

STATE CORPORATION COMMISSION OF KANSAS
OIL & GAS CONSERVATION DIVISION
WELL COMPLETION OR RECOMPLETION FORM
ACO-1 WELL HISTORY
DESCRIPTION OF WELL AND LEASE

S API NO. 15-175-20,924-A00-01
County Seward
S/2 SW NW Sec. 2 Twp 34S Rge 31 East
2970 Ft North from Southeast Corner of Section
4620 Ft West from Southeast Corner of Section
(Note: Locate well in section plat below)

Operator: License # 4247
Name Dolomite Resources Corporation
Address 105 S. Broadway, Suite 610
City/State/Zip Wichita, KS 67202

Lease Name Gene Black Well # 2-1

Purchaser Farmland Ind.

Field Name NA Iris

Operator Contact Person Thomas G. Pronold
Phone 316-265-8014

Producing Formation Marmaton

Elevation: Ground 2705 KB 2715

Contractor: License # 5107
Name H-30 Drilling, Inc.

Wellsite Geologist Thomas G. Pronold
Phone (316) 265-8014

Designate Type of Completion
 New Well Re-Entry Workover
 Oil SWD Temp Abd
 Gas Inj Delayed Comp.
 Dry Other (Core, Water Supply etc.)

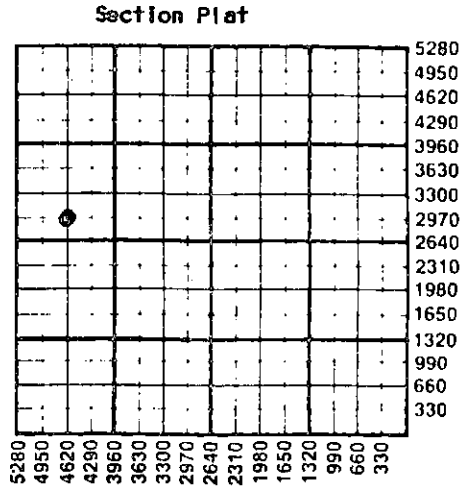

If OWG: old well info as follows:
Operator Jorford Corporation
Well Name Black No. 1-A
Comp. Date 1-22-87 Old Total Depth 6150'

WATER SUPPLY INFORMATION

Disposition of Produced Water: Disposal
Docket # Repressuring

Questions on this portion of the ACO-1 call:

Water Resources Board (913) 296-3717

Source of Water:
Division of Water Resources Permit #

Groundwater.....Ft North from Southeast Corner
(Well)Ft West from Southeast Corner of
Sec Twp Rge East West

Surface Water.....Ft North from Southeast Corner
(Stream, pond etc).....Ft West from Southeast Corner
Sec Twp Rge East West

Other (explain) Hauled
(purchased from city, R.W.D. #)

WELL HISTORY
Drilling Method:
 Mud Rotary Air Rotary Cable
7-20-87 7-21-87 8-04-87
Spud Date Date Reached TD Completion Date
6150' 5239
Total Depth PBTD
Amount of Surface Pipe Set and Cemented at 1562 feet
Multiple Stage Cementing Collar Used? Yes No
If yes, show depth set.....feet
If alternate 2 completion, cement circulated
from.....feet depth to.....w/.....SX cmt
Cement Company Name
Invoice #

INSTRUCTIONS: This form shall be completed in triplicate and filed with the Kansas Corporation Commission, 200 Colorado Derby Building, Wichita, Kansas 67202, within 120 days of the spud date of any well. Rule 82-3-130, 82-3-107 and 82-3-106 apply. Information on side two of this form will be held confidential for a period of 12 months if requested in writing and submitted with the form. See rule 82-3-107 for confidentiality in excess of 12 months. One copy of all wireline logs and drillers time log shall be attached with this form. Submit CP-4 form with all plugged wells. Submit CP-111 form with all temporarily abandoned wells.

All requirements of the statutes, rules and regulations promulgated to regulate the oil and gas industry have been fully complied with and the statements herein are complete and correct to the best of my knowledge.

Signature Thomas G. Pronold
Title President Date 18 Nov. 1987

Subscribed and sworn to before me this 18th day of Nov 1987
Notary Public Arlene E. Schroer

Date Commission Expires 8-5-90

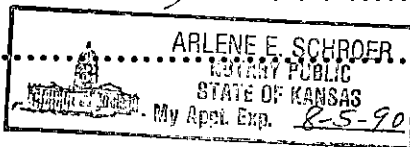

K.C.C. OFFICE USE ONLY
F Letter of Confidentiality Attached
C Wireline Log Received
C Drillers Time Log Received
Distribution
 KCC SWD/Rep NGPA
 KGS Plug Other
RECEIVED
STATE CORPORATION COMMISSION
NOV 24 1987
Form ACO-1 (5-86)

Sec. 2, Twp 34Rge 31

SIDE TWO

Operator Name Dolomite Resources Corporation Lease Name Gene Black Well # 2-1

Sec. 2 Twp. 34S Rge. 31 East West County Seward

WELL LOG

INSTRUCTIONS: Show important tops and base of formations penetrated. Detail all cores. Report all drill stem tests giving interval tested, time tool open and closed, flowing and shut-in pressures, whether shut-in pressure reached static level, hydrostatic pressures, bottom hole temperature, fluid recovery, and flow rates if gas to surface during test. Attach extra sheet if more space is needed. Attach copy of log.

Drill Stem Tests Taken Yes No
 Samples Sent to Geological Survey Yes No
 Cores Taken Yes No

Formation Description
 Log Sample

DST #1 6045-6080
 Misrun

Name Top Bottom
 Washed down to 6100'
 New Rotary Total Depth 6100'

CASING RECORD New Used

Report all strings set-conductor, surface, intermediate, production, etc.

Purpose of String	Size Hole Drilled	Size Casing Set (In O.D.)	Weight Lbs/Ft.	Setting Depth	Type of Cement	#Sacks Used	Type and Percent Additives
Surface	12 1/4"	8-5/8"	24#	1562'			
Production	7-7/8"	4-1/2"	10.5#	5296'	50-50 Poz	150	50/50 Poz 18% salt 3/4% Halad 322

PERFORATION RECORD

Acid, Fracture, Shot, Cement Squeeze Record 5# gils/5k.
 (Amount and Kind of Material Used) Depth

Shots Per Foot	Specify Footage of Each Interval Perforated	Depth
2	5131-5137	N/A

TUBING RECORD Size 2 3/8 Set At 5/61 Packer at N/A Liner Run Yes No

Date of First Production 22 September 1987 Producing Method Flowing Pumping Gas Lift Other (explain).....

Estimated Production Per 24 Hours	Oil	Gas	Water	Gas-Oil Ratio	Gravity
	34 Bbls	0 MCF	18 Bbls	CFPB	

METHOD OF COMPLETION

Production Interval

Disposition of gas: Vented Open Hole Perforation
 Sold Other (Specify) 5131-5137
 Used on Lease Dually Completed
 Commingled