

STATE CORPORATION COMMISSION OF KANSAS  
OIL & GAS CONSERVATION DIVISION  
WELL COMPLETION OR RECOMPLETION FORM  
ACO-1 WELL HISTORY  
DESCRIPTION OF WELL AND LEASE

S

API NO. 15-119-20,754-00-00  
County Meade  
C S/2 SW/4 14 34 29 East  
..... Sec. .... Twp. .... Rge. .... XX West  
..... 660 Ft North from Southeast Corner of Section  
..... 3960 Ft West from Southeast Corner of Section  
(Note: Locate well in section plat below)

Operator: License # 9404  
Name Rosewood Resources, Inc.  
Address 200 Crescent Court - Suite 300  
.....  
City/State/Zip Dallas, Texas 75201

Lease Name Larrabee Well # 1-14

Purchaser .....

Field Name .....

Operator Contact Person Gilbert Wolfe  
Phone 214-871-5700

Producing Formation .....

Elevation: Ground 2427.6' 2440.6'  
..... KB .....

Contractor: License # 5421  
Name Sage Drilling Co., Inc.

Wellsite Geologist Vernon Williams  
Phone 405/256-5966

Designate Type of Completion  
XX New Well Re-Entry Workover

Oil SWD Temp Abd  
Gas Inj Delayed Comp.  
XX Dry Other (Core, Water Supply etc.)

If ~~OWNED~~ old well, info as follows:  
Operator .....

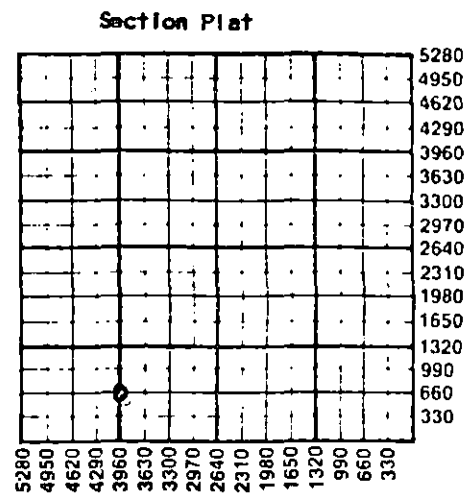

WATER SUPPLY INFORMATION  
Disposition of Produced Water: Disposal  
Docket # .....

WELL HISTORY

Drilling Method: XX Mud Rotary Air Rotary Cable  
2-10-87 2-18-87 2-22-87  
Spud Date Date Reached TD Completion Date  
5900' -  
Total Depth PBTD

Amount of Surface Pipe Set and Cemented at 1632 feet  
Multiple Stage Cementing Collar Used? Yes XX No  
If yes, show depth set .....

Questions on this portion of the ACO-1 call:  
Water Resources Board (913) 296-3717  
Source of Water:  
Division of Water Resources Permit # unknown  
XX Groundwater 3960 Ft North from Southeast Corner  
(Well) 3300 Ft West from Southeast Corner of  
Sec 23 Twp 34 Rge 29 East XX West  
Surface Water ..... Ft North from Southeast Corner  
(Stream, pond etc) ..... Ft West from Southeast Corner  
Sec Twp Rge East West  
Other (explain) .....  
(purchased from city, R.W.D. #)

INSTRUCTIONS: This form shall be completed in triplicate and filed with the Kansas Corporation Commission, 200 Colorado Derby Building, Wichita, Kansas 67202, within 120 days of the spud date of any well. Rule 82-3-130, 82-3-107 and 82-3-106 apply. Information on side two of this form will be held confidential for a period of 12 months if requested in writing and submitted with the form. See rule 82-3-107 for confidentiality in excess of 12 months. One copy of all wireline logs and drillers time log shall be attached with this form. Submit CP-4 form with all plugged wells. Submit CP-111 form with all temporarily abandoned wells.

All requirements of the statutes, rules and regulations promulgated to regulate the oil and gas industry have been fully complied with and the statements herein are complete and correct to the best of my knowledge.

Signature Gilbert Wolfe  
Title Operations Specialist Date 3-10-87

Subscribed and sworn to before me this 10th day of March 1987  
Notary Public [Signature]  
Date Commission Expires 12-29-88

K.C.C. OFFICE USE ONLY  
F Letter of Confidentiality Attached  
C Wireline Log Received  
C Drillers Timelog Received  
Distribution  
KCC SWD/Rep NGPA  
KGS Plug Other (Specify)

MAR 11 1987

CONSERVATION DIVISION  
Wichita, Kansas

Form ACO-1 (5-86)

Sec 14 Twp 34 Rge 29

SIDE TWO

Operator Name Rosewood Resources, Inc. Lease Name Larrabee Well # 1-14

Sec. 14 Twp. 34 Rge. 29  East  West County Meade

WELL LOG

INSTRUCTIONS: Show important tops and base of formations penetrated. Detail all cores. Report all drill stem tests giving interval tested, time tool open and closed, flowing and shut-in pressures, whether shut-in pressure reached static level, hydrostatic pressures, bottom hole temperature, fluid recovery, and flow rates if gas to surface during test. Attach extra sheet if more space is needed. Attach copy of log.

Drill Stem Tests Taken  Yes  No  
 Samples Sent to Geological Survey  Yes  No  
 Cores Taken  Yes  No

Formation Description  
 Log  Sample

Marmaton 5176-5185' (pressures psi)  
 1st Flow 30 Min. initial 283/final 283  
 ISIP 60 " 1736  
 2nd Flow 90 " initial 383/final 714  
 FSIP 180 " 1736  
 Hydrostatic Pressures initial 2502  
 final 2502  
 Data from recorder at 5141'; BHT 113° F  
 Recovery Data  
 Tr. Blow in 1-1/2 min. increase to bottom of bucket in 3 min.  
 GTS in 28 min, OTS in 0 min; Wtr. Anyl. 200,000 PPM CL  
 Fluid Recovery Gas Flow-MCF/D  
 170' Drlg Mud in 40 Min. FTP 1#, Rate 11  
 1468' Form. water in 75 Min. FTP 2#, Rate 13

Name	Top	Bottom
Base Heebner	4356'	
Toronto	4392'	
Lansing	4496'	
Upper Kansas City	4779'	
Lower Kansas City	5006'	
Marmaton	5176'	
Novinger	5254'	
Atoka	5596'	
Morrow Shale	5718'	
Chester	5815'	

CASING RECORD <input checked="" type="checkbox"/> New <input type="checkbox"/> Used							
Report all strings set-conductor, surface, intermediate, production, etc.							
Purpose of String	Size Hole Drilled	Size Casing Set (in O.D.)	Weight Lbs/Ft.	Setting Depth	Type of Cement	#Sacks Used	Type and Percent Additives
Surface	12-1/4"	8-5/8"	24#	1632	Lite 85-15-8 A	500 200	3% Salt, 1/4# / 5x Celco. 2% CACL
PERFORATION RECORD				Acid, Fracture, Shot, Cement Squeeze Record			
Shots Per Foot	Specify Footage of Each Interval Perforated			(Amount and Kind of Material Used)		Depth	
TUBING RECORD				Liner Run	<input type="checkbox"/> Yes <input type="checkbox"/> No		
Date of First Production	Producing Method <input type="checkbox"/> Flowing <input type="checkbox"/> Pumping <input type="checkbox"/> Gas Lift <input type="checkbox"/> Other (explain).....						
Estimated Production Per 24 Hours	Oil	Gas	Water	Gas-Oil Ratio	Gravity		
	Bbls	MCF	Bbls	CFPB			

METHOD OF COMPLETION

Production Interval

Disposition of gas:  Vented  Open Hole  Perforation  
 Sold  Other (Specify) .....  
 Used on Lease  Dually Completed  
 Commingled