

STATE OF KANSAS
STATE CORPORATION COMMISSION

WELL PLUGGING RECORD

Give All Information Completely
Make Required Affidavit
Mail or Deliver Report to
Conservation Division
State Corporation Comm.
245 North Water
Wichita, KS 67202

Meade County, Sec. 13 Twp. 35S Rge. 26 NW/4
Location as "NE/CNW1SW1" or footage from lines
2640' FEL and 1400' FNL

Lease Owner Hawkins Oil & Gas, Inc.
Lease Name Theis Well No. 1-13

Office Address P. O. Box 1869, Liberal, KS 67901-1869

Character of Well (Completed as Oil, Gas or Dry Hole)
dry hole

Date Well completed 8-29 1981

Application for plugging filed 9-1 1981

Application for plugging approved 9-1 1981

Plugging commenced 9-1 1981

Plugging completed 9-20 1981

Reason for abandonment of well or producing formation
dry hole

If a producing well is abandoned, date of last production
19

Was permission obtained from the Conservation Division or
its agents before plugging was commenced? yes

Name of Conservation Agent who supervised plugging of this well Ken Beaky

Producing formation Depth to top Bottom Total Depth of Well 6350'

Show depth and thickness of all water, oil and gas formations.

OIL, GAS OR WATER RECORDS

CASING RECORD

FORMATION	CONTENT	FROM	TO	SIZE	PUT IN	PULLED OUT
				8-5/8"	881'	-0-

Describe in detail the manner in which the well was plugged, indicating where the mud fluid was placed and the method or methods used in introducing it into the hold. If cement or other plugs were used, state the character of same and depth placed, from feet to feet for each plug set.

Plugged well as follows: 50 sx cement @ 6100'
50 sx cement @ 883'
25 sx cement @ 400'
10 sx cement @ 33-GL
5 sx ea. in rat and mouse hole

Cut off pipe and welded on ID cap

(If additional description is necessary, use BACK of this sheet)

Name of Plugging Contractor Halliburton

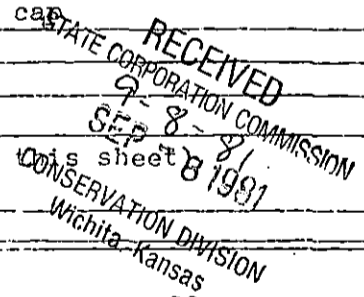

STATE OF Kansas COUNTY OF Seward
Ned.E. Lowry, Agent (employee of owner) or (owner or operator)

of the above-described well, being first duly sworn on oath, says: That I have knowledge of the facts, statements, and matters herein contained and the log of the above-described well as filed and that the same are true and correct. So help me God.

(Signature) Ned E Lowry, Agent
P. O. Box 1869, Liberal, KS 67901-1869
(Address)

SUBSCRIBED AND SWORN TO before me this 3rd day of September, 1981

Denise Geist
Notary Public.

My commission expires 2-26-83

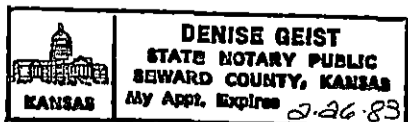

15-119-20492-0000

KANSAS
WELL COMPLETION REPORT AND
DRILLER'S LOG

S. 13 T. 35S R. 26 W
Loc. 2640' FEL & 1400' FNL
County Meade

API No. 15 --- 119 --- 20,492
County Number

Operator
Hawkins Oil & Gas, Inc.

Address
P. O. Box 1869 Liberal, KS 67901-1869

Well No. 1-13 Lease Name Theis

Footage Location
1400 feet from (N) (X) line 2640 feet from (E) (X) line

Principal Contractor Rine Geologist

Spud Date 8-16-81 Date Completed 8-29-81 Total Depth 6350' P.D.T.D.

Directional Deviation Oil and/or Gas Purchaser

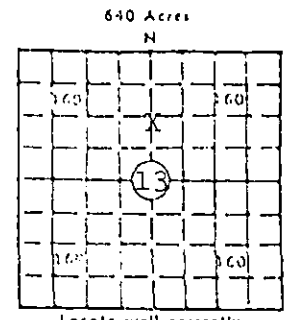

Locate well correctly
Elev.: Gr. 2258'
DF 2268' KB 2271'

CASING RECORD

Report of all strings set — surface, intermediate, production, etc.

Purpose of string	Size hole drilled	Size casing set (in O.D.)	Weight lbs/ft	Setting depth	Type cement	Socks	Type and percent additives
Surface	12-1/4"	8-5/8"	23#	881'	Halli lite Class H	350 150	1/4# flocele, 2% 3% cc

LINER RECORD

PERFORATION RECORD

Top, ft.	Bottom, ft.	Sucks cement	Shots per ft.	Size & type	Depth interval

TUBING RECORD

Size	Setting depth	Packer set at

ACID, FRACTURE, SHOT, CEMENT SQUEEZE RECORD

Amount and kind of material used	Depth interval treated
	RECEIVED STATE CORPORATION COMMISSION SEP 10 1981 CONSERVATION DIVISION Wichita, Kansas

INITIAL PRODUCTION

Date of first production	Producing method (flowing, pumping, gas lift, etc.)
RATE OF PRODUCTION PER 24 HOURS	Oil bbls. Gas MCF Water bbls. Gas-oil ratio CFPB
Disposition of gas (vented, used on lease or sold)	Producing interval(s)

INSTRUCTIONS: As provided in KCC Rule 82-2-125, within 90 days after completion of a well, one completed copy of this Drillers Log shall be transmitted to the State Geological Survey of Kansas, 4150 Monroe Street, Wichita, Kansas 67209. Copies of this form are available from the Conservation Division, State Corporation Commission, 245 No. Water, Wichita, Kansas 67202. Phone AC 316-522-2206. If confidential custody is desired, please note Rule 82-2-125. Drillers Logs will be an open file in the Oil and Gas Division, State Geological Survey of Kansas, Lawrence, Kansas 66044.

0000-28704-P.-2.

Operator Hawkins Oil & Gas, Inc.		DESIGNATE TYPE OF COMP.: OIL, GAS, DRY HOLE, SWDV, ETC.: dry hole
Well No. 1-13	Lease Name Theis	
S <u>13</u> T <u>35</u> R <u>26</u> ^{XX} _W		

WELL LOG

Show all important zones of porosity and contents thereof; cored intervals, and all drill-stem tests, including depth interval tested, cushion used, time lost open, flowing and shut-in pressures, and recoveries.

SHOW GEOLOGICAL MARKERS, LOGS RUN, OR OTHER DESCRIPTIVE INFORMATION.

FORMATION DESCRIPTION, CONTENTS, ETC.	TOP	BOTTOM	NAME	DEPTH
Surface	0	73'		
Red Bed	73	1830'		
Red Bed and Anhydrite	1830	2270'		
Anhydrite	2270	2620		
Anhydrite	2620	3005		
Dolomite	3005	4625		
Lime & Shale	4625	6350' TD		

USE ADDITIONAL SHEETS, IF NECESSARY, TO COMPLETE WELL RECORD.

Date Received	<i>Ned E Lowry</i> Signature	Agent
	Drilling Superintendent Title	
	September 9, 1981 Date	