

STATE OF KANSAS  
STATE CORPORATION COMMISSION

WELL PLUGGING RECORD

Give All Information Completely  
Make Required Affidavit  
Mail or Deliver Report to  
Conservation Division  
State Corporation Comm.  
245 North Water  
Wichita, KS 67202

Morton County, Sec. 9 Twp. 34S Rge. 43 E/W  
Location as "NE/CNW $\frac{1}{4}$ SW $\frac{1}{4}$ " or footage from lines  
NW NW

Lease Owner Anadarko Production Company  
Lease Name INTERSTATE "D" Well No. 4

Office Address P. O. Box 351, Liberal, Kansas 67901

Character of Well (Completed as Oil, Gas or Dry Hole)  
Dry Hole

Date Well completed 12/19 1979  
Application for plugging filed 1/4 1980  
Application for plugging approved verbal 12/19 1979  
Plugging commenced 12/19 1979  
Plugging completed 12/19 1979

Reason for abandonment of well or producing formation  
Dry Hole

If a producing well is abandoned, date of last production  
19

Was permission obtained from the Conservation Division or  
its agents before plugging was commenced? Yes

Name of Conservation Agent who supervised plugging of this well Clarence Thomas, Jr.  
Producing formation Depth to top Bottom Total Depth of Well 5150'

Show depth and thickness of all water, oil and gas formations.

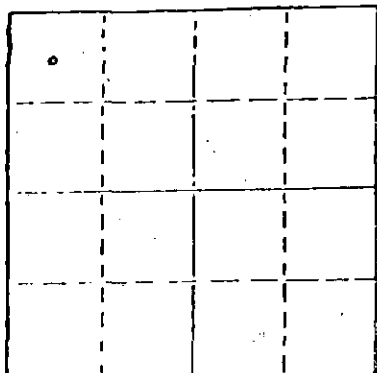

Locate well correctly on above  
Section Plot

OIL, GAS OR WATER RECORDS

CASING RECORD

FORMATION	CONTENT	FROM	TO	SIZE	PUT IN	PULLED OUT
				8-5/8"	1347'	-0-

Describe in detail the manner in which the well was plugged, indicating where the mud fluid was placed and the method or methods used in introducing it into the hold. If cement or other plugs were used, state the character of same and depth placed, from feet to feet for each plug set.

Spotted 60 sxs common from 1380-1280 & filled hole w/heavy drilling mud, spotted 10 sxs common from 40-0', 5 sxs cmt in rathole.

(If additional description is necessary, use BACK of this sheet)

Name of Plugging Contractor Gabbert-Jones, Inc.

STATE OF KANSAS COUNTY OF SEWARD, ss.

Paul Campbell (employee of owner) or (owner or operator) of the above-described well, being first duly sworn on oath, says: That I have knowledge of the facts, statements, and matters herein contained and the log of the above-described well as filed and that the same are true and correct. So help me God.

(Signature) *Paul Campbell*  
P. O. Box 351, Liberal, Kansas 67901  
(Address)

SUBSCRIBED AND SWORN TO before me this 7<sup>th</sup> day of January, 1980

BEVERLY J. WILLIAMS  
Seward County, Kansas  
My Appt. Exp. 11/21/82

My Commission expires November 21, 1982

*Beverly J. Williams*  
Notary Public.

RECEIVED  
STATE CORPORATION COMMISSION

JAN - 9 1980  
1-9-80  
Wichita, Kansas

15-129-20418-0000

KANSAS

WELL COMPLETION REPORT AND DRILLER'S LOG

S. 9 T. 34S R. 43 Ex W

API No. 15 — 129 — 20,418  
County Number

Loc. NW NW

County Morton

Operator  
Anadarko Production Company

Address  
P. O. Box 351, Liberal, Kansas 67901

Well No. 4 Lease Name INTERSTATE "D"

Footage Location  
660 feet from (N) ~~XX~~ line 660 feet from ~~XX~~ (W) line

Principal Contractor Geologist  
Gabbert-Jones, Inc.

Spud Date Date Completed Total Depth P.B.T.D.  
12/4/79 12/19/79 5150

Directional Deviation Oil and/or Gas Purchaser  
3/4 deg @ 4430' Dry Hole

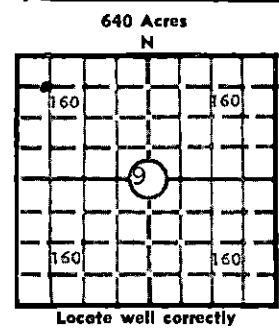

Locate well correctly  
Elev.: Gr. 3632.9

DF. 3635 KB 3636

CASING RECORD

Report of all strings set — surface, intermediate, production, etc.

Purpose of string	Size hole drilled	Size casing set (in O.D.)	Weight lbs/ft.	Setting depth	Type cement	Sacks	Type and percent additives
Surface	12-1/4"	8-5/8"	24#	1347'	Pozmix Common	600 200	4% gel 2% CaCl 2% CaCl

LINER RECORD

PERFORATION RECORD

Top, ft.	Bottom, ft.	Sacks cement	Shots per ft.	Size & type	Depth interval

Size	Setting depth	Packer set at

ACID, FRACTURE, SHOT, CEMENT SQUEEZE RECORD

Amount and kind of material used	Depth interval treated

INITIAL PRODUCTION

Date of first production Dry Hole	Producing method (flowing, pumping, gas lift, etc.)
RATE OF PRODUCTION PER 24 HOURS	Oil Gas Water Gas-oil ratio bbls. MCF bbls. CFPB
Disposition of gas (vented, used on lease or sold)	Producing interval(s)

STATE RECEIVED  
CONSERVATION COMMISSION  
NOV 20 1979  
LIBERAL - 9 1500

INSTRUCTIONS: As provided in KCC Rule 82-2-125, within 90 days after completion of a well, one completed copy of this Drillers Log shall be transmitted to the State Geological Survey of Kansas, 4150 Monroe Street, Wichita, Kansas 67209. Copies of this form are available from the Conservation Division, State Corporation Commission, 245 No. Water, Wichita, Kansas 67202. Phone AC 316-522-2206. If confidential custody is desired, please note Rule 82-2-125. Drillers Logs will be on open file in the Oil and Gas Division, State Geological Survey of Kansas, Lawrence, Kansas 66044.

Operator  
Anadarko Production Company

DESIGNATE TYPE OF COMP.: OIL, GAS,  
DRY HOLE, SWDW, ETC.:

Well No. 4 Lease Name INTERSTATE "D" DRY HOLE

S 9 T 34S R 43  $\frac{K}{W}$

**WELL LOG**

Show all important zones of porosity and contents thereof; cored intervals, and all drill-stem tests, including depth interval tested, cushion used, time tool open, flowing and shut-in pressures, and recoveries.

SHOW GEOLOGICAL MARKERS, LOGS RUN, OR OTHER DESCRIPTIVE INFORMATION.

FORMATION DESCRIPTION, CONTENTS, ETC.	TOP	BOTTOM	NAME	DEPTH
Surface Clay-Sand	0'	140'		
Redbed	140'	563'		
Redbed-Anhydrite	563'	907'		
Redbed-Anhydrite-Sand	907'	1095'		
Sand-Redbed	1095'	1253'		
Redbed-Anhydrite	1253'	1348'		
Anhydrite-Shale	1348'	1660'		
Lime-Shale	1660'	5150'		
RTD		5150'		
DST #1 4658-75 (Morrow) 30-60-60-120, op w/vry wk blow, rec 70' wtr mud, IFP 14-43, ISIP 977 (60), FFP 43-71, FSIP 977 (120), HP 2198-2184.				
DST #2 4694-4740 (St Louis) 30-30-60-120, op w/vry wk blow thruout, rec 350' SW-N.S., IFP 32-95, ISIP 983 (30), FFP 95-175, FSIP 1014 (120), HP 2282-2250.				

USE ADDITIONAL SHEETS, IF NECESSARY, TO COMPLETE WELL RECORD.

Date Received

*Paul Campbell*  
Signature

Paul Campbell, Division Production Manager  
Title

January 4, 19780  
Date