

15-119-10293-1000

STATE OF KANSAS
STATE CORPORATION COMMISSION

Give All Information Completely
Make Required Affidavit
Mail or Deliver Report to:
Conservation Division
State Corporation Commission
211 No. Broadway
Wichita, Kansas

WELL PLUGGING RECORD

NORTH

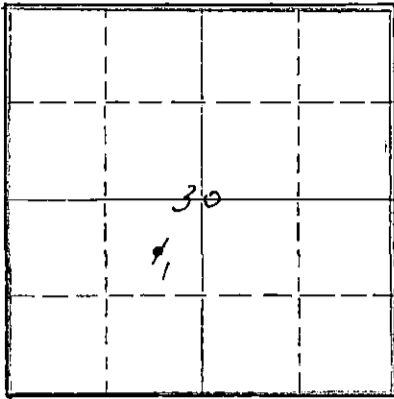

Locate well correctly on above
Section Plat

Meade

County. Sec. 30 Twp. 34 Rge. (E) 27(W)

Location as "NE/CNW/SW" or footage from lines C NE/4 SW/4

Lease Owner Skelly Oil Company

Lease Name Barragree "A" Well No. 1

Office Address Box 1650, Tulsa, Oklahoma

Character of Well (completed as Oil, Gas or Dry Hole) Dry Hole

Date well completed November 13, 1959

Application for plugging filed November 14, 1959

Application for plugging approved November 17, 1959

Plugging commenced November 14, 1959

Plugging completed November 14, 1959

Reason for abandonment of well or producing formation Dry Hole

If a producing well is abandoned, date of last production 19

Was permission obtained from the Conservation Division or its agents before plugging was commenced? Yes

Name of Conservation Agent who supervised plugging of this well Mr. W. L. Lackamp

Producing formation None Depth to top Bottom Total Depth of Well 3150 Feet

Show depth and thickness of all water, oil and gas formations.

OIL, GAS OR WATER RECORDS

CASING RECORD

FORMATION	CONTENT	FROM	TO	SIZE	PUT IN	PULLED OUT
Council Grove	Dry	3060'		8-5/8"	787'0"	None

Describe in detail the manner in which the well was plugged, indicating where the mud fluid was placed and the method or methods used in introducing it into the hole. If cement or other plugs were used, state the character of same and depth placed, from feet to feet for each plug set.

50 sacks of cement	3150' to 2989'
Heavy mud	2989' to 600'
Rubber plug	600'
30 sacks of cement	600' to 510'
Heavy mud	510' to 35'
Rubber plug	35'
25 sacks of cement	35' to 6'
Surface soil	6' to 0'

RECEIVED
CONSERVATION COMMISSION
DEC 15 1959
CONSERVATION DIVISION
Wichita, Kansas

(If additional description is necessary, use BACK of this sheet)
Name of Plugging Contractor Graham-Michaelis Drlg. Company
Address 211 No. Broadway, Wichita 2, Kansas

STATE OF Kansas, COUNTY OF Reno, ss.
H. E. Wamsley (employee of owner) of the above-described well, being first duly sworn on oath, says: That I have knowledge of the facts, statements, and matters herein contained and the log of the above-described well as filed and that the same are true and correct. So help me God.

(Signature) [Signature]
Box 391, Hutchinson, Kansas (Address)

SUBSCRIBED AND SWORN TO before me this 14th day of December, 1959

My commission expires April 7, 1963

[Signature] Notary Public.



SKELLY OIL COMPANY

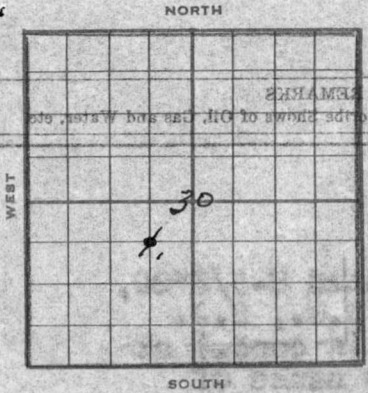

Well Record
 Lease Name and No. Farragree "A" Well No. 1 Elev. 2371' DP
 Lease Description All of Section 30-34S-27W, Meade
County, Kansas (640 Acres)
 Location made October 27, 1959 by Meade County Engineer
 feet from North line 660 feet from East line SW/4
 feet from South line 1930 feet from West line of Sec. 30

Work com'd. 11/3 1959 Rig comp'd 11/4 1959 Drlg. com'd 11/4 1959 Drlg. comp'd 11/12 1959
 Rig Contractor Graham-Michaels Drilling Company
 Drilling Contractor Graham-Michaels Drlg. Company, Wichita, Kansas
 Rotary Drilling from 0' to 3150' Cable Tool Drilling from _____ to _____

Commenced Producing DRY HOLE 19____
 Initial Prod. before shot or acid _____ Bbls.
 Initial Prod. after shot or acid _____ Bbls.
 Dry Gas Well Press _____ Volume _____ Cu. ft.
 Casing Head Gas Pressure _____ Volume _____ Cu. ft.
 Braden Head (_____ Size) Gas Pressure _____ Volume _____ Cu. ft.
 Braden Head (_____ Size) Gas Pressure _____ Volume _____ Cu. ft.

PRODUCING FORMATION DRY HOLE Top _____ Bottom _____ TOTAL DEPTH 3150'
 (Name)

CASING RECORD

OD	Size	Wt.	Thds.	Where Set	PULLED OUT			LEFT IN			KIND	Cond'n	CEMENTING	
					Jts	Feet	In.	Jts	Feet	In.			Sacks Used	Method Employed
	<u>8-5/8"</u>	<u>22.7</u>	<u>34</u>	<u>792'</u>				<u>20</u>	<u>787</u>	<u>0</u>	<u>Armed SW A</u>	<u>500</u>	<u>Halliburton</u>	
<u>(8-5/8" casing cut off 5' below derrick floor)</u>														

RECEIVED
 STATE CORPORATION COMMISSION
 DEC 15 1959
 CONSERVATION DIVISION
 Wichita, Kansas

Liner Set at _____ Length _____ Perforated at _____
 Liner Set at _____ Length _____ Perforated at _____
 Packer Set at _____ Size and Kind _____
 Packer Set at _____ Size and Kind _____

SHOT OR ACID TREATMENT RECORD

	FIRST		SECOND		THIRD		FOURTH	
Date								
Acid Used								
Size Shot								
Shot Between	Ft. and	Ft.	Ft. and	Ft.	Ft. and	Ft.	Ft. and	Ft.
Size of Shell								
Put in by (Co.)								
Length anchor								
Distance below Cas'g								
Damage to Casing or Casing Shoulder								

SIGNIFICANT GEOLOGICAL FORMATIONS

NAME	Top	Bottom	GAS		OIL		REMARKS
			From	To	From	To	
<u>Council Grove</u>	<u>3060'</u>						

CLEANING OUT RECORDS

	DATE COMMENCED	DATE COMPLETED	PROD. BEFORE	PROD. AFTER	REMARKS
1st					See Reverse for other details.
2nd					" " " " "
3rd					" " " " "
4th					" " " " "

PLUGGING BACK AND DEEPENING RECORDS

	Date Commenced	Date Completed	No. Feet Plugged Back or Deepened	Prod. Before	Prod. After	REMARKS
1st						See Reverse for other details.
2nd						" " " " "
3rd						" " " " "
4th						" " " " "

(See Reverse for Record of Formation)

RECORD OF FORMATIONS

FORMATION	TOP	BOTTOM	REMARKS
Surface soil, red bed and shale	0	130	Set and cemented 8-5/8" OD, 22.7% Amco S.W., S.J. steel casing (A cond.) at 792' with 500 sacks of common cement and 2% calcium chloride. Finished cementing at 9:15 am 11/5/59. Cement circulated. EASE ANHYDRITE 1332'
Red bed and gyp	130	625	
Red bed and lime	625	793	
Shale and lime	793	1821	TOP COUNCIL GROVE LINE 3060' DRILL STEM TEST NO. 1 3048'-3105', open 1 hour, 20 mins., gas to surface in 6 minutes, gas gauged 334 MCF in 15 mins.; in 30 mins., 270 MCF; in 1 hr., 210 MCF; and in 80 mins., 196 MCF, recovered 150' gas cut mud, 270' gas cut muddy salt water, IBHP-890# in 20 mins., IFF-110#, FFP-130#, FBHP-760# in 20 mins. Ran Schlumberger Survey DRILL STEM TEST NO. 2 3050'-3084', straddle packers, top packer failed. DRILL STEM TEST NO. 3 3048'-3086', top packer set at 3048', bottom packer set at 3086', used 64' anchor, open 1 1/2 hours, gas to surface in 5 minutes, gas gauged 310 MCF in 15 mins.; 240 MCF in 30 mins.; 196 MCF in 45 mins.; 196 MCF in 75 mins., recovered 185' of gas cut watery mud, IBHP-905# in 20 mins., IFF-60#, FFP-60#, FBHP-775# in 20 minutes.
Shale with streaks of gyp	1821	2025	
Shale and shells	2025	2225	
Anhydrite	2225	2308	
Anhydrite and shale	2308	2533	
Anhydrite	2533	2619	
Lime	2619	2688	
Anhydrite	2688	2826	
Lime	2826	2977	
Chert and lime	2977	2995	
Cherty lime and shale	2995	3082	
Lime	3082	3105	

CASING RECORD			
KIND	DEPTH IN FEET	DATE	REMARKS
Lime	3105	11/12/59	Ran Schlumberger Survey DRILL STEM TEST NO. 2 3050'-3084', straddle packers, top packer failed.

ACID TREATMENT RECORD			
DATE	TIME	DEPTH	REMARKS
			DRILL STEM TEST NO. 3 3048'-3086', top packer set at 3048', bottom packer set at 3086', used 64' anchor, open 1 1/2 hours, gas to surface in 5 minutes, gas gauged 310 MCF in 15 mins.; 240 MCF in 30 mins.; 196 MCF in 45 mins.; 196 MCF in 75 mins., recovered 185' of gas cut watery mud, IBHP-905# in 20 mins., IFF-60#, FFP-60#, FBHP-775# in 20 minutes.

TOTAL DEPTH 3150'
Total Depth Reached: 11/12/59

Since there were no commercial shows of either oil or gas encountered in drilling to the total depth of 3150', regular authority was granted to plug and abandon the well. On November 14, the well was plugged as follows:

MATERIAL	DEPTH	TO	REMARKS
50 sacks of cement	3150'	2989'	Plugged and Abandoned 11/14/59
Heavy mud	2989'	600'	
Rubber plug		600'	
30 sacks of cement	600'	510'	
Heavy mud	510'	35'	
Rubber plug		35'	
25 sacks of cement	35'	6'	
Surface soil	6'	0'	

CLEANING OUT RECORDS																			
DATE	TIME	DEPTH	REMARKS																
			SLOPE TEST DATA <table border="1" style="width: 100%; border-collapse: collapse;"> <thead> <tr> <th>DEPTH</th> <th>ANGLE OF DEFLECTION</th> </tr> </thead> <tbody> <tr> <td>255'</td> <td>1/4 Degree</td> </tr> <tr> <td>700'</td> <td>1/2 "</td> </tr> <tr> <td>1350'</td> <td>0 "</td> </tr> <tr> <td>1850'</td> <td>1/4 "</td> </tr> <tr> <td>2418'</td> <td>3/4 "</td> </tr> <tr> <td>2616'</td> <td>3/4 "</td> </tr> <tr> <td>2899'</td> <td>3/4 "</td> </tr> </tbody> </table>	DEPTH	ANGLE OF DEFLECTION	255'	1/4 Degree	700'	1/2 "	1350'	0 "	1850'	1/4 "	2418'	3/4 "	2616'	3/4 "	2899'	3/4 "
DEPTH	ANGLE OF DEFLECTION																		
255'	1/4 Degree																		
700'	1/2 "																		
1350'	0 "																		
1850'	1/4 "																		
2418'	3/4 "																		
2616'	3/4 "																		
2899'	3/4 "																		

(See Remarks for Record of Formations)