

15-119-20167-0000

STATE OF KANSAS
STATE CORPORATION COMMISSION

Form CP-4

Give All Information Completely
Make Required Affidavit
Mail or Deliver Report to:
Conservation Division
State Corporation Commission

WELL PLUGGING RECORD

P. O. Box 17027
Wichita, Kansas 67217
NORTH

Meade County, Sec. 19 Twp. 34S Rgs. (E) 28 (W)
Location as "NE/CNW/SE/SW" or footage from lines 1320' FNL, 1980' FWL
Lease Owner SABINE DEVELOPMENT COMPANY
Lease Name Davis #1-19 Well No. _____
Office Address 801 First Nat'l Bank Bldg, Okla City, Oklahoma
Character of Well (completed as Oil, Gas or Dry Hole) Dry Hole
Date well completed 5-2-74 19____
Application for plugging filed 5-2-74 19____
Application for plugging approved 5-2-74 19____
Plugging commenced 5-2-74 19____
Plugging completed 5-2-74 19____
Reason for abandonment of well or producing formation Dry Hole

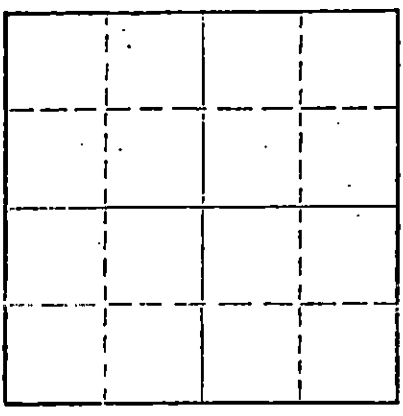

Locate well correctly on above
Section Plot

If a producing well is abandoned, date of last production _____ 19____
Was permission obtained from the Conservation Division or its agents before plugging was commenced? Yes

Name of Conservation Agent who supervised plugging of this well Ed Eves, Sublette, Kansas
Producing formation _____ Depth to top _____ Bottom _____ Total Depth of Well 6245' Feet
Show depth and thickness of all water, oil and gas formations.

OIL, GAS OR WATER RECORDS

CASING RECORD

FORMATION	CONTENT	FROM	TO	SIZE	PUT IN	PULLED OUT
				8-5/8"	767'	0

Describe in detail the manner in which the well was plugged, indicating where the mud fluid was placed and the method or methods used in introducing it into the hole. If cement or other plugs were used, state the character of same and depth placed, from _____ feet to _____ feet for each plug set.

35 sks @ 700'
15 sks @ 35'
job completed @ 1:00 pm. 5-2-74

RECEIVED
STATE CORPORATION COMMISSION
MAY 17 1974
CONSERVATION DIVISION
Wichita, Kansas

(If additional description is necessary, use BACK of this sheet)
Name of Plugging Contractor Halliburton
Address Liberal, Kansas

STATE OF Kansas, COUNTY OF Sedgwick ss.
R. T. Houston (employee of owner) or (owner or operator) of the above-described

well, being first duly sworn on oath, says: That I have knowledge of the facts, statements, and matters herein contained and the log of the above-described well as filed and that the same are true and correct. So help me God.

(Signature) [Signature]
111 West Douglas, Wichita, Kansas
(Address)

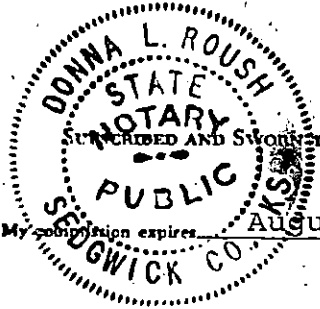

Subscribed and Sworn to before me this Eight day of May, 1974

Donna J. Roush
Notary Public.

My commission expires August 30, 1977

15-119-20167-0000

IMPORTANT
Kans. Geo. Survey request
samples on this well.

KANSAS DRILLERS LOG

S. 19 T. 34 R. 27 E
W
Loc. 1320 FNL 1980 FWL
County Meade

API No. 15 — 119 — 20,167
County Number

Operator
The Headington Company

Address 801 First National Center
Oklahoma City, Oklahoma

Well No. #1-19 Lease Name Davis

Footage Location
1320 FNL feet from (N) (S) line 1980 FWL feet from (E) (W) line

Principal Contractor Leben Drilling Company Geologist Ed Headington

Spud Date 4-17-74 Total Depth 6250 P.B.T.D.

Date Completed 5-2-74 Oil Purchaser D & A

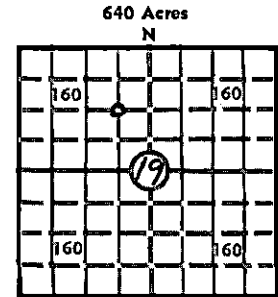

Locate well correctly
Elev.: Gr. 2387
DF 2394 KB

CASING RECORD

Report of all strings set — surface, intermediate, production, etc.

Purpose of string	Size hole drilled	Size casing set (in O.D.)	Weight lbs/ft.	Setting depth	Type cement	Sacks	Type and percent additives
Casing	12-1/4"	8-5/8"	24#	767'	Alco Litewt. Class H	250 200	2%cc 3%cc

LINER RECORD

PERFORATION RECORD

Top, ft.	Bottom, ft.	Sacks cement	Shots per ft.	Size & type	Depth interval
-	-	-	-	-	-

Size	Setting depth	Packer set at
-	-	-

ACID, FRACTURE, SHOT, CEMENT SQUEEZE RECORD

Amount and kind of material used

None

RECEIVED
STATE CORPORATION COMMISSION
MAY 9 - 1974
CONSERVATION DIVISION
Wichita, Kansas

INITIAL PRODUCTION

Date of first production None - Dry & Abandoned Producing method (flowing, pumping, gas lift, etc.) -

RATE OF PRODUCTION PER 24 HOURS	Oil	Gas	Water	Gas-oil ratio
	-	-	-	-

Disposition of gas (vented, used on lease or sold) None Producing interval (s) None

INSTRUCTIONS: As provided in KCC Rule 82-2-125, within 90 days after completion of a well, one completed copy of this Drillers Log shall be transmitted to the State Geological Survey of Kansas, 4150 Monroe Street, Wichita, Kansas 67209. Copies of this form are available from the Conservation Division, State Corporation Commission, 3830 So. Meridian (P.O. Box 17027), Wichita, Kansas 66217. Phone AC 316-522-2206. If confidential custody is desired, please note Rule 82-2-125. Drillers Logs will be on open file in the Oil and Gas Division, State Geological Survey of Kansas, Lawrence, Kansas 66044.

DESIGNATE TYPE OF COMP.: OIL, GAS, DRY HOLE, SWDW, ETC.:

Operator

Well No.
1-19

Lease Name
Davis

S 19 T 34S R 27W

WELL LOG

Show all important zones of porosity and contents thereof; cored intervals, and all drill-stem tests, including depth interval tested, cushion used, time tool open, flowing and shut-in pressures, and recoveries.

SHOW GEOLOGICAL MARKERS, LOGS RUN, OR OTHER DESCRIPTIVE INFORMATION.

FORMATION DESCRIPTION, CONTENTS, ETC.	TOP	BOTTOM	NAME	DEPTH
Sand & Shale	Surface	250		
Shale & Lime	250	1000		
Shale	1000	1400		
Anhydrite	1400	1500		
Anhydrite & Salt	1500	2600		
Sands - some shale	2600	3400		
Sand & Shale	3400	3875		
Shale	3875	4500		
Lime	4500	5235		
Sand & Lime	5235	5850		
Shale & Sands	5850	5960		
Lime	5960	6250		

USE ADDITIONAL SHEETS, IF NECESSARY, TO COMPLETE WELL RECORD:

Date Received

[Handwritten Signature]
Signature

Engineer - The Headington Company

Title

May 3, 1974

Date

RECORDED
INDEXED

WELL LOG

15-119-20167-0000

Company SABINE DEVELOPMENT COMPANY
Contractor LEBEN DRILLING, INC.
Farm Davis #1-19
Total Depth 6245'
Commenced 4-16-74
Completed 5-2-74

Sec. 19 T.34S R. 27W
Loc.
County Meade County, Kansas
Casing 8-5/8" @767' w/250 sks
Production

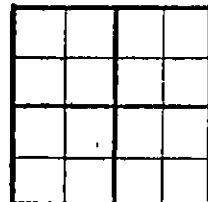

Figures Indicate Bottom of Formations

0	-	401	Red Bed
401	-	750	Red Bed & Sand
750	-	1360	Red Bed
1360	-	1710	Red Bed, Shale, Anhydrite
1710	-	2300	Shale, Anhydrite
2300	-	6245	Lime & Shale

RECEIVED
STATE CORPORATION COMMISSION
MAY 13 1974
CONSERVATION DIVISION
Wichita, Kansas

State of KANSAS
County of MEADE
SS

I, R. T. Houston of Leben Drilling, Inc., upon oath state that the above and foregoing is a true and correct copy of the log of the Davis #1-19 Well.

R. T. Houston
Operations Manager

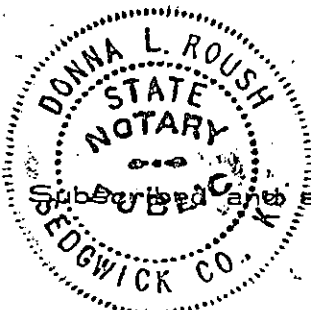

Subscribed and sworn to before me this Eighth day of May, 1974

My Commission Expires: August 30, 1977

Donna L. Roush