

ORIGINAL

FORM MUST BE TYPED

SIDE ONE

STATE CORPORATION COMMISSION OF KANSAS
OIL & GAS CONSERVATION DIVISION
WELL COMPLETION FORM
ACO-1 WELL HISTORY
DESCRIPTION OF WELL AND LEASE

Operator: License # 4549

Name: ANADARKO PETROLEUM CORPORATION

Address P. O. BOX 351

City/State/Zip LIBERAL, KANSAS 67905-0351

Purchaser: ANADARKO ENERGY SERVICES

Operator Contact Person: SHAWN D. YOUNG

Phone (316) 624-6253

Contractor: Name: NA

License: NA

Wellsite Geologist: NA

Designate Type of Completion
 New Well Re-Entry Workover

Oil SWD SLOW Temp. Abd.

Gas ENHR SIGW

Dry Other (Core, WSW, Expl., Cathodic, etc)

If Workover:

Operator: ANADARKO PETROLEUM CORPORATION

Well Name: GOING B-1

Comp. Date 12-14-84 Old Total Depth 5023

Deepening Re-perf. Conv. to Inj/SWD

Plug Back 3448 PBTD

Commingled Docket No. _____

Dual Completion Docket No. _____

Other (SWD or Inj?) Docket No. _____

1-26-98 -- 4-5-98
Spud Date Date Reached TD Completion Date

API NO. 15- 129-20725 - 0002

County MORTON

- - - NW - SE Sec. 35 Twp. 32S Rge. 41 E W

1980 Feet from N (circle one) Line of Section

1980 Feet from W (circle one) Line of Section

Footages Calculated from Nearest Outside Section Corner:
NE, SE, NW or SW (circle one)

Lease Name GOING B Well # 1

Field Name RICHEFIELD

Producing Formation TOPEKA, WABAUNSEE

Elevation: Ground 3415 KB _____

Total Depth 5023 PBTD 3448

Amount of Surface Pipe Set and Cemented at 1466 Feet

Multiple Stage Cementing Collar Used? Yes No

If yes, show depth set _____ Feet

If Alternate II completion, cement circulated from _____

feet depth to _____ w/ _____ sx cmt.

Drilling Fluid Management Plan Re-work, 6-23-98 uc.
(Data must be collected from the Reserve Pit)
NOT APPLICABLE

Chloride content _____ ppm Fluid volume _____ bbls

Dewatering method used _____

Location of fluid disposal if hauled offsite: _____

Operator Name _____

Lease Name _____ License No. _____

_____ Quarter Sec. _____ Twp. _____ S Rng. _____ E/W

County _____ Docket No. _____

INSTRUCTIONS: An original and two copies of this form shall be filed with the Kansas Corporation Commission, 130 S. Market - Room 2078, Wichita, Kansas 67202, within 120 days of the spud date, recompletion, workover or conversion of a well. Rule 82-3-130, 82-3-106 and 82-3-107 apply. Information on side two of this form will be held confidential for a period of 12 months if requested in writing and submitted with the form (see rule 82-3-107 for confidentiality in excess of 12 months). One copy of all wireline logs and geologist well report shall be attached with this form. ALL CEMENTING TICKETS MUST BE ATTACHED. Submit CP-4 form with all plugged wells. Submit CP-111 form with all temporarily abandoned wells.

All requirements of the statutes, rules and regulations promulgated to regulate the oil and gas industry have been fully complied with and the statements herein are complete and correct to the best of my knowledge.

Signature Shawn D. Young
SHAWN D. YOUNG

Title DIVISION PRODUCTION ENGINEER Date 5/27/98

Subscribed and sworn to before me this 27th day of May 19 98.

Notary Public Shirley J. Childers

Date Commission Expires 11/14/98

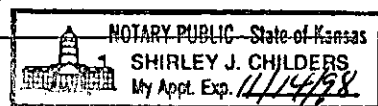

K.C.C. OFFICE USE ONLY
F Letter of Confidentiality Attached
C Wireline Log Received SIGN
C Geologist Report-Received
Distribution
 KCC SWD/Rep NGPA
 KGS Plug Other
(Specify)

SIDE TWO

ORIGINAL

Operator Name ANADARKO PETROLEUM CORPORATION Lease Name GOING B Well # 1

Sec. 35 Twp. 32S Rge. 41 East West
 County MORTON

INSTRUCTIONS: Show important tops and base of formations penetrated. Detail all cores. Report all drill stem tests giving interval tested, time tool open and closed, flowing and shut-in pressures, whether shut-in pressure reached static level, hydrostatic pressures, bottom hole temperature, fluid recovery, and flow rates if gas to surface during test. Attach extra sheet if more space is needed. Attach copy of log.

Drill Stem Tests Taken Yes No
 (Attach Additional Sheets.)
 Samples Sent to Geological Survey Yes No
 Cores Taken Yes No
 Electric Log Run Yes No
 (Submit Copy.)
 List All E.Logs Run:

Log Formation (Top), Depth and Datums Sample
 Name Top Datum

SEE ORIGINAL ACO-1 ATTACHED

** Original Completion		CASING RECORD		<input checked="" type="checkbox"/> New <input type="checkbox"/> Used		Report all strings set-conductor, surface, intermediate, production, etc.	
Purpose of String	Size Hole Drilled	Size Casing Set (In O.D.)	Weight Lbs./Ft.	Setting Depth	Type of Cement	# Sacks Used	Type and Percent Additives
** SURFACE	12-1/4"	8-5/8"	24.0	1466	--	--	
** PRODUCTION	7-7/8"	4-1/2"	10.5	3568	LITEWATE/ 50/50 POZ	50/ 450	10% SALT, .75 CFR-2

ADDITIONAL CEMENTING/SQUEEZE RECORD

Purpose: ___ Perforate ___ Protect Casing ___ Plug Back TD ___ Plug Off Zone	Depth		Type of Cement	#Sacks Used	Type and Percent Additives
	Top	Bottom			

Shots Per Foot	PERFORATION RECORD - Bridge Plugs Set/Type Specify Footage of Each Interval Perforated		Acid, Fracture, Shot, Cement Squeeze Record (Amount and Kind of Material Used) Depth	
	4	3246-3256 (TOPEKA)		ACID W/ 600 GAL 15% FeHCl 3246-3256
	CIBP @ 3448			

TUBING RECORD	Size	Set At	Packer At	Liner Run
	2-3/8	3283		<input type="checkbox"/> Yes <input checked="" type="checkbox"/> No

Date of First, Resumed Production, SWD or Inj. RESUMED: 2-3-98	Producing Method				
	<input type="checkbox"/> Flowing	<input checked="" type="checkbox"/> Pumping	<input type="checkbox"/> Gas Lift	<input type="checkbox"/> Other (Explain)	

Estimated Production Per 24 Hours	Oil Bbls.	Gas Mcf	Water Bbls.	Gas-Oil Ratio	Gravity
	0	265	31		

Disposition of Gas: Vented Sold Used on Lease (If vented, submit ACO-18.)

METHOD OF COMPLETION: Open Hole Perf. Dually Comp. Commingled Other (Specify) _____

Production Interval: 2848-3256 OA

STATE CORPORATION COMMISSION OF KANSAS
OIL & GAS CONSERVATION DIVISION

WELL COMPLETION OR RECOMPLETION FORM
ACO-1 WELL HISTORY

DESCRIPTION OF WELL AND LEASE

Operator: license # 5469
name Anadarko Production Company
address Box 351
City/State/Zip Liberal, Kansas 67901

Operator Contact Person Paul Gatlin
Phone (316) 624-6253

Contractor: license # 5662
name Wakefield Oil Company

Wellsite Geologist Jim D. Crawford
Phone (405) 341-3163
Purchaser To be Determined

Designate Type of Completion
 New Well Re-Entry Workover
 Oil SWD Temp Abd
 Gas Inj Delayed Comp.
 Dry Other (Core, Water Supply etc.)

Old Well Info as follows:
Operator
Well Name
Comp. Date Old Total Depth

WELL HISTORY

Drilling Method: Mud Rotary Air Rotary Cable
10/30/84 11/10/84 12/14/84
Spud Date Date Reached TD Completion Date
5023 3498
Total Depth PBTD

Amount of Surface Pipe Set and Cemented at 1466 feet
Multiple Stage Cementing Collar Used? Yes No
If Yes, Show Depth Set feet

Materialize 2 completion, cement circulated
from feet depth to w/ SX cmt

API NO. 15-129-20,725
County Morton
C NW SE Sec 35 Twp 32S Rge 41 West
1980 Ft North from Southeast Corner of Section
1980 Ft West from Southeast Corner of Section
(Note: locate well in section plat below)
Lease Name Going "B" Well# 1
Field Name Dunkle
Producing Formation Lansing
Elevation: Ground 3418 KB 3426

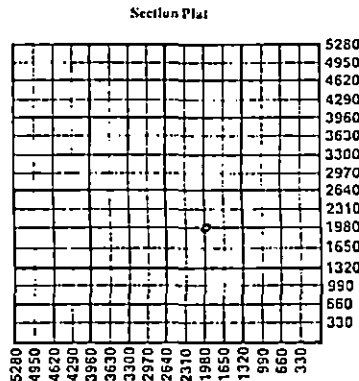

WATER SUPPLY INFORMATION

Source of Water:
Division of Water Resources Permit # Domestic Well
 Groundwater 1980 Ft North From Southeast Corner and
40 Ft West From Southeast Corner of
Sec 35 Twp 32S Rge 41 East West
 Surface Water Ft North From Southeast Corner and
Ft West From Southeast Corner
Sec Twp Rge East West
 Other (explain)
(purchased from city, R.W.D.#)

Disposition of Produced Water: Disposal Repressuring
Docket # To be determined

INSTRUCTIONS: This form shall be completed in duplicate and filed with the Kansas Corporation Commission, 200 Colorado Derby Building, Wichita, Kansas 67202, within 90 days after completion or recompletion of any well. Rules 82-3-130 and 82-3-107 apply.

Information on side two of this form will be held confidential for a period of 12 months if requested in writing and submitted with the form. See rule 82-3-107 for confidentiality in excess of 12 months.

One copy of all wireline logs and drillers time log shall be attached with this form. Submit CP-4 form with all plugged wells. Submit CP-111 form with all temporarily abandoned wells.

All requirements of the statutes, rules, and regulations promulgated to regulate the oil and gas industry have been fully complied with and the statements herein are complete and correct to the best of my knowledge.

Signature Paul Campbell
Title Division Operations Manager Date 12/17/84

Subscribed and sworn to before me this 18th day of December 1984

Notary Public Elizabeth J. Harper
Date Commission Expires 7/26/87

K.C.C. OFFICE USE ONLY
F Letter of Confidentiality Attached
C Wireline Log Received
C Drillers Time Log Received
Distribution: KCC SWD/Rap NGPA
 KGS Plug Other (Specify)

SIDE TWO.

Operator Name Anadarko Produc Co. Lease Name Going "B" Well# 1 SEC. 35 P. 325 RGE. A1 East West
County: Morton

WELL LOG

INSTRUCTIONS: Show important tops and base of formations penetrated. Detail all cores. Report all drill stem tests giving interval tested, time tool open and closed, flowing and shut-in pressures, whether shut-in pressure reached static level, hydrostatic pressures, bottom hole temperature, fluid recovery, and flow rates if gas to surface during test. Attach extra sheet if more space is needed. Attach copy of log.

Drill Stem Tests Taken Yes No
Samples Sent to Geological Survey Yes No
Cores Taken Yes No

Formation Description
 Log Sample

Name	Top	Bottom
Clay & Surface Sand	0'	75'
Sand & Clay	75'	350'
Redbed & Gyp	350'	1067'
Gloretta Sand	1067'	1250'
Redbed & Gyp	1250'	2170'
Shale	2170'	2280'
Shale & Lime	2280'	2505'
Lime & Shale	2505'	5031'
RTD	5031'	

CASING RECORD <input checked="" type="checkbox"/> new <input type="checkbox"/> used							
Report all strings set - conductor, surface, intermediate, production, etc.							
Purpose of string	size hole drilled	size casing set (In O.D.)	weight lbs/ft.	setting depth	type of cement	# sacks used	type and percent additives
Surface	12-1/4	8-5/8	24	1466			
Production	7-7/8	4-1/2	10.5	3568	Litewate 50/50 Poz	50 450	10% Salt .75 CFP-2
PERFORATION RECORD				Acid, Fracture, Shot, Cement Squeeze Record			
shots per foot specify footage of each interval perforated				(amount and kind of material used)			Depth
2 3472-82 3464-68				2/1400 gal. 15% + .35 BS			3472-82 3464-68
TUBING RECORD <input checked="" type="checkbox"/> (Used)							
size 2-3/8		set at 3424		packer at ---		Liner Run <input type="checkbox"/> Yes <input checked="" type="checkbox"/> No	
Date of First Production		Producing method <input checked="" type="checkbox"/> flowing <input type="checkbox"/> pumping <input type="checkbox"/> gas lift <input type="checkbox"/> Other (explain)					
SI WOPL		Oil	Gas	Water	Gas-Oil Ratio	Gravity	
Estimated Production Per 24 Hours		NA	1545 Bbls MCFD	18 Bbls/day	CFPB	---	

Disposition of gas: vented sold used on lease
 METHOD OF COMPLETION open hole perforation other (specify) _____
 Dually Completed. Commingled
 PRODUCTION INTERVAL 3464-82 OA