

15-119-10279-0000

STATE OF KANSAS
STATE CORPORATION COMMISSION

WELL PLUGGING RECORD

Give All Information Completely
Make Required Affidavit
Mail or Deliver Report to:
Conservation Division
State Corporation Commission
211 No. Broadway
Wichita, Kansas

MEADE

County. Sec. 9 Twp. 34 Rge. 26 (E) W (W)

Location as "NE/CNW/SW" or footage from lines E/2 E/2 SE

Lease Owner PETROLEUM, INC.

Lease Name HARRINGTON GAS UNIT Well No. 1

Office Address ROUTE 2, GREAT BEND, KANSAS

Character of Well (completed as Oil, Gas or Dry Hole) DRY HOLE

Date well completed April 9, 19 58

Application for plugging filed April 10, 19 58

Application for plugging approved April 9, 19 58

Plugging commenced April 9, 19 58

Plugging completed April 9, 19 58

Reason for abandonment of well or producing formation

No Producing Zones

If a producing well is abandoned, date of last production None 19

Was permission obtained from the Conservation Division or its agents before plugging was commenced? Yes

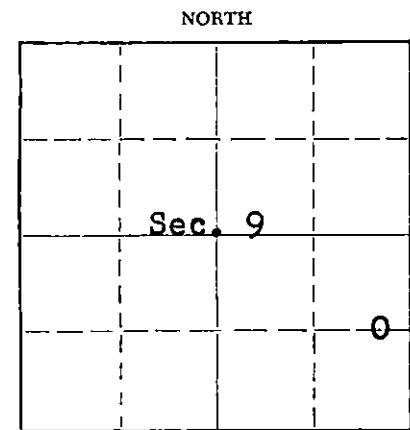

Locate well correctly on above
Section Plat

Name of Conservation Agent who supervised plugging of this well Merle H. Rives, Box 8, Pratt, Kansas

Producing formation ----- Depth to top --- Bottom ----- Total Depth of Well 6045 Feet

Show depth and thickness of all water, oil and gas formations.

OIL, GAS OR WATER RECORDS

CASING RECORD

FORMATION	CONTENT	FROM	TO	SIZE	PUT IN	PULLED OUT
				8-5/8"	1255'	None

Describe in detail the manner in which the well was plugged, indicating where the mud fluid was placed and the method or methods used in introducing it into the hole. If cement or other plugs were used, state the character of same and depth placed, from _____ feet to _____ feet for each plug set.

Mud up with heavy mud to 1250' pushed down 1/3 sack hulls to 1250' followed by wooden plug. Placed 20 sacks cement on top of plug. Mud up to 400' and pushed down 1/3 sack hulls to 400' followed by wooden plug. Placed 20 sacks cement on top of plug. Mud up to 40' and placed 1/3 sack hulls at 40' followed by wooden plug and 10 sacks cement to base of well cellar.

STATE CORPORATION COMMISSION
APR 17 1958
CONSERVATION DIVISION
Wichita, Kansas

(If additional description is necessary, use BACK of this sheet)
Name of Plugging Contractor GARVEY DRILLING COMPANY
Address ROUTE 2, GREAT BEND, KANSAS

STATE OF KANSAS, COUNTY OF BARTON, ss.
Don Searle (employee of owner) or ~~(owner)~~ of the above-described well, being first duly sworn on oath, says: That I have knowledge of the facts, statements, and matters herein contained and the log of the above-described well as filed and that the same are true and correct. So help me God.

(Signature) Don Searle
Route 2, Great Bend, Kansas
(Address)

SUBSCRIBED AND SWORN to before me this 16th day of April, 19 58

Ed J. Brown
Notary Public.

My commission expires July 11, 1960

PLUGGING
FILE SEC 9 T. 34 R. 26
BOOK PAGE 92 LINE 13

WELL LOG

COMPANY PETROLEUM, INCORPORATED

SEC. 9 T. 34S R. 26W

FARM HARRINGTON GAS UNIT NO. 1

Loc. Approx. C-E/2, E/2, SE

TOTAL DEPTH 6045'

COUNTY MEADE CO., KANSAS

COMM. March 18, 1958

COMP. April 9, 1958

CONTRACTOR GARVEY DRILLING COMPANY

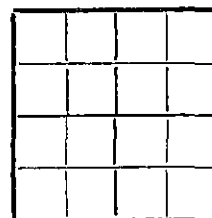

CASING 8 5/8" @ 1255' W/700 sax.

ELEVATION 2290' DF

PRODUCTION D & A

FIGURES INDICATE BOTTOM OF FORMATIONS

130	Surface clay & shells
355	Red bed
380	Sand
480	Red bed & shells
675	Red bed & gypsum
790	Red bed & shale
850	Shale & sand
1000	Shale & shells w/sand streaks
1058	Red bed & shells
1220	Red bed & anhydrite
1260	Red bed & gypsum
1580	Shale & shells
2180	Shale & anhydrite
2720	Lime & shale
2865	Shale & shells
2905	Lime & shale
2917	Chalk
3152	Lime & shale
3314	Lime, shale & chalk
3845	Chalky lime & shale streaks
4080	Shale & lime
4189	Lime
4500	Shale & lime
4592	Lime
4730	Lime & shale
4815	Chalky lime
4855	Lime, shalk & shale
4948	
4948	Lime & shale
5045	Lime
5085	Lime & shale
5127	Lime
5175	Shale
5236	Lime & shale
5238	Lime
5315	Shale
5364	Lime
5424	Lime & shale
	Lime
	Lime & shale
	Morrow sand
	Shale & lime

PLUGGING
 FILE SEC. 9 T. 34 R. 26 W.
 BOOK PAGE 92 LINE 43

RECEIVED
STATE CORPORATION COMMISSION

APR 17 1958

CONSERVATION DIVISION
Wichita, Kansas

State of KANSAS }
 County of BARTON } ss: 5830
 5849
 5856
 6045

I, VERNE A. MORRIS of GARVEY DRILLING CO.

upon oath state that the above and foregoing is a true and correct copy of the log of the #1 HARRINGTON GAS UNIT well

Verne A. Morris

Subscribed and sworn to before me this 15th day of April 19 58

My Commission Expires: July 11, 1960

Jed T. Brown
NOTARY PUBLIC