

STATE OF KANSAS  
STATE CORPORATION COMMISSION

WELL PLUGGING RECORD

Give All Information Completely  
Make Required Affidavit  
Mail or Deliver Report to:  
Conservation Division  
State Corporation Commission  
211 No. Broadway  
Wichita, Kansas

Meade County. Sec. 15 Twp. 34 Rge. 26 (E) W (W)  
Location as "NE/CNW4SW4" or footage from lines Approx. C SE  
Lease Owner Petroleum, Inc.  
Lease Name Harrington "B" Gas Unit Well No. 1  
Office Address Route 2, Great Bend, Kansas  
Character of Well (completed as Oil, Gas or Dry Hole) Dry hole  
Date well completed May 5 19 58  
Application for plugging filed May 6 19 58  
Application for plugging approved May 5 19 58  
Plugging commenced May 5 19 58  
Plugging completed May 5 19 58  
Reason for abandonment of well or producing formation No producible zones

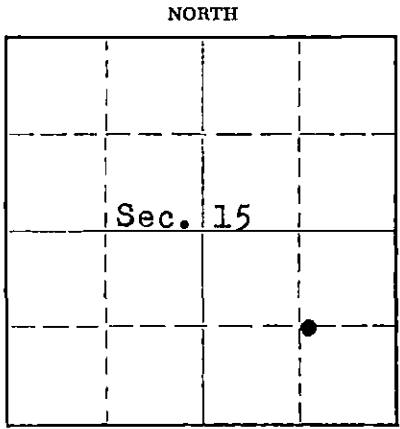

Locate well correctly on above Section Plat

If a producing well is abandoned, date of last production none 19  
Was permission obtained from the Conservation Division or its agents before plugging was commenced? Yes

Name of Conservation Agent who supervised plugging of this well M.A. Rives  
Producing formation ----- Depth to top --- Bottom --- Total Depth of Well 6040 Feet  
Show depth and thickness of all water, oil and gas formations.

OIL, GAS OR WATER RECORDS

CASING RECORD

FORMATION	CONTENT	FROM	TO	SIZE	PUT IN	PULLED OUT
				8 5/8"	870'	None

Describe in detail the manner in which the well was plugged, indicating where the mud fluid was placed and the method or methods used in introducing it into the hole. If cement or other plugs were used, state the character of same and depth placed, from \_\_\_\_\_ feet to \_\_\_\_\_ feet for each plug set.

Mud up with heavy mud to 500' followed by wooden plug, pushed down 1/3 sack hulls on top of plug. Placed 20 sacks cement through drill pipe on top of plug. Mud up to 35' followed by wooden plug and 1/3 sack hulls. Cement to base of well cellar with 10 sacks cement.

RECEIVED  
MAY 10 1960

MAY 10 1960 5-10-60

CONSERVATION DIVISION  
Wichita, Kansas

(If additional description is necessary, use BACK of this sheet)

Name of Plugging Contractor Garvey Drilling Co.  
Address Great Bend, Kansas

STATE OF Kansas COUNTY OF Barton ss.  
Don Searle (employee of owner) or (owner or operator) of the above-described well, being first duly sworn on oath, says: That I have knowledge of the facts, statements, and matters herein contained and the log of the above-described well as filed and that the same are true and correct. So help me God.

(Signature) Don Searle  
Route 2, Great Bend, Kansas (Address)

SUBSCRIBED AND SWORN TO before me this 9th day of May 19 58  
Notary Public.

My commission expires July 11, 1960

PLUGGING  
FILE SEC 15 T 34 R 26  
BOOK PAGE 99 LINE 34

# WELL LOG

15-119-10278-0000

COMPANY PETROLEUM, INCORPORATED

SEC. 15 T. 34S R. 26W

FARM HARRINGTON GAS UNIT NO. "B"-1

LOC. Approx. C-SE/4

TOTAL DEPTH 6040'

COUNTY MEADE CO., KANSAS

COMM. April 11, 1958

COMP. May 5, 1958

CONTRACTOR GARVEY DRILLING COMPANY

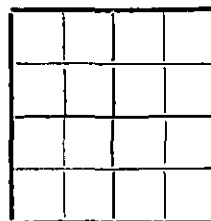

CABING 8 5/8" @ 870' W/475 sax.

ELEVATION 2204' DF

PRODUCTION D & A

FIGURES INDICATE BOTTOM OF FORMATIONS

RECEIVED  
STAT

MAY 10 1958

CONSERVATION DIVISION  
Wichita, Kansas

60	Surface clay & gyp
255	Red bed & shells
290	Sand
490	Shale & gyp
870	Red bed, shells & sand streaks
1385	Red bed & gyp
1735	Red bed & anhydrite
2428	Lime & shale
2578	Lime
2842	Lime & shale
2880	Chalky lime & shale
3070	Lime & shale
3230	Sand, shale & lime streaks
3515	Chalky lime & shale
4735	Lime & shale
4800	Lime
5030	Lime & shale
5044	Lime
5060	Sandy lime & shale
5180	Lime & shale
5240	Sand & shale
5625	Lime & sandy shale
5675	Lime
5752	Lime
5833	Sand & shale
6005	Chert & lime
6040	Lime
6040	T. D.

State of KANSAS }  
County of BARTON } ss:

I, VERNE A. MORRIS of GARVEY DRILLING COMPANY

upon oath state that the above and foregoing is a true and correct copy of the log of the #1 HARRINGTON GU "B" well

Subscribed and sworn to before me this 8th day of May 19 58

My Commission Expires: July 11, 1960

Verne A. Morris  
Notary Public

PLUGGING  
FILE SEC 5 T. 34 R. 26 W  
BOOK PAGE 99 LINE 34