

Give All Information Completely
Make Required Affidavit
Mail or Deliver Report to:
Conservation Division
State Corporation Commission
212 No. Market
Wichita, Kansas

WELL PLUGGING RECORD

Meade County. Sec. 5 Twp. 35S Rge. 30W (E) (W)

Location as "NE/CNW/SW" or footage from lines C/SW 1/4 - NE 1/4
Lease Owner Horizon Oil & Gas Co.
Lease Name Adams "B" Well No. 1-5
Office Address P.O. Box #7, Spearman, Texas 79081
Character of Well (completed as Oil, Gas or Dry Hole) Dry Hole
Date well completed June 3, 1967
Application for plugging filed August 11, 1967
Application for plugging approved August 15, 1967
Plugging commenced August 30, 1967
Plugging completed August 31, 1967
Reason for abandonment of well or producing formation Dry Hole

NORTH

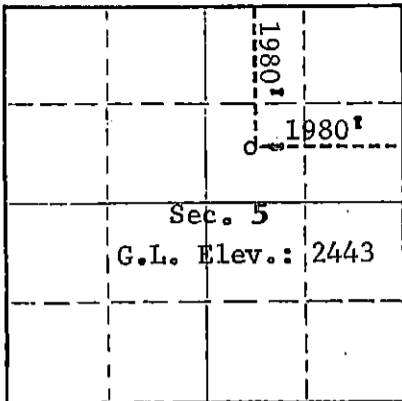

Locate well correctly on above
Section Plat

If a producing well is abandoned, date of last production None
Was permission obtained from the Conservation Division or its agents before plugging was commenced? Yes

Name of Conservation Agent who supervised plugging of this well Edgar J. Eves, Box F, Sublette, Kansas 67877
Producing formation None Depth to top ** Bottom ** Total Depth of Well 6320 Feet
Show depth and thickness of all water, oil and gas formations.

OIL, GAS OR WATER RECORDS

CASING RECORD

FORMATION	CONTENT	FROM	TO	SIZE	PUT IN	PULLED OUT
				8-5/8"	1360	N O N E
				4-1/2"	6310	4955
Basal Chester Sand	Water	5993	6012			
St. Louis	Water	6154	6223			

Describe in detail the manner in which the well was plugged, indicating where the mud fluid was placed and the method or methods used in introducing it into the hole. If cement or other plugs were used, state the character of same and depth placed, from surface feet to 6144 feet for each plug set.

Set 15 sack plug from 5960' to 6144'
Spotted 40 sack plug from 600' to 700'
Spotted 5 sack cement from 5' to 20'
Welded on cap.
Well D & A

RECEIVED
STATE CORPORATION COMMISSION

SEP 6 1967

RECEIVED
STATE CORPORATION COMMISSION

CONSERVATION DIVISION
Wichita, Kansas

SEP 11 1967

CONSERVATION DIVISION
Wichita, Kansas

(If additional description is necessary, use BACK of this sheet)

Name of Plugging Contractor Daco Lease & Well Service (License No. 138)
Address Borger, Texas

STATE OF Texas, COUNTY OF Hansford, ss.
Everett R. Tracy (employee of owner) or (~~conservation operator~~) of the above-described well, being first duly sworn on oath, says: That I have knowledge of the facts, statements, and matters herein contained and the log of the above-described well as filed and that the same are true and correct. So help me God.

(Signature) Everett R. Tracy
P.O. Box #7, Spearman, Texas 79081
(Address)

SUBSCRIBED AND SWORN to before me this 5th day of September, 19 67

My commission expires June 1, 1969

Jessie Garcia
Notary Public.
Hansford County, Texas