

STATE OF KANSAS  
STATE CORPORATION COMMISSION

WELL PLUGGING RECORD

Give All Information Completely  
Make Required Affidavit  
Mail or Deliver Report to  
Conservation Division  
State Corporation Comm.  
245 North Water  
Wichita, KS 67202

Seward County, Sec. 15 Twp. 34S Rge. 34 E/W  
Location as "NE/CNW $\frac{1}{4}$ SW $\frac{1}{4}$ " or footage from lines  
C SW SE

Lease Owner Anadarko Production Company  
Lease Name SUMMERS TRUST "A" Well No. 1  
Office Address P. O. Box 351, Liberal, KS 67901  
Character of Well (Completed as Oil, Gas or Dry Hole)

DRY HOLE

Date Well completed March 3 19 81  
Application for plugging filed January 26 19 81  
Application for plugging approved February 13 19 81  
Plugging commenced March 3 19 81  
Plugging completed March 3 19 81  
Reason for abandonment of well or producing formation

DRY HOLE

If a producing well is abandoned, date of last production 19

Was permission obtained from the Conservation Division or its agents before plugging was commenced? yes

Name of Conservation Agent who supervised plugging of this well Clarence Thomas  
Producing formation Lower Morrow Depth to top 6114 Bottom 6120 Total Depth of Well 6580  
Show depth and thickness of all water, oil and gas formations.

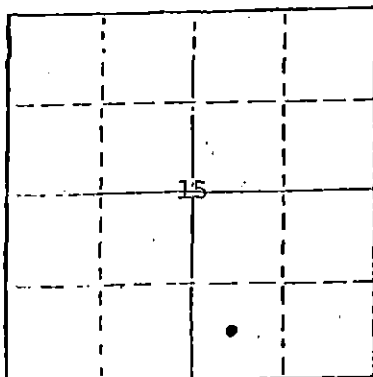

Locate well correctly on above Section Plat

OIL, GAS OR WATER RECORDS

CASING RECORD

FORMATION	CONTENT	FROM	TO	SIZE	PUT IN	PULLED OUT
Lower Morrow	DRY	6114	6120	8-5/8"	1687'	None
				4-1/2"	6270'	4500'

Describe in detail the manner in which the well was plugged, indicating where the mud fluid was placed and the method or methods used in introducing it into the hold. If cement or other plugs were used, state the character of same and depth placed, from feet to feet for each plug set.

P&A'd as follows: 30 sxs cmt & 2 sxs hulls at TD, spot mud from cement plug to 1720, spot 50 sxs cement @ 1720, spot mud from cement plug to 800, spot 25 sxs cement @ 800, spot mud from cement plug to 40, spot 10 sxs cement from 40' surface, cut 8-5/8 casing and cap well.

RECEIVED  
STATE CORPORATION COMMISSION  
6-1-81  
JUN - 1 1981

(If additional description is necessary, use BACK of this sheet)  
Name of Plugging Contractor Sargents Casing Pulling Service  
Conservation Division  
Wichita Kansas

STATE OF KANSAS COUNTY OF SEWARD, ss.  
Paul Campbell (employee of owner) or (owner or operator)

of the above-described well, being first duly sworn on oath, says: That I have knowledge of the facts, statements, and matters herein contained and the log of the above-described well as filed and that the same are true and correct. So help me God.

(Signature) Paul Campbell  
P. O. Box 351, Liberal, Kansas 67901  
(Address)

SUBSCRIBED AND SWORN TO before me this 28th day of May, 1981

Beverly J. Williams  
Notary Public.

My commission expires November 21, 1982

NOTARY PUBLIC  
KANSAS  
BEVERLY J. WILLIAMS  
Seward County, Kansas  
My Appt. Exp. 11/21/82

15-175-20451-0000

KANSAS

WELL COMPLETION REPORT AND  
DRILLER'S LOG

S. 15 T. 34S R. 34 E  
W

Loc. C SW SE

County Seward

API No. 15 — 175 — 20,451  
County Number

Operator

Anadarko Production Company

Address

P. O. Box 351, Liberal, Kansas 67901

Well No.

1

Lease Name

SUMMERS TRUST "A"

Footage Location

600 feet from (N) (S) line 1980 feet from (E) (W) line

Principal Contractor

Lohmann-Johnson

Geologist

Joseph G. Blair, Jr.

Spud Date

2/19/80

Date Completed

2/19/80

Total Depth

6580'

P.B.T.D.

Surface

Directional Deviation

not applicable; JUN

Oil and/or Gas Purchaser

DRY HOLE

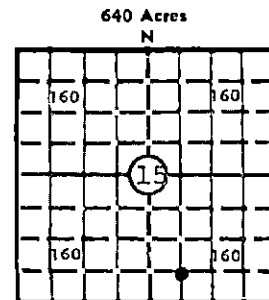

Elev.: Gr. 2937'

DF 2947' KB 2948'

CASING RECORD

Report of oil strings set at surface, intermediate, production, etc.

Purpose of string	Size hole drilled	Size casing set (in O.D.)	Weight lbs/ft.	Setting depth	Type cement	Sacks	Type and percent additives
Surface	12-1/4"	8-5/8"	24#	1687'	SS Pozmix Common	500 200	4% Gel 2% CaCl 2% CaCl
Production	7-7/8"	4-1/2"	10.5#	6270'	SS Pozmix	150	Salt Saturated

LINER RECORD

PERFORATION RECORD

Top, ft.	Bottom, ft.	Sacks cement	Shots per ft.	Size & type	Depth interval
			2	.46 jet	6114-20'

TUBING RECORD

Size	Setting depth	Packer set at
none		

ACID, FRACTURE, SHOT, CEMENT SQUEEZE RECORD

Amount and kind of material used	Depth interval treated
A/1000 gals 7-1/2% FE acid w/500 SCF N2/BBL	6114-20
F/22000 gals foamed 2% KCl water + 20,000# 20-40 sand	6114-20
A/4000 gals 2% HCl, 190,000 SCF N2	6114-20

INITIAL PRODUCTION

Date of first production	Producing method (flowing, pumping, gas lift, etc.)				
DRY HOLE					
RATE OF PRODUCTION PER 24 HOURS	Oil	Gas	Water	Gas-oil ratio	
	bbls.	MCF	bbls.	CFPB	
Disposition of gas (vented, used on lease or sold)			Producing interval (s)		

INSTRUCTIONS: As provided in KCC Rule 82-2-125, within 90 days after completion of a well, one completed copy of this Drillers Log shall be transmitted to the State Geological Survey of Kansas, 4150 Monroe Street, Wichita, Kansas 67209. Copies of this form are available from the Conservation Division, State Corporation Commission, 245 No. Water, Wichita, Kansas 67202. Phone AC 316-522-2206. If confidential custody is desired, please note Rule 82-2-125. Drillers Logs will be an open file in the Oil and Gas Division, State Geological Survey of Kansas, Lawrence, Kansas 66044.

Operator Anadarko Production Company		DESIGNATE TYPE OF COMP.: OIL, GAS, DRY HOLE, SWDW, ETC.:
Well No. 1	Lease Name SUMMERS TRUST "A"	DRY HOLE
S 15 T 34S R 34 <del>W</del> <sup>E</sup>		

**WELL LOG**

Show all important zones of porosity and contents thereof; cored intervals, and all drill-stem tests, including depth interval tested, cushion used, time tool open, flowing and shut-in pressures, and recoveries.

SHOW GEOLOGICAL MARKERS, LOGS RUN, OR OTHER DESCRIPTIVE INFORMATION.

FORMATION DESCRIPTION, CONTENTS, ETC.	TOP	BOTTOM	NAME	DEPTH
Sand and Redbed	0'	830'		
Redbed, Sand, Shale	830'	1682'		
Anhydrite	1682'	1692'		
Shale	1692'	2366'		
Lime and Shale	2366'	6570'		
TD		6570'		

USE ADDITIONAL SHEETS, IF NECESSARY, TO COMPLETE WELL RECORD.

Date Received	
	Signature
	Paul Campbell, Division Production Manager
	Title
	May 22, 1981
	Date