

STATE OF KANSAS
STATE CORPORATION COMMISSION

WELL PLUGGING RECORD

Give All Information Completely
Make Required Affidavit
Mail or Deliver Report to
Conservation Division
State Corporation Comm.
245 North Water
Wichita, KS 67202

Seward County, Sec. 15 Twp. 34S Rge. 34 ~~EW~~W
Location as "NE/CNW $\frac{1}{4}$ SW $\frac{1}{4}$ " or footage from lines
C NE NW

Lease Owner Anadarko Production Company
Lease Name ALBRIGHT "A" Well No. 1
Office Address P. O. Box 351, Liberal, Kansas 67901
Character of Well (Completed as Oil, Gas or Dry Hole)
DRY HOLE

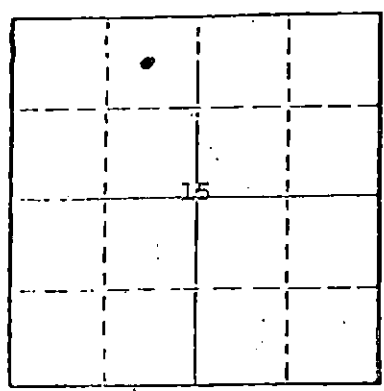

Locate well correctly on above
Section Plot

Date Well completed 5/20 1980
Application for plugging filed 6/20 1980
Application for plugging approved verbal 5/20 1980
Plugging commenced 5/20 1980
Plugging completed 5/20 1980

Reason for abandonment of well or producing formation
DRY HOLE
If a producing well is abandoned, date of last production 19

Was permission obtained from the Conservation Division or
its agents before plugging was commenced? yes

Name of Conservation Agent who supervised plugging of this well Bill Owens
Producing formation _____ Depth to top _____ Bottom _____ Total Depth of Well 6550
Show depth and thickness of all water, oil and gas formations.

OIL, GAS OR WATER RECORDS

CASING RECORD

FORMATION	CONTENT	FROM	TO	SIZE	PUT IN	PULLED OUT
				8-5/8"	1658'	-0-

Describe in detail the manner in which the well was plugged, indicating where the mud fluid
was placed and the method or methods used in introducing it into the hold. If cement or other
plugs were used, state the character of same and depth placed, from _____ feet to
_____ feet for each plug set.

Spotted 50 sxs cmt @ 2700', 50 sxs @ 1640', 12 sxs 40-3', 5 sxs rathole, 3 sxs mousehole,
w/hvy mud between all plugs.

JUN 25 1980
6-25-80
CONSERVATION DIVISION
Wichita, Kansas

(If additional description is necessary, use BACK of this sheet)

Name of Plugging Contractor Lohmann-Johnson Drilling Co., Inc.

STATE OF KANSAS COUNTY OF SEWARD, ss.
Paul Campbell (employee of owner) or ~~XXXXXXXXXXXXXXXXXX~~

of the above-described well, being first duly sworn on oath, says: That I have knowledge of
the facts, statements, and matters herein contained and the log of the above-described well
as filed and that the same are true and correct. So help me God.

(Signature) *Paul Campbell*

(Address)

SUBSCRIBED AND SWORN TO before me this 20th day of June, 19 80

STATE NOTARY PUBLIC
BEVERLY J. WILLIAMS
Seward County, Kansas
My Appt. Exp. 11/21/82

Beverly J. Williams
Notary Public.

My commission expires November 21, 1982

15-175-20467-0000

KANSAS

WELL COMPLETION REPORT AND DRILLER'S LOG

S. 15 T. 34S R. 34 W

Loc. C NE NW

County Seward

API No. 15 — 175 — 20,467
County Number

Operator
Anadarko Production Company

Address
P. O. Box 351, Liberal, Kansas 67901

Well No. 1 Lease Name ALBRIGHT "A"

Footage Location
660 feet from (N) line 1980 feet from (W) line

Principal Contractor Lohmann-Johnson Drlg. Co. Geologist Joe Blair

Spud Date 5/8/80 Date Completed 5/20/80 Total Depth 6550' P.B.T.D.

Directional Deviation Oil and/or Gas Purchaser DRY HOLE

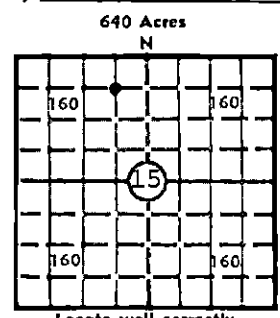

Locate well correctly
Elev.: Gr. 2914'
DF 2924' KB 2925'

CASING RECORD

Report of all strings set — surface, intermediate, production, etc.

Purpose of string	Size hole drilled	Size casing set (in O.D.)	Weight lbs/ft.	Setting depth	Type cement	Sacks	Type and percent additives
Surface	12-1/4"	8-5/8"	24#	1658'	Pozmix Common	600 200	4% gel 3% CaCl

LINER RECORD

PERFORATION RECORD

Top, ft.	Bottom, ft.	Sacks cement	Shots per ft.	Size & type	Depth interval

Size	Setting depth	Packer set at

ACID, FRACTURE, SHOT, CEMENT SQUEEZE RECORD

Amount and kind of material used	Depth interval treated

INITIAL PRODUCTION

JUN 23 1980

Date of first production DRY HOLE	Producing method (flowing, pumping, gas lift, etc.)			
RATE OF PRODUCTION PER 24 HOURS	Oil bbls.	Gas MCF	Water bbls.	Gas-oil ratio CFPB
Disposition of gas (vented, used on lease or sold)			Producing interval(s)	

INSTRUCTIONS: As provided in KCC Rule 82-2-125, within 90 days after completion of a well, one completed copy of this Drillers Log shall be transmitted to the State Geological Survey of Kansas, 4150 Monroe Street, Wichita, Kansas 67209. Copies of this form are available from the Conservation Division, State Corporation Commission, 245 No. Water, Wichita, Kansas 67202. Phone AC 316-522-2206. If confidential custody is desired, please note Rule 82-2-125. Drillers Logs will be on open file in the Oil and Gas Division, State Geological Survey of Kansas, Lawrence, Kansas 66044.

Operator
Anadarko Production Company

DESIGNATE TYPE OF COMP.: OIL, GAS,
DRY HOLE, SWDW, ETC.:

Well No. 1 Lease Name ALBRIGHT "A" DRY HOLE

S 15 T 34S R 34 ~~E~~ W

WELL LOG

Show all important zones of porosity and contents thereof; cored intervals, and all drill-stem tests, including depth interval tested, cushion used, time tool open, flowing and shut-in pressures, and recoveries.

SHOW GEOLOGICAL MARKERS, LOGS RUN, OR OTHER DESCRIPTIVE INFORMATION.

FORMATION DESCRIPTION, CONTENTS, ETC.	TOP	BOTTOM	NAME	DEPTH
Surface	0'	156'	LOGS: Schlumberger Dual Induction-SFL Compensated Neutron- Formation Density	
Surface and Redbed	156'	1038'		
Glorietta Sand	1038'	1257'		
Shale	1257'	1508'		
Anhydrite	1508'	1518'		
Shale	1518'	2770'		
Lime and Shale	2770'	5870'		
Shale	5870'	6010'		
Lime	6010'	6200'		

USE ADDITIONAL SHEETS, IF NECESSARY, TO COMPLETE WELL RECORD.

Date Received

Paul Campbell
Signature

Paul Campbell, Division Production Manager
Title

June 20, 1980
Date