

WELL PLUGGING RECORD

Give All Information Completely
Make Required Affidavit
Mail or Deliver Report to:
Conservation Division
State Corporation Commission
800 Bittling Building
Wichita, Kansas

NORTH

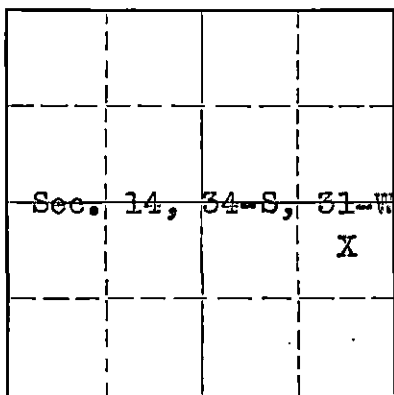

Locate well correctly on above
Section Plat

Seward County. Sec. 14 Twp. 34 Rge. 31 (E) (W)
Location as "NE/CNW/SW" or footage from lines G NE/4 SE/4
Lease Owner LANSEKAN COMPANY, INC.
Lease Name E. Keating Well No. 1
Office Address 714 West Olympic Blvd., Los Angeles 15, Calif.
Character of Well (completed as Oil, Gas or Dry Hole) Dry Hole
Date well completed January 3, 1953 19
Application for plugging filed January 3, 1953 19
Application for plugging approved January 3, 1953 19
Plugging commenced January 4, 1953 19
Plugging completed January 5, 1953 19
Reason for abandonment of well or producing formation Dry Hole

If a producing well is abandoned, date of last production 0 19
Was permission obtained from the Conservation Division or its agents before plugging was commenced? Yes

Name of Conservation Agent who supervised plugging of this well Mr. M. Rives
Producing formation None Depth to top - Bottom - Total Depth of Well 6,140 Feet
Show depth and thickness of all water, oil and gas formations.

OIL, GAS OR WATER RECORDS

CASING RECORD

Formation	Content	From	To	Size	Put In	Pulled Out
Sand	Water	0'	490'	13-3/8"	629.46'	0'
				8-5/8"	2570.76'	1473'
No oil or gas formations found.						

Describe in detail the manner in which the well was plugged, indicating where the mud fluid was placed and the method or methods used in introducing it into the hole. If cement or other plugs were used, state the character of same and depth placed, from _____ feet to _____ feet for each plug set.

Plugged back from 6,140' to 600'. Cemented by Halliburton through drill pipe.
Cement plug: 600' - 563'; heavy drilling mud from 563' to 41', through drill pipe; cement plug 41' to 4', through drill pipe by Halliburton.

(If additional description is necessary, use BACK of this sheet)

Name of Plugging Contractor Midwestern Drillers
Address 324 Wright Bldg., Tulsa, Oklahoma

STATE OF Kansas, COUNTY OF Seward, ss.
W. H. Riggins (employee of owner) or (owner or operator) of the above-described well, being first duly sworn on oath, says: That I have knowledge of the facts, statements, and matters herein contained and the log of the above-described well as filed and that the same are true and correct. So help me God.

(Signature) W. H. Riggins
1020 N. Prospect, Liberal, Kansas
(Address)

SUBSCRIBED AND SWORN to before me this 12th day of January, 1953
Lowella Sturdivant
Notary Public.

My commission expires November 16, 1953

23-8390-s 6-51-20M

PLUGGING
FILE SEC 14 T34 R 312A
BOOK PAGE 71 JAN 12 1953

STATE CORPORATION COMMISSION
JAN 12 1953
CONSERVATION DIVISION
Wichita, Kansas

WELL LOG

15-175-00076-00-00

LANSEKAN COMPANY, INC.

E. Keating #1

C NE SE Sec. 14, 31-S, 31-W

Seward County, Kansas

Drilling Contractor:

Midwestern Drillers

324 Wright Bldg.,

Tulsa, Oklahoma

0'	- 490'	Sand and yellow clay
490'	- 610'	Red clay, sand streaks
610'	- 683'	Red Bed
683'	-1195'	Shale and gypsum
1195'	-1471'	Red Beds, shale
1471'	-2375'	Shale and shells
2375'	-2530'	Shale and lime streaks
2530'	-2680'	Lime
2680'	-2920'	Lime and shale
2920'	-2947'	Lime
2947'	-3120'	Lime and shale
3120'	-3250'	Lime
3250'	-4452'	Lime and shale
4452'	-4497'	Lime
4497'	-4720'	Lime and shale
4720'	-4755'	Lime
4755'	-5084'	Lime and shale
5084'	-5115'	Lime
5115'	-5165'	Lime and shale
5165'	-5205'	Lime
5205'	-5250'	Lime and shale
5250'	-5350'	Lime
5350'	-5375'	Lime and shale
5375'	-5434'	Sand and Shale
5434'	-5510'	Shale and lime
5510'	-5545'	Lime
5545'	-5965'	Lime and shale
5965'	-5973'	Lime
5973'	-6003'	Lime and chert
6003'	-6031'	Lime
6031'	-6095'	Lime and shale
6095'	-6150'	Lime (T.D.)

NOTE:

Above depths based on Drillers' K.B. measurements.

K.B. - 10.0' above G.L.

G.L. - 2589'

PLUGGINGFILE sec 14 7 34 R 31 W
BOOK PAGE 21 LINE 10STATE COMMISSION
JAN 13 1934
CONSERVATION DIVISION
Wichita, Kansas