

STATE OF KANSAS
STATE CORPORATION COMMISSION
200 Colorado Derby Building
Wichita, Kansas 67202

WELL PLUGGING RECORD
K.A.R.-82-3-117

API NUMBER 15-129, 20,458 -0000

LEASE NAME INTERSTATE "B"

WELL NUMBER 6

TYPE OR PRINT
NOTICE: Fill out completely
and return to Cons. Div.
office within 30 days.

1320 Ft. from S Section Line

3960 Ft. from E Section Line

LEASE OPERATOR ANADARKO PETROLEUM CORPORATION

SEC. 17 TWP. 34S RGE. 43 (E) or (W)

ADDRESS P. O. BOX 351, LIBERAL, KANSAS 67905-0351

COUNTY MORTON

PHONE# (316) 624-6253 OPERATORS LICENSE NO. 4549

Date Well Completed 12/18/80

Character of Well GAS

Plugging Commenced 3/17/95

(Oil, Gas, D&A, SWD, Input, Water Supply Well)

Plugging Completed 3/18/95

The plugging proposal was approved on 3/18/95 (date)

by GLENN BARLOW (KCC District Agent's Name).

Is ACO-1 filled? DRILLERS LOG FILED If not, Is well log attached?

Producing Formation NONE Depth to Top Bottom T.D. 1335

Show depth and thickness of all water, oil and gas formations.

OIL, GAS OR WATER RECORDS

CASING RECORD

Formation	Content	From	To	Size	Put In	Pulled out
				8 5/8	368	3'
				4 1/2	1334	NONE

Describe in detail the manner in which the well was plugged, indicating where the mud fluid was placed and the method or methods used in introducing it into the hole. If cement or other plugs were used, state the character of same and depth placed, from feet to feet each set.
MIRU PLUGGERS, CIRC HOLE W/MUD. MIX 1 SK HULLS W/20 SXS CMT & SPOT ACROSS PERFS FROM 1242-1042' PULL TBG TO 40' & SPOT 5 SXS FROM 40-0'. CUT OFF 8 5/8" & 4 1/2" CSG 3' BELOW GL & CAP. WITNESSED BY KCC REP - GLENN BARLOW. RESTORE LOCATION.

(If additional description is necessary, use BACK of this form.)

Name of Plugging Contractor SARGENT & HORTON PLUGGING, INC. License No. 31151

Address RT. 1, BOX 49BA, TYRONE, OK 73951-9731 (405) 854-6515

RECEIVED
STATE CORPORATION COMMISSION

NAME OF PARTY RESPONSIBLE FOR PLUGGING FEES: ANADARKO PETROLEUM CORPORATION

MAR 9 1995

STATE OF KANSAS COUNTY OF SEWARD

LESLIE I. BARNES, SR TECHNICAL ASSISTANT (Employee of Operator) of above-described well, being first duly sworn on oath, says: That I have knowledge of the facts, statements, and matters herein contained and the log of the above-described well as filed that the same are true and correct, so help me God.

(Signature) Leslie I. Barnes

(Address) P. O. BOX 351, LIBERAL, KS 67905-0351

SUBSCRIBED AND SWORN TO before me this 28 day of March, 1995

My Commission Expires:

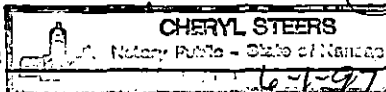

Notary Public

15-129-20458-0000

KANSAS

WELL COMPLETION REPORT AND DRILLER'S LOG

API No. 15 — 129 — 20,458
 County Number

RECEIVED
 KANSAS CORPORATION COMMISSION

S. 17 T. 34S R. 43 ^{NE} W
 Loc. C SW/4
 County Morton

Operator
 Anadarko Production Company

JAN 18 1995

Address
 P. O. Box 351, Liberal, Kansas 67901

Well No. 6 Lease Name INTERSTATE "B"
 CONSERVATION DIVISION WICHITA, KS

Footage Location
 1320 feet from (SE) (S) line 1320 feet from (E) (W) line

Principal Contractor KTM Drilling Company Geologist John Jacobson

Spud Date 12/1/80 Date Completed 12/18/80 Total Depth 1335' P.B.T.D. 1325'

Directional Deviation not applicable Oil and/or Gas Purchaser Panhandle Eastern Pipeline Co.

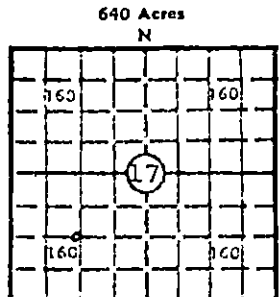

Locate well correctly
 Elev.: Gr. 3548'
 DF 3552' KB 3553'

CASING RECORD

Report of all strings set — surface, intermediate, production, etc.

Purpose of string	Size hole drilled	Size casing set (in O.D.)	Weight lbs/ft.	Setting depth	Type cement	Sacks	Type and percent additives
Surface	12-1/4"	8-5/8"	20#	368	Common	350	3% CaCl
Production	7-7/8"	4-1/2"	10.5#	1334'	Lite-wate SS Pozmix	350 150	.5% tic .5% tic

LINER RECORD

PERFORATION RECORD

Top, ft.	Bottom, ft.	Sacks cement	Shots per ft.	Size & type	Depth interval
			2	.46 jet	1242-1276' O.Z.

TUBING RECORD

Size	Setting depth	Packer set at
2-1/16"	1245'	

ACID, FRACTURE, SHOT, CEMENT SQUEEZE RECORD

Amount and kind of material used	Depth interval treated
A/1000 gal 15% Spearhead + 75 BS	1242-76' O.A.

INITIAL PRODUCTION

Date of first production SI for pipeline	Producing method (flowing, pumping, gas lift, etc.) Flowing
RATE OF PRODUCTION PER 24 HOURS	Oil --- bbls. Gas 201 MCF Water --- bbls. Gas-oil ratio --- CFPB
Disposition of gas (vented, used on lease or sold) To be sold	Producing interval(s) 1242-76' O.A. (Redcave)

INSTRUCTIONS: As provided in KCC Rule 82-2-125, within 90 days after completion of a well, one completed copy of this Drillers Log shall be transmitted to the State Geological Survey of Kansas, 4150 Monroe Street, Wichita, Kansas 67209. Copies of this form are available from the Conservation Division, State Corporation Commission, 245 No. Water, Wichita, Kansas 67202. Phone AC 316-522-2206. If confidential custody is desired, please note Rule 82-2-125. Drillers Logs will be on open file in the Oil and Gas Division, State Geological Survey of Kansas, Lawrence, Kansas 66044.

15-129-20458-0000

Operator Anadarko Production Company		DESIGNATE TYPE OF COMP.: OIL, GAS, DRY HOLE, SWDW, ETC.:
Well No. 6	Lease Name INTERSTATE "B"	GAS
S 17 T 34S R 43 E W		

WELL LOG

Show all important zones of porosity and contents thereof; cored intervals, and all drill-stem tests, including depth interval tested, cushion used, time tool open, flowing and shut-in pressures, and recoveries.

SHOW GEOLOGICAL MARKERS, LOGS RUN, OR OTHER DESCRIPTIVE INFORMATION.

FORMATION DESCRIPTION, CONTENTS, ETC.	TOP	BOTTOM	NAME	DEPTH
Sand & Clay	0'	62'		
Sand Shale & Lime Stone	62'	373'		
Redbed & Red Shale	373'	776'		
Anhydrite	776'	813'		
Glorietta	813'	1121'		
Anhydrite	1121'	1254'		
Anhydrite & Clay	1254'	1335'		

RECEIVED
KANSAS CORPORATION COMMISSION
JAN 18 1995
CONSERVATION DIVISION
WICHITA, KS

USE ADDITIONAL SHEETS, IF NECESSARY, TO COMPLETE WELL RECORD.

Date Received	<i>Paul Campbell</i> Signature
	Paul Campbell, Division Production Manager Title
	December 19, 1980 Date