

Give All Information Completely
Make Required Affidavit
Mail or Deliver Report to:
Conservation Division
State Corporation Commission
212 No. Market
Wichita, Kansas

WELL PLUGGING RECORD

SEWARD

County. Sec. 24 Twp. 34S Rge. 33 (R) (W)

Location as "NE/CNW/SE/SW" or footage from lines 1874' FNL & 554' FWL

Lease Owner ANADARKO PRODUCTION COMPANY

Lease Name McAHREN "C"

Well No 2

Office Address P. O. BOX 351, LIBERAL, KANSAS 67901

Character of Well (completed as Oil, Gas or Dry Hole) DRY HOLE

Date well completed 7/22 19 77

Application for plugging filed verbally 7/21 19 77

Application for plugging approved 7/21 19 77

Plugging commenced 7/22 19 77

Plugging completed 7/22 19 77

Reason for abandonment of well or producing formation DRY HOLE

If a producing well is abandoned, date of last production 19

Was permission obtained from the Conservation Division or its agents before plugging was commenced? Yes

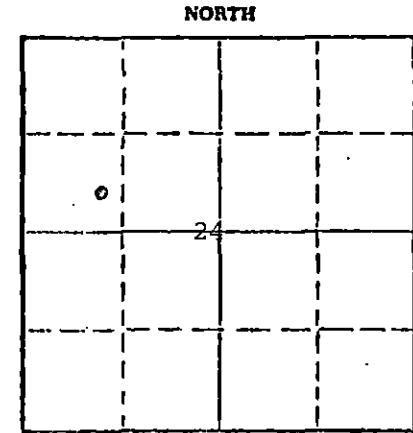

Locate well correctly on above Section Plat

Name of Conservation Agent who supervised plugging of this well CLARENCE THOMAS

Producing formation Depth to top Bottom Total Depth of Well 6610 Feet

Show depth and thickness of all water, oil and gas formations.

OIL, GAS OR WATER RECORDS

CASING RECORD

FORMATION	CONTENT	FROM	TO	SIZE	PUT IN	PULLED OUT
				8-5/8"	1594'	-0-

Describe in detail the manner in which the well was plugged, indicating where the mud fluid was placed and the method or methods used in introducing it into the hole. If cement or other plugs were used, state the character of same and depth placed, from feet to feet for each plug set.

Spotted 60 sxs cmt 1500, 15 sxs cmt 40-0', 5 sxs rathole, 5 sxs mousehole

RECEIVED
STATE CORPORATION COMMISSION

SEP 29 1977

CONSERVATION DIVISION
Wichita, Kansas

(If additional description is necessary, use BACK of this sheet)

Name of Plugging Contractor LOHMANN-JOHNSON DRILLING CO., INC.

Address 3545 NW 58th STREET, SUITE 450, OKLAHOMA CITY, OKLAHOMA 73112

STATE OF KANSAS COUNTY OF SEWARD, ss.
PAUL CAMPBELL

(employee of owner) or (owner or operator) of the above-described well, being first duly sworn on oath, says: That I have knowledge of the facts, statements, and matters herein contained and the log of the above-described well as filed and that the same are true and correct. So help me God.



STATE NOTARY PUBLIC
Seward County, Kansas
My Appointment Expires
June 23, 1980

(Signature) Paul Campbell
Paul Campbell, Division Production Manager
P. O. Box 351, Liberal, Ks. (Address)

SUBSCRIBED AND SWORN to before me this 28th day of September 19 77

My commission expires June 23, 1980

Leon J. Cornelsen
Notary Public.

15-175-20320-0000

KANSAS DRILLERS LOG

S. 24 T. 34S R. 33 ^{EX} W
 Loc. 1874' FNL & 554' FWL
 County SEWARD

API No. 15 — 175 — 20,320
 County Number

Operator
ANADARKO PRODUCTION COMPANY

Address
P. O. BOX 351, LIBERAL, KANSAS 67901

Well No. Lease Name
2 **McAHREN "C"**

Footage Location
1874 feet from (N) (S) line 554 feet from (E) (W) line

Principal Contractor Geologist
Lohmann-Johnson Drilling Co., BOB POSEY

Spud Date Inc. Total Depth P.B.T.D.
3PM 7/6/77 6610'

Date Completed Oil Purchaser
11 PM 7/22/77 NA

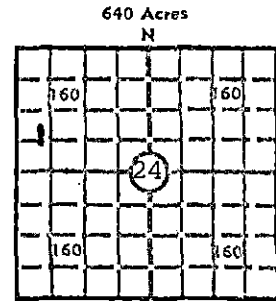

Locate well correctly
 Elev.: Gr. 2830'
 DF _____ KB _____

CASING RECORD

Report of all strings set — surface, intermediate, production, etc.

Purpose of string	Size hole drilled	Size casing set (in O.D.)	Weight lbs/ft.	Setting depth	Type cement	Sacks	Type and percent additives
Surface	12-1/4"	8-5/8"	24#	1594'	Pozmix Common	800	4% gel, 2% CaCl, 3% CaCl

LINER RECORD

PERFORATION RECORD

Top, ft.	Bottom, ft.	Sacks cement	Shots per ft.	Size & type	Depth interval

TUBING RECORD

Size	Setting depth	Packer set at

ACID, FRACTURE, SHOT, CEMENT SQUEEZE RECORD

Amount and kind of material used	Depth interval treated

RECEIVED
 STATE CORPORATION COMMISSION
 SEP 20 1977

INITIAL PRODUCTION

Date of first production		Producing method (flowing, pumping, gas lift, etc.)			
RATE OF PRODUCTION PER 24 HOURS	Oil	Gas	Water	Gas-oil ratio	
	bbls.	MCF	bbls.	CFPB	
Disposition of gas (vented, used on lease or sold)			Producing interval (s)		

INSTRUCTIONS: As provided in KCC Rule 82-2-125, within 90 days after completion of a well, one completed copy of this Drillers Log shall be transmitted to the State Geological Survey of Kansas, 4150 Monroe Street, Wichita, Kansas 67209. Copies of this form are available from the Conservation Division, State Corporation Commission, 3830 So. Meridian (P.O. Box 17027), Wichita, Kansas 66217. Phone AC 316-522-2206. If confidential custody is desired, please note Rule 82-2-125. Drillers Logs will be on an open file in the Oil and Gas Division, State Geological Survey of Kansas, Lawrence, Kansas 66044.

Operator

ANADARKO PRODUCTION COMPANY

DESIGNATE TYPE OF COMP.: OIL, GAS,
DRY HOLE, SWDW, ETC.:
DRY HOLE

Well No.

2

Lease Name

McAHREN "C"

S 24 T 34S R 33 E
W

WELL LOG

Show all important zones of porosity and contents thereof; cored intervals, and all drill-stem tests, including depth interval tested, cushion used, time tool open, flowing and shut-in pressures, and recoveries.

SHOW GEOLOGICAL MARKERS, LOGS RUN,
OR OTHER DESCRIPTIVE INFORMATION.

FORMATION DESCRIPTION, CONTENTS, ETC.	TOP	BOTTOM	NAME	DEPTH
Sand	0'	610'		
Redbed	610'	835'		
Sand	835'	1217'		
Redbed	1217'	1595'		
Shale	1595'	2580'		
Lime & Shale	2580'	2973'		
Sand & Shale	2973'	3534'		
Shale	3534'	3672'		
Shale & Lime	3672'	3840'		
Lime	3840'	4310'		
Lime & Shale	4310'	5566'		
Lime	5566'	5618'		
Lime & Shale	5618'	6610'		
TOTAL DEPTH		6610'		

USE ADDITIONAL SHEETS, IF NECESSARY, TO COMPLETE WELL RECORD.

Date Received

Paul Campbell
Signature

Paul Campbell, Division Production Manager

Title

September 28, 1977

Date