

WELL PLUGGING RECORD

Give All Information Completely  
Make Required Affidavit  
Mail or Deliver Report to:  
Conservation Division  
State Corporation Commission  
211 No. Broadway  
Wichita, Kansas

Seward County. Sec. 21 Twp. 34S Rge. 33 (W)  
Location as "NE/CNW\*SW\*" or footage from lines 1980' FSL, 1345' FWL of SW/4  
Lease Owner Cities Service Oil Company (w/2 NE SW/4)  
Lease Name Bruns "A" Well No. 3  
Office Address 3545 N. W. 58th Street, Oklahoma City, Okla. 73112  
Character of Well (completed as Oil, Gas or Dry Hole) Dry Hole  
Date well completed 5-11 19 76  
T Application for plugging filed 5-11 19 76  
34 Application for plugging approved 5-11 19 76  
S Plugging commenced 5-11 19 76  
Plugging completed 5-11 19 76  
Reason for abandonment of well or producing formation Dry Hole

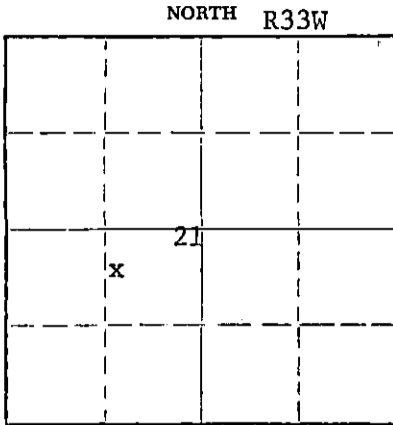

Locate well correctly on above  
Section Plat

If a producing well is abandoned, date of last production N/A 19  
Was permission obtained from the Conservation Division or its agents before plugging was commenced? Yes

Name of Conservation Agent who supervised plugging of this well Clarence Thomas  
Producing formation ----- Depth to top -- Bottom -- Total Depth of Well 6500 Feet  
Show depth and thickness of all water, oil and gas formations.

OIL, GAS OR WATER RECORDS				CASING RECORD		
FORMATION	CONTENT	FROM	TO	SIZE	PUT IN	PULLED OUT
N/A						

Describe in detail the manner in which the well was plugged, indicating where the mud fluid was placed and the method or methods used in introducing it into the hole. If cement or other plugs were used, state the character of same and depth placed, from \_\_\_\_\_ feet to \_\_\_\_\_ feet for each plug set.

5-11-76: Spotted cement plugs as follows:

- 40 sx from 5980 - 6090' Morrow & Chester
- 100 sx from 2600 - 2900' Hugoton
- 40 sx from 1520 - 1620' Surface pipe
- 10 sx from 4 - 35'

Cutt off 8-5/8" casing 4' below GL at which point a steel cap with well name & date was welded on.

5-19-76

(If additional description is necessary, use BACK of this sheet)

Name of Plugging Contractor Lohmann-Johnson Drilling Co., Inc.  
Address 1302 Old National Bank Bldg., Evansville, Indiana 47708

STATE OF Oklahoma, COUNTY OF Oklahoma, ss.  
H. E. Massey (employee of the above-described well, being first duly sworn on oath, says: That I have knowledge of the facts, statements, and matters herein contained and the log of the above-described well as filed and that the same are true and correct. So help me God.

(Signature) H. E. Massey, Operations Manager  
3545 N. W. 58th Street, Okla. City, Okla. 73112  
(Address)

SUBSCRIBED AND SWORN TO before me this 18th day of May, 19 76

My commission expires 6/25/77

Dorothy L. St. George  
Dorothy L. St. George Notary Public.

KANSAS CORPORATION COMMISSION

WELL RECORD

(Mail to Kansas Geological Survey, 4150 Monroe Street, Wichita, Kansas 67209)

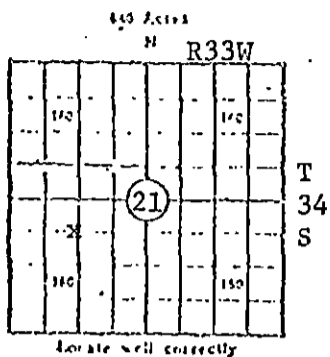

Lease Name: Bruns "A" Well No. 3  
 Well Located: 1980' FSL, 1345' FWL of SW/4  
SEC 21 TWP 34S RGE 33W  
 Operator: Cities Service Oil Company  
 Address: 3545 N. W. 58th Street, Okla. City, Okla. 73112  
 Elevation: Ground 2839' D.F. 2847' K.B. 2848'  
 Type Well: (Oil, gas, dry hole) Dry Hole

Drilling Commenced: 4-25 1976 Drilling Completed: 5-12 1976  
 Well Completed: 5-12 1976 Total Depth 6500'  
 Initial Production: Dry Hole

Casing Record

Size: 8-5/8" Set at 1569' Size: --- Set at ---  
 Size: --- Set at --- Size: --- Set at ---

Liner Record

Size: --- Set from --- To ---

Cementing

Casing Size	Sacks	Type Cement and Additives
<u>8-5/8"</u>	<u>900</u>	<u>Cemented w/700 sx Howco Lite w/2% CaCl followed by 200 sx Class H w/3% CaCl. Cement circulated to surface.</u>
<u>---</u>	<u>---</u>	<u>---</u>
<u>---</u>	<u>---</u>	<u>---</u>

Perforations

Formation	Perforated Interval and Number Shots
<u>N/A</u>	<u>---</u>
<u>---</u>	<u>---</u>
<u>---</u>	<u>---</u>
<u>---</u>	<u>---</u>

Electric Log Run. (Show type log and depths covered)

Ran Dresser Atlas Dual Induction Focused Log Comp. Formation Density w/Neutron, GR & Caliper from 1569', Loggers T.D. to 6496'.

(Fill in formation and related information on reverse side)

FORMATION, TESTING AND COMPLETION RECORD

Show Drill Stem Tests,  
Well Stimulation and  
Production Tests

Formation	Top	Bottom		
Sand & Clay	0	500	DST #1 Lower Morrow	6050-68'
Glorietta Sand	500	1210	DST #2 Lower Morrow	6005-95'
Red Bed & Shale	1210	1553	DST #2A Lower Morrow	6025-99'
Anhydrite	1553	1576		
Shale	1576	3620		
Lime	3620	3678		
Shale	3678	4115		
Shale & Lime	4115	4845		
Lime	4845	6260		
Lime & Shale	6260	6359		
Lime	6359	6500		
T.D.		6500		