

STATE OF KANSAS
STATE CORPORATION COMMISSION

WELL PLUGGING RECORD

Give All Information Completely
Make Required Affidavit
Mail or Deliver Report to
Conservation Division
State Corporation Comm.
245 North Water
Wichita, KS 67202

Morton County, Sec. 25 Twp. 33S Rge. 41 E/W
Location as "NE/CNW $\frac{1}{4}$ SW $\frac{1}{4}$ " or footage from lines
1980' FN&EL
Lease Owner Anadarko Production Company
Lease Name HONOUR "A" Well No. 1
Office Address P. O. Box 351, Liberal, Kansas 67901
Character of Well (Completed as Oil, Gas or Dry Hole)
Dry Hole
Date Well completed 6/9/76 19
Application for plugging filed 4/27/76 19
Application for plugging approved 4/29/76 19
Plugging commenced 6/9/76 19
Plugging completed 6/9/76 19
Reason for abandonment of well or producing formation
Dry Hole
If a producing well is abandoned, date of last production 19

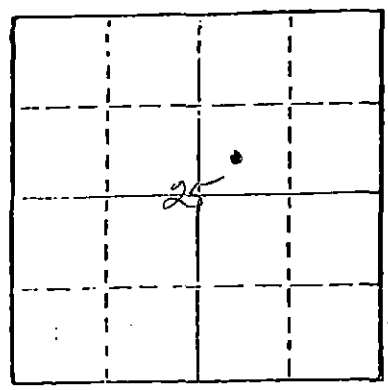

Locate well correctly on above Section Plat

Name of Conservation Agent who supervised plugging of this well Clarence Thomas
Producing formation Depth to top Bottom Total Depth of Well 15812'
Show depth and thickness of all water, oil and gas formations.

OIL, GAS OR WATER RECORDS CASING RECORD

FORMATION	CONTENT	FROM	TO	SIZE	PUT IN	PULLED OUT
	C.P. 21-76			4-1/2	5795'	3010'
	CONSERVA DIVISION WICHITA					

Describe in detail the manner in which the well was plugged, indicating where the mud fluid was placed and the method or methods used in introducing it into the hold. If cement or other plugs were used, state the character of same and depth placed, from _____ feet to _____ feet for each plug set.

MI csg pullers, ran 2-3/8" thg, spotted 35 sxs cmt 1200', 15 sxs 45'-0', cut off & capped 8-5/8 csg, comp 11 AM 6/9/76. P&A.

(If additional description is necessary, use BACK of this sheet)

Name of Plugging Contractor Sargents Casing & Pulling Contractor

STATE OF Kansas COUNTY OF SEWARD, ss.

Stanley R. Shoemaker (employee of owner) or (owner/operating) of the above-described well, being first duly sworn on oath, says: That I have knowledge of the facts, statements, and matters herein contained and the log of the above-described well as filed and that the same are true and correct. So help me God.

(Signature) Stanley Shoemaker
P. O. Box 351, Liberal, Kansas 67901
(Address)

SUBSCRIBED AND SWORN TO before me this 17th day of September, 1976

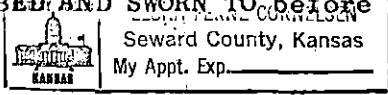

Lerona Ferné Cornelsen
Notary Public.

My commission expires 6/23/80

KANSAS DRILLERS LOG

S. 25 T. 33S R. 41 E
W

API No. 15 — 129 — 20,206 - 0000
County Number

Loc. 1980' FN&EL

County Morton

Operator
Anadarko Production Company

Address
P. O. Box 351, Liberal, Kansas 67901

Well No. 1 Lease Name HONOUR "A"

Footage Location
1980 feet from (N) line 1980 feet from (E) line

Principal Contractor Lohmann-Johnson Geologist Joe Blair

Spud Date 6/17/75 Total Depth 5812' P.B.T.D.

Date Completed 6/9/76 Oil Purchaser

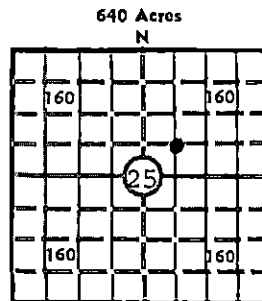

Locate well correctly

Elev.: Gr. 3335'

DF KB

CASING RECORD

Report of all strings set— surface, intermediate, production, etc.

Purpose of string	Size hole drilled	Size casing set (in O.D.)	Weight lbs/ft.	Setting depth	Type cement	Sacks	Type and percent additives
Surface	12-1/4"	8-5/8"	24 & 28#	1512	Poz Common	500 200	4% gel, 2% CaCl 3% CaCl
Production	7-7/8"	4-1/2"	10.5#	5795	S. S. Poz	125	.5% CFR-2

LINER RECORD

PERFORATION RECORD

Top, ft.	Bottom, ft.	Sacks cement	Shots per ft.	Size & type	Depth interval
			4		5716-20

TUBING RECORD

Size	Setting depth	Packer set at

ACID, FRACTURE, SHOT, CEMENT SQUEEZE RECORD

Amount and kind of material used	Depth interval treated
A/500 gal NE	5716-20

INITIAL PRODUCTION

Date of first production	Producing method (flowing, pumping, gas lift, etc.)			
RATE OF PRODUCTION PER 24 HOURS	Oil bbls.	Gas MCF	Water bbls.	Gas-oil ratio CFPB
Disposition of gas (vented, used on lease or sold)			Producing interval (s)	

INSTRUCTIONS: As provided in KCC Rule 82-2-125, within 90 days after completion of a well, one completed copy of this Drillers Log shall be transmitted to the State Geological Survey of Kansas, 4150 Monroe Street, Wichita, Kansas 67209. Copies of this form are available from the Conservation Division, State Corporation Commission, 3830 So. Meridian (P.O. Box 17027), Wichita, Kansas 66217. Phone AC 316-522-2206. If confidential custody is desired, please note Rule 82-2-125. Drillers Logs will be on open file in the Oil and Gas Division, State Geological Survey of Kansas, Lawrence, Kansas 66044.

Operator **Anadarko Production Company** DESIGNATE TYPE OF COMP.: OIL, GAS, DRY HOLE, SWDW, ETC.: **Dry Hole**

Well No. **1** Lease Name **HONOUR "A"**

S **25** T **33S** R **41** ^X/_W

WELL LOG

Show all important zones of porosity and contents thereof; corod intervals, and all drill-stem tests, including depth interval tested, cushion used, time tool open, flowing and shut-in pressures, and recoveries.

SHOW GEOLOGICAL MARKERS, LOGS RUN, OR OTHER DESCRIPTIVE INFORMATION.

FORMATION DESCRIPTION, CONTENTS, ETC.	TOP	BOTTOM	NAME	DEPTH
Native Sand & Redbed	0'	1502'		
Anhydrite	1502'	2211'		
Anhydrite & Shale	2211'	2415'		
Lime & Shale	2415'	5812'		
Total Depth		5812'		
DST #1 5403-5442 (Keyes), op 20 SI 60, op 40, SI 80 w/fair blow throug rec 90' wtry mud, 510' GCSW, ISIP 1244 (60), IFP 103-171, FP 205-291, FSIP 1194 (80).				
DST #2 5672-5812 (St Louis) op 20 vry wk blow, op 40, vry wk blow, rec 270' mud, 180' SGC & OC mdy wtr, ISIP 1530 (45), IFP 52-170, FP 170-274, FSIP 1543 (60).				

USE ADDITIONAL SHEETS, IF NECESSARY, TO COMPLETE WELL RECORD.

Date Received _____

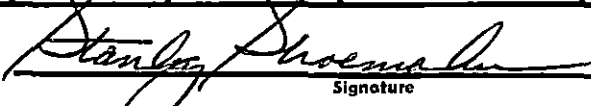
 Signature
 Stanley R. Shoemaker, Division Office Manager
 Title
 September 17, 1976
 Date