

STATE OF KANSAS
STATE CORPORATION COMMISSION

WELL PLUGGING RECORD

Give All Information Completely
Make Required Affidavit
Mail or Deliver Report to
Conservation Division
State Corporation Comm.
245 North Water
Wichita, KS 67202

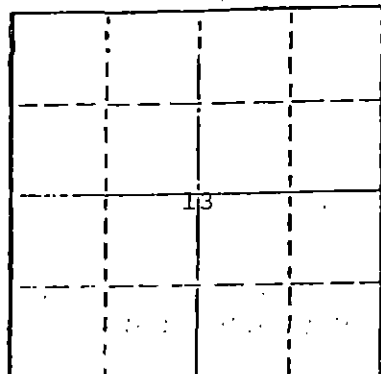

Locate well correctly on above
Section Plot

MORTON County, Sec. 13 Twp. 33S Rge. 40 E/W

Location as "NE/CNW 1/4 SW 1/4" or footage from lines

C E/2 NE/4

Lease Owner ANADARKO PRODUCTION COMPANY

Lease Name HAYWARD "E" Well No. 2

Office Address P. O. BOX 351, LIBERAL, KANSAS 67901

Character of Well (Completed as Oil, Gas or Dry Hole)

DRY HOLE

Date Well completed 8/21 1977

Application for plugging filed verbally 8/20 1977

Application for plugging approved written 8/25 1977

Plugging commenced 8/21 1977

Plugging completed 8/21 1977

Reason for abandonment of well or producing formation

Dry Hole

If a producing well is abandoned, date of last production

19

Was permission obtained from the Conservation Division or its agents before plugging was commenced? Yes

Name of Conservation Agent who supervised plugging of this well Clarence Thomas

Producing formation Depth to top Bottom Total Depth of Well 6378'

Show depth and thickness of all water, oil and gas formations.

OIL, GAS OR WATER RECORDS

CASING RECORD

FORMATION	CONTENT	FROM	TO	SIZE	PUT IN	PULLED OUT
				8-5/8	1651'	-0-

Describe in detail the manner in which the well was plugged, indicating where the mud fluid was placed and the method or methods used in introducing it into the hold. If cement or other plugs were used, state the character of same and depth placed, from feet to feet for each plug set.

Spotted 80 sxs cmt, 6378-6103, 50 sxs cmt 3100-2928, 50 sxs cmt 2850-2678, 35 sxs 1700-1587, 15 sxs cmt 40-4', 5 sxs ea. rathole & mousehole, comp 5AM 8/21/77, rig rel 7AM, P&A.

RECEIVED
STATE CORPORATION COMMISSION

SEP 28 1977

CONSERVATION DIVISION
Wichita, Kansas

(If additional description is necessary, use BACK of this sheet)

Name of Plugging Contractor Lohmann-Johnson Drlg Co., Inc.

3545 NW 58th Street, Suite 450, Oklahoma City, Okla. 73112

STATE OF KANSAS COUNTY OF SEWARD ss.

Paul Campbell (employee of owner) or (owner or operator) of the above-described

well, being first duly sworn on oath, says: That I have knowledge of the facts, statements, and matters herein contained and the log of the above-described well and that the same are true and correct. So help me God.



STATE NOTARY PUBLIC

Seward County, Kansas

My Appointment Expires

STATE OF KANSAS

Subscribed and Sworn to before me this

27th

(Signature)

Paul Campbell

Paul Campbell, Division Production Manager

P. O. Box 351, (Address) Liberal, Kansas 67901

day of September 1977

Lona Ferne Cornelsen

Notary Public.

My commission expires June 23, 1980

7-11-76
Mr. [unclear]
[unclear]
[unclear]
[unclear]

RECEIVED

AUG 16 1976

PRODUCTION
LIBERAL DIVISION

KANSAS DRILLERS LOG

S. 13 T. 33S R.40 ^K/_W

API No. 15 _____
 County _____ Number _____

Loc. E/2 NE/4

County MORTON

Operator
ANADARKO PRODUCTION COMPANY

Address
P. O. BOX 351, LIBERAL, KANSAS 67901

Well No. 2 Lease Name **HAYWARD "E"**

Footage Location
 feet from (N) (S) line _____ feet from (E) (W) line _____

Principal Contractor **LOHMANN-JOHNSON** Geologist **Walt Riggs**

Spud Date **8/5/77 8PM** Total Depth **6378'** P.B.T.D. _____

Date Completed **8/21/77 5AM** Oil Purchaser _____

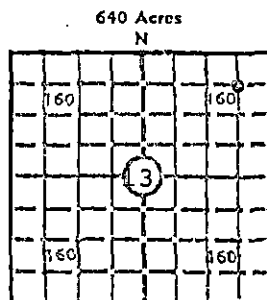

Elev.: Gr. **3259.7**

DF _____ KB _____

CASING RECORD

Report of all strings set— surface, intermediate, production, etc.

Purpose of string	Size hole drilled	Size casing set (in O.D.)	Weight lbs/ft.	Setting depth	Type cement	Sacks	Type and percent additives
Surface	12-1/4"	8-5/8"	24#	1651'	Pozmix & Common	800	4% gel, 2% cc

LINER RECORD

PERFORATION RECORD

Top, ft.	Bottom, ft.	Sacks cement	Shots per ft.	Size & type	Depth interval

TUBING RECORD

Size	Setting depth	Packer set at			

ACID, FRACTURE, SHOT, CEMENT SQUEEZE RECORD

Amount and kind of material used	Depth interval treated

RECEIVED
 STATE COMMISSION
 SEP 28 1977
 CONSERVATION DIVISION
 WICHITA, KANSAS

INITIAL PRODUCTION

Date of first production _____		Producing method (flowing, pumping, gas lift, etc.) _____			
RATE OF PRODUCTION PER 24 HOURS	Oil _____ bbls.	Gas _____ MCF	Water _____ bbls.	Gas-oil ratio _____ CFPB	
Disposition of gas (vented, used on lease or sold) _____			Producing interval(s) _____		

INSTRUCTIONS: As provided in KCC Rule 82-2-125, within 90 days after completion of a well, one completed copy of this Drillers Log shall be transmitted to the State Geological Survey of Kansas, 4150 Monroe Street, Wichita, Kansas 67209. Copies of this form are available from the Conservation Division, State Corporation Commission, 3830 So. Meridian (P.O. Box 17027), Wichita, Kansas 66217. Phone AC 316-522-2206. If confidential custody is desired, please note Rule 82-2-125. Drillers Logs will be on an open file in the Oil and Gas Division, State Geological Survey of Kansas, Lawrence, Kansas 66044.

Operator ANADARKO PRODUCTION COMPANY		DESIGNATE TYPE OF COMP.: OIL, GAS, DRY HOLE, SWDW, ETC.:
Well No. 2	Lease Name HAYWARD "E"	DRY HOLE
S 13 T 33S R 40 ^F / _W		

WELL LOG

Show all important zones of porosity and contents thereof; cored intervals, and all drill-stem tests, including depth interval tested, cushion used, time tool open, flowing and shut-in pressures, and recoveries.

SHOW GEOLOGICAL MARKERS, LOGS RUN, OR OTHER DESCRIPTIVE INFORMATION.

FORMATION DESCRIPTION, CONTENTS, ETC.	TOP	BOTTOM	NAME	DEPTH
Native	0'	397'		
Redged	397'	985'		
Sand & Gyp	985'	1519'		
Gyp, Shale & Andy	1519'	1654'		
Shale	1654'	2459'		
Shale & Lime	2459'	3238'		
Shale & Dolo	3238'	4030'		
Shale & Lime	4030'	5309'		
Shale	5309'	5645'		
Shale & Lime	5645'	5764'		
Shale	5764'	5910'		
Sand	5910'	5960'		
Shale	5960'	6023'		
Sand	6023'	6060'		
Shale	6060'	6090'		
Shale & Lime	6090'	6378'		
TOTAL DEPTH		6378'		
<p>DST #1 5744-64 (Morr) 20-45-60-90 w/str blow thruout, rec 45' gassey oil, 90' HGCM, 570' GCSW, ISIP 1590 (45), IFP 85-157, FP 230-342, FSIP 1519 (90), HP 2750-2721, temp 150°.</p> <p>DST #2 5924-60 (Morr) 20-40-45-90 w/wk blow on preflow & no blow on 2nd open, rec 300' DM, ISIP 1392 (40), IFP 171-228, FFP 371-400, FSIP 1575 (90), 2981-2806.</p> <p>DST #3 5918-60 (Morr) 20MPF w/wk blow op 20 w/no blow, rec 30' DM, ISIP 1619 (40), IFP 57-85, FFP 85-85, FSIP 1392 (80), temp 135°, HP 2863-2806.</p> <p>DST #4 6016-60 (Morr) 20MPF w/str blow, op 60 GTS 4M, 10M ga 27 Mcf, 45M 55 McF 60M, 52 Mcf, rec 3400' GCMSW, ISIP 1644 (40), IFP 663-1382, FFP 1382-1644, FSIP 1644 (120), HP 3021-2860.</p>				

USE ADDITIONAL SHEETS, IF NECESSARY, TO COMPLETE WELL RECORD.

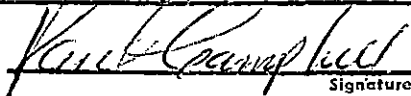
Date Received	 Signature
	Paul Campbell, Divison Production Manager Title
	September 27, 1977 Date