

Give All Information Completely  
Make Required Affidavit  
Mail or Deliver Report to:  
Conservation Division  
State Corporation Commission  
212 No. Market  
Wichita, Kansas

WELL PLUGGING RECORD

Morton County, Sec. 14 Twp. 33S Rge. (E) 40 (W)

Location as "NE/CNWKSWK" or footage from lines \_\_\_\_\_  
Lease Owner Anadarko Production Company  
Lease Name Methodist "B" Well No. 2  
Office Address Box 351, Liberal, Kansas 67901  
Character of Well (completed as Oil, Gas or Dry Hole) Dry Hole  
Date well completed 8-4-74  
Application for plugging filed August 4 1974  
Application for plugging approved August 4 1974  
Plugging commenced August 4 1974  
Plugging completed August 4 1974  
Reason for abandonment of well or producing formation Dry Hole

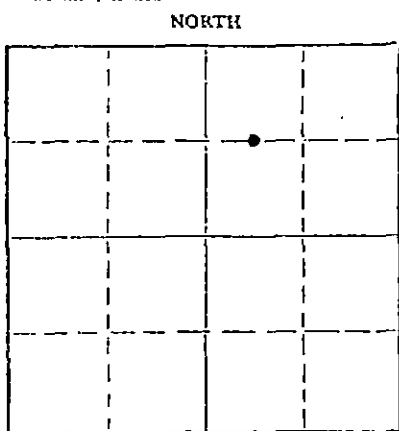

Locate well correctly on above Section Plot

If a producing well is abandoned, date of last production \_\_\_\_\_ 19\_\_\_\_  
Was permission obtained from the Conservation Division or its agents before plugging was commenced? Yes

Name of Conservation Agent who supervised plugging of this well Mr. Edgar Eves  
Producing formation \_\_\_\_\_ Depth to top \_\_\_\_\_ Bottom \_\_\_\_\_ Total Depth of Well 6190 Feet  
Show depth and thickness of all water, oil and gas formations.

OIL, GAS OR WATER RECORDS

CASING RECORD

FORMATION	CONTENT	FROM	TO	SIZE	PUT IN	PULLED OUT

Describe in detail the manner in which the well was plugged, indicating where the mud fluid was placed and the method or methods used in introducing it into the hole. If cement or other plugs were used, state the character of same and depth placed, from \_\_\_\_\_ feet to \_\_\_\_\_ feet for each plug set.

Spotted 50 sacks cement @ 2836'-2686', spotted 35 sacks cement 1717'-1617', spotted 10 sacks cement 35'-0', spotted 5 sacks in rat hole and mouse hole.

RECEIVED  
STATE CORPORATION COMMISSION  
SEP 20 1974  
CONSERVATION DIVISION  
Wichita, Kansas

(If additional description is necessary, use BACK of this sheet)  
Name of Plugging Contractor Lohmann-Johnson Drilling Co., Inc.  
Address 1701 Fidelity National Bank Bldg., Oklahoma City, Oklahoma 73102

STATE OF Kansas, COUNTY OF Seward, ss.  
T. W. Williams (employee of owner) or Contractor of the above-described well, being first duly sworn on oath, says: That I have knowledge of the facts, statements, and matters herein contained and the log of the above-described well as filed and that the same are true and correct. So help me God.)

(Signature) T. W. Williams  
P. O. Box 351, Liberal, Kansas 67901  
(Address)

SUBSCRIBED AND SWORN to before me this 18th day of September, 1974

Norma L. Atkinson  
Notary Public.

My commission expires \_\_\_\_\_

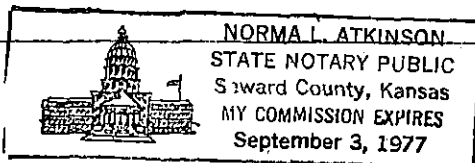

15-129-20157-0000

KANSAS DRILLERS LOG

S. 14 T. 33 R. 40 E W

API No. 15 — 129 — 20,157  
County Number

Loc. W NE

County Morton

Operator  
Anadarko Production Co.

Address Box 351 Liberal, Kansas

Well No. #2 Lease Name Methodist "B"

Footage Location  
1320 feet from (N) line 1980 feet from (E) line

Principal Contractor Lohmann-Johnson Drlg. Co. Geologist

Spud Date 7-11-74 Total Depth 6190' P.B.T.D.

Date Completed 8-4-74 Oil Purchaser

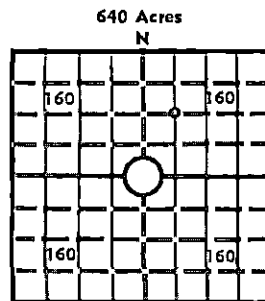

Elev.: Gr. 3295.99'

DF KB

CASING RECORD

Report of all strings set— surface, intermediate, production, etc.

Purpose of string	Size hole drilled	Size casing set (in O.D.)	Weight lbs/ft.	Setting depth	Type cement	Sacks	Type and percent additives
Surface	12-1/4"	8-5/8"	20&23#	1666'	Pozmix	650	4% gel + 2% CC
					Common	200	2% CC

LINER RECORD

PERFORATION RECORD

Top, ft.	Bottom, ft.	Sacks cement	Shots per ft.	Size & type	Depth interval

Size	Setting depth	Packer set at

ACID, FRACTURE, SHOT, CEMENT SQUEEZE RECORD

Amount and kind of material used

RECEIVED  
STATE CORPORATION COMMISSION

SEP 20 1974

CONSERVATION DIVISION  
Wichita, Kansas

INITIAL PRODUCTION

Date of first production	Producing method (flowing, pumping, gas lift, etc.)				
RATE OF PRODUCTION PER 24 HOURS	Oil bbls.	Gas MCF	Water bbls.	Gas-oil ratio	CFPB
Disposition of gas (vented, used on lease or sold)			Producing interval (s)		

INSTRUCTIONS: As provided in KCC Rule 82-2-125, within 90 days after completion of a well, one completed copy of this Drillers Log shall be transmitted to the State Geological Survey of Kansas, 4150 Monroe Street, Wichita, Kansas 67209. Copies of this form are available from the Conservation Division, State Corporation Commission, 3830 So. Meridian (P.O. Box 17027), Wichita, Kansas 66217. Phone AC 316-522-2206. If confidential custody is desired, please note Rule 82-2-125. Drillers Logs will be on open file in the Oil and Gas Division, State Geological Survey of Kansas, Lawrence, Kansas 66044.

Operator  
Anadarko Production Company

DESIGNATE TYPE OF COMP.: OIL, GAS,  
DRY HOLE, SWDW, ETC.:

Well No. #2      Lease Name Methodist "B"      Dry Hole

S 14 T33S R 40 E W

**WELL LOG**

Show all important zones of porosity and contents thereof; cored intervals, and all drill-stem tests, including depth interval tested, cushion used, time tool open, flowing and shut-in pressures, and recoveries.

SHOW GEOLOGICAL MARKERS, LOGS RUN, OR OTHER DESCRIPTIVE INFORMATION.

FORMATION DESCRIPTION, CONTENTS, ETC.	TOP	BOTTOM	NAME	DEPTH
Surface Sand-Clay	0	50		
Sand-Shale	50	425		
Redbed-Sand-Shale	425	1473		
Shale-Lime	1473	1667		
Shale	1667	1760		
Shale-Gyp	1760	2521		
Shale	2521	2888		
Lime-Shale	2888	5641		
Sand	5641	5719		
Lime-Shale	5719	6190		
Total Depth		6190		

USE ADDITIONAL SHEETS, IF NECESSARY, TO COMPLETE WELL RECORD.

Date Received

*T. W. Williams*  
T. W. Williams      Signature

Division Office Supervisor      Title  
August 15, 1974      Date

DRILLER'S LOG

WELL NAME Methodist "B" #2

COMPANY OPERATING Anadarko Production Company

ADDRESS OF COMPANY Box 351, Liberal, Kansas

WELL LOCATION 1/4 1/4 1/4

3960 Ft. North of South Line,

3300 Ft. East of West Line, Sec. 14, Twp. 33S, Rge. 40W, Morton County, Kansas

DRILLING STARTED 7-11, 19 74, DRILLING COMPLETED 8-4, 19 74

WELL COMPLETED 8-4, 19 74, WELL CONNECTED \_\_\_\_\_, 19 \_\_\_\_\_

ELEVATION 3295.99' Ft. Ground Level CHARACTER of WELL (Oil, Gas, Dry Hole) Dry Hole

OIL OR GAS SANDS OR ZONES - PERFORATIONS - ACIDIZING AND FRACTURING INFORMATION.

Name	From	To	No. of Shots	Callons Used	Kind Used

CASING RECORD

Size	Amount Set	Sacks of Cement	Amount Pulled
<u>8-5/8"</u>	<u>1666'</u>	<u>850 sxs</u>	

FORMATION RECORD

Formation	Top	Bottom	Formation	Top	Bottom

RESULTS OF INITIAL PRODUCTION TEST: \_\_\_\_\_

RECEIVED  
STATE CORPORATION COMMISSION

SEP 20 1974

CONSERVATION DIVISION  
Wichita, Kansas