

STATE OF KANSAS  
STATE CORPORATION COMMISSION

WELL PLUGGING RECORD

Give All Information Completely  
Make Required Affidavit  
Mail or Deliver Report to:  
Conservation Division  
State Corporation Commission  
211 No. Broadway  
Wichita, Kansas

Sedgwick County. Sec. 2 Twp. 29 Rge. 2 (E) W (W)  
Location as "NE/CNW%SW%" or footage from lines NW NE SE  
Lease Owner Petroleum, Inc.  
Lease Name House Well No. 2  
Office Address Route 2, Great Bend, Kansas  
Character of Well (completed as Oil, Gas or Dry Hole) Dry hole  
Date well completed March 29 19 57  
Application for plugging filed March 29 19 57  
Application for plugging approved March 29 19 57  
Plugging commenced March 29 19 57  
Plugging completed March 29 19 57  
Reason for abandonment of well or producing formation No Producing Zones

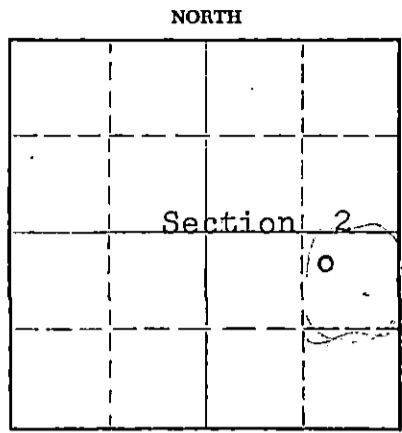

Locate well correctly on above  
Section Plat

If a producing well is abandoned, date of last production None 19       
Was permission obtained from the Conservation Division or its agents before plugging was commenced? Yes

Name of Conservation Agent who supervised plugging of this well Ruel Durkee McPherson, Kansas  
Producing formation      Depth to top      Bottom      Total Depth of Well 3640 Feet  
Show depth and thickness of all water, oil and gas formations.

OIL, GAS OR WATER RECORDS

CASING RECORD

FORMATION	CONTENT	FROM	TO	SIZE	PUT IN	PULLED OUT
				8 5/8"	447'	None

Describe in detail the manner in which the well was plugged, indicating where the mud fluid was placed and the method or methods used in introducing it into the hole. If cement or other plugs were used, state the character of same and depth placed, from      feet to      feet for each plug set.

Mud up with heavy mud to 240' followed by wooden plug. Placed 15 sacks cement through drill pipe on to plug. Mud up to 40' followed by wooden plug and 10 sacks cement to base of well cellar.

(If additional description is necessary, use BACK of this sheet)

Name of Plugging Contractor Garvey Drilling Co.  
Address Route 2, Great Bend, Kansas

STATE OF Kansas, COUNTY OF Barton, ss.  
Don Searle (employee of owner) or (~~owner or operator~~) of the above-described well, being first duly sworn on oath, says: That I have knowledge of the facts, statements, and matters herein contained and the log of the above-described well as filed and that the same are true and correct. So help me God.

(Signature) Don Searle  
Route 2, Great Bend, Kansas  
(Address)

SUBSCRIBED AND SWORN TO before me this 10th day of April, 19 57  
      
Notary Public.

My commission expires July 11, 1960

PLUGGING  
FILE SEC 2 T 29 R 2W  
BOOK PAGE 3 LINE 9

RECEIVED  
STATE CORPORATION COMMISSION

APR 11 1957 4-11-57

CONSERVATION DIVISION  
WICHITA, KANSAS

15-173-00254-0000

# WELL LOG

COMPANY PETROLEUM, INCORPORATED

SEC. 2 T. 29S. 2W

FARM HOUSE

NO. 2

LOC. NW, NE, SE

TOTAL DEPTH 3640'

COUNTY Sedgwick Co., Kansas

COMM. March 18, 1957

COMP. March 29, 1957

CONTRACTOR GARVEY DRILLING COMPANY

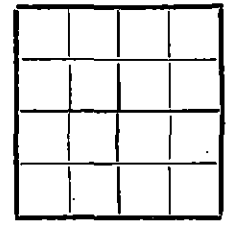

CASING 8 5/8" @ 447' w/225 sax.

ELEVATION 1351' DF

PRODUCTION D & A

FIGURES INDICATE BOTTOM OF FORMATIONS

60	Clay & sand
205	Sand & shale
250	Salt
400	Shale
435	Anhydrite
447	Shale
1125	Lime & shale
1680	Shale
2585	Lime & shale
2730	Shale & sand
2955	Lime & shale
3287	Lime
3341	Lime & shale
3485	Lime
3552	Lime & shale
3640	Lime
3640	T. D.

**PLUGGING**  
 FILE SEC. 2 T. 29 R. 2W  
 BOOK PAGE 3 LINE 9

State of KANSAS

County of BARTON

**RECEIVED**  
STATE CORPORATION COMMISSION

APR 11 1957

I, Verne A. Morris

Garvey Drilling Co.

CONSERVATION DIVISION  
Wichita, Kansas

upon oath-state that the above and foregoing is a true and correct copy of the log of the #2 House well

Verne A. Morris

Subscribed and sworn to before me this 5th day of April 19 57

My Commission Expires: July 11, 1960

Zed T. Brown  
NOTARY PUBLIC