

STATE OF KANSAS
STATE CORPORATION COMMISSION

Form CP-4

Give All Information Completely
Make Required Affidavit
Mail or Deliver Report to:
Conservation Division
State Corporation Commission
211 No. Broadway
Wichita, Kansas

WELL PLUGGING RECORD

Stevens County. Sec. 23 Twp. 33S Rge. 36 (W)
Location as "NE/CNW/SW" or footage from lines C-NW-SE
Lease Owner Petroleum, Inc.
Lease Name Heger Unit Well No. 1
Office Address P.O. Box 1255, Liberal, Kansas
Character of Well (completed as Oil, Gas or Dry Hole) Dry Hole
Date well completed October 28 1967
Application for plugging filed November 1 1967
Application for plugging approved November 1 1967
Plugging commenced October 28 1967
Plugging completed October 28 1967
Reason for abandonment of well or producing formation Dryhole

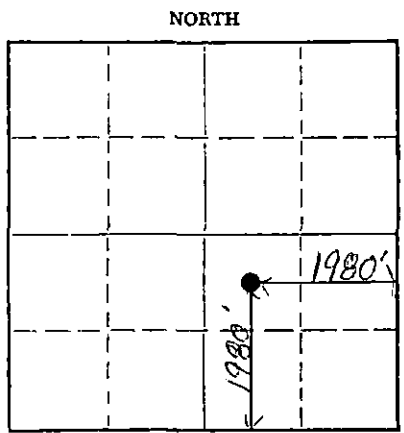

Locate well correctly on above
Section Plat

If a producing well is abandoned, date of last production --- 19--
Was permission obtained from the Conservation Division or its agents before plugging was commenced? Yes

Name of Conservation Agent who supervised plugging of this well Edgar Eves
Producing formation NONE Depth to top -- Bottom -- Total Depth of Well 6610' Feet
Show depth and thickness of all water, oil and gas formations.

OIL, GAS OR WATER RECORDS

CASING RECORD

FORMATION	CONTENT	FROM	TO	SIZE	PUT IN	PULLED OUT
NONE						

Describe in detail the manner in which the well was plugged, indicating where the mud fluid was placed and the method or methods used in introducing it into the hole. If cement or other plugs were used, state the character of same and depth placed, from _____ feet to _____ feet for each plug set.
Mudded up w/heavy mud to 700', plugged w/35 sacks cement. Mudded up w/heavy mud to 45', plugged w/15 sacks cement to base of cellar.

RECEIVED
NOV 15 1967
CONSERVATION DIVISION
WICHITA, KANSAS

(If additional description is necessary, use BACK of this sheet)
Name of Plugging Contractor Garvey Drilling Co.
Address R.R. #2, Great Bend, Kansas

STATE OF Kansas, COUNTY OF Seward, ss.
Ned E. Lowry (employee of owner) or (owner or operator) of the above-described well, being first duly sworn on oath, says: That I have knowledge of the facts, statements, and matters herein contained and the log of the above-described well as filed and that the same are true and correct. So help me God.

(Signature) Ned E. Lowry
P.O. Box 1255, Liberal, Kansas
(Address)

SUBSCRIBED AND SWORN TO before me this 14th day of November, 1967
James R. Hatfield
Notary Public.

My commission expires Sept. 19, 1970

WELL LOG

COMPANY Petroleum, Inc.

SEC. 23 T. 33S R. 36W

FARM Heger Unit

NO. 1

LOC. C NW SE

TOTAL DEPTH 6610'

COUNTY Stevens

COMM. 10-8-67

COMP. 10-28-67

CONTRACTOR Garvey Drilling Company

CASING 8 5/8" @ 1730' w/700 sx

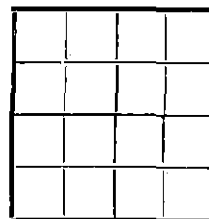

ELEVATION

PRODUCTION D & A

FIGURES INDICATE BOTTOM OF FORMATIONS

- 180' Surface Clay
- 550' Sand
- 700' Red Bed
- 1116' Shale and Gyp
- 1137' Shale
- 1380' Sand
- 1435' Shale
- 1722' Red Bed and Shale
- 1730' Anhydrite
- 2020' Shale and Shells
- 2305' Shale
- 2457' Shale and Lime
- 3509' Lime and Shale
- 3569' Shale and Lime
- 3789' Lime and Shale
- 3852' Shale and Lime
- 4250' Lime and Shale
- 4795' Lime
- 4968' Lime, Shale and Sand
- 5021' Lime
- 5301' Lime and Shale
- 5378' Lime
- 5583' Lime and Shale
- 5680' Shale with Lime Streaks
- 5818' Shale and Lime
- 5871' Lime and Shale
- 6110' Shale and Sand
- 6246' Shale
- 6321' Lime and Shale
- 6453' Lime
- 6536' Lime and Shale
- 6610' Lime
- 6610' RTD

RECEIVED
 STATE GEOLOGICAL SURVEY
 NOV 15 1967
 CONSERVATION DIVISION
 WICHITA, KANSAS

State of Kansas }
 County of Barton } ss

I, Sam N. Stephens of Garvey Drilling Company

upon oath state the above and foregoing is a true and correct copy of the log of the Heger Unit No. 1 well.

Sam N. Stephens

Subscribed and sworn to before me this 7th day of November 1967

My Commission Expires: November 5th, 1969

Richard A. Boja
 NOTARY PUBLIC