

STATE OF KANSAS
STATE CORPORATION COMMISSION

WELL PLUGGING RECORD

Give All Information Completely
Make Required Affidavit
Mail or Deliver Report to
Conservation Division
State Corporation Comm.
245 North Water
Wichita, KS 67202

Morton County, Sec. 7 Twp. 33S Rge. 41 X/W
Location as "NE/CNW/SW" or footage from lines
660' FSL and 1320' FEL
Lease Owner Tom F. Marsh, Inc.
Lease Name Irene Compton Well No. 1
Office Address P. O. Box 1869 Liberal, KS 67901
Character of Well (Completed as Oil, Gas or Dry Hole)
dry hole
Date Well completed 5-7 1981
Application for plugging filed 5-8 1981
Application for plugging approved 5-8 1981
Plugging commenced 7:00AM 5-8- 1981
Plugging completed 11:00AM 5-9 1981
Reason for abandonment of well or producing formation
dry hole
If a producing well is abandoned, date of last production
n/a 19

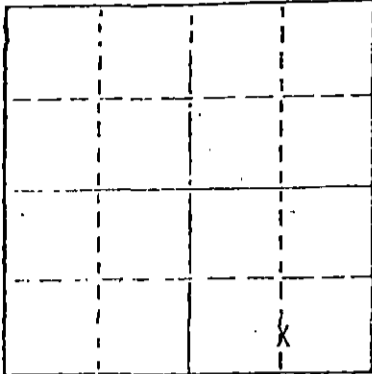

Locate well correctly on above
Section Plot

Name of Conservation Agent who supervised plugging of this well Clarence Thomas
Producing formation _____ Depth to top _____ Bottom _____ Total Depth of Well _____
Show depth and thickness of all water, oil and gas formations.

OIL, GAS OR WATER RECORDS

CASING RECORD

FORMATION	CONTENT	FROM	TO	SIZE	PUT IN	PULLED OUT
				8-5/8"	1564'	none

Describe in detail the manner in which the well was plugged, indicating where the mud fluid was placed and the method or methods used in introducing it into the hold. If cement or other plugs were used, state the character of same and depth placed, from _____ feet to _____ feet for each plug set. Plugged well as follows:

- 25 sx cement @ 3330'
- 25 sx cement @ 3025'
- 25 sx cement @ 2700'
- 25 sx cement @ 2600'
- 60 sx cement @ 1550'
- 25 sx cement @ 700'
- 10 sx cement @ 40-0'
- 5 sx rat hole
- 5 sx mouse hole
- Cut off pipe and welded on ID cap

(If additional description is necessary, use BACK of this sheet)

Name of Plugging Contractor Dowell, Ulysses, KS

STATE OF Kansas COUNTY OF Seward, ss.
Ned E. Lowry (employee of owner) or (owner or operator
of the above-described well, being first duly sworn on oath, says: That I have knowledge of the facts, statements, and matters herein contained and the log of the above-described well as filed and that the same are true and correct. So help me God.

(Signature) Ned E. Lowry, Agent
P. O. Box 1869 Liberal, KS 67901
(Address)

SUBSCRIBED AND SWORN TO before me this 12th day of May, 1981

My commission expires

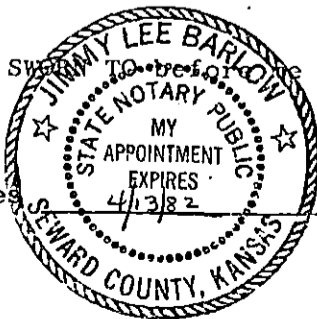

Jimmy Lee Barlow
Notary Public.

RECEIVED
STATE CORPORATION COMMISSION

MAY 13 1981

CONSERVATION DIVISION
Wichita, Kansas

15-129-20504-0000

KANSAS DRILLERS LOG

S. 7 T. 33S R. 41 ~~W~~
 Loc: 660' FSL and 1320' FEL
 County Morton

API No. 15 — 129 — 20,504
 County Number

Operator
Tom F. Marsh, Inc.

Address
P. O. Box 1869, Liberal, KS 67901

Well No. 1 Lease Name Irene Compton

Footage Location 660' 1320'
 feet from ~~XX~~ (S) line feet from (E) ~~WX~~ line

Principal Contractor Weber Drilling Geologist Bill Grant

Spud Date April 27, 1981 Total Depth 5100' P.B.T.D. n/a

Date Completed May 7, 1981 Oil Purchaser n/a

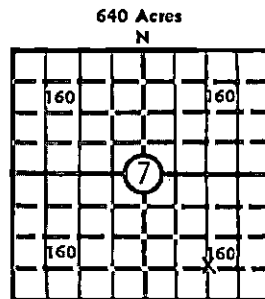

Locate well correctly
 Elev.: Gr. 3430'
 DF 3436' KB _____

CASING RECORD

Report of all strings set— surface, intermediate, production, etc.

Purpose of string	Size hole drilled	Size casing set (in O.D.)	Weight lbs/ft.	Setting depth	Type cement	Sacks	Type and percent additives
surface casing	12-1/4"	8-5/8"	24#	1564'	35/65 poz Class H	650 150	6% gel, 2%cc, f 3% cc

LINER RECORD

PERFORATION RECORD

Top, ft.	Bottom, ft.	Sacks cement	Shots per ft.	Size & type	Depth interval

TUBING RECORD

Size	Setting depth	Packer set at

ACID, FRACTURE, SHOT, CEMENT SQUEEZE RECORD

Amount and kind of material used	Depth interval treated

INITIAL PRODUCTION

Date of first production		Producing method (flowing, pumping, gas lift, etc.)			
RATE OF PRODUCTION PER 24 HOURS	Oil	Gas	Water	Gas-oil ratio	
	bbls.	MCF	bbls.	CFPB	
Disposition of gas (vented, used on lease or sold)			Producing interval(s)		

RECEIVED
 STATE CORPORATION COMMISSION
 MAY 18 1981
 CONSERVATION DIVISION
 Wichita, Kansas

INSTRUCTIONS: As provided in KCC Rule 82-2-125, within 90 days after completion of a well, one completed copy of this Drillers Log shall be transmitted to the State Geological Survey of Kansas, 4150 Monroe Street, Wichita, Kansas 67209. Copies of this form are available from the Conservation Division, State Corporation Commission, 3830 So. Meridian (P.O. Box 17027), Wichita, Kansas 66217. Phone AC 316-522-2206. If confidential custody is desired, please note Rule 82-2-125. Drillers Logs will be on an open file in the Oil and Gas Division, State Geological Survey of Kansas, Lawrence, Kansas 66044.

Operator
Tom F. Marsh, Inc.

DESIGNATE TYPE OF COMP.: OIL, GAS,
DRY HOLE, SWDW, ETC.:
dry hole

Well No.
1

Lease Name
Irene Compton

S 7 T 33S R 41 ~~W~~

WELL LOG

Show all important zones of porosity and contents thereof; cored intervals, and all drill-stem tests, including depth interval tested, cushion used, time tool open, flowing and shut-in pressures, and recoveries.

SHOW GEOLOGICAL MARKERS, LOGS RUN,
OR OTHER DESCRIPTIVE INFORMATION.

FORMATION DESCRIPTION, CONTENTS, ETC.	TOP	BOTTOM	NAME	DEPTH
			1052'	Top Glorietta Sand
			0-2815'	Red Bed
			2815-5100'(TD)	Lime & Shale

USE ADDITIONAL SHEETS, IF NECESSARY, TO COMPLETE WELL RECORD.

Date Received

Tom F. Marsh

Signature

Agent/Tom F. Marsh, Inc.

Title

May 15, 1981

Date