

STATE CORPORATION COMMISSION OF KANSAS
OIL & GAS CONSERVATION DIVISION
WELL COMPLETION OR RECOMPLETION FORM
ACO-1 WELL HISTORY
DESCRIPTION OF WELL AND LEASE

Operator: License # KCC 9620
Name MID-TECH OIL OPERATIONS, INC.
Address P.O. Box 706
City/State/Zip HAYS, KS, 67601

Purchaser PERMIAN CORP.

Operator Contact Person Robert A. Poe
Phone 913-628-6582

Contractor: License #
Name R. AINS WILKINSON

Wellsite Geologist R.W. "woody" PAUL
Phone 913-723-3340

Designate Type of Completion
 New Well Re-Entry Workover
 Oil SWD Temp Abd
 Gas Inj Delayed Comp.
 Dry Other (Core, Water Supply etc.)
If OWO: old well info as follows:
Operator
Well Name
Comp. Date Old Total Depth

WELL HISTORY

Drilling Method:
 Mid Rotary Air Rotary Cable
12-31-84 1- -85 TA-NA
Spud Date Date Reached TD Completion Date
6232 6190
Total Depth PBD

Amount of Surface Pipe Set and Cemented at 1714 feet.
Multiple Stage Cementing Collar Used? Yes No
If yes, show depth set feet
If alternate 2 completion, cement circulated from 1714 feet depth to SURESEED cmt
Cement Company Name HALLIBURTON SERVICES
Invoice # 993914 - LIBERAL, K.

API NO. 15- 189-20,806-0000
County STEVENS
NE NW Sec 24 Twp 32S Rge 35 East
West

4620 Ft North from Southeast Corner of Section
1980 Ft West from Southeast Corner of Section
(Note: Locate well in section plat below)

Lease Name PITTMAN Well # 1

Field Name LARABEE

Producing Formation MISSISSIPPIAN

Elevation: Ground 2969 KB 2978

Section Plat

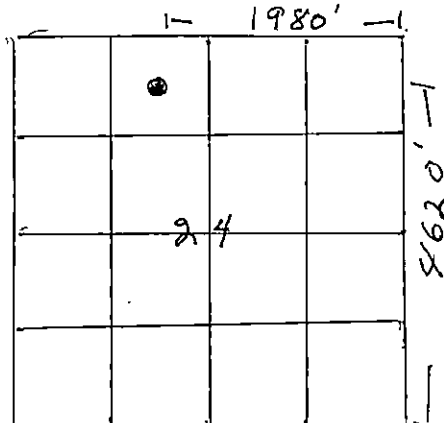

WATER SUPPLY INFORMATION

Disposition of Produced Water: Disposal
Docket # Repressuring

Questions on this portion of the ACO-1 call:

Water Resources Board (913) 296-3717
Source of Water:
Division of Water Resources Permit #
 Groundwater.....Ft North from Southeast Corner
(Well)Ft West from Southeast Corner of
Sec Twp Rge East West
 Surface Water.....Ft North from Southeast Corner
(Stream, pond etc).....Ft West from Southeast Corner
Sec Twp Rge East West
 Other (explain) FARMERS IRRIGATION WELL ON LEASE (PITTMAN)
(purchased from city, R.W.D. #)

INSTRUCTIONS: This form shall be completed in duplicate and filed with the Kansas Corporation Commission, 200 Colorado Derby Building, Wichita, Kansas 67202, within 90 days after completion or recompletion of any well. Rule 82-3-130 and 82-3-107 apply.
Information on side two of this form will be held confidential for a period of 12 months if requested in writing and submitted with the form. See rule 82-3-107 for confidentiality in excess of 12 months.
One copy of all wireline logs and drillers time log shall be attached with this form. Submit CP-4 form with all plugged wells. Submit CP-111 form with all temporarily abandoned wells.

All requirements of the statutes, rules and regulations promulgated to regulate the oil and gas industry have been fully complied with and the statements herein are complete and correct to the best of my knowledge.

Signature Robert G. Poe
Title President Date 3/18/86

Subscribed and sworn to before me this 18th day of March
1986
Notary Public Rogena C. Basgall

Date Commission Expires

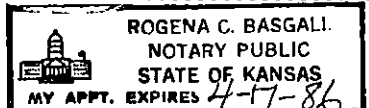

K.C.C. OFFICE USE ONLY
F Letter of Confidentiality Attached
C Wireline Log Received
C Drillers Timelog Received
T Distribution
KCC SWD/Rep NGPA
KGS Plug Other
(Specify)
RECEIVED
STATE CORPORATION COMMISSION

Operator Name: MID-TECH OIL OPERATIONS, INC Lease Name: PITTMAN Well #.....

Sec. 24 Twp. 32S Rge. 35 East West County: STEVENS

WELL LOG

INSTRUCTIONS: Show important tops and base of formations penetrated. Detail all cores. Report all drill stem tests giving interval tested, time tool open and closed, flowing and shut-in pressures, whether shut-in pressure reached static level, hydrostatic pressures, bottom hole temperature, fluid recovery, and flow rates if gas to surface during test. Attach extra sheet if more space is needed. Attach copy of log.

Drill Stem Tests Taken Yes No
 Samples Sent to Geological Survey Yes No
 Cores Taken Yes No

Formation Description
 Log Sample

Name	Top	Bottom
Chester Sand	6088	6098

COPY ATTACHED

CASING RECORD <input type="checkbox"/> New <input type="checkbox"/> Used							
Report all strings set-conductor, surface, intermediate, production, etc.							
Purpose of String	Size Hole Drilled	Size Casing Set (in O.D.)	Weight Lbs/Ft.	Setting Depth	Type of Cement	#Sacks Used	Type and Percent Additives
SURFACE	12 1/4	8 3/8	24#	1714	LITE CLASS. H.	500	2% CC
PRODUCTION		5 1/2	15.5	6232	50/50 POL	150	3% CC 10% SALT
PERFORATION RECORD				Acid, Fracture, Shot, Cement Squeeze Record (Amount and Kind of Material Used)			
Shots Per Foot	Specify Footage of Each Interval Perforated					Depth	
4	6090 - 6096			FRACTURE - 14,500 SAND 10,000 gal DIESEL		6090 - 6096	
TUBING RECORD <u>6100</u> Size <u>2 3/8"</u> Set At <u>6100</u> Packer at <u>—</u>				Liner Run <input type="checkbox"/> Yes <input checked="" type="checkbox"/> No			
Date of First Production	Producing Method <input type="checkbox"/> Flowing <input checked="" type="checkbox"/> Pumping <input type="checkbox"/> Gas Lift <input type="checkbox"/> Other (explain).....						
Estimated Production Per 24 Hours	Oil	Gas	Water	Gas-Oil Ratio	Gravity		
	5 Bbls	MCF	150 Bbls	CFPB			

METHOD OF COMPLETION

Production Interval

Disposition of gas: Vented Open Hole Perforation
 Sold Other (Specify) 6090-6096
 Used on Lease Dually Completed Commingled
NONE

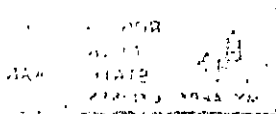

CHENEY TESTING COMPANY, INC.

P. O. Box 367

HILL CITY, KANSAS 67642

DRILL-STEM TEST DATA

Company <u>Mid-Tech Oil Operations Inc.</u>	Test No. <u>1</u>
Well Name & Number <u>Pittman #1</u>	Zone Tested <u>Chester Sand</u>
Company Address <u>P.O. Box 706 Hays, Ks.</u>	Date <u>1/13/85</u>
Company Rep. <u>Robert Poe</u>	Tester <u>Walt Brown</u>
Contractor <u>Rains & Williamson</u>	Elevation <u>2987 KB</u>
Location: Sec. <u>24</u> Twp. <u>32s</u> Rge. <u>35w</u> Co. <u>Steven State Ks.</u>	Est. Feet of Pay <u>17</u>

Recorder No. 13637 Type AK-1 Range 6075 PSI
 Recorder Depth 6110 Clock # 25560
 (A) Initial Hydrostatic Mud 2983 PSI
 (B) First Initial Flow Pressure -- PSI
 (C) First Final Flow Pressure -- PSI
 (D) Initial Shut-in Pressure 1802 PSI
 (E) Second Initial Flow Pressure 116 PSI
 (F) Second Final Flow Pressure 264 PSI
 (G) Final Shut-in Pressure 1729 PSI
 (H) Final Hydrostatic Mud 2889 PSI
 Temperature 118
 Mud Weight 9.1 Viscosity 43
 Fluid Loss 9.8
 Interval Tested 6097-6120
 Anchor Length 23
 Top Packer Depth 6092
 Bottom Packer Depth 6097
 Total Depth 6120
 Drill Pipe Size 4 1/2 XH
 Wt. Pipe I. D. _____ Ft. Run _____
 Recovery-Total Feet 445

Recorder No. 7456 Type AK-1 Range 4150 PSI
 Recorder Depth 6115 Clock # 25720
 Tool Open Before I.S.I. 30 Mins.
 Initial Shut-in 60 Mins.
 Flow Period 60 Mins.
 Final Shut-in 60 Mins.
 Top Choke Size 1" Hole Size 7 7/8"
 Bottom Choke Size 3/4" Rubber Size 6 3/4"
 Tool Open @ 7:45 AM
 Blow Remarks 1st open: Weak dying blow, blow died.
2nd open: No blow, flushed tool & started getting building blow, blow at bottom of 5 gal. bucket in 20 minutes.
 Drill Collars I.D. 2.25 Ft. run 452.

Recovered 15 Feet Of 90% oil & 10% mud.
 Recovered 125 Feet Of 10% oil & 90% mud.
 Recovered 125 Feet Of 3% oil, 37% water & 60% mud.
 Recovered 180 Feet Of 5% mud & 95% water.
 Recovered _____ Feet Of Salt Water Chlorides: 55,000 ppm.
 Recovered _____ Feet Of _____
 Extra Equipment Bowen Jars, Safety Joint, Down Hole Insurance Price of Job \$1140.00

MILLER PRINTERS, INC.
Great Bend, Kansas

MAR 21 1985

CONSERVATION DIVISION
Wichita, Kansas

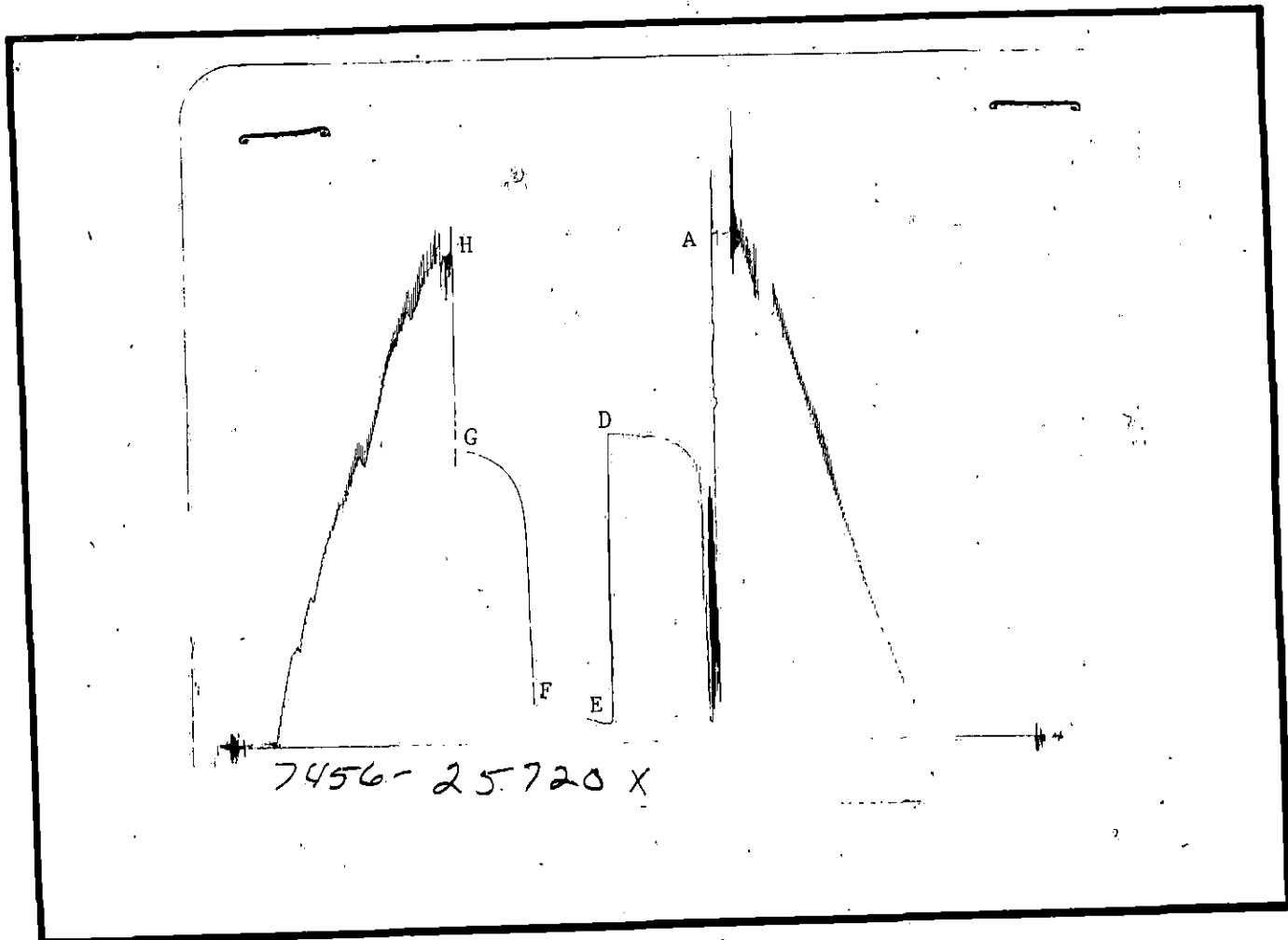

This is an actual photograph of recorder chart.

POINT	PRESSURE		PSI
	Field Reading	Office Reading	
(A) Initial Hydrostatic Mud	2983	2978	PSI
(B) First Initial Flow Pressure	--	--	PSI
(C) First Final Flow Pressure	--	--	PSI
(D) Initial Closed-in Pressure	1802	1819.9	PSI
(E) Second Initial Flow Pressure	116	114.4	PSI
(F) Second Final Flow Pressure	264	230.9	PSI
(G) Final Closed-in Pressure	1729	1744.7	PSI
(H) Final Hydrostatic Mud	2889	2884	PSI