

*\*Amended*

SIDE ONE

STATE CORPORATION COMMISSION OF KANSAS  
OIL & GAS CONSERVATION DIVISION

WELL COMPLETION OR RECOMPLETION FORM  
ACO-1 WELL HISTORY

DESCRIPTION OF WELL AND LEASE

Operator: License # 5208  
Name Mobil Oil Corporation  
Address P.O. Box 5444  
Denver, CO 80217

Purchaser N/A

Operator Contact Person J. E. Dawson  
Phone (303) 298-2596

Contractor: License # 9137  
Name Unit Drilling & Exploration

Wellsite Geologist T. N. Tvrdik  
Phone (303) 298-3689

Designate Type of Completion  
 New Well     Re-Entry     Workover  
 Oil     SWD     Temp Abd  
 Gas     Inj     Delayed Comp.  
 Dry     Other (Core, Water Supply etc.)

If OWWO: old well info as follows:  
Operator .....  
Well Name .....  
Comp. Date ..... Old Total Depth.....

WELL HISTORY

Drilling Method:  
 Mud Rotary     Air Rotary     Cable

7/17/86    7/24/86    7/26/86  
Spud Date    Date Reached TD    Completion Date  
6400'    P&A'd    Plug & Abandon  
Total Depth    PBTD

Amount of Surface Pipe Set and Cemented at 1802 feet  
Multiple Stage Cementing Collar Used?  Yes  No  
If yes, show depth set.....feet  
If alternate 2 completion, cement circulated  
from.....feet depth to.....w/.....SX cmt

5 API NO. 15-189-20917-1-9999  
County Stevens  
SE NE SE 35 32S Rge 35  East  
..... Sec..... Twp..... Rge.....  West  
1650  
330 Ft North from Southeast Corner of Section  
..... Ft West from Southeast Corner of Section  
(Note: Locate well in section plat below)  
Lease Name Josephine E. Burchett Well #. 2.  
Field Name North Shuck  
Producing Formation.....  
Elevation: Ground 2947 KB 2961

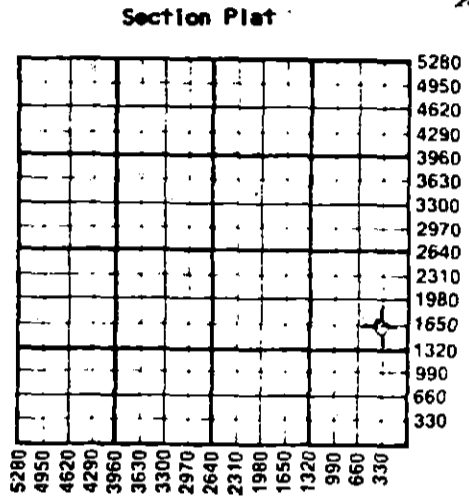

*11-21-86*  
*1 1986*

WATER SUPPLY INFORMATION  
Disposition of Produced Water:  Disposal  
Docket # na  Repressuring

Questions on this portion of the ACO-1 call:  
Water Resources Board (913) 296-3717  
Source of Water:  
Division of Water Resources Permit # T86-262  
 Groundwater 4898 Ft North from Southeast Corner  
(Well) 105 Ft West from Southeast Corner of  
Sec Twp Rge  East  West  
 Surface Water.....Ft North from Southeast Corner  
(Stream, pond etc).....Ft West from Southeast Corner  
Sec Twp Rge  East  West  
 Other (explain).....  
(purchased from city, R.W.D. #)

INSTRUCTIONS: This form shall be completed in duplicate and filed with the Kansas Corporation Commission, 200 Colorado Derby Building, Wichita, Kansas 67202, within 90 days after completion or recompletion of any well. Rule 82-3-130 and 82-3-107 apply.  
Information on side two of this form will be held confidential for a period of 12 months if requested in writing and submitted with the form. See rule 82-3-107 for confidentiality in excess of 12 months.  
One copy of all wireline logs and drillers time log shall be attached with this form. Submit CP-4 form with all plugged wells. Submit CP-111 form with all temporarily abandoned wells.

All requirements of the statutes, rules and regulations promulgated to regulate the oil and gas industry have been fully complied with and the statements herein are complete and correct to the best of my knowledge.

Signature J. E. Dawson

Title Producing Accounting Supervisor Date 10-9-86

Subscribed and sworn to before me this 9th day of October  
1986  
Notary Public Deborah Cavetta  
MY COMMISSION EXPIRES 7/2/90

Date Commission Expires.....

K.C.C. OFFICE USE ONLY  
F  Letter of Confidentiality Attached  
C  Wireline Log Received  
C  Drillers Timelog Received  
Distribution  
 KCC     SWD/Rep     NGPA  
 KGS     Plug     Other  
(Specify)

\* J. E. Dawson 11.19.86  
Subscribed & sworn to before me this 19th day of November, 1986.  
Deborah Cavetta  
Notary  
MY COMMISSION EXPIRES 7/2/90

Sec. 35 Twp. 32 S. Rge. 35 E.

Operator Name Mobil Oil Corporation Lease Name Josephine E. Burchett # 2

Sec 35 Twp 32S Rge 35 East West County Stevens

WELL LOG

INSTRUCTIONS: Show important tops and base of formations penetrated. Detail all cores. Report all drill stem tests giving interval tested, time tool open and closed, flowing and shut-in pressures, whether shut-in pressure reached static level, hydrostatic pressures, bottom hole temperature, fluid recovery, and flow rates if gas to surface during test. Attach extra sheet if more space is needed. Attach copy of log.

Drill Stem Tests Taken  Yes  No  
 Samples Sent to Geological Survey  Yes  No  
 Cores Taken  Yes  No

Formation Description  
 Log  Sample

Plugging Procedure:

60 sxs class "H" neat 5898'-5799'  
 70 sxs class "H" neat 3366'-3238'  
 70 sxs class "H" neat 3025'-2895'  
 70 sxs class "H" neat 2672'-2464'  
 80 sxs class "H" neat 1887'-1732'  
 50 sxs class "H" neat 620'-464'  
 20 sxs class "H" neat 45'-surface

Name	Top	Bottom
* Chase	2635	
Winfield	2740	
Council Grove	2970	
Admire	3242	
Wabaunsee	3355	
Lansing	4310	
Kansas City	4650	
Marmaton	5080	
Cherokee	5240	
Morrow	5655	
Chester	5910	
St. Genevieve	6170	
St. Louis	6255	
T.D.	6400	

CASING RECORD <input checked="" type="checkbox"/> New <input type="checkbox"/> Used Report all strings set-conductor, surface, intermediate, production, etc.							
Purpose of String	Size Hole Drilled	Size Casing Set (in O.D.)	Weight Lbs/Ft.	Setting Depth	Type of Cement	#Sacks Used	Type and Percent Additives
Surface	12 1/2"	8 5/8"	24#	1802'	65/35-6	640	3% CaCl2
					N/A	80	2% CaCl2
PERFORATION RECORD				Acid, Fracture, Shot, Cement Squeeze Record			
Shots Per Foot	Specify Footage of Each Interval Perforated			(Amount and Kind of Material Used)		Depth	
	N/A			(See plugging procedure above)			
TUBING RECORD				Liner Run <input type="checkbox"/> Yes <input type="checkbox"/> No			
Date of First Production		Size Set At		Packer at			
N/A		N/A		N/A			
Producing Method <input type="checkbox"/> Flowing <input type="checkbox"/> Pumping <input type="checkbox"/> Gas Lift <input type="checkbox"/> Other (explain).....							
Estimated Production Per 24 Hours							
Oil		Gas		Water		Gas-Oil Ratio	
Bbls		MCF		Bbls		CFPE	

METHOD OF COMPLETION

Production Interval

Disposition of gas:  Vented  Open Hole  Perforation  
 Sold  Other (Specify) .....  
 Used on Lease  Dually Completed  Commingled

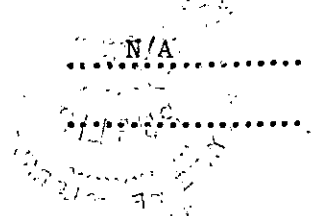

STATE CORPORATION COMMISSION OF KANSAS  
OIL & GAS CONSERVATION DIVISION

WELL COMPLETION OR RECOMPLETION FORM  
ACO-1 WELL HISTORY

DESCRIPTION OF WELL AND LEASE

Operator: License # 5208  
Name Mobil Oil Corporation  
Address P.O. Box 5444  
City/State/Zip Denver, CO 80217

Purchaser N/A

Operator Contact Person J. E. Dawson  
Phone (303) 298-2696

Contractor: License # 9137  
Name Unit Drilling & Exploration

Wellsite Geologist T. N. Tvrdik  
Phone (303) 298-3689

Designate Type of Completion  
 New Well  Re-Entry  Workover  
 Oil  SWD  Temp Abd  
 Gas  Inj  Delayed Comp.  
 Dry  Other (Core, Water Supply etc.)

If OWNO: old well info as follows:  
Operator \_\_\_\_\_  
Well Name \_\_\_\_\_  
Comp. Date \_\_\_\_\_ Old Total Depth \_\_\_\_\_

WELL HISTORY

Drilling Method:  
 Mud Rotary  Air Rotary  Cable

7/17/86 7/24/86 7/26/86  
Spud Date Date Reached TD Completion Date  
6400' P&A'd Plug & Abandon  
Total Depth PBD

Amount of Surface Pipe Set and Cemented at 1802 feet  
Multiple Stage Cementing Collar Used?  Yes  No  
If yes, show depth set \_\_\_\_\_ feet  
If alternate 2 completion, cement circulated  
from \_\_\_\_\_ feet depth to \_\_\_\_\_ w/ \_\_\_\_\_ SX cmt

API NO. 15-189-20917

County Stevens  
SE NE SE Sec 35 32S Rge 35  East  
 West

1650  
330 Ft North from Southeast Corner of Section  
Ft West from Southeast Corner of Section  
(Note: Locate well in section plat below)

Lease Name Josephine E. Burchett Well # 2  
Field Name North Shuck

Producing Formation \_\_\_\_\_  
Elevation: Ground APP. 2947 KB. 2961

Section Plat

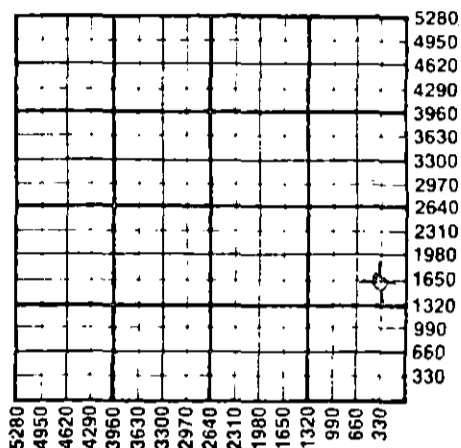

WATER SUPPLY INFORMATION

Disposition of Produced Water:  Disposal  
Docket # n/a  Repressuring

Questions on this portion of the ACO-1 call:  
Water Resources Board (913) 296-3717

Source of Water:  
Division of Water Resources Permit # T86-262

Groundwater 4898 Ft North from Southeast Corner  
105 Ft West from Southeast Corner  
Sec Twp Rge  East  West

Surface Water \_\_\_\_\_ Ft North from Southeast Corner  
\_\_\_\_\_ Ft West from Southeast Corner  
Sec Twp Rge  East  West

Other (explain) \_\_\_\_\_  
(purchased from city, R.W.D. #)

INSTRUCTIONS: This form shall be completed in duplicate and filed with the Kansas Corporation Commission, 200 Colorado Derby Building, Wichita, Kansas 67202, within 90 days after completion or recompletion of any well. Rule 82-3-130 and 82-3-107 apply.

Information on side two of this form will be held confidential for a period of 12 months if requested in writing and submitted with the form. See rule 82-3-107 for confidentiality in excess of 12 months. One copy of all wireline logs and drillers time log shall be attached with this form. Submit CP-4 form with all plugged wells. Submit CP-111 form with all temporarily abandoned wells.

All requirements of the statutes, rules and regulations promulgated to regulate the oil and gas industry have been fully complied with and the statements herein are complete and correct to the best of my knowledge.

Signature J. E. Dawson  
Title Producing Accounting Supervisor Date 10-9-86

Subscribed and sworn to before me this 9th day of October 1986  
Notary Public Deborah A. Cavette  
Date Commission Expires 7/2/90

K.C.C. OFFICE USE ONLY  
F  Letter of Confidentiality Attached  
C  Wireline Log Received  
C  Drillers Timelog Received  
Distribution  
 KCC  SWD/Rep  NGPA  
 KGS  Plug  Other  
(Specify)  
RECEIVED  
STATE CORPORATION COMMISSION  
CONSERVATION DIVISION  
WICHITA, KANSAS

Sec 35 Twp 32S Rge 35W

SIDE TWO

Operator Name Mobil Oil Corporation Lease Name Josephine E. Burchett # 2

Sec. 35 Twp. 32S Rge. 35 East  West  County Stevens

WELL LOG

INSTRUCTIONS: Show important tops and base of formations penetrated. Detail all cores. Report all drill stem tests giving interval tested, time tool open and closed, flowing and shut-in pressures, whether shut-in pressure reached static level, hydrostatic pressures, bottom hole temperature, fluid recovery, and flow rates if gas to surface during test. Attach extra sheet if more space is needed. Attach copy of log.

Drill Stem Tests Taken  Yes  No  
 Samples Sent to Geological Survey  Yes  No  
 Cores Taken  Yes  No

Formation Description  
 Log  Sample

Name Top Bottom

Plugging Procedure:

60 sxs class "H" neat 5898'-5799'  
 70 sxs class "H" neat 3366'-3238'  
 70 sxs class "H" neat 3025'-2895'  
 70 sxs class "H" neat 2672'-2464'  
 80 sxs class "H" neat 1887'-1732'  
 50 sxs class "H" neat 620'-464'  
 20 sxs class "H" neat 45'-surface

CASING RECORD <input checked="" type="checkbox"/> New <input type="checkbox"/> Used							
Report all strings set-conductor, surface, intermediate, production, etc.							
Purpose of String	Size Hole Drilled	Size Casing Set (in O.D.)	Weight Lbs/Ft.	Setting Depth	Type of Cement	#Sacks Used	Type and Percent Additives
Surface	12 1/4"	8 5/8"	24#	1802'	65/35-6	640	3% CaCl2
					N/A	80	2% CaCl2
PERFORATION RECORD				Acid, Fracture, Shot, Cement Squeeze Record			
Shots Per Foot	Specify Footage of Each Interval Perforated			(Amount and Kind of Material Used)		Depth	
	N/A			(See plugging procedure above)			
TUBING RECORD		Size	Set At	Packer at	Liner Run	<input type="checkbox"/> Yes <input type="checkbox"/> No	
		N/A					
Date of First Production		Producing Method					
N/A		<input type="checkbox"/> Flowing <input type="checkbox"/> Pumping <input type="checkbox"/> Gas Lift <input type="checkbox"/> Other (explain)					
Estimated Production Per 24 Hours		Oil	Gas	Water	Gas-Oil Ratio	Gravity	
		Bbls	MCF	Bbls			

METHOD OF COMPLETION

Disposition of gas:  Vented  Open Hole  Perforation  
 Sold  Other (Specify) .....  
 Used on Lease  Dually Completed  
 Commingled

Production Interval

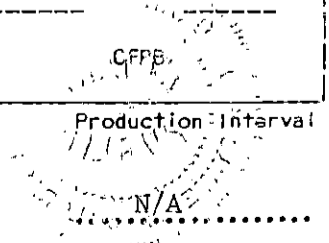

# Mobil Oil Corporation

P.O. BOX 5444  
DENVER, COLORADO 80217-5444

8 October, 1986

Ms. Kathy Carlisle  
Kansas State Corporation Commission  
Conservation Division  
200 Colorado Derby Building  
202 West First Street  
Wichita, KS 67202-1286

WELL NAME: Josephine E. Burchett # 2  
LOCATION: Mc 35-325-35W  
COUNTY: Stevens

Dear Ms. Carlisle:

In reference to the subject well, enclosed are the following items:

- / ✓ Well History & geological data will be forwarded.
- / / Logs \_\_\_\_\_
- / / Confidentiality Request

Very truly yours,

*J. E. Dawson*

J. E. Dawson  
Producing Accounting Supervisor

BABagnall/iml  
Enclosures

RECEIVED  
STATE CORPORATION COMMISSION  
CONS. DIV. WICHITA, KS

OCT 14 1986

SUPPLEMENT TO WELL RECORD

DATE 2-29-88

LEASE <u>Josephine E. Bierchutt</u>	WELL NO. <u>2</u>	DIVISION	REGION
--	----------------------	----------	--------

STATE	COUNTY OR PARISH
-------	------------------

REASON FOR WORK <u>Convert to SWP</u>	<input type="checkbox"/> WORK OVER <input type="checkbox"/> CLEAN OUT <input type="checkbox"/> RECOMPLETION <input type="checkbox"/> DRILL DEEPER <input type="checkbox"/> REDRILL <input type="checkbox"/> ABANDONMENT
--	--

APPROPRIATION NO.	AMOUNT REQUESTED \$	APPROXIMATE EXPENDITURE \$	ESTIMATED MONTHS TO PAY OUT
-------------------	------------------------	-------------------------------	-----------------------------

WORK PERFORMED BY <u>Patrick Well Service</u>	DATE WORK COMMENCED	DATE COMPLETED <u>RECEIVED</u>
--	---------------------	-----------------------------------

POTENTIAL TEST AFTER

---



---

PREVIOUS T.D.	P.B.T.D.	MEASURING POINT <u>RECEIVED</u> WICHITA CONSERVATION COMMISSION
PRESENT T.D.	P.B.T.D.	MEASURING POINT <u>MAY 1 - 1985</u>

PREVIOUS PRODUCING FORMATION (S) AND DEPTH (S)	PRESENT PRODUCING FORMATION (S) AND DEPTH (S)
--	---

CHANGE (S) IN CASING RECORD

CONSERVATION DIVISION  
Wichita, Kansas

SUMMARY OF OPERATIONS

Rig up Patrick rig 16 + Acme tool - Drill out cement from surface to 45 ft - 464' to 620 ft - Circulate hole clean to plug at 1802 ft. Schlumberger logged 8 3/8 hole & ran CBC - Run 5 1/2" liner - set at 1524 - Rig up Howco & circulate cement to surface. Let cement set 48 hrs - Schlumberger perforated from 1370' to 99' w/ 45pl. Howco ran PPT tool and chanced perfor w/ 50 gal /ft 15% Hcl - Pumped 1500 gal 15% HCL - 4.5 BBL min @ 1800#. Run Baker AD-1 Tension packer set @ 1304 w/ 10 gals on 42 gals 2 3/8 TBWg - Test circulated Packer fluid on back side - Tested to 500# - Richard Lacy of KCC w/ Howard - established injection rate of 2.75 BBL @ 130# - on UAC @ 1.75 BPL -

Ver Schock

WELL J. B. Burchett # C

LOCATION \_\_\_\_\_

PRESENT COMPLETION

DATUM ELEVATION \_\_\_\_\_

G. L. ELEVATION \_\_\_\_\_

SURFACE CASING

Size & Wt. \_\_\_\_\_

Set at \_\_\_\_\_ feet

with \_\_\_\_\_ Sx.

PRODUCTION CASING

Size & Wt. \_\_\_\_\_

Grade \_\_\_\_\_

Condition \_\_\_\_\_

Set at \_\_\_\_\_ feet

with \_\_\_\_\_ Sx.

2-29-88  
W. Schach

MINOR CONSTRUCTION  
EMERGENCY

RECEIVED

Perfs  
1370, to 99  
45PF

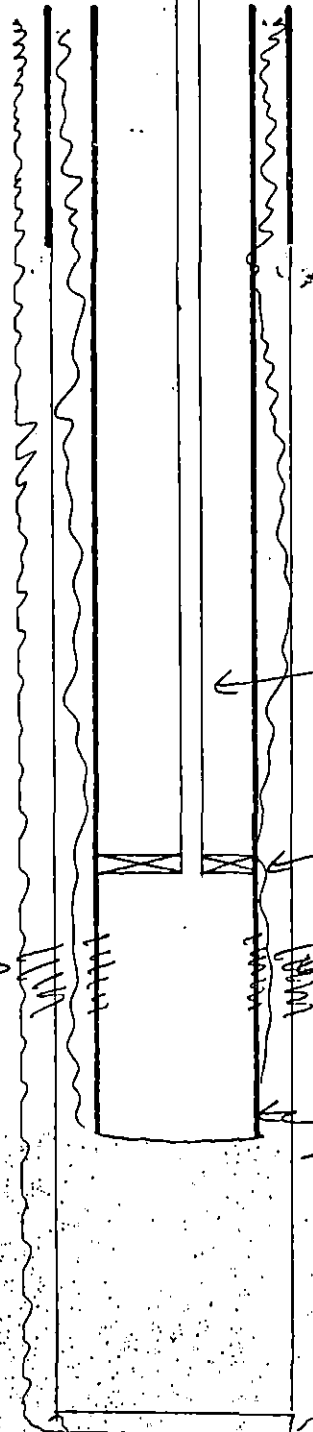

← 42 lbs 2 3/8 PBM

Baker AD-1  
Packer Set w/Tow Pts  
@ 1304

8 5/8 24#  
CSNG - Cement  
to Surface

← 5 1/2" 14# CSNG  
@ 1524 w cement  
to Surface

1802

2509  
3550 POZ

2464'  
2672'  
2895'  
3025'  
5799'  
5898'

7 7/8" Hole

+D 1400

RECEIVED  
STATE CORPORATION COMMISSION

MAY 11 1988

CONSERVATION DIVISION  
Wichita, Kansas