

TYPE

AFFIDAVIT OF COMPLETION FORM

ACO-1 WELL HISTORY

SIDE ONE

Two (2) copies of this form shall be filed with the Kansas Corporation Commission, 200 Colorado Derby Building, Wichita, Kansas 67202, within thirty (30) days after the completion of a well, regardless of how the well was completed.

Attach separate letter of request if the information is to be held confidential. If confidential, only file one copy. Information on Side One will be of public record and Side Two will then be held confidential.

Applications must be made on dual completion, commingling, salt water disposal, injection and temporarily abandoned wells.

Attach one copy only wireline logs (i.e. electrical log, sonic log, gamma ray neutron log, etc.). (Rules 82-2-105 & 82-2-125) KCC# (316) 263-3238.

LICENSE # 6878 EXPIRATION DATE 6/30/83

OPERATOR Northern Natural Gas Producing Co. API NO. 15-189-20583-0000

ADDRESS P. O. Box 5444 COUNTY Stevens

Denver, CO 80217 FIELD Panoma

** CONTACT PERSON C. J. Park, Producing Acctg. Supv. PROD. FORMATION Council Grove PHONE 303/572-3696

PURCHASER Northern Natural Gas LEASE Morrell No. 1 Unit

ADDRESS 2223 Dodge Street WELL NO. #2

Omaha, Nebraska 68102 WELL LOCATION Sec. 14-32S-36W

DRILLING EARL F. Wakefield, Inc. 2450 Ft. from North Line and

CONTRACTOR 300 W. Douglass, Suite 500 2450 Ft. from West Line of

Wichita, Kansas 67202 the NW/4 (Qtr.) SEC 14 TWP 32S RGE 36W.

PLUGGING CONTRACTOR ADDRESS

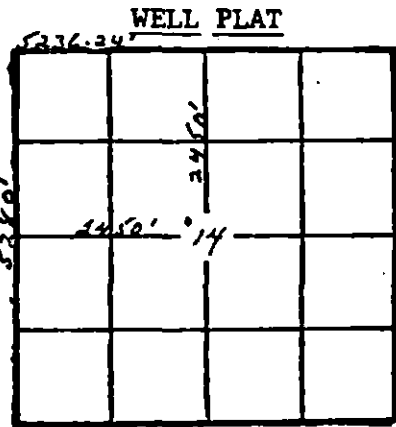

(Office Use Only)

KCC KGS

SWD/REP PLG.

TOTAL DEPTH 3160' PBTD 3147'

SPUD DATE 6/11/82 DATE COMPLETED 7/7/82

ELEV: GR 3043' DF - KB 3052'

DRILLED WITH (CABLE) (ROTARY) (AIR) TOOLS.

DOCKET NO. OF DISPOSAL OR REPRESSURING WELL BEING USED TO DISPOSE OF WATER FROM THIS LEASE 82,408-C (C-13,821)

Amount of surface pipe set and cemented 624' DV Tool Used? No

THIS AFFIDAVIT APPLIES TO: (Circle ONE) - Oil, Gas, Shut-in Gas, Dry, Disposal, Injection, Temporarily Abandoned, OWWO. Other

ALL REQUIREMENTS OF THE STATUTES, RULES AND REGULATIONS PROMULGATED TO REGULATE THE OIL AND GAS INDUSTRY HAVE BEEN FULLY COMPLIED WITH.

AFFIDAVIT

C. J. Park, being of lawful age, hereby certifies that:

I am the Affiant, and I am familiar with the contents of the foregoing Affidavit. The statements and allegations contained therein are true and correct.

C. J. Park (Name)

SUBSCRIBED AND SWORN TO BEFORE ME this 8 day of November, 1982.

Judith A. Olsen (NOTARY PUBLIC)

MY COMMISSION EXPIRES: 11-28-84

** The person who can be reached by phone regarding any questions concerning this information.

82-12.99

SIDE TWO

ACO-1 WELL HISTORY

OPERATOR Mobil Oil Corporation LEASE Morrell No. 1 #2 SEC. 14 TWP. 32S RGE. 36W

FILL IN WELL LOG AS REQUIRED:

SHOW GEOLOGICAL MARKERS, LOGS RUN, OR OTHER DESCRIPTIVE INFORMATION.

FORMATION DESCRIPTION, CONTENTS, ETC.	TOP	BOTTOM	NAME	DEPTH
Surface Sand - Clay	0	525	Stone Corral	1747
Red Bed	525	950	Chase	2644
Shale Gyp Streaks	950	1240	Council Grove	2954
Sand	1240	1470		
Shale & Gyp	1470	2255		
Shale	2255	2400		
Shale & Lime	2400	3070		
Lime & Shale	3070	3160		
R.T.D.	3160	3160		

Report of all strings set — surface, intermediate, production, etc. **CASING RECORD** (New) or (Used)

Purpose of string	Size hole drilled	Size casing set (in O.D.)	Weight lbs/ft.	Setting depth	Type cement	Sacks	Type and percent additives
Surface Casing	12 1/4"	8 5/8"	24#	624'	Class H	150	12% gel, 3% CaCl ₂
					Class H	150	3% CaCl ₂
Production casing	7 7/8"	5 1/2"	14#	3160'	Class H	500	6% gel, 1/2# D-29
					Class H	150	18% salt, 3/4% D-65, .02% D-45

LINER RECORD

PERFORATION RECORD

Top, ft.	Bottom, ft.	Cement	Shots per ft.	Size & type	Depth interval
			2 H/Ft.		3013/3017, 2991/3003,

TUBING RECORD

Size	Setting depth	Factor set at	Depth interval
2 3/8"	3029.7'		2985/2989, 2965/2968

ACID, FRACTURE, SHOT, CEMENT SQUEEZE RECORD

Amount and kind of material used	Depth interval treated
Acidized down 5 1/2" casing w/504 gal. 1401 acid & additives w/69 ball sealers.	3017/2965

Date of first production	Producing method (Flowing, pumping, gas lift, etc.)	Gravity
Awaiting pipeline connection	-	Awaiting pipeline connection

RATE OF PRODUCTION PER 24 HOURS	Oil	Gas	Water	Gas-oil ratio
	bbls.	McF	%	bbls.

Disposition of gas (vented, used on lease or sold)	Perforations
Awaiting pipeline connection	3017/2965