

15-119-20459-0000

STATE OF KANSAS
STATE CORPORATION COMMISSION

WELL PLUGGING RECORD

Give All Information Completely
Make Required Affidavit
Mail or Deliver Report to
Conservation Division
State Corporation Comm.
245 North Water
Wichita, KS 67202

Meade County, Sec. 7 Twp. 31S Rge. 29 R/W
Location as "NE/CNW $\frac{1}{4}$ /SW $\frac{1}{4}$ " or footage from lines _____
C NW SW
Lease Owner Argo Petroleum
Lease Name Fred Miles Well No. 1
Office Address P. O. Box 1869 Liberal, KS 67901

Character of Well (Completed as Oil, Gas or Dry Hole) _____
Dry Hole

Date Well completed 4-5 1981
Application for plugging filed 4-5 1981
Application for plugging approved 4-5 1981
Plugging commenced 4-5 1981
Plugging completed 6:30PM 4-5 1981

Reason for abandonment of well or producing formation _____
dry hole
If a producing well is abandoned, date of last production _____
n/a 1981

Was permission obtained from the Conservation Division or its agents before plugging was commenced? yes

Name of Conservation Agent who supervised plugging of this well Morris Leslie
Producing formation _____ Depth to top _____ Bottom _____ Total Depth of Well 5890
Show depth and thickness of all water, oil and gas formations.

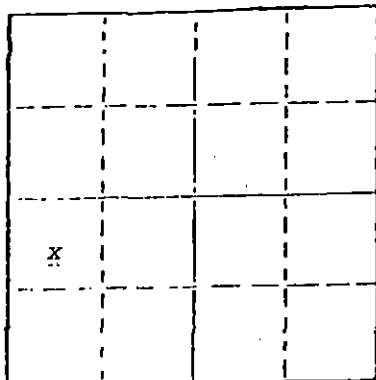

OIL, GAS OR WATER RECORDS

CASING RECORD

FORMATION	CONTENT	FROM	TO	SIZE	PUT IN	PULLED OUT
				8-5/8"	1574'	none

Describe in detail the manner in which the well was plugged, indicating where the mud fluid was placed and the method or methods used in introducing it into the hold. If cement or other plugs were used, state the character of same and depth placed, from _____ feet to _____ feet for each plug set.

Well plugged as follows:
50 sx cement @ 1600'
30 sx cement @ 800'
10 sx cement @ 40-0'
5 sx rat

Cut off pipe and welded on ID cap

(If additional description is necessary, use BACK of this sheet)
Name of Plugging Contractor Halliburton - Liberal, KS

RECEIVED
STATE CORPORATION COMMISSION
4-13-81
APR 13 1981
CONSERVATION DIVISION
WICHITA, KANSAS

STATE OF Kansas COUNTY OF Seward
Ned E. Lowry (employee of owner) or owner or operator
of the above-described well, being first duly sworn on oath, says: That I have knowledge of the facts, statements, and matters herein contained and the log of the above-described well as filed and that the same are true and correct. So help me God.

(Signature) Ned E. Lowry
Ned E. Lowry
P. O. Box 1869 Liberal, KS 67901
(Address)

SUBSCRIBED AND SWORN TO before me this 10th day of April, 1981

My commission expires _____

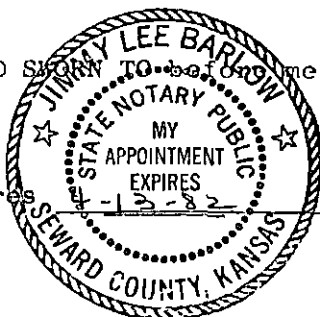

Jimmy Lee Barlow
Notary Public.

KANSAS DRILLERS LOG

API No. 15 — 119 — 20459-0000
 County Number

S. 7 T. 31S R. 29 ~~XX~~
 W

Loc.: C NW SW

County Meade

Operator
Argo Petroleum

Address
P. O. Box 1869 Liberal, KS 67901

Well No. 1 Lease Name Fred Miles

Footage Location
1980 feet from ~~NN~~ (S) line 660 feet from ~~XX~~ (W) line

Principal Contractor Service Drilling Contractor Geologist Marc Harvey

Spud Date 3-13-81 Total Depth 5890' P.B.T.D. n/a

Date Completed 4-6-81 Oil Purchaser n/a

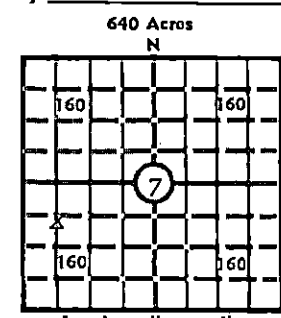

Elev.: Gr. 2742'

DF 2748' KB 2751'

CASING RECORD

Report of all strings set — surface, intermediate, production, etc.

Purpose of string	Size hole drilled	Size casing set (in O.D.)	Weight lbs/ft.	Setting depth	Type cement	Sacks	Type and percent additives
surface casing	12-1/4"	8-5/8"	24#	1572'	lite Class H	600 150	2%cc 2%cc

LINER RECORD

PERFORATION RECORD

Top, ft.	Bottom, ft.	Sacks cement	Shots per ft.	Size & type	Depth interval

TUBING RECORD

Size	Setting depth	Packer set at

ACID, FRACTURE, SHOT, CEMENT SQUEEZE RECORD

Amount and kind of material used

RECEIVED
 STATE CORPORATION COMMISSION
 APR 13 1981
 CONSERVATION DIVISION
 Wichita, Kansas

INITIAL PRODUCTION

Date of first production _____ Producing method (flowing, pumping, gas lift, etc.) _____

RATE OF PRODUCTION PER 24 HOURS	Oil	Gas	Water	Gas-oil ratio

Disposition of gas (vented, used on lease or sold) _____ Producing interval (s) _____

INSTRUCTIONS: As provided in KCC Rule 82-2-125, within 90 days after completion of a well, one completed copy of this Drillers Log shall be transmitted to the State Geological Survey of Kansas, 4150 Monroe Street, Wichita, Kansas 67209. Copies of this form are available from the Conservation Division, State Corporation Commission, 3830 So. Meridian (P.O. Box 17027), Wichita, Kansas 66217. Phone AC 316-522-2206. If confidential custody is desired, please note Rule 82-2-125. Drillers Logs will be on an open file in the Oil and Gas Division, State Geological Survey of Kansas, Lawrence, Kansas 66044.

Operator
Argo Petroleum

DESIGNATE TYPE OF COMP.: OIL, GAS,
DRY HOLE, SWDW, ETC.:

Well No.
1

Lease Name
Fred Miles

Dry hole

S 7 T 31S R 29 ^{EX}
W

WELL LOG

Show all important zones of porosity and contents thereof; cored intervals, and all drill-stem tests, including depth interval tested, cushion used, time tool open, flowing and shut-in pressures, and recoveries.

SHOW GEOLOGICAL MARKERS, LOGS RUN,
OR OTHER DESCRIPTIVE INFORMATION.

FORMATION DESCRIPTION, CONTENTS, ETC.	TOP	BOTTOM	NAME	DEPTH
DST #1 2701-2780'			Chase	2672' +79
DST #2 3051-3095'			Krider	2722' +29
DST #3 3403-3436'			Winfield	2768 -17
DST #4 5056-5116'			V. Ft. Riley	2826' -75
DST #5 5351-5419'			Florence, Flant	2930 -179
			Raford	2974 -223
			Council Grove	2994 +243
			Heubner	4284 -1533
			Toronto	4304 -1553
			Lansing	4400 -1649
			K.C.	4664 -1913
			Marmaton	5024 -2273
			Atoka	5236 -2485
			Morrow	5322 -2571
			Chester	5348 -2597

USE ADDITIONAL SHEETS, IF NECESSARY, TO COMPLETE WELL RECORD.

Date Received

Fred E. Lewis
Signature

Agent, Argo Petroleum

Title

April 10, 1981

Date