

STATE CORPORATION COMMISSION OF KANSAS  
OIL & GAS CONSERVATION DIVISION  
WELL COMPLETION OR RECOMPLETION FORM  
ACO-1 WELL HISTORY  
DESCRIPTION OF WELL AND LEASE

API NO. 15-129-20942-0000  
County... Morton  
S/2 SE/4 NW/4 Sec. 4 Twp. 32S Rge. 39 East West

Operator: License # 5447  
Name... OXY USA Inc.  
Address... P.O. Box 26100  
Oklahoma City, OK 73126-0100  
City/State/Zip

2970 Ft North from Southeast Corner of Section  
3300 Ft West from Southeast Corner of Section  
(Note: Locate well in section plat below)

Purchaser... CITGO

Lease Name... Sullivan A Well #. 1  
Field Name... East Kinsler

Operator Contact Person... Raymond Hui  
Phone... (405) 749-2471

Producing Formation... Morrow  
Elevation: Ground... 3240 KB... 3251

Contractor: License # 5141  
Name... Zenith Drilling Company

Wellsite Geologist... Andrew Howell  
Phone... (405) 749-2000

RECEIVED  
STATE CORPORATION COMMISSION  
JAN 31 1989  
CONSERVATION DIVISION  
Wichita, Kansas

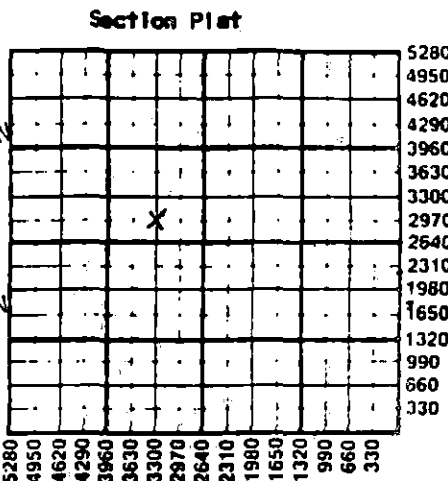

Designate Type of Completion  
X New Well Re-Entry Workover  
X Oil SWD Temp Abd  
Gas Inj Delayed Comp.  
Dry Other (Core, Water Supply etc.)

If ONNO: old well info as follows:  
Operator  
Well Name  
Comp. Date Old Total Depth

WATER SUPPLY INFORMATION  
Disposition of Produced Water: Disposal  
Docket # Repressuring

WELL HISTORY

Drilling Method: X Mud Rotary Air Rotary Cable  
11-4-1988 11-15-1988 1-12-1989  
Spud Date Date Reached TD Completion Date  
6000' 5531'  
Total Depth PBD  
Amount of Surface Pipe Set and Cemented at 1725'  
Multiple Stage Cementing Collar Used? X Yes No  
If yes, show depth set DV tool at 3175'  
If alternate 2 completion, cement circulated from...feet depth to...w/...SX cmt  
Cement Company Name  
Invoice #

Questions on this portion of the ACO-1 call:  
Water Resources Board (913) 296-3717  
Source of Water:  
Division of Water Resources Permit #  
Groundwater...Ft North from Southeast Corner (Well) ...Ft West from Southeast Corner of Sec Twp Rge East West  
Surface Water...Ft North from Southeast Corner (Stream, pond etc)...Ft West from Southeast Corner Sec Twp Rge East West  
Other (explain) Provided by Driller (purchased from city, R.W.D. #)

INSTRUCTIONS: This form shall be completed in triplicate and filed with the Kansas Corporation Commission, 200 Colorado Derby Building, Wichita, Kansas 67202, within 120 days of the spud date of any well. Rule 82-3-130, 82-3-107 and 82-3-106 apply. Information on side two of this form will be held confidential for a period of 12 months if requested in writing and submitted with the form. See rule 82-3-107 for confidentiality in excess of 12 months. One copy of all wireline logs and drillers time log shall be attached with this form. Submit CP-4 form with all plugged wells. Submit CP-111 form with all temporarily abandoned wells.

All requirements of the statutes, rules and regulations promulgated to regulate the oil and gas industry have been fully complied with and the statements herein are complete and correct to the best of my knowledge.

Signature... Bryan D. Humphries  
Title... Engineering Manager Date... 1-26-1989

Subscribed and sworn to before me this 26th day of January, 1989.  
Notary Public... M. Larsha C. Wilson  
Date Commission Expires... 4-1-92

K.C.C. OFFICE USE ONLY  
Letter of Confidentiality Attached  
Wireline Log Received  
Drillers Time Log Received  
Distribution  
KCC SWD/Rep NGPA  
KGS Plug Other (Specify)  
1-21-89  
Form ACO-1 (5-86)

Sec. 4, Twp. 32S, Rge. 39E

Operator Name OXY USA Inc. Lease Name Sullivan A. Well # 1

Sec. 4 Twp. 32S Rge. 39 East West County Morton RELEASED

MAR 07 1990

WELL LOG

INSTRUCTIONS: Show important tops and base of formations penetrated. Detail all cores. Report all drill stem tests giving interval tested, time tool open and closed, flowing and shut-in pressures, whether shut-in pressure reached static level, hydrostatic pressures, bottom hole temperature, fluid recovery, and flow rates if gas to surface during test. Attach extra sheet if more space is needed. Attach copy of log.

FROM CONFIDENTIAL

Drill Stem Tests Taken  Yes  No  
 Samples Sent to Geological Survey  Yes  No  
 Cores Taken  Yes  No

Formation Description  
 Log  Sample

Ran Compensated Acoustic Velocity Log w/Caliper from 1720' to surf. Ran Dual Ind. Short Guard Log; Spectral Density Dual Spaced Neutron Log; Microlog.

Name	Top	Bottom
Sand	0	320
Sand & Red Bed	320	786
Red Bed	786	1325
Glorietta	1325	1575
Red Bed & Anhyd.	1575	1725
Red Bed & Sand	1725	1980
Shale & Lime	1980	3510
Dolomite	3510	3700
Dolomite & Shale	3700	3900
Dolomite	3900	4060
Lime & Shale	4060	6000
	TD	6000
	PBTD	5531

Production Casing & Cementing Information:  
 Cement 1st stage as follows: 500 gal mud flush, 350 sx Hal Lite w/1#/sx Flo., followed by 275 50/50 Cl H Poz. containing 2%, 12% salt, 2% CaCl.  
 Cement 2nd stage cmt. as follows: 500 gals mud flush, followed w/225 sx Cl C Hal. Lite cmt. w/1#/sx Flo. & 475 sx Cl. C Poz. w/2% gel, 5#/sx Cal-Seal, 2% CaCl<sub>2</sub>, 0.4% Halad-4.

CASING RECORD  New  Used  
 Report all strings set-conductor, surface, intermediate, production, etc.

Purpose of String	Size Hole Drilled	Size Casing Set (in O.D.)	Weight Lbs/Ft.	Setting Depth	Type of Cement	#Sacks Used	Type and Percent Additives
Conductor Pipe	30"	20"		51'	Bed-Mix	4-3/4 yd	
Surface	12-1/2"	8-5/8"	24#	1725'	Cl C	700	6% total gel 2% CaCl <sub>2</sub>
Production	7-7/8"	5-1/2"	15.5#/14#	6000	* PLS refer to info listed above.		

Shots Per Foot	Specify Footage of Each Interval Perforated	Acid, Fracture, Shot, Cement Squeeze Record (Amount and Kind of Material Used)	Depth
4	Morrow 5544-5548' (Squeezed)	None	
4	Morrow 5522-5527'		

TUBING RECORD Size 2-3/8" Set At 5525' Packer at Liner Run  Yes  No

Date of First Production 12-28-1988 Producing Method  Flowing  Pumping  Gas Lift  Other (explain).....

Estimated Production Per 24 Hours	Oil	Gas	Water	Gas-Oil Ratio	Gravity
	116 Bbls	34 MCF	Trace Bbls	CFPB	40.4°

METHOD OF COMPLETION Production Interval

Disposition of gas:  Vented  Sold  Used on Lease  
 Open Hole  Perforation  Other (Specify) ..... 5522-5527'  
 Dually Completed  Commingled