

STATE CORPORATION COMMISSION OF KANSAS  
OIL & GAS CONSERVATION DIVISION  
WELL COMPLETION OR RECOMPLETION FORM  
ACO-1 WELL HISTORY  
DESCRIPTION OF WELL AND LEASE

5

API NO. 15-129-20952-0000  
County Morton  
C-E/2 SW/4 NW/4 Sec 4 Twp 32 Rge 39 East West

Operator: License # 5447  
Name OXY USA Inc.  
Address P. O. Box 26100  
Oklahoma City, OK 73126-0100  
City/State/Zip

3300 Ft North from Southeast Corner of Section  
4290 Ft West from Southeast Corner of Section  
(Note: Locate well in section plat below)

Purchaser Permian & PEPL

Lease Name Sullivan A Well # 2

Operator Contact Person Raymond Hui  
Phone (405) 749-2471

Field Name East Kinsler

Producing Formation Morrow L-1

Elevation: Ground 3247 KB 3258

Contractor: License #  
Name H-30 Drilling Company

Wellsite Geologist Andy Howell  
Phone (405) 749-2000

RECEIVED  
STATE CORPORATION COMMISSION

FEB 28 1989  
2-28-1989

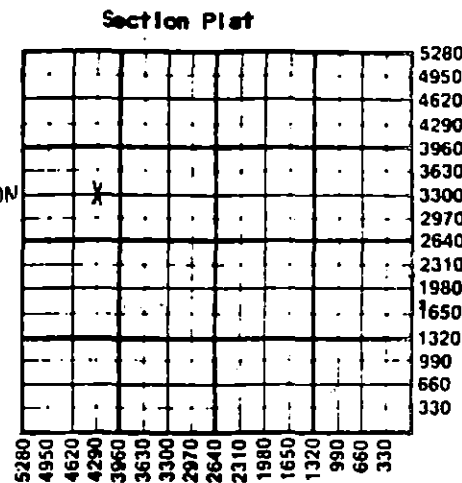

Designate Type of Completion  
X New Well Re-Entry Workover  
Oil SWD Temp Abd  
X Gas Inj Delayed Comp  
Dry Other (Core, Water Supply etc.)

CONSERVATION DIVISION  
Wichita, Kansas

If ONWO: old well info as follows:  
Operator  
Well Name  
Comp. Date Old Total Depth

WELL HISTORY

WATER SUPPLY INFORMATION

Disposition of Produced Water: Disposal  
Docket # Repressuring

Drilling Method: X Mud Rotary Air Rotary Cable  
12-3-1988 12-13-1988 2-23-1989  
Spud Date Date Reached TD Completion Date  
5975' 5906'  
Total Depth PBTD  
Amount of Surface Pipe Set and Cemented at 1744 feet  
Multiple Stage Cementing Collar Used? X Yes No  
If yes, show depth set DV Tool at 3145 feet  
If alternate 2 completion, cement circulated from feet depth to w/ SX cmt  
Cement Company Name  
Invoice #

Questions on this portion of the ACO-1 call:  
Water Resources Board (913) 296-3717  
Source of Water: Provided by Driller  
Division of Water Resources Permit #  
Groundwater Ft North from Southeast Corner (Well) Ft West from Southeast Corner of Sec Twp Rge East West  
Surface Water Ft North from Southeast Corner (Stream, pond etc) Ft West from Southeast Corner Sec Twp Rge East West  
Other (explain) (purchased from city, R.W.D. #)

INSTRUCTIONS: This form shall be completed in triplicate and filed with the Kansas Corporation Commission, 200 Colorado Derby Building, Wichita, Kansas 67202, within 120 days of the spud date of any well. Rule 82-3-130, 82-3-107 and 82-3-106 apply. Information on side two of this form will be held confidential for a period of 12 months if requested in writing and submitted with the form. See rule 82-3-107 for confidentiality in excess of 12 months. One copy of all wireline logs and drillers time log shall be attached with this form. Submit CP-4 form with all plugged wells. Submit CP-111 form with all temporarily abandoned wells.

All requirements of the statutes, rules and regulations promulgated to regulate the oil and gas industry have been fully complied with and the statements hereby are complete and correct to the best of my knowledge.

Signature Bryan Humphries

Title Engineering Manager Date 2-23-1989

Subscribed and sworn to before me this 23rd day of February 1989

Notary Public Marsha P. Quisenberry

Date Commission Expires 4-1-92

K.C.C. OFFICE USE ONLY  
Letter of Confidentiality Attached  
Wireline Log Received  
Drillers Time Log Received  
Distribution  
KCC SWD/Rep NGPA  
KGS Plug Other  
(Specify)  
2-28-89

Sec 4, Twp 32, Rge 39

Operator Name ..... OXY USA Inc ..... Lease Name ..... Sullivan A ..... **RELEASED**

4 32 39  East  East  
 Morton ..... MAR 07 1990

WELL LOG

FROM CONFIDENTIAL

INSTRUCTIONS: Show important tops and base of formations penetrated. Detail all cores. Report all drill stem tests giving interval tested, time tool open and closed, flowing and shut-in pressures, whether shut-in pressure reached static level, hydrostatic pressures, bottom hole temperature, fluid recovery, and flow rates if gas to surface during test. Attach extra sheet if more space is needed. Attach copy of log.

Drill Stem Tests Taken  Yes  No  
 Samples Sent to Geological Survey  Yes  No  
 Cores Taken  Yes  No

Formation Description  
 Log  Sample

Ran Long Spaced Sonic, Dual Induction Short Guard Log, Microlog, Dipmeter and Spectral Density Dual Spaced Neutron Log from 5590-1700'.

Name	Top	Bottom
Anhydrite	0	1717'
Lime & Shale	1717'	5975'
	TD	5975'
	PBTD	5906'

Ran CBL w/GR & CCL log from loggers TD of 5906' to 440' and CET log from 5906' to 1700'.

Production Casing Record:

Cemented 1st stage w/500 gals mud flush, followed by 325 sx 65/35 Cl H Poz containing 6% total gel and 1/4#/sx Floc., followed by 225 sx 50/50 Cl H Poz containing 2% total gel, 12% salt, 1/2% HALAD-9 2% CaCl<sup>2</sup> & 1/4#/sx Floc.

Cemented 2nd stage w/500 gals mud flush, followed by 275 sx 65/35 Cl C Poz containing 6% total gel & 1/4#/sx Floc., followed by 425 sx 50/50 Cl C Poz. containing 2% Total gel, 5#/sx Cal-Seal, 0.4% HALAD-4, 2% CaCl<sup>2</sup> & 1/4#/sx floc.

CASING RECORD <input checked="" type="checkbox"/> New <input type="checkbox"/> Used							
Report all strings set-conductor, surface, intermediate, production, etc.							
Purpose of String	Size Hole Drilled	Size Casing Set (In O.D.)	Weight Lbs/Ft.	Setting Depth	Type of Cement	#Sacks Used	Type and Percent Additives
Surface Production	12-1/4" 7-7/8"	8-5/8" 5-1/2"	24# 15.5#/14#	1714' 5974'	Cl C *PLS refer to info listed above.	875	6% gel; 2% CaCl <sup>2</sup>
PERFORATION RECORD				Acid, Fracture, Shot, Cement Squeeze Record			
Shots Per Foot	Specify Footage of Each Interval Perforated			(Amount and Kind of Material Used)		Depth	
4	Morrow 5514-5528'			Not acidized			
TUBING RECORD				Liner Run <input type="checkbox"/> Yes <input checked="" type="checkbox"/> No			
Date of First Production		Size		Set At		Packer at	
1-5-1989		2-3/8"		5459		---	
Producing Method							
<input checked="" type="checkbox"/> Flowing <input type="checkbox"/> Pumping <input type="checkbox"/> Gas Lift <input type="checkbox"/> Other (explain).....							
Estimated Production Per 24 Hours		Oil	Gas	Water	Gas-Oil Ratio	Gravity	
109 Bbls		1652 MCF/D	---	Bbls	---	CFPB	

METHOD OF COMPLETION

Production Interval

Disposition of gas:  Vented  Sold  Used on Lease  
 Open Hole  Perforation  Other (Specify) ..... 5514-5528'  
 Dually Completed  Comingled