

Plugged  
4-25-89

STATE CORPORATION COMMISSION OF KANSAS  
OIL & GAS CONSERVATION DIVISION  
WELL COMPLETION OR RECOMPLETION FORM  
ACO-1 WELL HISTORY  
DESCRIPTION OF WELL AND LEASE

S

API NO. 15-151-21,928 - 00-00  
County...Pratt  
NE/4 SW/4 SE/4 3 28S 12W East  
..... Sec..... Twp.....Rge..... X West

Operator: License # 5316  
Name Falcon Exploration, Inc.  
Address 125 North Market, Suite 1075  
City/State/Zip Wichita, Kansas 67202

990 Ft North from Southeast Corner of Section  
1650 Ft West from Southeast Corner of Section  
(Note: Locate well in section plat below)

Purchaser.....  
Operator Contact Person Mike Mitchell  
Phone 316-262-1378

Lease Name Hissons Well # 3  
Field Name.....

Contractor: License # 5302  
Name Red Tiger Drilling Company  
Wellsite Geologist Arden Ratzlaff  
Phone (316) 262-8938

Producing Formation.....  
Elevation: Ground 1841 KB 1846

Designate Type of Completion  
 New Well  Re-Entry  Workover  
 Oil  SWD  Temp Abd  
 Gas  Inj  Delayed Comp.  
 Dry  Other (Core, Water Supply etc.)  
If OWWO: old well info as follows:  
Operator.....  
Well Name.....  
Comp. Date.....Old Total Depth.....

STATE RECEIVED  
CORPORATION COMMISSION  
MAY 18 1989  
5-18-1989  
CONSERVATION DIVISION  
Wichita, Kansas

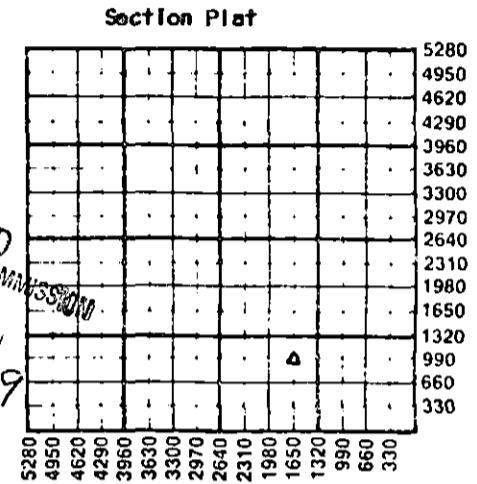

WATER SUPPLY INFORMATION  
Disposition of Produced Water: \_\_\_\_\_ Disposal  
Docket # \_\_\_\_\_ Repressuring

WELL HISTORY  
Drilling Method:  
 Mud Rotary  Air Rotary  Cable  
4/16/89 4/25/89 4/25/89  
Spud Date Date Reached TD Completion Date  
4,400'  
Total Depth PBTD  
Amount of Surface Pipe Set and Cemented at 315 feet  
Multiple Stage Cementing Collar Used? Yes No  
If alternate 2 completion, cement circulated from.....feet depth to.....w/.....SX cmt  
Cement Company Name.....  
Invoice #.....  
A/I OPA

Questions on this portion of the ACO-1 call:  
Water Resources Board (913) 296-3717  
Source of Water: T 89-175  
Division of Water Resources Permit #.....  
 Groundwater 1000 Ft North from Southeast Corner  
(Well) 1900 Ft West from Southeast Corner of  
Sec 3 Twp 28S Rge 12 East X West  
Surface Water.....Ft North from Southeast Corner  
(Stream, pond etc).....Ft West from Southeast Corner  
Sec Twp Rge East West  
Other (explain).....  
(purchased from city, R.W.D. #)

INSTRUCTIONS: This form shall be completed in triplicate and filed with the Kansas Corporation Commission, 200 Colorado Derby Building, Wichita, Kansas 67202, within 120 days of the spud date of any well. Rule 82-3-130, 82-3-107 and 82-3-106 apply. Information on side two of this form will be held confidential for a period of 12 months if requested in writing and submitted with the form. See rule 82-3-107 for confidentiality in excess of 12 months. One copy of all wireline logs and drillers time log shall be attached with this form. Submit CP-4 form with all plugged wells. Submit CP-111 form with all temporarily abandoned wells.

All requirements of the statutes, rules and regulations promulgated to regulate the oil and gas industry have been fully complied with and the statements herein are complete and correct to the best of my knowledge.

Signature Tom Boyce  
Title Engineer Date 5/17/89

Subscribed and sworn to before me this 17th day of May 1989  
Notary Public Norma N. LeBlanc  
Date Commission Expires 7-8-91

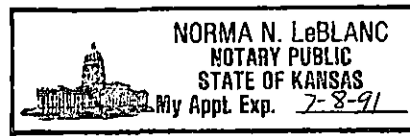

K.C.C. OFFICE USE ONLY  
F Letter of Confidentiality Attached  
C Wireline Log Received  
C Drillers Timelog Received  
Distribution  
KCC SWD/Rep NGPA  
KGS Plug Other  
(Specify)  
5-18-89  
Form ACO-1 (5-86)

Sec 3 Twp 28 Rge 12W

Operator Name Falcon Exploration, Inc. Lease Name Hissons Well # 3

Sec. 3 Twp. 28S Rge. 12W  East  West County Pratt

WELL LOG

INSTRUCTIONS: Show important tops and base of formations penetrated. Detail all cores. Report all drill stem tests giving interval tested, time tool open and closed, flowing and shut-in pressures, whether shut-in pressure reached static level, hydrostatic pressures, bottom hole temperature, fluid recovery, and flow rates if gas to surface during test. Attach extra sheet if more space is needed. Attach copy of log.

Drill Stem Tests Taken  Yes  No  
 Samples Sent to Geological Survey  Yes  No  
 Cores Taken  Yes  No

DST #1 (3917-3946') 30-60-45-90, fair to st blow off bottom of bucket 4", fair to st. blow off bottom of bucket 7". Rec. 1125' SMW, 108,000 Cl, IFP 77-397, FFP 453-607, ISIP 1342, FSIP 1364, Temp 128°

DST #2 (3980-3994') 30-45-45-90, st blow off btm bucket 15 sec, fair bl off bottom bucket 23". Rec. 1550' GIP, 150' TF, 90' HOCGCMW (12% gas, 30% oil, 20% mud, 38% wtr), 60' O&GCMW (8% gas, 25% oil, 15% mud, 52% wtr) IFP 44-33, FFP 66-77, ISIP 870#, FSIP 881 Temp 126°

DST #3 (4014-4030') 30-60-45-90, strong blow, GTS 6", 49.4 MCF decreasing to 7.1 MCF in 70". Rec. 270' VGSMWCO (63% gas, 30% oil, 2% mud, 5% wtr), 120' VSO&GCW (3% gas, 1% oil, 96% wtr), 180' wtr 133,000 Cl, IFP 88-110, FFP 154-232, ISIP 1232, FSIP 1210, Temp. 130°

DST #4 (4050-4066') 30-60-45-90, strong blow, GTS 5", 77.5 MCF decreasing to 40.7 MCF in 70". Rec. 1470' fluid, 150' OGCW (35% gas, 23% oil, 2% mud, (continued on attached page)

Name	Formation Description	
	Top	Bottom
Heebner	3513	-1667
Lansing	3716	-1870
B/KC	4083	-2237
Marmaton	4110	-2264
Mississippian	4161	-2315
Kinderhook	4285	-2439
Viola	4348	-2502
TD	4400	-2554

CASING RECORD <input checked="" type="checkbox"/> New <input type="checkbox"/> Used Report all strings set-conductor, surface, intermediate, production, etc.							
Purpose of String	Size Hole Drilled	Size Casing Set (in O.D.)	Weight Lbs/Ft.	Setting Depth	Type of Cement	#Sacks Used	Type and Percent Additives
Surface	12 1/4"	8 5/8"		315'	60/40 Poz	240	2% Gel 3%CC
PERFORATION RECORD				Acid, Fracture, Shot, Cement Squeeze Record			
Shots Per Foot	Specify Footage of Each Interval Perforated			(Amount and Kind of Material Used)		Depth	
	NA			NA			
TUBING RECORD		Size NA	Set At	Packer at	Liner Run	<input type="checkbox"/> Yes <input checked="" type="checkbox"/> No	
Date of First Production	Producing Method						
NA	<input type="checkbox"/> Flowing <input type="checkbox"/> Pumping <input type="checkbox"/> Gas Lift <input type="checkbox"/> Other (explain).....						
Estimated Production Per 24 Hours	Oil	Gas	Water	Gas-Oil Ratio	Gravity		
	Bbls	MCF	Bbls	CFPB			

METHOD OF COMPLETION

Production Interval

Disposition of gas:  Vented  Open Hole  Perforation  
 Sold  Other (Specify) .....  
 Used on Lease  Dually Completed .....  
 Commingled

Falcon Exploration, Inc.  
Continuation of ACO-1 Well History

RE: Hissons #3  
NE SW SE of Sec. 3-28S-12W  
Pratt County, KS

DST #4 (4050-4066') continued:

40% wtr), 240' SOGCW (7% gas, 3% oil, 90% wtr), 1080' wtr w/tr. oil. IFP 210-375,  
FFP 508-684, ISIP 1430, FSIP 1408, Temp. 132°

DST #5 (4102-4120') 30-30-20, very weak blo 5" died, flushed tool 2nd open, no help.  
Rec. 5' mud, IFP 22-22, FFP 22-22, ISIP 22 no FSIP, 108°

RECEIVED  
STATE CORPORATION COMMISSION

MAY 18 1989

CONSERVATION DIVISION  
Wichita, Kansas