

15-119-10058-0000

STATE OF KANSAS  
STATE CORPORATION COMMISSION

Give All Information Completely  
Make Required Affidavit  
Mail or Deliver Report to:  
Conservation Division  
State Corporation Commission  
800 Biting Building  
Wichita, Kansas

WELL PLUGGING RECORD

NORTH

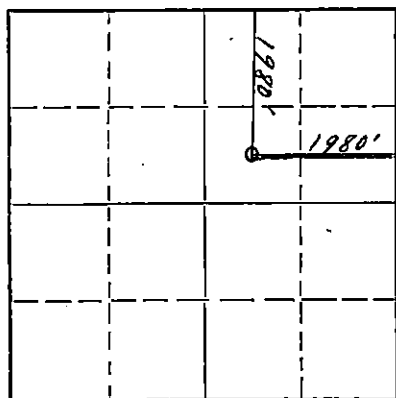

Locate well correctly on above  
Section Plat

Meade County. Sec. 31 Twp. 32 Rge. 30 (E) W (W)  
Location as "NE/CNW/SW" or footage from lines center of SW/4 of NE/4  
Lease Owner Columbian Fuel Corporation  
Lease Name C. E. Stevens Well No. B-1  
Office Address Drawer 31, Liberal, Kansas  
Character of Well (completed as Oil, Gas or Dry Hole) Dry hole  
Date well completed December 12, 1953  
Application for plugging filed (phone) December 12, 1953  
Application for plugging approved 19  
Plugging commenced December 12, 1953  
Plugging completed December 12, 1953  
Reason for abandonment of well or producing formation Dry

If a producing well is abandoned, date of last production None 19  
Was permission obtained from the Conservation Division or its agents before plugging was commenced? Yes

Name of Conservation Agent who supervised plugging of this well M. A. Rives  
Producing formation None Depth to top          Bottom          Total Depth of Well 5710 Feet  
Show depth and thickness of all water, oil and gas formations.

OIL, GAS OR WATER RECORDS

CASING RECORD

FORMATION	CONTENT	FROM	TO	SIZE	PUT IN	PULLED OUT
<u>None</u>				<u>13 3/8"</u>	<u>606'</u>	<u>None</u>
				<u>9 5/8"</u>	<u>2680'</u>	<u>None</u>

Describe in detail the manner in which the well was plugged, indicating where the mud fluid was placed and the method or methods used in introducing it into the hole. If cement or other plugs were used, state the character of same and depth placed, from          feet to          feet for each plug set.

5710' to 600' -- filled with 9.8#, 48 vis. mud  
600' to 520' -- cement plug (35 sacks)  
520' to 20' -- 9.8#, 48 vis. mud  
20' to 0' -- cement plug (15 sacks)

All cement plugs displaced through drill pipe

(If additional description is necessary, use BACK of this sheet)

Name of Plugging Contractor Done by company (Columbian Fuel Corp.)  
Address Drawer 31, Liberal, Kansas.

STATE OF Kansas, COUNTY OF Seward, ss.

I, Robert Grady (employee of owner) of          of the above-described well, being first duly sworn on oath, says: That I have knowledge of the facts, statements, and matters herein contained and the log of the above-described well as filed and that the same are true and correct. So help me God.

(Signature)

Robert Grady  
Robert Grady, Superintendent  
Drawer 31, Liberal, Kansas  
(Address)

SUBSCRIBED AND SWORN TO before me this 11th day of December, 1953

Wallace B. Pedigo  
Wallace B. Pedigo Notary Public.

My commission expires June 5, 1955

24-7588-6 3-53-20M

PLUGGING  
FILE SEC 31 T 32 R 30W  
BOX PAGE 149 LINE 11

12-16-53

DRILLER'S LOG

OPERATOR: Columbian Fuel Corporation

ELEVATION:

CONTRACTOR: Midwestern Drillers  
227 Wright Building  
Tulsa 3, Oklahoma

WELL COMMENCED: Nov. 13, 1953

WELL COMPLETED: Dec. 12, 1953

LEASE NAME: Stevens B-1

TOTAL DEPTH 5715

LOCATION: Sec. 31-T32S-R30W  
Meade, Kansas

CASING RECORD: Surface - Set 606.59' of 13-3/8" with 450 sacks of cement  
Intermediate - Set 2680' of 9-5/8" with 800 sacks of cement

FORMATION

DEPTH FROM ROTARY BUSHING

FORMATION	DEPTH FROM ROTARY BUSHING
Clay, sand water & gravel	0
Red Bed	510
Red Bed & Gypsum	637
Shale & Anhydrite	935
Anhydrite & Shale	1790
Anhydrite & Shale	2625
Lime & Shale	2680
Lime & Shale	2695
Lime & Shale	3520
Lime & Shale	4075
Cherty Lime	4535
Lime & Shale	4735
Lime & Shale	5035
Lime & Shale	5121
Lime & Shale	5164
Lime & Shale	5192
Lime & Shale	5593
Lime & Shale	5610
Lime & Shale	5641
Lime & Shale	5643
Lime & Shale	5714
Lime & Shale	5715

I certify that the above is a true and correct copy of Driller's Log of the Stevens B-1 Well.

Subscribed and sworn to before me this 23rd day of Dec., 1953.

MIDWESTERN DRILLERS

J. W. Wyant  
Notary Public

by G. A. Dow

My Commission Expires: August 12, 1956

**PLUGGING**  
FILE SEC. 31 T 32 R 30W  
BOOK PAGE 149 LINE 11

# LOG OF WELL

CODE GW 2062 Columbian Fuel Corp SHEET \_\_\_\_\_  
(COMPANY)

STATE Kansas DISTRICT 72 COUNTY Meade

LEASE C.E. Stevens WELL NO. 1-B SEC. 31 TWP. 32 R. 30

DATE OF LOG 1-4-54 LOCATION IN SEC. 1980' From North & 1980' From East Line

LOCATION MADE 11-9-53 COMM. RIGGING UP 11-12-53 COMM. DRILLING 11-12-53 COMP. DRILLING 12-12-53

TOTAL DEPTH 5715' ELEVATION 2751' Ground STATE PERMIT NO. \_\_\_\_\_

DAY DRILLER Dan Abrams NIGHT DRILLER Roy Jenkins CONTRACTOR Midwestern Drillers

CABLE TOOLS FROM \_\_\_\_\_ TO \_\_\_\_\_ ROTARY TOOLS FROM 0 TO 5715'

OPEN FLOW CAPACITY \_\_\_\_\_ M. CU. FT. ROCK PRESSURE \_\_\_\_\_ GASOLINE CONTENT PER M. CU. FT. \_\_\_\_\_

DEPTH IN SAND Thru PRODUCING SANDS AND THICKNESS OF EACH None

PRODUCTION FIRST 24 HOURS None SETTLED PRODUCTION None STARTED PRODUCTION \_\_\_\_\_

DATE TUBED \_\_\_\_\_ SYPHON SET \_\_\_\_\_ SIZE \_\_\_\_\_ FEET \_\_\_\_\_

### CASING RECORD

SIZE	WEIGHT	PUT IN WELL		PULLED OUT		LEFT IN WELL		SHOES		PACKERS		
		FEET	IN.	FEET	IN.	FEET	IN.	LENGTH	MAKE	KIND	LENGTH	SET AT
13 3/8"	48#	606.59'				606.59'						
9 5/8"	36#	2680'				2680'						

LINER: STATE SIZE AND WEIGHT \_\_\_\_\_ WHERE SET \_\_\_\_\_ FT. AND INS. BLANK \_\_\_\_\_ FT. AND INS. PERFORATED \_\_\_\_\_

HOW PUT TOGETHER \_\_\_\_\_ COUPLING \_\_\_\_\_ FLUSH-JOINT \_\_\_\_\_ INSERTED \_\_\_\_\_

REMARKS \_\_\_\_\_

### EQUIPMENT RECORD

TUBING				SUCKER RODS				PUMPING OUTFIT			
SIZE	WEIGHT	FEET	IN.	FEET	IN.	SIZE AND KIND					DESCRIPTION, KIND, SIZE, ETC.

KIND OF SHOT \_\_\_\_\_ SIZE OF SHOT QUARTS \_\_\_\_\_ NUMBER OF SHOTS \_\_\_\_\_

NUMBER OF SHELLS \_\_\_\_\_ SIZE OF SHELLS \_\_\_\_\_ INCHES. DIAMETER \_\_\_\_\_

LENGTH OF SHELLS \_\_\_\_\_ FT. \_\_\_\_\_ INS. SHOT FURNISHED BY \_\_\_\_\_ TOP OF SHOT \_\_\_\_\_

BOTTOM OF SHOT \_\_\_\_\_ ANCHOR \_\_\_\_\_ WELL BRIDGED TO \_\_\_\_\_

PRODUCTION BEFORE SHOT \_\_\_\_\_ PRODUCTION AFTER SHOT \_\_\_\_\_

NAME OF SHOOTER \_\_\_\_\_ SHOT INSPECTED \_\_\_\_\_ BY \_\_\_\_\_ (COMPANY EMPLOYEE)

COMMENCED DRILLING DEEPER \_\_\_\_\_ COMPLETED DRILLING DEEPER \_\_\_\_\_

TOTAL DEPTH \_\_\_\_\_ PRODUCTION FIRST 24 HOURS \_\_\_\_\_ SETTLED PRODUCTION \_\_\_\_\_

REMARKS: No 5 1/2" O.D. Casing Set. Well Non Productive...Dry & Abandoned

Plugging Completed December 12, 1953

NOTE: IF WELL WAS DRY, STATE UNDER REMARKS, WHEN, HOW, AND BY WHOM PLUGGED. STATE UNDER REMARKS ANYTHING OF INTEREST NOT COVERED IN LOG. IF SPACE PROVIDED FOR REMARKS IS NOT SUFFICIENT WRITE ON BOTTOM OF LAST SHEET OF LOG.