

STATE CORPORATION COMMISSION OF KANSAS
OIL & GAS CONSERVATION DIVISION
WELL COMPLETION FORM
ACO-1 WELL HISTORY
DESCRIPTION OF WELL AND LEASE

API NO. 15- 189-21,343-0600

County Stevens

NW NW NE NE Sec. 4 Twp. 32S Rge. 38 East West

5080 Ft. North from Southeast Corner of Section

1250 Ft. West from Southeast Corner of Section
(NOTE: Locate well in section plat below.)

Lease Name MCCLURE "D" Well # 3H

Field Name Hugoton

Producing Formation Chase

Elevation: Ground 3157.0 KB NA

Total Depth 2816 PBD 2790

Operator: License # 4549

Name: Anadarko Petroleum Corporation

Address P.O. Box 351

City/State/Zip Liberal, KS 67905-0351

Purchaser: Panhandle Eastern Pipeline Co.
(Transporter)

Operator Contact Person: M. L. Pease

Phone (316) 624-6253

Contractor: Name: Gabbert-Jones, Inc.

License: 5842

Wellsite Geologist: NA

Designate Type of Completion
 New Well Re-Entry Workover

Oil SWD Temp. Abd.
 Gas Inj Delayed
 Dry Other (Core, Water Supply)

If OWO: old well info as follows:

Operator: _____

Well Name: _____

Comp. Date _____ Old Total Depth _____

Drilling Method:
 Mud Rotary Air Rotary Cable

6/28/89 6/30/89 9/9/89
Spud Date Date Reached TD Completion Date

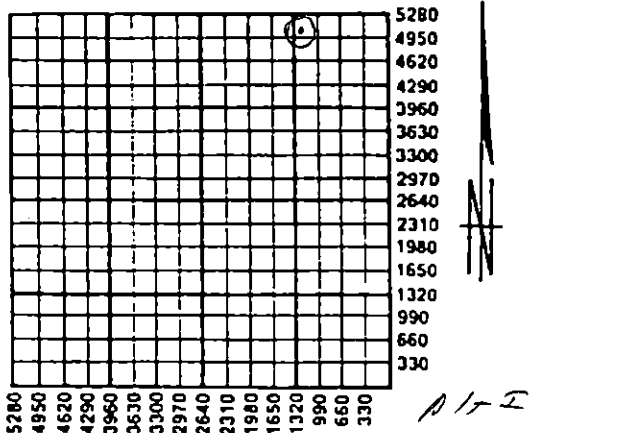

RECEIVED
STATE CORPORATION COMMISSION
DEC 20 1989
12-20-1989
CONSERVATION DIVISION
Wichita, Kansas

_____ of Surface Pipe Set and Cemented at 601 Feet

Multiple Stage Cementing Collar Used? Yes No

If yes, show depth set _____ Feet

If Alternate II completion, cement circulated from _____

feet depth to _____ w/ _____ sx cmt.

INSTRUCTIONS: This form shall be completed in triplicate and filed with the Kansas Corporation Commission, 200 Colorado Derby Building, Wichita, Kansas 67202, within 120 days of the spud date of any well. Rule 82-3-130, 82-3-107 and 82-3-106 apply. Information on side two of this form will be held confidential for a period of 12 months if requested in writing and submitted with the form. See rule 82-3-107 for confidentiality in excess of 12 months. One copy of all wireline logs and drillers time log shall be attached with this form. ALL CEMENTING TICKETS MUST BE ATTACHED. Submit CP-4 form with all plugged wells. Submit CP-111 form with all temporarily abandoned wells. Any recompletion, workover or conversion of a well requires filing of ACO-2 within 120 days from commencement date of such work.

All requirements of the statutes, rules and regulations promulgated to regulate the oil and gas industry have been fully complied with and the statements herein are complete and correct to the best of my knowledge.

Signature M. L. Pease
Title Division Production Manager Date 12/13/89

Subscribed and sworn to before me this 13th day of December, 1989.

Notary Public Cheryl Steers

Date Commission Expires _____



K.C.C. OFFICE USE ONLY
F Letter of Confidentiality Attached
W Wireline Log Received
C Drillers Timelog Received
Distribution
 KEC SWD/Rep NGPA
 KGS Plug Other
(Specify)

91 X

SIDE TWO

Operator Name Anadarko Petroleum Corporation Lease Name MCCLURE "D" Well # 3H

Sec. 4 Twp. 32S Rge. 38
 East
 West

County Stevens

INSTRUCTIONS: Show important tops and base of formations penetrated. Detail all cores. Report all drill stem tests giving interval tested, time tool open and closed, flowing and shut-in pressures, whether shut-in pressure reached static level, hydrostatic pressures, bottom hole temperature, fluid recovery, and flow rates if gas to surface during test. Attach extra sheet if more space is needed. Attach copy of log.

Drill Stem Tests Taken (Attach Additional Sheets.)	<input type="checkbox"/> Yes <input checked="" type="checkbox"/> No	Formation Description <input checked="" type="checkbox"/> Log <input type="checkbox"/> Sample <table border="1"> <thead> <tr> <th>Name</th> <th>Top</th> <th>Bottom</th> </tr> </thead> <tbody> <tr> <td>Blaine</td> <td>1092</td> <td>1180</td> </tr> <tr> <td>Cedar Hills</td> <td>1264</td> <td>1430</td> </tr> <tr> <td>Stone Corral</td> <td>1690</td> <td>1728</td> </tr> <tr> <td>Chase</td> <td>2430</td> <td>2770</td> </tr> <tr> <td>Council Grove</td> <td>2770</td> <td>NA</td> </tr> <tr> <td>TD</td> <td></td> <td>2816</td> </tr> </tbody> </table>	Name	Top	Bottom	Blaine	1092	1180	Cedar Hills	1264	1430	Stone Corral	1690	1728	Chase	2430	2770	Council Grove	2770	NA	TD		2816
Name	Top		Bottom																				
Blaine	1092		1180																				
Cedar Hills	1264		1430																				
Stone Corral	1690	1728																					
Chase	2430	2770																					
Council Grove	2770	NA																					
TD		2816																					
Samples Sent to Geological Survey	<input type="checkbox"/> Yes <input checked="" type="checkbox"/> No																						
Cores Taken	<input type="checkbox"/> Yes <input checked="" type="checkbox"/> No																						
Electric Log Run (Submit Copy.)	<input type="checkbox"/> Yes <input checked="" type="checkbox"/> No																						

CASING RECORD New Used
 Report all strings set-conductor, surface, intermediate, production, etc.

Purpose of String	Size Hole Drilled	Size Casing Set (In O.D.)	Weight Lbs./Ft.	Setting Depth	Type of Cement	# Sacks Used	Type and Percent Additives
Surface	12 1/4	8 5/8	24.0	601	Pozmix & Common	395	3% CC
Production	7 7/8	5 1/2	14.0	2815	Class C	235	10% DCD 20% DCD

Shots Per Foot	PERFORATION RECORD Specify Footage of Each Interval Perforated	Acid, Fracture, Shot, Cement Squeeze Record (Amount and Kind of Material Used)	Depth
2	2456-70, 2485-2514, 2536-68, 2602-30	BRK DN w/17,400 gal 2% KCl	2456-2766'
2	2658-94, 2714-21, 2758-66	WTR. Frac w/136,000 gal X-Link gelled 2% KCl WTR. & 401,700# 12/20 SD.	O.A.

TUBING RECORD	Size	Set At	Packer At	Liner Run <input type="checkbox"/> Yes <input checked="" type="checkbox"/> No
----------------------	------	--------	-----------	---

Date of First Production 10/3/89 Producing Method Flowing Pumping Gas Lift Other (Explain)

Estimated Production Per 24 Hours	Oil Bbls.	Gas 1790 Mcf @ 115#	Water Bbls.	Gas-Oil Ratio	Gravity
-----------------------------------	-----------	---------------------	-------------	---------------	---------

Disposition of Gas: Vented Sold Used on Lease (If vented, submit ACO-18.)

METHOD OF COMPLETION: Open Hole Perforation Dually Completed Commingled Other (Specify)

Production Interval: 2456-2766'
O.A.

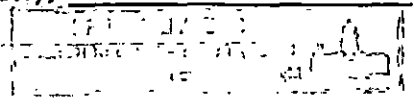



INVOICE

HALLIBURTON SERVICES

A Halliburton Company

INVOICE NO.	DATE
823110	06/28/1989

WELL LEASE NO./PLANT NAME		WELL/PLANT LOCATION		STATE	WELL/PLANT OWNER
MCCLURE D-3H		STEVENS		KS	SAME
SERVICE LOCATION		CONTRACTOR		JOB PURPOSE	
LIBERAL		GABBERT & JONES #9		CEMENT SURFACE CASING	
TICKET DATE		06/28/1989			
ACCT. NO.	CUSTOMER AGENT	VENDOR NO.	CUSTOMER P.O. NUMBER	SHIPPED VIA	FILE NO.
019595	DAVID GILMORE		33876	COMPANY TRUCK	78887

ANADARKO PETROLEUM CORP
P. O. BOX 351
LIBERAL, KS 67905-0351

DIRECT CORRESPONDENCE TO:
SUITE 600
COLORADO DERBY BUILDING
WICHITA, KS 67202-0000

PRICE REF. NO.	DESCRIPTION	QUANTITY	U/M	UNIT PRICE	AMOUNT
PRICING AREA - MID CONTINENT					
000-117	MILEAGE	10	MI	2.20	22.00
		1	UNT		
001-016	CEMENTING CASING	602	FT	515.80	515.80
		1	UNT		
030-016	CEMENTING PLUG SW ALUM TOP	8	5/8 IN	90.00	90.00
		1	EA		
504-043	PREMIUM CEMENT	150	SK	6.85	1,027.50
504-043	PREMIUM CEMENT	184	SK	6.85	1,260.40
506-105	POZMIX A	61	SK	3.91	238.51
507-210	FLOCELE	99	LB	1.21	119.79
509-406	ANHYDROUS CALCIUM CHLORIDE	9	SK	25.75	231.75
500-207	BULK SERVICE CHARGE	413	CFT	.95	392.35
500-306	MILEAGE CMTG MAT DEL OR RETURN	183.650	TMI	.70	128.56
INVOICE SUBTOTAL					4,026.66
DISCOUNT-(BID)					1,369.03-
INVOICE BID AMOUNT					2,657.63
*-KANSAS STATE SALES TAX					92.11
*-SEWARD COUNTY SALES TAX					23.02
INVOICE TOTAL - PLEASE PAY THIS AMOUNT					\$2,772.76

Jim Sullivan

7-11-89

4341-2041
KA 7-12

RECEIVED
STATE CORPORATION COMMISSION

DEC 20 1989

CONSERVATION DIVISION
Wichita, Kansas

TERMS INVOICES PAYABLE NET BY THE 20TH OF THE FOLLOWING MONTH AFTER DATE OF INVOICE. UPON CUSTOMER'S DEFAULT IN PAYMENT OF CUSTOMER'S ACCOUNT BY THE LAST DAY OF THE MONTH FOLLOWING THE MONTH IN WHICH THE INVOICE IS DATED, CUSTOMER AGREES TO PAY INTEREST THEREON AFTER DEFAULT AT THE HIGHEST LAWFUL CONTRACT RATE APPLICABLE BUT NEVER TO EXCEED 18% PER ANNUM. IN THE EVENT IT BECOMES NECESSARY TO EMPLOY AN ATTORNEY TO ENFORCE COLLECTION OF SAID ACCOUNT, CUSTOMER AGREES TO PAY ALL COLLECTION COSTS AND ATTORNEY FEES IN THE AMOUNT OF 20% OF THE AMOUNT OF THE UNPAID ACCOUNT

GABBERT-JONES
DRILLERS WELL LOG

MC CLURE D-3H
SEC. 4-32S-38W
STEVENS COUNTY

Commenced: 6-28-89
Completed: 6-30-89
Operator: ANADARKO PETROLEUM CORP.

R-9

Depth		Formation	Remarks
From	To		
0	480	Sand-Clay	Ran 14 jts of 24# 8 5/8"
480	602	Redbed	csg LD @ 601' W/245 sks
602	975	Redbed-Sand	25/75 Posmix - 2% CC - 1/4#FS
975	1220	Redbed	150 sks Common - 3% CC
1220	1405	Glorietta Sand	1/4# FS
1405	1633	Redbed	PD @ 2:30 PM
1633	2210	Redbed-Shale	6-28-89
2210	2816	Lime-Shale	
	2816 TD		Ran 65 jts 14# 4-1/2" csg LD @ 2815' w/195 sks Class C - 20% DCD - 2%CC 1/4# FS - 40 sks Class C 10% DCD - 2% CC - 1/4# FS PD @ 6:30 PM 6-30-89 RR @ 7:30 PM 6-30-89

*W. J. J. 10/2/89
5 1/2" ANADARKO*

RECEIVED
STATE CORPORATION COMMISSION
DEC 20 1989
CONSERVATION DIVISION
Wichita, Kansas

State of Kansas)
County of Sedgwick) I, the undersigned, being duly sworn on oath, state
that the above Drillers ' Well Log is true and correct
to the best of my knowledge and belief and according
to the records of this office.

GABBERT-JONES, INC.

[Signature]
James S. Sutton, II --President

Subscribed & sworn to before me this

[Signature]
Lola Lenore Costa

LOLA LENORE COSTA
NOTARY PUBLIC
STATE OF KANSAS
My Appt. Expires 11/21/92

My Commission expires Nov. 21, 1992.