

ORIGINAL RELEASED

12/21/88

STATE CORPORATION COMMISSION OF KANSAS  
OIL & GAS CONSERVATION DIVISION  
RECOMPLETION FORM  
ACO-2 AMENDMENT TO WELL HISTORY

API NO. 15- 189-21,011-00-01 12-21-1988  
County Stevens FROM CONFIDENTIAL  
C SW Sec 4 Twp 32S Rge 38 X West

Operator: License # 5598  
Name APX Corporation  
Address P. O. Box 351  
City/State/Zip Liberal, Kansas 67905-0351

1325 Ft North from Southeast Corner of Section  
3951 Ft West from Southeast Corner of Section  
(Note: Locate well in section plat below)

Purchaser Panhandle Eastern Pipe Line Co.  
(Transporter)  
Operator Contact Person M. L Pease  
Phone (316) 624-6253

Lease Name Walker "C" Well # 1H  
Field Name Hugoton  
Name of New Formation Chase  
Elevation: Ground 3174.0 KB —  
Section Plat

Designate Type of Original Completion  
 New Well  Re-Entry  Workover

Oil  SWD  Temp Abd  
 Gas  Inj  Delayed Comp.  
 Dry  Other (Core, Water Supply etc.)

Date of Original Completion: 9/20/88

DATE OF RECOMPLETION:  
NA NA  
Commenced, Completed

Designate Type of Recompletion/Workover:  
 Deepening  Delayed Completion  
 Plug Back  Re-perforation  
 Conversion to Injection/Disposal

Is recompleted production:  
 Commingled; Docket No. —  
 Dual Completion; Docket No. —  
 Other (Disposal or Injection)? —

RECEIVED  
CORPORATION COMMISSION  
DEC 21 1988  
12-21-1988  
CONSERVATION DIVISION  
Wichita, Kansas

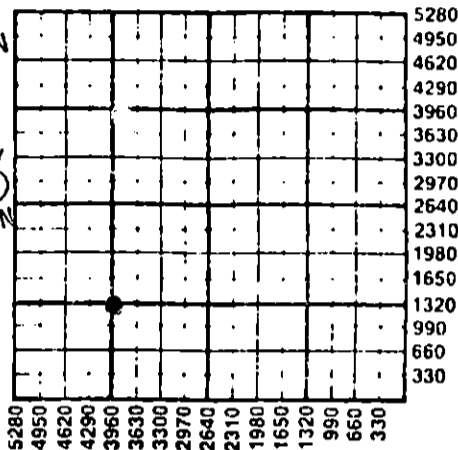

K. C. C. OFFICE USE ONLY  
 Letter of Confidentiality Attached  
 Wireline Log Received  
 Drillers Timelog Received  
Distribution  
 KCC  SWD/Rep  NGPA  
 KGS  Plug  Other  
(Specify)

INSTRUCTIONS: This form shall be completed in triplicate and filed with the Kansas Corporation Commission, 200 Colorado Derby Building, Wichita, Kansas 67202, within 120 days of the recompletion of any well. Rules 82-3-107 and 82-3-141 apply. Information on side two of this form will be held confidential for a period of 12 months if requested in writing and submitted with the form. See rule 82-3-107 for confidentiality in excess of 12 months. One copy of any additional wireline logs and driller's time logs (not previously submitted) shall be attached with this form. Submit ACO-4 prior to or with this form for approval of commingling or dual completions. Submit CP-4 with all plugged wells. Submit CP-111 with all temporarily abandoned wells. NOTE: Conversion of wells to either disposal or injection must receive approval before use; submit form U-1.

All requirements of the statutes, rules and regulations promulgated to regulate the oil and gas industry have been fully complied with and the statements herein are complete and correct to the best of my knowledge.

Signature M. L. Pease Title Division Production Mgr. Date 12/18/88  
Subscribed and sworn to before me this 19th day of December 19 88  
Notary Public Glenna S. Salley Date Commission Expires —

KANSAS GEOLOGICAL SURVEY  
WICHITA BRANCH  
JAN 05 1989

GLENN S. SALLEY  
NOTARY PUBLIC  
STATE OF KANSAS  
MY APPT. EXPIRES 1-6-91

FORM ACO-2  
5/88

PI

SIDE TWO

Operator Name APX Corporation Lease Name Walker "C" Well # 1H

Sec 4 Twp 32S Rge 38  East  West County Stevens

RECOMPLETED FORMATION DESCRIPTION:

\_\_\_\_\_ Log \_\_\_\_\_ Sample

Name Top Bottom

ADDITIONAL CEMENTING/SQUEEZE RECORD					
Purpose:	Depth		Type of Cement	# Sacks Used	Type & Percent Additives
	Top	Bottom			
<input type="checkbox"/> Perforate	_____	_____	_____	_____	_____
<input type="checkbox"/> Protect Casing	_____	_____	_____	_____	_____
<input type="checkbox"/> Plug Back TD	_____	_____	_____	_____	_____
<input type="checkbox"/> Plug Off Zone	_____	_____	_____	_____	_____

Shots Per Foot	PERFORATION RECORD Specify Footage of Each Interval Perforated	Acid, Fracture, Shot, Cement Squeeze Record (Amount and Kind of Material Used)
2	2474-2491, 2500-2532, 2552-2590, 2618-2654, 2673-2703, 2727-2736, 2762-2778	Brk dwn w/19,800 gal 2% KCL wtr. Frac w/135,000 gal gelled 2% KCL wtr + 367,800# 12/20 sd.

PBTD 2826 Plug Type NA

TUBING RECORD:

Size \_\_\_\_\_ Set At \_\_\_\_\_ Packer At \_\_\_\_\_ Was Liner Run?  Y  X  N

Date of Resumed Production, Disposal or Injection 10/10/88

Estimated Production Per 24 Hours \_\_\_\_\_ bbl/oil \_\_\_\_\_ bbl/water

1760 MCF gas \_\_\_\_\_ gas-oil ratio  
@ 95 psig

BW

GABBERT-JONES, INC.  
WICHITA, KAS.

DRILLERS WELL LOG

WALKER <sup>C</sup>" #1H  
C SW/4 Sec. 4-32S-38W  
Stevens County, Kansas

RECEIVED  
STATE CORPORATION COMMISSION

DEC 21 1988

COMMENCED: 4-9-87

COMPLETED: 4-12-87

CONSERVATION DIVISION  
Wichita, Kansas

OPERATOR: PAN EASTERN EXPLORATION COMPANY

DEPTH		Formation	Remarks
From	To		
0	595	Sand-Clay	
595	1251	Redbed	Ran 14 jts. of 24# 8 5/8" csg
1251	1425	Glorita Sand	LD @ 612' w/190 sks 75/25
1425	1497	Shale	Posmix - 2% CC - 1/4# Celoflake
1497	1952	Shale - Clay	150 sks Common - 3% CC
1952	2350	Shale - Sand	1/4# Celoflake
2350	2612	Shale - Lime	PD @ 3:30 AM 4-10-87
2612	2845	Lime-Shale	
	2845 TD		Ran 71 jts. of 14# 5 1/2" csg. LD @ 2844' w/195 sks Class C - 20% DCD - 2% CC 1/4# Celoflakes - 40 sks. Class C - 10% DCD - 2% CC 1/4# Celoflake PD @ 9:30 PM 4-12-87.

STATE OF KANSAS )  
                          ) I, the undersigned, being duly sworn on oath, state that  
COUNTY OF SEDGWICK) the above Drillers' Well Log is true and correct  
                          ) to the best of my knowledge and belief and according  
                          ) to the records of this office.

GABBERT-JONES, INC.

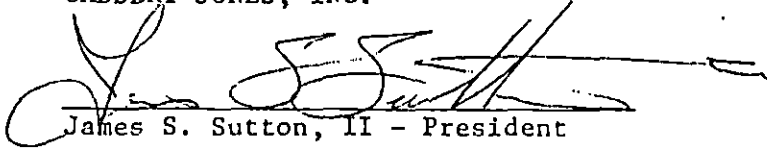
  
James S. Sutton, II - President

Subscribed & sworn to before me this 20th day of April 1987.

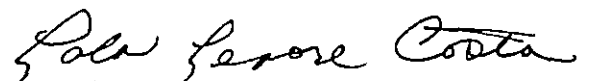
  
Lola Lenore Costa - Notary Public

My Commission expires 11-21-88