

STATE CORPORATION COMMISSION OF KANSAS
OIL & GAS CONSERVATION DIVISION
WELL COMPLETION FORM
ACO-1 WELL HISTORY
DESCRIPTION OF WELL AND LEASE

Operator: License # 4549

Name: Anadarko Petroleum Corp.

Address P.O. Box 351

City/State/Zip Liberal, KS 67905-0351

Purchaser: Panhandle Eastern Pipeline Co.
(Transporter)

Operator Contact Person: M. L. Pease

Phone (316) 624-6253

Contractor: Name: Gabbert-Jones, Inc.

License: 5842

Wellsite Geologist: NA

Designate Type of Completion

New Well Re-Entry Workover

Oil SWD Temp. Abd. STATE OF
 Gas Inj Delayed Comp.
 Dry Other (Core, Water Supply, etc.)

If OWMO: old well info as follows:

Operator: _____

Well Name: _____

Comp. Date _____ Old Total Depth _____

Drilling Method:

Mud Rotary Air Rotary Cable

9/21/89 9/25/89 11/28/89
Spud Date Date Reached TD Completion Date

API NO. 15- 189-21,382-0000

County Stevens

SE NE SW Sec. 9 Twp. 32S Rge. 38 East West

1390 Ft. North from Southeast Corner of Section

2740 Ft. West from Southeast Corner of Section
(NOTE: Locate well in section plat below.)

Lease Name McClure "G" Well # 3H

Field Name Hugoton

Producing Formation Chase

Elevation: Ground 3216.5 KB NA

Total Depth 2908 PBTD 2886

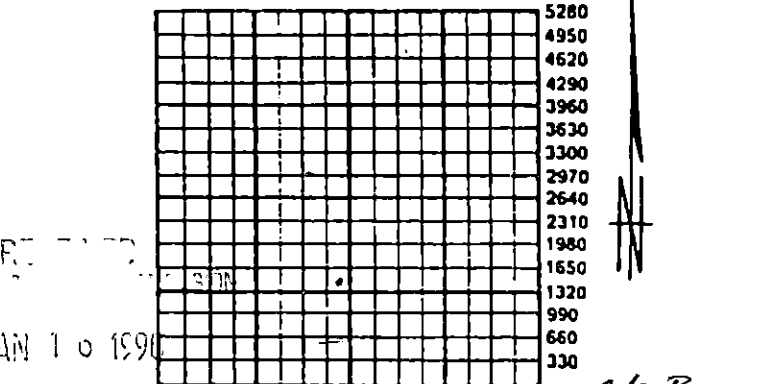

Amount of Surface Pipe Set and Cemented at 629 Feet

Multiple Stage Cementing Collar Used? Yes No

If yes, show depth set _____ Feet

If Alternate II completion, cement circulated from _____ feet depth to _____ w/ _____ sx cmt.

INSTRUCTIONS: This form shall be completed in triplicate and filed with the Kansas Corporation Commission, 200 Colorado Derby Building, Wichita, Kansas 67202, within 120 days of the spud date of any well. Rule 82-3-130, 82-3-107 and 82-3-106 apply. Information on side two of this form will be held confidential for a period of 12 months if requested in writing and submitted with the form. See rule 82-3-107 for confidentiality in excess of 12 months. One copy of all wireline logs and drillers time log shall be attached with this form. ALL CEMENTING TICKETS MUST BE ATTACHED. Submit CP-4 form with all plugged wells. Submit CP-111 form with all temporarily abandoned wells. Any recompletion, workover or conversion of a well requires filing of ACO-2 within 120 days from commencement date of such work.

All requirements of the statutes, rules and regulations promulgated to regulate the oil and gas industry have been fully complied with and the statements herein are complete and correct to the best of my knowledge.

Signature M. L. Pease

Title Division Production Manager Date 1/3/90

Subscribed and sworn to before me this 3rd day of January, 1990.

Notary Public Cheryl Steers

Date Commission Expires _____

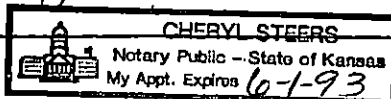

K.C.C. OFFICE USE ONLY
F Letter of Confidentiality Attached
C Wireline Log Received
 Drillers Timelog Received
Distribution
 KCC SWD/Rep NGPA
 KGS Plug Other (Specify)

SIDE TWO

Operator Name Anadarko Petroleum Corp. Lease Name McClure "G" Well # 3H

Sec. 9 Twp. 32S Rge. 38W East West County Stevens

INSTRUCTIONS: Show important tops and base of formations penetrated. Detail all cores. Report all drill stem tests giving interval tested, time tool open and closed, flowing and shut-in pressures, whether shut-in pressure reached static level, hydrostatic pressures, bottom hole temperature, fluid recovery, and flow rates if gas to surface during test. Attach extra sheet if more space is needed. Attach copy of log.

Drill Stem Tests Taken (Attach Additional Sheets.)	<input type="checkbox"/> Yes <input checked="" type="checkbox"/> No	Formation Description <input checked="" type="checkbox"/> Log <input type="checkbox"/> Sample <table border="1"> <thead> <tr> <th>Name</th> <th>Top</th> <th>Bottom</th> </tr> </thead> <tbody> <tr> <td>Blaine</td> <td>1117</td> <td>1197</td> </tr> <tr> <td>Cedar Hills</td> <td>1280</td> <td>1449</td> </tr> <tr> <td>Stone Corral</td> <td>1708</td> <td>1792</td> </tr> <tr> <td>Chase</td> <td>2501</td> <td>2846</td> </tr> <tr> <td>Council Grove</td> <td>2846</td> <td>NA</td> </tr> <tr> <td>TD</td> <td></td> <td>2908</td> </tr> </tbody> </table>	Name	Top	Bottom	Blaine	1117	1197	Cedar Hills	1280	1449	Stone Corral	1708	1792	Chase	2501	2846	Council Grove	2846	NA	TD		2908
Name	Top		Bottom																				
Blaine	1117		1197																				
Cedar Hills	1280		1449																				
Stone Corral	1708	1792																					
Chase	2501	2846																					
Council Grove	2846	NA																					
TD		2908																					
Samples Sent to Geological Survey	<input type="checkbox"/> Yes <input checked="" type="checkbox"/> No																						
Cores Taken	<input type="checkbox"/> Yes <input checked="" type="checkbox"/> No																						
Electric Log Run (Submit Copy.)	<input type="checkbox"/> Yes <input checked="" type="checkbox"/> No																						

CASING RECORD New Used
Report all strings set-conductor, surface, intermediate, production, etc.

Purpose of String	Size Hole Drilled	Size Casing Set (In O.D.)	Weight Lbs./Ft.	Setting Depth	Type of Cement	# Sacks Used	Type and Percent Additives
Surface	12 1/4	8 5/8	24	629	Poz/Comm	405	2%CC 1/2# sxs flocele
Production	7 7/8	5 1/2	14	2905	Class "C"	250	20% DCD 2%CC 1/2# sxs flocele

Shots Per Foot	PERFORATION RECORD Specify Footage of Each Interval Perforated	Acid, Fracture, Shot, Cement Squeeze Record (Amount and Kind of Material Used)	Depth
2	2816-40, 2784-95, 2728-60, 2673-2718	BK DN w/21200 gal 2% KCL WTR & 480 BS. F/136,600 gal X-Linked gelled 2% KCL WTR & 401,700# 12/20 SD.	2528-2840
2	2612-40, 2557-90, 2528-47		O.A.

TUBING RECORD Size Set At Packer At Liner Run Yes No

Date of First Production SI WOPL	Producing Method <input checked="" type="checkbox"/> Flowing <input type="checkbox"/> Pumping <input type="checkbox"/> Gas Lift <input type="checkbox"/> Other (Explain)
Estimated Production Per 24 Hours	Oil Bbls. Gas Mcfd Water Bbls. Gas-Oil Ratio Gravity
	1710 @ 100 psi

Disposition of Gas: Vented Sold Used on Lease (If vented, submit ACO-18.)

METHOD OF COMPLETION: Open Hole Perforation Dually Completed Commingled Other (Specify) _____

Production Interval: 2528-2840'
O.A.

ORIGINAL



REMIT TO:
P.O. BOX 951046 JAA
DALLAS, TX 75395-1046

INVOICE

HALLIBURTON SERVICES

A Halliburton Company

INVOICE NO.	DATE
844354	09/22/1989

WELL LEASE NO./PLANT NAME	WELL/PLANT LOCATION	STATE	WELL/PLANT OWNER		
MCCLURE G-3	STEVENS	KS	SAME		
SERVICE LOCATION	CONTRACTOR	JOB PURPOSE	TICKET DATE		
LIBERAL	GABBERT & JONES #11	CEMENT SURFACE CASING	09/22/1989		
ACCT. NO.	CUSTOMER AGENT	VENDOR NO.	CUSTOMER P.O. NUMBER	SHIPPED VIA	FILE NO.
019595	DAVID GILMORE		33876	COMPANY TRUCK	83172

ANADARKO PETROLEUM CORP
P. O. BOX 351
LIBERAL, KS 67905-0351

DIRECT CORRESPONDENCE TO:
SUITE 600
COLORADO DERBY BUILDING
WICHITA, KS 67202-0000

PRICE REF. NO.	DESCRIPTION	QUANTITY	UM	UNIT PRICE	AMOUNT
000-117	PRICING AREA - MID CONTINENT MILEAGE	20	MI	2.20	44.00
001-016	CEMENTING CASING	1	UNT		
030-016	CEMENTING PLUG SW ALUM TOP	634	FT	528.60	528.60
504-043	PREMIUM CEMENT	1	UNT		
506-105	POZMIX A	8 5/8	IN	90.00	90.00
504-043	PREMIUM CEMENT	1	EA		
509-406	ANHYDROUS CALCIUM CHLORIDE	191	SK	6.85	1,308.35
507-210	FLOCELE	64	SK	3.91	250.24
500-207	BULK SERVICE CHARGE	150	SK	6.85	1,027.50
500-306	MILEAGE CMTG MAT DEL OR RETURN	9	SK	25.75	231.75
		101	LB	1.21	122.21
		423	CFT	.95	401.85
		376.110	TMI	.70	263.28

INVOICE SUBTOTAL

4,267.78

DISCOUNT-(BID)
INVOICE BID AMOUNT

1,237.62-
3,030.16

*-KANSAS STATE SALES TAX
*-SEWARD COUNTY SALES TAX

111.51
26.25

FINAL APPROVAL	
ARE #	LOCATION
LIBERAL OPERATIONS RECEIVED	
OCT 05 1989	
APPROVED	IDC
DATE	TANGIBLE
10-3-89	
CODED BY	OPERATIONS

INVOICE TOTAL - PLEASE PAY THIS AMOUNT =====> \$3,167.92

TERMS INVOICES PAYABLE NET BY THE 20TH OF THE FOLLOWING MONTH AFTER DATE OF INVOICE. UPON CUSTOMER'S DEFAULT IN PAYMENT OF CUSTOMER'S ACCOUNT BY THE LAST DAY OF THE MONTH FOLLOWING THE MONTH IN WHICH THE INVOICE IS DATED, CUSTOMER AGREES TO PAY INTEREST THEREON AFTER DEFAULT AT THE HIGHEST LAWFUL CONTRACT RATE APPLICABLE BUT NEVER TO EXCEED 18% PER ANNUM. IN THE EVENT IT BECOMES NECESSARY TO EMPLOY AN ATTORNEY TO ENFORCE COLLECTION OF SAID ACCOUNT, CUSTOMER AGREES TO PAY ALL COLLECTION COSTS AND ATTORNEY FEES IN THE AMOUNT OF 20% OF THE AMOUNT OF THE UNPAID ACCOUNT.

GABBERT-JONES, INC.
DRILLERS WELL LOG

McCLURE "G" 3H
SEC. 9-32S-38W
STEVENS COUNTY, KANSAS

Commenced: 9-21-89
Completed: 9-26-89
Operator: ANADARKO PETROLEUM CORPORATION

Depth		Formation	Remarks
From	To		
0	67	Sand	Ran 15 jts of 24# 8 5/8" csg
67	525	Sand - Clay	LD @ 629' w/255 sks 25/75
525	1273	Redbed	Posmix - 2% CC - 1/4# CF
1273	1447	Glorietta Sand	150 sks Common - 3% CC
1447	1945	Shale	1/4# CF
1945	2369	Redbed-Anhy-Shale	PD @ 7:00 PM 9-22-89
2369	2880	Shale - Lime	1" to 70' w/100 sks Class H
2880	2908	Lime - Shale	3% CC CP @ 12:45 PM 9-23-89
	2908 TD		Ran 67 jts of 14# 5 1/2" csg LD @ 2905' w/210 sks Class C 20% DCD - 2% CC - 1/4# CF 40 sks Class C - 10% DCD 2% CC - 1/4# CF PD @ 6:00 AM 9-26-89. RR @ 7:00 AM 9-26-89.

RECEIVED
STATE COMMISSION
JAN 16 1990
CONSERVATION DIVISION
Wichita, Kansas

State of Kansas
County of Sedgwick

) I, the undersigned, being duly sworn on oath, state
) that the above Drillers' Well Log is true and correct
) to the best of my knowledge and belief and according
to the records of this office.

Gabbert-JONES, INC.

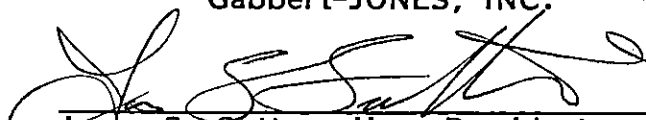
James S. Sutton, II -- President

Subscribed & sworn to before me this
29th day of September 1989

Lola Lenore Costa

My Commission expires Nov. 21, 1992

LOLA LENORE COSTA
NOTARY PUBLIC
STATE OF KANSAS
My Appt. Exp. 11/21/92