

STATE CORPORATION COMMISSION OF KANSAS  
OIL & GAS CONSERVATION DIVISION  
WELL COMPLETION OR RECOMPLETION FORM  
ACO-1 WELL HISTORY  
DESCRIPTION OF WELL AND LEASE

API NO. 15-189-21052-0000  
County Stevens  
SE NE SE Sec. 23 Twp 32S Rge 37 East West

Operator: License # 5208  
Name Mobil Oil Corporation  
Address P.O. Box 5444  
City/State/Zip Denver, CO 80217

1650 Ft North from Southeast Corner of Section  
330 Ft West from Southeast Corner of Section  
(Note: Locate well in section plat below)

Purchaser NA

Lease Name Republic Fee #1 Unit Well # 4

Operator Contact Person J. L. Douglass  
Phone (303) 298-2047

Field Name Unnamed (wildcat)

Producing Formation Morrow

Elevation: Ground 3109' KB 3125'

Contractor: License # 9137  
Name Unit Drilling & Expl. Co.  
Wellsite Geologist J. Bauman  
Phone 303-298-3706

Section Plat

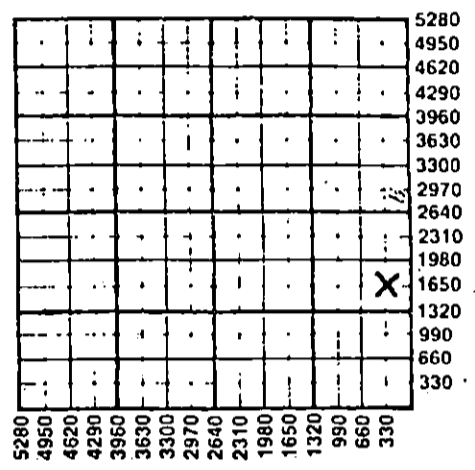

Designate Type of Completion  
 New Well  Re-Entry  Workover  
 Oil  SWD  Temp Abd  
 Gas  Inj  Delayed Comp.  
 Dry  Other (Core, Water Supply etc.)

WATER SUPPLY INFORMATION

Disposition of Produced Water:  Disposal  
Docket # NA  Repressuring

If OWN: old well info as follows:  
Operator  
Well Name  
Comp. Date  
Old Total Depth

WELL HISTORY

Drilling Method:  
 Mud Rotary  Air Rotary  Cable  
6-2-87 6-9-87 6-11-87  
Spud Date Date Reached TD Completion Date  
6497' TA'd  
Total Depth PBTD

Questions on this portion of the ACO-1 call:  
Water Resources Board (913) 296-3717

Source of Water:  
Division of Water Resources Permit # TB7-206

Groundwater 1500 Ft North from Southeast Corner  
(Well) 300 Ft West from Southeast Corner of  
Sec 23 Twp 32S Rge 37 East West

Amount of Surface Pipe Set and Cemented at 1769 feet  
Multiple Stage Cementing Collar Used?  Yes  No  
If yes, show depth set...feet  
If alternate 2 completion, cement circulated  
from...feet depth to...w/...SX cmt  
Cement Company Name  
Invoice # 817-I

Surface Water...Ft North from Southeast Corner  
(Stream, pond etc)...Ft West from Southeast Corner  
Sec Twp Rge East West  
Other (explain)  
(purchased from city, R.W.D. #)

INSTRUCTIONS: This form shall be completed in triplicate and filed with the Kansas Corporation Commission, 200 Colorado Derby Building, Wichita, Kansas 67202, within 120 days of the spud date of any well. Rule 82-3-130, 82-3-107 and 82-3-106 apply. Information on side two of this form will be held confidential for a period of 12 months if requested in writing and submitted with the form. See rule 82-3-107 for confidentiality in excess of 12 months. One copy of all wireline logs and drillers time log shall be attached with this form. Submit CP-4 form with all plugged wells. Submit CP-111 form with all temporarily abandoned wells.

All requirements of the statutes, rules and regulations promulgated to regulate the oil and gas industry have been fully complied with and the statements herein are complete and correct to the best of my knowledge.

Signature J. L. Douglass  
Title Regulatory Compliance Manager Date 4/22/88

K.C.C. OFFICE USE ONLY  
F Letter of Confidentiality Attached  
C Wireline Log Received  
C Drillers Timelog Received  
Distribution  
SWD/Rep NGPA  
KGS Plug Other (Specify)  
RECEIVED  
APR 28 1988  
4-28-88  
Form ACO-1 (5-86)

Subscribed and sworn to before me this 22nd day of April 1988  
Notary Public George  
Date Commission Expires 1/3/91

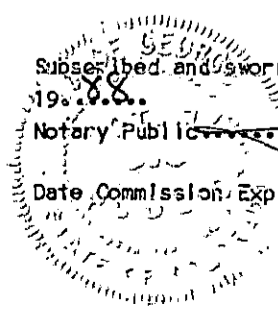

Sec. 23 Twp 32S Rge 37

Operator Name Mobil Oil Corp Lease Name Republic Fee #1 Unit #4

Sec. 23 Twp. 32 S Rge. 37  East  West County Stevens

WELL LOG

INSTRUCTIONS: Show important tops and base of formations penetrated. Detail all cores. Report all drill stem tests giving interval tested, time tool open and closed, flowing and shut-in pressures, whether shut-in pressure reached, static level, hydrostatic pressures, bottom hole temperature, fluid recovery, and flow rates if gas to surface during test. Attach extra sheet if more space is needed. Attach copy of log.

Drill Stem Tests Taken  Yes  No  
 Samples Sent to Geological Survey  Yes  No  
 Cores Taken  Yes  No

Formation Description  
 Log  Sample

Name	Top	Bottom
Base Stone Corral	1778'	
Summer	2210'	
Chase	2594'	
Winfield	2674'	
Council Grove	2903'	
Admire	3155'	
Wabauwsee	3325'	
Shawnee	3703'	
Lansing	4204'	
Kansas City	4575'	
Marmaton	4939'	
Cherokee	5168'	
Morrow	5635'	
Chester	6028'	
Ste. Genevieve	6207'	
St. Louis	6302'	

CASING RECORD  New  Used  
 Report all strings set-conductor, surface, intermediate, production, etc.

Purpose of String	Size Hole Drilled	Size Casing Set (In O.D.)	Weight Lbs/Ft.	Setting Depth	Type of Cement	#Sacks Used	Type and Percent Additives
SURFACE	12-1/4"	8-3/8"	24#	1769'	CL C LITE	68.55x	65:35:6 + 2% CAC
PRODUCTION	7-7/8"	5-1/2"	15.5#	3073'	CL C	100x	+ 2% CAC
					CL H	640	50:50 + 2% GE

Shots Per Foot	Specify Footage of Each Interval Perforated	Acid, Fracture, Shot, Cement Squeeze Record (Amount and Kind of Material Used)	Depth
TA'd	TA'd		

TUBING RECORD Size TA'd Set At TA'd Packer at TA'd Liner Run  Yes  No

Date of First Production TA'd Producing Method  Flowing  Pumping  Gas Lift  Other (explain).....

Estimated Production Per 24 Hours	Oil Bbls	Gas MCF	Water Bbls	Gas-Oil Ratio	Gravity
TA'd					

METHOD OF COMPLETION

Production Interval

Disposition of gas:  Vented  Open Hole  Perforation  
 Sold  Other (Specify) .....  
 Used on Lease  Dually Completed  Commingled

