

STATE CORPORATION COMMISSION OF KANSAS OIL & GAS CONSERVATION DIVISION WELL COMPLETION OR RECOMPLETION FORM ACO-1 WELL HISTORY DESCRIPTION OF WELL AND LEASE

Operator: License # 4549 Name Anadarko Petroleum Corporation Address P.O. Box 351 City/State/Zip Liberal, KS 67905-0351

Purchaser: Panhandle Eastern Pipe Line Company (Transporter)

Operator Contact Person M. L. Pease Phone (316) 624-6253

Contractor: License # 5842 Name Gabbert-Jones, Inc.

Wellsite Geologist C. Isban Phone NA

Designate Type of Completion: X New Well, Re-Entry, Workover, Oil, SWD, Temp Abd, X Gas, Inj, Delayed Comp., Dry, Other (Core, Water Supply etc.)

If OWWG: old well info as follows: Operator, Well Name, Comp. Date, Old Total Depth

WELL HISTORY

Drilling Method: X Mud Rotary, Air Rotary, Cable. Spud Date: 5-26-89, Date Reached TD: 6-9-89, Completion Date: 7-28-89. Total Depth: 6525, PBDT: 5997.

Amount of Surface Pipe Set and Cemented at 1743 feet. Multiple Stage Cementing Collar Used? Yes X No. Cement Company Name Halliburton Services, Invoice # 803055.

API NO. 15-189-21,336-0000 County: Stevens FROM CONFIDENTIAL NE SE NE Sec 12 Twp 32S Rge 38 X West

3890 Ft North from Southeast Corner of Section 1250 Ft West from Southeast Corner of Section (Note: Locate well in section plat below)

Lease Name: METTS "A" Well #: 2 Field Name: Bucksnot Prospect Producing Formation: Lower Morrow Elevation: Ground: 3144.0 KB N/A

Section Plat

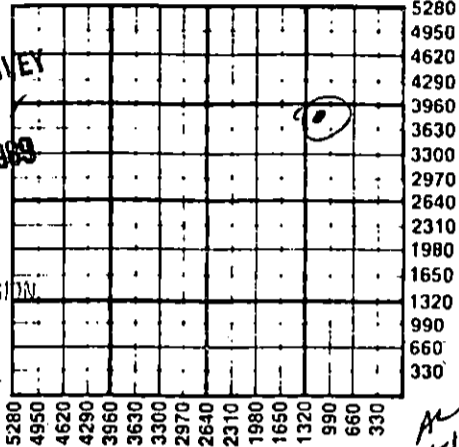

WATER SUPPLY INFORMATION

Disposition of Produced Water: Docket #, Disposal, Repressuring

Questions on this portion of the ACO-1 call: Water Resources Board (913) 296-3717

Source of Water: Division of Water Resources Permit #

Groundwater: Ft North from Southeast Corner (Well) Ft West from Southeast Corner of Sec Twp Rge East West

Surface Water: Ft North from Southeast Corner (Stream, pond etc) Ft West from Southeast Corner Sec Twp Rge East West

Other (explain): Contractor provided water. (purchased from city, R.W.D. #)

INSTRUCTIONS: This form shall be completed in triplicate and filed with the Kansas Corporation Commission, 200 Colorado Derby Building, Wichita, Kansas 67202, within 120 days of the spud date of any well. Rule 82-3-130, 82-3-107 and 82-3-106 apply. Information on side two of this form will be held confidential for a period of 12 months if requested in writing and submitted with the form. See rule 82-3-107 for confidentiality in excess of 12 months. One copy of all wireline logs and drillers time log shall be attached with this form. Submit CP-4 form with all plugged wells. Submit CP-111 form with all temporarily abandoned wells.

All requirements of the statutes, rules and regulations promulgated to regulate the oil and gas industry have been fully complied with and the statements herein are complete and correct to the best of my knowledge.

Signature: M. L. Pease Title: Division Production Manager Date: 9/20/89

Subscribed and sworn to before me this 20th day of September 1989. Notary Public: Cheryl Steers

Date Commission Expires: Cheryl Steers Notary Public - State of Kansas My Appt. Expires 6-1-93

K.C.C. OFFICE USE ONLY. Letter of Confidentiality Attached, Wireline Log Received, Drillers Time Log Received. Distribution: KCC, KGS, SWD/Rep, Plug, NGPA, Other (Specify).

Operator Name Anadarko Petroleum Corporation Lease Name METTS "A" Well # 2

Sec. 12 Twp. 32S Rge. 38 East West County Stevens **RELEASED**

NOV 01 1990

WELL LOG

FROM CONFIDENTIAL

INSTRUCTIONS: Show important tops and base of formations penetrated. Detail all cores. Report all drill stem tests giving interval tested, time tool open and closed, flowing and shut-in pressures, whether shut-in pressure reached static level, hydrostatic pressures, bottom hole temperature, fluid recovery, and flow rates if gas to surface during test. Attach extra sheet if more space is needed. Attach copy of log.

Drill Stem Tests Taken Yes No
 Samples Sent to Geological Survey Yes No
 Cores Taken Yes No

Formation Description
 Log Sample

DST #1: 6/6/89 5940-5952 (L. Morrow)
 Open tool @ 6:05 am
 Close tool @ 9:05 am
 Flowing pressure 160 psi
 Shut-in pressure 1776 psi
 Hydrostatic pressure 2778 psi
 Bottom hole temperature 150° F @ 5947
 Fluid recovery 20 ft gas cut mud
 Flow rate 750 MCFD

Name	Top	Bottom
Sand	0	59
Sand-Clay-Gyp Stks	59	530
Redbed-Gyp	530	715
Redbed-Gyp-Sand	715	1210
Gyp-Sand	1210	1680
Redbed-Gyp	1680	1746
Anly-Shale	1746	2200
Shale	2200	2485
Shale-Lime	2485	2790
Lime-Shale	2790	6525
TD		6525

*TIMES: Interval/Final Flows
 " " Shut-In's etc.
 GAS GAUGES x times etc.*

~~SEE ATTACHMENT~~

* ~~SEE ATTACHMENT~~

CASING RECORD <input checked="" type="checkbox"/> New <input type="checkbox"/> Used Report all strings set-conductor, surface, intermediate, production, etc.							
Purpose of String	Size Hole Drilled	Size Casing Set (In O.D.)	Weight Lbs/Ft.	Setting Depth	Type of Cement	#Sacks Used	Type and Percent Additives
Surface	12 1/4	8 5/8	24	1743	Pozmix	850	2% cc
Production	7 7/8	4 1/2	11.6	6044	Thickset	290	5% KCL 1/4# Flocele
PERFORATION RECORD				Acid, Fracture, Shot, Cement Squeeze Record (Amount and Kind of Material Used)			
Shots Per Foot	Specify Footage of Each Interval Perforated					Depth	
4	5932-5946			None		5932-46	
TUBING RECORD		Size	Set At	Packer at	Liner Run	<input type="checkbox"/> Yes <input checked="" type="checkbox"/> No	
		2 3/8	5900	5900			
Date of First Production		Producing Method					
SI - NO PIPELINE		<input checked="" type="checkbox"/> Flowing <input type="checkbox"/> Pumping <input type="checkbox"/> Gas Lift <input type="checkbox"/> Other (explain).....					
Estimated Production Per 24 Hours		Oil	Gas	Water	Gas-Oil Ratio	Gravity	
➔		Bbls	1140 MCF	Bbls	CFPB		

METHOD OF COMPLETION

Production Interval

Disposition of gas: Vented Sold Used on Lease
 Open Hole Perforation Other (Specify)

5932'-5946'.....
 (Lower Morrow)...

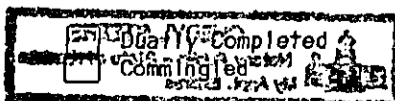



INVOICE ORIGINAL HALLIBURTON SERVICES RELEASED

A Halliburton Company

NOV 0 1 1990

INVOICE NO.	DATE
803055	05/27/1989

WELL LEASE NO./PLANT NAME	WELL/PLANT LOCATION	STATE	WELL/PLANT OWNER		
METTS A-2	STEVENS FROM CONFIDENTIAL	KS	SAME		
SERVICE LOCATION	CONTRACTOR	JOB PURPOSE	TICKET DATE		
LIBERAL	GABBERT & JONES #12	CEMENT SURFACE CASING	05/27/1989		
ACCT. NO.	CUSTOMER AGENT	VENDOR NO.	CUSTOMER P.O. NUMBER	SHIPPED VIA	FILE NO.
019595	DAVID GILMORE		33876	COMPANY TRUCK	7723

ANADARKO PETROLEUM CORP
P. O. BOX 351
LIBERAL, KS 67905-0351

DIRECT CORRESPONDENCE TO:
SUITE 600
COLORADO DERBY BUILDING
WICHITA, KS 67202-0000

PRICE REF. NO.	DESCRIPTION	QUANTITY	U/M	UNIT PRICE	AMOUNT
000-117	MILEAGE	10	MI	2.20	22.00
		1	UNT		
001-016	CEMENTING CASING	1757	FT	887.00	887.00
		1	UNT		
030-016	CEMENTING PLUG 5W ALUM TOP	8 5/8	IN	82.00	82.00
		1	EA		
504-043	PREMIUM CEMENT	200	SK	6.85	1,370.00
504-043	PREMIUM CEMENT	325	SK	6.85	2,226.25
506-105	POZMIX A	325	SK	3.91	1,270.75
506-121	HALLIBURTON-GEL 2%	11	SK	.00	N/C
507-277	HALLIBURTON-GEL BENTONITE	11	SK	13.00	143.00
509-406	ANHYDROUS CALCIUM CHLORIDE	15	SK	25.75	386.25
500-207	BULK SERVICE CHARGE	880	CFT	.95	836.00
500-306	MILEAGE CMTG MAT DEL OR RETURN	383.920	TMI	.70	268.74

INVOICE SUBTOTAL

4335 - 2041

7,491.99

DISCOUNT-(BID)
INVOICE BID AMOUNT

2,622.17-
4,869.82

*-KANSAS STATE SALES TAX
*SEWARD COUNTY SALES TAX
RECEIVED
STATE CORPORATION COMMISSION

FINAL APPROVAL
LIBERAL OPERATIONS RECEIVED
JUN 08 1989
APPROVED
IDC
6-9-89

11-21-1989
CONSERVATION DIVISION
Wichita, Kansas

INVOICE TOTAL - PLEASE PAY THIS AMOUNT =====> \$5,083.77

TERMS: INVOICES PAYABLE NET BY THE 20TH OF THE FOLLOWING MONTH AFTER DATE OF INVOICE. UPON CUSTOMER'S DEFAULT IN PAYMENT OF CUSTOMER'S ACCOUNT BY THE LAST DAY OF THE MONTH FOLLOWING THE MONTH IN WHICH THE INVOICE IS DATED, CUSTOMER AGREES TO PAY INTEREST THEREON AFTER DEFAULT AT THE HIGHEST LAWFUL CONTRACT RATE APPLICABLE BUT NEVER TO EXCEED 18% PER ANNUM IN THE EVENT IT BECOMES NECESSARY TO EMPLOY AN ATTORNEY TO ENFORCE COLLECTION OF SAID ACCOUNT, CUSTOMER AGREES TO PAY ALL COLLECTION COSTS AND ATTORNEY FEES IN THE AMOUNT OF 20% OF THE AMOUNT OF THE UNPAID ACCOUNT.

ATTACHMENT

ORIGINAL

RELEASED

METTS "A" No. 2
Section 12-32S-38W
Stevens County, Kansas

JAN 02 1991

API #15-189-21,336

FROM CONFIDENTIAL

<u>FORMATION</u>	<u>DEPTH</u>	<u>SUBSEA (GL 3144)</u>
BASE STONE CORRAL	1756	+1388
TOP CHASE GROUP	2516	+628
TOP COUNCIL GROVE	2832	+312
TOP ADMIRE	3058	+86
TOP WABAUNSEE	3253	-109
TOP TOPEKA	3514	-370
TOP HEEBNER	4026	-882
TOP TORONTO	4058	-914
TOP LANSING	4150	-1006
TOP KANSAS CITY	4564	-1420
TOP MARMATON	4818	-1674
TOP CHEROKEE	5034	-1890
TOP MORROW	5550	-2406
TOP CHESTER	5948	-2804
TOP STE. GENEVIEVE	6064	-2920
TOP ST. LOUIS	6200	-3056

DST # 1 - 5940-5952'; 30"-60"-90"-150"

G.T.S./2nd open ga. 260 MCF ~~increasing~~ to 750 MCF (Possible plugging)

150' @ 5947'; spl. rec. 210#, 1.19 cu ft. gas; drillstring rec.

20' DM w/gas.

I.H. 2783; F.H. 2788

I.F. 235-303#; F.F. 67-160#

ISIP 1744#; FSIP 1776#

*DW
KCC*

RECEIVED
STATE CORPORATION COMMISSION

DEC 7 1990

CORPORATION COMMISSION
Wichita, Kansas

GABBERT-JONES
DRILLERS WELL LOG

METTS A
SEC. 12-32S-38W
STEVENS COUNTY, KS

ORIGINAL

RELEASED

NOV 0 1 1990

FROM CONFIDENTIAL

Commenced: 5-26-89
Completed: 6-9-89
Operator: ANADARKO PETROLEUM CORP.

Depth		Formation	Remarks
From	To		
0	59	Sand	Ran 44 jts of 24# 8 5/8"
59	530	Sand-Clay-Gyps Stks	csg LD @ 1743 W/650
530	715	Redbed-Gyp	sks posmix - 4% Gel -
715	1210	Redbed-Gyp-Sand	2% CC- 200 sks Common
1210	1680	Gyp-Sand	2% CC - PD @ 8:30 PM
1680	1746	Redbed-Gyp	5-27-89
1746	2200	Anly-Shale	
2200	2485	Shale	Ran 143 jts of 11.6# 4 1/2"
2485	2790	Shale-Lime	csg LD @ 6044' W/50 sks
2790	6525	Lime-Shale	Lite - 240 sks Thickset
			5% KCL - 1/4# FS
			PD @ 5:30 PM 6-9-89
			RR @ 6:30 PM 6-9-89
	6525 - TD		

RECEIVED
STATE CORPORATION COMMISSION
Oct 21 1989
CONSERVATION DIVISION
Wichita, Kansas

State of Kansas)
County of Sedgwick) I, the undersigned, being duly sworn on oath, state that the above Drillers ' Well Log is true and correct to the best of my knowledge and belief and according to the records of this office.

GABBERT-JONES, INC.

[Signature]
James S. Sutton, II --President

LOLA LENORE COSTA
NOTARY PUBLIC
STATE OF KANSAS
My Appt. Exp. 11/21/92

Subscribed & sworn to before me this
16th day of June 1989

[Signature]
Lola Lenore Costa

My Commission expires Nov. 21, 1992