

STATE CORPORATION COMMISSION OF KANSAS
OIL & GAS CONSERVATION DIVISION
WELL COMPLETION OR RECOMPLETION FORM
ACO-1 WELL HISTORY
DESCRIPTION OF WELL AND LEASE

API No. 15-189-21,230-0000
County Stevens
NE SW NE Sec. 28 Twp. 32S Rge. 37 East
West

Operator: License # 5003
Name McCoy Petroleum Corporation
Address 110 S. Main, Suite 500
City/State/Zip Wichita, Kansas 67202

3630 Ft North from Southeast Corner of Section
1650 Ft West from Southeast Corner of Section
(Note: Locate well in section plat below)

Purchaser

Lease Name Hittle Well # 1-28

Operator Contact Person Roger McCoy
Phone (316) 265-9697

Field Name Gentzler Field Extension

Producing Formation

Contractor: License # 5658
Name Sweetman Drilling, Inc.

Elevation: Ground 3139 KB 3149

Wellsite Geologist John Hastings
Phone (316) 265-9697

Designate Type of Completion
 New Well Re-Entry Workover
 Oil SWD Temp Abd
 Gas Inj Delayed Comp.
 Dry Other (Core, Water Supply etc.)

RECEIVED
STATE CORPORATION COMMISSION

AUG 18 1988

CONSERVATION DIVISION
Wichita, Kansas

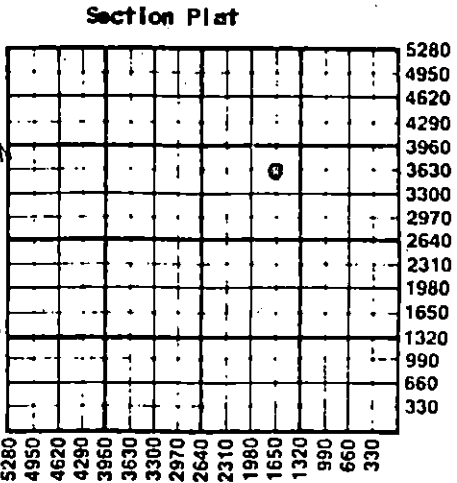

If OWN: old well info as follows:
Operator
Well Name
Comp. Date Old Total Depth

WATER SUPPLY INFORMATION

Disposition of Produced Water: Disposal
Docket # Repressuring

WELL HISTORY
Drilling Method:
 Mud Rotary Air Rotary Cable
8-3-88 8-14-88 8-15-88
Spud Date Date Reached TD Completion Date
6500'
Total Depth PBTD

Questions on this portion of the ACO-1 call:

Water Resources Board (913) 296-3717
Source of Water:
Division of Water Resources Permit # T88-379
 Groundwater 3630 Ft North from Southeast Corner
(Well) 1650 Ft West from Southeast Corner of
Sec 28 Twp 32S Rge 37 East West
 Surface WaterFt North from Southeast Corner
(Stream, pond etc)Ft West from Southeast Corner
Sec Twp Rge East West
 Other (explain)
(purchased from city, R.W.D. #)

Amount of Surface Pipe Set and Cemented at 1752 feet
Multiple Stage Cementing Collar Used? Yes No
If yes, show depth setfeet
If alternate 2 completion, cement circulated
fromfeet depth tow/.....SX cmt
Cement Company Name
Invoice # Air I

INSTRUCTIONS: This form shall be completed in triplicate and filed with the Kansas Corporation Commission, 200 Colorado Derby Building, Wichita, Kansas 67202, within 120 days of the spud date of any well. Rule 82-3-130, 82-3-107 and 82-3-106 apply. Information on side two of this form will be held confidential for a period of 12 months if requested in writing and submitted with the form. See rule 82-3-107 for confidentiality in excess of 12 months. One copy of all wireline logs and drillers time log shall be attached with this form. Submit CP-4 form with all plugged wells. Submit CP-111 form with all temporarily abandoned wells.

All requirements of the statutes, rules and regulations promulgated to regulate the oil and gas industry have been fully complied with and the statements herein are complete and correct to the best of my knowledge.

Signature [Signature]
Title President Date 8-17-88

Subscribed and sworn to before me this 17th day of August 1988
Notary Public Deborah Ann Paulus

Date Commission Expires January 8, 1992

K.C.C. OFFICE USE ONLY
 Letter of Confidentiality Attached
 Wireline Log Received
 Drillers Time Log Received
Distribution
 KCC SWD/Rep NGPA
 KGS Plug Other
(Specify)
8-18-88

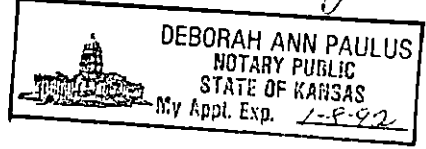

Section 28, Twp 32S, Rge 37E

SIDE TWO

Operator Name McCoy Petroleum Corporation Lease Name Hittle Well # 1-28

Sec. 28 Twp. 32S Rge. 37 East West County Stevens MAR. 0. 5. 1990

RELEASED

WELL LOG

FROM CONFIDENTIAL

INSTRUCTIONS: Show important tops and base of formations penetrated. Detail all cores. Report all drill stem tests giving interval tested, time tool open and closed, flowing and shut-in pressures, whether shut-in pressure reached static level, hydrostatic pressures, bottom hole temperature, fluid recovery, and flow rates if gas to surface during test. Attach extra sheet if more space is needed. Attach copy of log.

Drill Stem Tests Taken Yes No
 Samples Sent to Geological Survey Yes No
 Cores Taken Yes No

Formation Description
 Log Sample

Name	Top	Bottom
ELECTRIC LOG TOPS		
Winfield	2648	(+ 501)
Council Grove	2878	(+ 271)
Wabaunsee	3306	(- 157)
Heebner	4124	(- 975)
Toronto	4143	(- 994)
Lansing	4200	(-1051)
Lansing "A"	4266	(-1117)
Marmaton	4918	(-1769)
Cherokee	5142	(-1993)
Atoka	5421	(-2272)
Morrow Shale	5624	(-2475)
Lower Morrow Sand	5942	(-2793)
Chester	6040	(-2891)
St. Genevieve	6182	(-3033)
St. Louis	6324	(-3175)
Log Total Depth	6502	(-3353)

CASING RECORD <input checked="" type="checkbox"/> New <input type="checkbox"/> Used								
Report all strings set-conductor, surface, intermediate, production, etc.								
Purpose of String	Size Hole Drilled	Size Casing Set (In O.D.)	Weight Lbs/Ft.	Setting Depth	Type of Cement	#Sacks Used	Type and Percent Additives	
Surface Casing	12-1/4"	8-5/8"	24#	1752'	Light Premium	525 125	1/2 flocculent 2% cc	
PERFORATION RECORD				Acid, Fracture, Shot, Cement Squeeze Record				
Shots Per Foot	Specify Footage of Each Interval Perforated			(Amount and Kind of Material Used)		Depth		
TUBING RECORD				Liner Run <input type="checkbox"/> Yes <input type="checkbox"/> No				
Size	Set At	Packer at						
Date of First Production		Producing Method						
		<input type="checkbox"/> Flowing <input type="checkbox"/> Pumping <input type="checkbox"/> Gas Lift <input type="checkbox"/> Other (explain).....						
Estimated Production Per 24 Hours	Oil		Gas		Water		Gas-Oil Ratio	
	Bbls		MCF		Bbls		CFPB	

METHOD OF COMPLETION

Production Interval

Disposition of gas: Vented Open Hole Perforation
 Sold Other (Specify)
 Used on Lease Dually Completed
 Commingled