

AFFIDAVIT OF COMPLETION FORM

ACO-1

This form shall be filed in triplicate with the Kansas Corporation Commission, 200 Colorado Derby Building, Wichita, Kansas 67202, within ten days after the completion of the well regardless of how the well was completed. Circle one: Oil, gas, dry, SWD, OWWO, injection. Type and complete ALL sections. Applications must be filed for dual completion, commingling, salt water disposal and injection. Attach wireline logs (i.e. electrical log, sonic log, gamma ray neutron log, etc.) KCC#-(316)263-3238.

OPERATOR Mobil Oil Corporation
 ADDRESS P. O. Box 5444
Denver, CO 80217-5444
 **CONTACT PERSON C. J. Park
 PHONE 303/572-2696
 PURCHASER Northern Natural Gas Co.
 ADDRESS 2223 Dodge Street
Omaha, Nebraska 68102
 DRILLING CONTRACTOR Earl F. Wakefield, Inc.
 ADDRESS 300 W. Douglas, Suite 500
Wichita, KS 67202

API NO. 15-189-20556-0000
 COUNTY Stevens
 FIELD Panoma
 PROD. FORMATION Panoma Council Grove
 LEASE Republic Fee Unit #4
 WELL NO. #5
 WELL LOCATION Sec. 28-32S-36W
1250 Ft. from South Line and
1250 Ft. from East Line of
 the SEC. 28 TWP. 32S RGE. 36W

PLUGGING CONTRACTOR ADDRESS _____

TOTAL DEPTH 3160' PBDT 3145'
 SPUD DATE 3/31/82 DATE COMPLETED 4/22/82
 ELEV: GR 3059' DF _____ KB 3067'

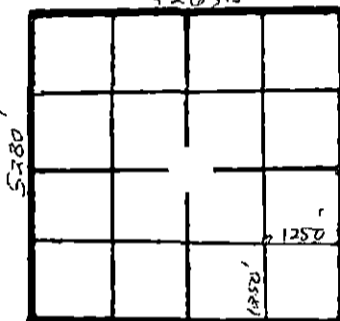

WELL PLAT
 KCC _____
 KGS _____
 MISC _____
 (Office Use)

DRILLED WITH (CABLE) (ROTARY) (AIR) TOOLS (New) / (Used) casing.
CASING RECORD

Report of all strings set — surface, intermediate, production, etc.

Purpose of string	Size hole drilled	Size casing set (in O.D.)	Weight lbs/ft.	Setting depth	Type cement	Sacks	Type and percent additives
Surface casing	12 1/4"	8 5/8"	24#	636'	Class H	150	12% gel + 3% CaCl ₂
					Class H	150	3% CaCl ₂
					Lite	500	65-35 Poz 1/4# D-29/sk
Prod. casing	7 7/8"	5 1/2"	14#	3160'	Class H	150	18% salt + .75 % TIC + 2% D-45

LINER RECORD

PERFORATION RECORD

Top, ft.	Bottom, ft.	Sacks cement	Shots per ft. 2H/Ft.	Size & type	Depth interval
					2943/2949, 2950/2955
					2965/2968, 2968/2975
					2978/2982
					3012/3016

ACID, FRACTURE, SHOT, CEMENT SQUEEZE RECORD

Amount and kind of material used	Depth interval treated
Acidized down 5 1/2" csg. w/4284 gal. L401	2943/3016
acid & additives w/87 ball sealers.	

Date of first production _____ Producing method (Flowing, pumping, gas lift, etc.) _____ Gravity Awaited Pipeline Connection
 Awaiting Pipeline Connection Pipeline Connection

RATE OF PRODUCTION PER 24 HOURS	Oil bbls.	Gas MCF	Water %	Gas-oil ratio bbls.
Awaiting Pipeline Connection				
				Perforations 2943/3016

*The person who can be reached by phone regarding any questions concerning this information. A witnessed initial test by the Commission is required if the well produces more than 25 BOPD or is located in a Basic Order Pool.

RECEIVED
 STATE CORPORATION COMMISSION
 CONSERVATION DIVISION
 WICHITA, KANSAS
 11-20-82

Name of lowest fresh water producing stratum _____ Depth _____

Estimated height of cement behind Surface Pipe _____

DV USED? $1\frac{1}{4}^\circ$ at 636', $1\frac{1}{2}^\circ$ at 1207', $1\frac{1}{2}^\circ$ at 3160'

WELL LOG

Formation Description, Contents, etc.	Top	Bottom	Name	Depth
Sand & Clay	0	505	Stone Corral	1,716
Red Bed	505	1,050	Chase	2,596
Shale	1,050	1,230	Winfield	2,702
Sand	1,230	1,450	Council Grove	2,934
Shale	1,450	1,530		
Shale & Anhydrite	1,530	1,980		
Shale	1,980	2,190		
Shale & Lime	2,190	2,440		
Lime & Shale	2,440	3,160		
R.T.D.	3,160	3,160		

A F F I D A V I T

STATE OF Colorado, COUNTY OF Denver SS, _____

C. J. Park OF LAWFUL AGE, BEING FIRST DULY SWORN UPON HIS OATH,

DEPOSES THAT HE IS Producing Accounting Supervisor (OF) Mobil Oil Corporation

OPERATOR OF THE Republic Fee Unit #4 LEASE, AND IS DULY AUTHORIZED TO MAKE

THIS AFFIDAVIT FOR AND ON THE BEHALF OF SAID OPERATOR, THAT WELL NO. #5 ON

SAID LEASE HAS BEEN COMPLETED AS OF THE 22nd DAY OF April, 19 82, AND THAT

ALL INFORMATION ENTERED HEREIN WITH RESPECT TO SAID WELL IS TRUE AND CORRECT.

FURTHER AFFIANT SAITH NOT.

SUBSCRIBED AND SWORN BEFORE ME THIS 6 DAY OF May, 19 82

(S) C. J. Park
Judith A. Olson
NOTARY PUBLIC

MY COMMISSION EXPIRES: 11-28-84