

STATE OF KANSAS
STATE CORPORATION COMMISSION

WELL PLUGGING RECORD

Give All Information Completely
Make Required Affidavit
Mail or Deliver Report to
Conservation Division
State Corporation Comm.
245 North Water
Wichita, KS 67202

Pratt County. Sec. 30 Twp. 28S Rge. 11W E/W
Location as "NE/CNW $\frac{1}{4}$ /SW $\frac{1}{4}$ " or footage from lines

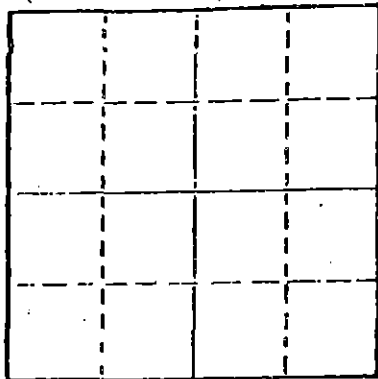

Locate well correctly on above
Section Plat

C NE SE
Lease Owner Raymond Oil Company
Lease Name Armitstead Well No. 1-A
Office Address 200 West Douglas, Suite 800, Wichita, Ks
Character of Well (Completed as Oil, Gas or Dry Hole)
Dry Hole

Date Well completed October 14, 1977
Application for plugging filed October 13, 1977
Application for plugging approved October 13, 1977
Plugging commenced October 14, 1977
Plugging completed October 14, 1977
Reason for abandonment of well or producing formation
Dry

If a producing well is abandoned, date of last production
19

Was permission obtained from the Conservation Division or
its agents before plugging was commenced? Yes

Name of Conservation Agent who supervised plugging of this well Bill Owens
Producing formation _____ Depth to top _____ Bottom _____ Total Depth of Well _____
Show depth and thickness of all water, oil and gas formations.

OIL, GAS OR WATER RECORDS

CASING RECORD

FORMATION	CONTENT	FROM	TO	SIZE	PUT IN	PULLED OUT

Describe in detail the manner in which the well was plugged, indicating where the mud fluid
was placed and the method or methods used in introducing it into the hold. If cement or other
plugs were used, state the character of same and depth placed, from _____ feet to
_____ feet for each plug set.

Plugged: Mud to 450, spot 40 sacks cement
Mud to 260 with 35 sacks cement; Mud to 40
Plug and 1/2 sack hulls, 12 sacks cement,
3 sacks in rathole, 3 sacks in mousehole.
Plugged @ 11:15 A

RECEIVED
STATE CORPORATION COMMISSION
OCT 26 1977
CONSERVATION DIVISION
Wichita, Kansas

(If additional description is necessary, use BACK of this sheet)

Name of Plugging Contractor DaMac Drilling Inc.
Box 1164, Great Bend, Kansas 67530

STATE OF Kansas COUNTY OF Barton, ss.

Martha J. McKown (employee of owner) or (owner or operator) of the above-described
well, being first duly sworn on oath, says: That I have knowledge of the facts, statements, and matters herein contained and the log of the
above-described well as filed and that the same are true and correct. So help me God.

STATE NOTARY PUBLIC
LANA L. REMMERT
Barton County, Kansas
My Appt. Exp. _____

(Signature) Martha J. McKown
Box 1164, Great Bend, Kansas 67530
(Address)

SWORN AND SWORN TO before me this 17th day of October, 1977

My commission expires 4-28-81

Notary Public.

KANSAS DRILLERS LOG

S. 30 T. 28S R. 11W ^E/_W

API No. 15 _____
 County _____ Number _____

Loc. C NE SE

Operator
Raymond Oil Company

County Pratt

Address
200 West Douglas, Suite 800, Wichita, Ks. 67202

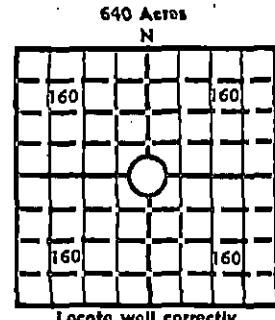

Well No. 1-A Lease Name Armitstead

Footage Location
C NE SE foot from (N) (S) line _____ foot from (E) (W) line _____

Principal Contractor DaMac Drilling Inc. Geologist _____

Spud Date 10-10-77 Total Depth 2811 P.B.T.D. _____

Elev.: Gr. _____

Date Completed 10-14-77 Oil Purchaser _____

DF _____ KB _____

CASING RECORD

Report of all strings set — surface, intermediate, production, etc.

Purpose of string	Size hole drilled	Size casing set (in O.D.)	Weight lbs/ft.	Setting depth	Type cement	Sacks	Type and percent additives
Surface	12 1/4	8 5/8	28	262	Reg & 2% Gel	250	3%CC

LINER RECORD

PERFORATION RECORD

Top, ft.	Bottom, ft.	Sacks cement	Shots per ff.	Size & type	Depth interval

TUBING RECORD

Size	Setting depth	Pecker set at

ACID, FRACTURE, SHOT CEMENT SQUEEZE RECORD

Amount and kind of material used	Depth interval treated

RECEIVED
 STATE CORPORATION COMMISSION
 OCT 26 1977
 CONSERVATION DIVISION
 Wichita, Kansas

INITIAL PRODUCTION

Date of first production _____	Producing method (flowing, pumping, gas lift, etc.) _____
RATE OF PRODUCTION PER 24 HOURS	Oil _____ bbls. Gas _____ MCF Water _____ bbls. Gas-oil ratio _____ CFPB
Disposition of gas (vented, used on lease or sold) _____	Producing interval (s) _____

INSTRUCTIONS: As provided in KCC Rule 82-2-125, within 90 days after completion of a well, one completed copy of this Drillers Log shall be transmitted to the State Geological Survey of Kansas, 4150 Monroe Street, Wichita, Kansas 67209. Copies of this form are available from the Conservation Division, State Corporation Commission, 3830 So. Meridian (P.O. Box 17027), Wichita, Kansas 66217. Phone AC 316-522-2206. If confidential custody is desired, please note Rule 82-2-125. Drillers Logs will be on open file in the Oil and Gas Division, State Geological Survey of Kansas, Lawrence, Kansas 66044.

Operator Raymond Oil Company		DESIGNATE TYPE OF COMP.: OIL, GAS, DRY HOLE, SWDW, ETC.:
Well No. A-1	Lease Name Armitstead	Dry Hole

S 30 T 28S R 11W^E_W

WELL LOG

Show all important zones of porosity and contents thereof; cored intervals, and all drill-stem tests, including depth interval tested, cushion used, time tool open, flowing and shut-in pressures, and recoveries.

SHOW GEOLOGICAL MARKERS, LOGS RUN, OR OTHER DESCRIPTIVE INFORMATION.

FORMATION DESCRIPTION, CONTENTS, ETC.	TOP	BOTTOM	NAME	DEPTH
Surface Clay, Sand, Shells	0	195		
RedBed	195	263		
Shale, RedBed	263	1195		
Shale	1195	1774		
Shale, Lime	1774	2811RTD		

USE ADDITIONAL SHEETS, IF NECESSARY, TO COMPLETE WELL RECORD.

Date Received	<i>Matthew J. McKernan</i>
	Signature
	Vice President
	Title
	October 17, 1977
	Date