

WELL PLUGGING RECORD

Give All Information Completely
Make Required Affidavit
Mail or Deliver Report to:
Conservation Division
State Corporation Commission
212 No. Market
Wichita, Kansas

Stevens County, Sec. 29 Twp. 34S Rge. 38W (5) (W)
Location as "NE/CNWSW" or footage from lines 1390' FSL & 660' FEL
Lease Owner Anadarko Production Company
Lease Name MORRIS "A" Well No. 1
Office Address P. O. Box 351, Liberal, Kansas 67901
Character of Well (completed as Oil, Gas or Dry Hole) Dry Hole
Date well completed 1/20 1976
Application for plugging filed 4/27 1976
Application for plugging approved 4/29 1976
Plugging commenced 5/14 1976
Plugging completed 5/14 1976
Reason for abandonment of well or producing formation Dry Hole

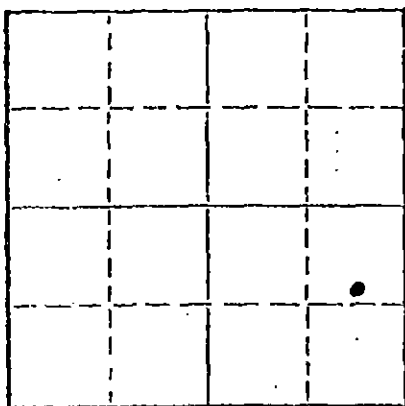

Locate well correctly on above
Section Plat

If a producing well is abandoned, date of last production 19
Was permission obtained from the Conservation Division or its agents before plugging was commenced? Yes

Name of Conservation Agent who supervised plugging of this well Clarence Thomas
Producing formation _____ Depth to top _____ Bottom _____ Total Depth of Well 3115 Feet
Show depth and thickness of all water, oil and gas formations.

OIL, GAS OR WATER RECORDS

CASING RECORD

| FORMATION | CONTENT | FROM | TO | SIZE | PUT IN | PULLED OUT |
|-----------|---------|------|----|------|--------|------------|
| | | | | | | |
| | | | | | | |
| | | | | | | |
| | | | | | | |
| | | | | | | |
| | | | | | | |
| | | | | | | |
| | | | | | | |
| | | | | | | |

Describe in detail the manner in which the well was plugged, indicating where the mud fluid was placed and the method or methods used in introducing it into the hole. If cement or other plugs were used, state the character of same and depth placed, from _____ feet to _____ feet for each plug set.

Mixed 75 sxs. cmt. pmpd. plug to 800', sqd. hole in 5-1/2" csg. @ 1350'-1200#.

RECEIVED
STATE CORPORATION COMMISSION
MAY 23 1976
5-23-76
CONSERVATION DIVISION
WICHITA, KANSAS

(If additional description is necessary, use BACK of this sheet)

Name of Plugging Contractor Sargents Casing Pulling Service
Address 620 S. Lincoln, Liberal, Kansas 67901

STATE OF Kansas COUNTY OF Seward, ss.

Stanley R. Shoemaker (employee of owner) or (owner or operator) of the above-described well, being first duly sworn on oath, says: That I have knowledge of the facts, statements, and matters herein contained and the log of the above-described well as filed and that the same are true and correct. So help me God.

(Signature) Stanley R. Shoemaker

P. O. Box 351, Liberal, Kansas 67901
(Address)

SUBSCRIBED AND SWORN TO before me this 20th day of May 1976

NORMA JEAN TUCKER
NOTARY PUBLIC
Seward County, Kansas
My Commission Expires
September 9, 1976

Norma Jean Tucker
Notary Public.

My commission expires _____

15-189-20263-0000

KANSAS DRILLERS LOG

S. 29 T. 34S R. 38 E
 W
 Loc. 1390' FSL& 660' FEL
 County Stevens

API No. 15 — 189 — 20,263
 County Number

Operator
 ANADARKO PRODUCTION COMPANY
 Address
 P. O. Box 351, Liberal, Kansas 679051

Well No. 1 Lease Name MORRIS "A"

Footage Location
 1390 feet from (N) (S) line 660 feet from (E) (W) line

Principal Contractor Gabbert-Jones, Inc Geologist None
 Spud Date 11/22/74 Total Depth 3115' P.B.T.D.
 Date Completed 1/20/75 P&A 5/14/76 Oil Purchaser

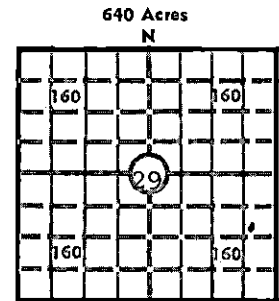

Locate well correctly
 Elev.: Gr. 3264.96
 DF _____ KB _____

CASING RECORD

Report of all strings set— surface, intermediate, production, etc.

| Purpose of string | Size hole drilled | Size casing set (in O.D.) | Weight lbs/ft. | Setting depth | Type cement | Sacks | Type and percent additives |
|-------------------|-------------------|---------------------------|----------------|---------------|------------------|------------|---|
| Surface | 15" | 10-3/4" | 30# | 582' | Common | 550 | 3% CaCl |
| Production | 7-7/8" | 5-1/2" | 14# | 3115' | Lite Wate Pozmix | 500 150 | 12-1/2# Gilsonite 18% Salt. 5% CFR-2 |
| | | | | | | | |
| | | | | | | | |

LINER RECORD

PERFORATION RECORD

| Top, ft. | Bottom, ft. | Sacks cement | Shots per ft. | Size & type | Depth interval |
|----------|-------------|--------------|---------------|-------------|----------------|
| | | | 3 | C.G "A" | 3012-64 OA |

| Size | Setting depth | Packer set at |
|------|---------------|---------------|
| | | |

ACID, FRACTURE, SHOT, CEMENT SQUEEZE RECORD

| Amount and kind of material used | Depth interval treated |
|---|------------------------|
| A/3000 gals 15% HCL + 125 BS, frac w/80,000 gals wtr + 80,000 | 3012-64 OA |
| riversand + 3# per 1,000 gal FR-16 + 1 gal/100 bbl-BE-1 | |

RECEIVED
 CORPORATION COMMISSION
 AUG 31 1976

INITIAL PRODUCTION

CONSERVATION DIVISION
 Wichita, Kansas

| | | | | |
|--|---|---------|------------------------|--------------------|
| Date of first production | Producing method (flowing, pumping, gas lift, etc.) | | | |
| RATE OF PRODUCTION PER 24 HOURS | Oil bbls. | Gas MCF | Water bbls. | Gas-oil ratio CFPB |
| Disposition of gas (vented, used on lease or sold) | | | Producing interval (s) | |

INSTRUCTIONS: As provided in KCC Rule 82-2-125, within 90 days after completion of a well, one completed copy of this Drillers Log shall be transmitted to the State Geological Survey of Kansas, 4150 Monroe Street, Wichita, Kansas 67209. Copies of this form are available from the Conservation Division, State Corporation Commission, 3830 So. Meridian (P.O. Box 17027), Wichita, Kansas 66217. Phone AC 316-522-2206. If confidential custody is desired, please note Rule 82-2-125. Drillers Logs will be on open file in the Oil and Gas Division, State Geological Survey of Kansas, Lawrence, Kansas 66044.

Operator ANADARKO PRODUCTION COMPANY DESIGNATE TYPE OF COMP.: OIL, GAS, DRY HOLE, SWDW, ETC.: Dry Hole

Well No. 1 Lease Name MORRIS "A"

S 29 T 34 S R 38 E W

WELL LOG

Show all important zones of porosity and contents thereof; cored intervals, and all drill-stem tests, including depth interval tested, cushion used, time tool open, flowing and shut-in pressures, and recoveries.

SHOW GEOLOGICAL MARKERS, LOGS RUN, OR OTHER DESCRIPTIVE INFORMATION.

| FORMATION DESCRIPTION, CONTENTS, ETC. | TOP | BOTTOM | NAME | DEPTH |
|---------------------------------------|-------|--------|------|-------|
| Clay-Sand | 0' | 530' | | |
| Redbed | 530' | 1100' | | |
| Redbed-Sand-Shale | 1100' | 1550' | | |
| Sand-Shale | 1550' | 1588' | | |
| Shale-Snhy | 1588' | 1814' | | |
| Shale-Lime | 1814' | 2264' | | |
| Lime-Shale | 2264' | 3090' | | |
| Lime | 3090' | 3115' | | |
| T.D. | | 3115' | | |

USE ADDITIONAL SHEETS, IF NECESSARY, TO COMPLETE WELL RECORD.

Date Received _____
 Signature Stanley R. Shoemaker
 Title Stanley R. Shoemaker, Division Office Manager
 Date August 25, 1976