

ORIGINAL 5

1/18/91
RELEASED

SIDE ONE

MAR 0 4 1991

STATE CORPORATION COMMISSION OF KANSAS
OIL & GAS CONSERVATION DIVISION
WELL COMPLETION FORM
ACO-1 WELL HISTORY
DESCRIPTION OF WELL AND LEASE

Operator: License # 5447
Name: OXY USA Inc.
Address P. O. Box 26100
Oklahoma City, OK 73126-0100
City/State/Zip _____
Purchaser: Permian & PEPL
Operator Contact Person: Raymond Hui
Phone (405) 749-2471
Contractor: Name: Zenith Drilling Company
License: _____
Wellsite Geologist: Andy Howell

Designate Type of Completion
 New Well Re-Entry Workover
 Oil SWD Temp. Abd.
 Gas Inj Delayed Comp.
 Dry Other (Core, Water Supply, etc.)

If **OWMO**: old well info as follows:
Operator: _____
Well Name: _____
Comp. Date _____ Old Total Depth _____
Drilling Method: Mud Rotary Air Rotary Cable
11-20-1989 12-01-1989 1-16-1990
Spud Date Date Reached TD Completion Date

API NO. 15- 129-21031-0000
County Morton FROM CONFIDENTIAL
C NE SE/4 Sec. 4 Twp. 32S Rge. 39 East West
1980 Ft. North from Southeast Corner of Section
660 Ft. West from Southeast Corner of Section
(NOTE: Locate well in section plat below.)
Lease Name Israel B Well # 5
Field Name East Kinsler
Producing Formation Morrow L-1
Elevation: Ground 3233' KB 3244'
Total Depth 5990' PBD 5879'

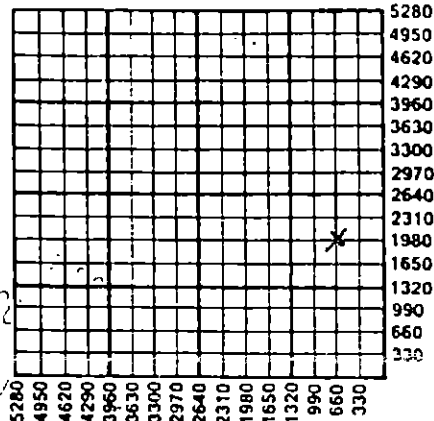

Amount of Surface Pipe Set and Cemented at 1720' Feet
Multiple Stage Cementing Collar Used? Yes No
If yes, show depth set DV Tool at 3108' Feet
If Alternate II completion, cement circulated from _____
feet depth to _____ w/ _____ sx cmt.

INSTRUCTIONS: This form shall be completed in triplicate and filed with the Kansas Corporation Commission, 200 Colorado Derby Building, Wichita, Kansas 67202, within 120 days of the spud date of any well. Rule 82-3-130, 82-3-107 and 82-3-106 apply. Information on side two of this form will be held confidential for a period of 12 months if requested in writing and submitted with the form. See rule 82-3-107 for confidentiality in excess of 12 months. One copy of all wireline logs and drillers time log shall be attached with this form. ALL CEMENTING TICKETS MUST BE ATTACHED. Submit CP-4 form with all plugged wells. Submit CP-111 form with all temporarily abandoned wells. Any recompletion, workover or conversion of a well requires filing of ACO-2 within 120 days from commencement date of such work.

All requirements of the statutes, rules and regulations promulgated to regulate the oil and gas industry have been fully complied with and the statements herein are complete and correct to the best of my knowledge.

Signature Bryan Humphries
Title Manager Engineering Date 1-16-1990
Subscribed and sworn to before me this 15th day of January,
19 90.
Notary Public Nancy C. Hauer
Date Commission Expires 8-8-91

K.C.C. OFFICE USE ONLY
 Letter of Confidentiality Attached
 Wireline Log Received
 Drillers Timelog Received
Distribution
 KCC SWD/Rep NGPA
 KGS Plug Other
(Specify)

SIDE TWO

Operator Name OXY USA, Inc. Lease Name Israel B Well # 5
 Sec. 4 Twp. 32S Rge. 39 East West
 County Morton

INSTRUCTIONS: Show important tops and base of formations penetrated. Detail all cores. Report all drill stem tests giving interval tested, time tool open and closed, flowing and shut-in pressures, whether shut-in pressure reached static level, hydrostatic pressures, bottom hole temperature, fluid recovery, and flow rates if gas to surface during test. Attach extra sheet if more space is needed. Attach copy of log. **RELEASED**

Drill Stem Tests Taken Yes No
 (Attach Additional Sheets.)
 Samples Sent to Geological Survey Yes No
 Cores Taken Yes No
 Electric Log Run Yes No
 (Submit Copy.)
 Ran Dual Spaced Neutron Spectral Density,
 Micro. & Dual Induction Log w/GR & Caliper;
 Dipmeter log from 5980-4980. Ran CBL &
 CET w/GR & CCL.

Formation Description: 110 0 4 1901

Log Sample

CONFIDENTIAL

Name	Top	Bottom
Red Bed	0	750
Anhydrite	750	2100
Anhydrite & Dol.	2100	3125
Lm & Shale	3125	5990
PBTD		5879
T D		5990

CASING RECORD <input checked="" type="checkbox"/> New <input type="checkbox"/> Used							
Report all strings set-conductor, surface, intermediate, production, etc.							
Purpose of string	Size Hole Drilled	Size Casing Set (In O.D.)	Weight Lbs./Ft.	Setting Depth	Type of Cement	# Sacks Used	Type and Percent Additives
Conductor pipe	32"	22"	---	43.6"	Redi-mix	3.5 yds	---
Surface	12 1/4"	8 5/8"	24#	1720'	C1, C	665 sx	2% CaCl & 1/2 #/sx
Production	7 7/8"	5 1/2"	14#	5988'	*Please refer to log listed below.		
PERFORATION RECORD				Acid, Fracture, Shot, Cement Squeeze Record			
Shots Per Foot	Specify Footage of Each Interval Perforated			(Amount and Kind of Material Used) Depth			
4	5509-5513' (4'; 17 holes)			Not acidized.			
TUBING RECORD							
Size <u>2 3/8"</u>		Set At <u>5430'</u>		Packer At		Liner Run <input type="checkbox"/> Yes <input checked="" type="checkbox"/> No	
Date of First Production		Producing Method <input checked="" type="checkbox"/> Flowing <input type="checkbox"/> Pumping <input type="checkbox"/> Gas Lift <input type="checkbox"/> Other (Explain)					
12-17-1989							
Estimated Production Per 24 Hours		Oil Bbls.	Gas Mcf.	Water Bbls.	Gas-Oil Ratio		Gravity
		85	245	2			

Disposition of Gas: Vented Sold Used on Lease (If vented, submit ACO-18.)

METHOD OF COMPLETION: Open Hole Perforation Dually Completed Commingled Other (Specify) _____

Production Interval: 5509-5513

*Production Casing Record: pumped 1st stage w/300 sx 65/35 C1. H. poz. containing 6% gel, 1/4 #/sx cello; tailed in w/240 sx 50/50 C1. H poz. containing 2% gel. Pumped 2nd stage w/430 sx 65/35 C1. C poz. containing 6% gel; 1/4 #/sx Cello.

53

ORIGINAL

RELEASED

MAR 0 4 1991

Isreal B #5
Sec. 4-32S-39W

FROM CONFIDENTIAL

15-129-21,031

Formation	Top	Bottom
BCA	1728	
Winfield	2480	
Council Grove	2798	
Heebner	3907	
Lansing	4020	
Marmaton	4691	
Morrow Shale	5460	
Mrow sd.	5496	5516
Mrow sd.	5840	5872
Chester	5930	

RECEIVED
STATE COPYRIGHT COMMISSION

FEB 28 1991

U.S. Copyright Office
Washington, D.C. 20540

PLAT AND CERTIFICATION OF ACREAGE ATTRIBUTABLE TO AN OIL WELL

State Corporation Commission, Conservation Division
200 Colorado Derby Bldg. Wichita, Kansas 67202

OPERATOR OXY USA Inc.
LEASE NAME Israel B
WELL NUMBER _____
FIELD East Kinsler
NUMBER OF ACRES ATTRIBUTED TO WELL 40

LOCATION OF WELL:
1980 feet north of SE corner
660 feet west of SE corner
SE 1/4 Sec. 4 T. 32S R. 39W
COUNTY Morton

PLAT
(Show location of well and shade attributable acreage)
(Show footage to nearest lease or unit boundary line)

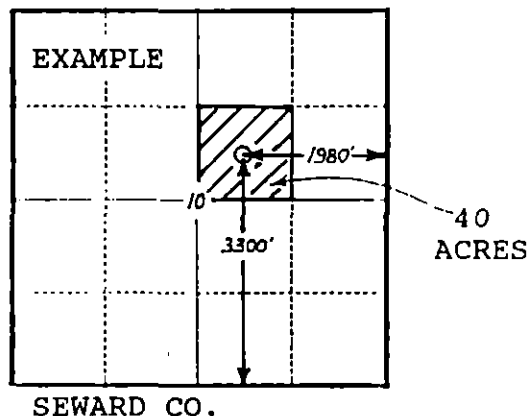
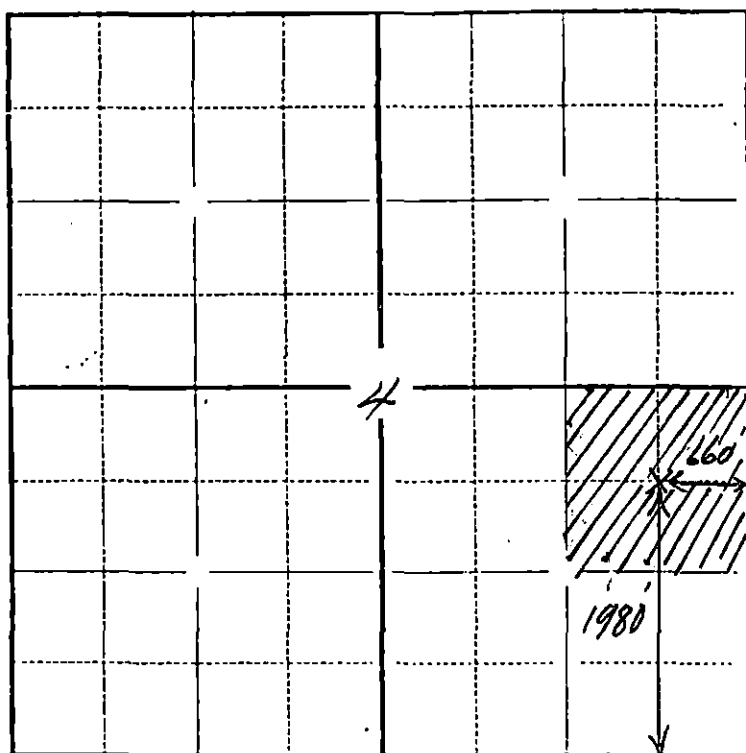

The undersigned hereby certifies that he is Raymond Hui
for OXY USA Inc. (Co.), a duly authorized agent, that all
information shown hereon is true and correct to the best of his knowledge and
belief, and that all acreage claimed as attributable to the well named herein
is held by production from that well.

Subscribed and sworn to before me on this 17 day of November 1989

My Commission expires 3/24/90

Raymond Hui
Deborah Jay Matthews
Notary Public

(6-1989)

RECEIVED
STATE CORPORATION COMMISSION

DEC 21 1989

CONSERVATION DIVISION
Wichita, Kansas