

STATE CORPORATION COMMISSION OF KANSAS
OIL & GAS CONSERVATION DIVISION
WELL COMPLETION OR RECOMPLETION FORM
ACO-1 WELL HISTORY
DESCRIPTION OF WELL AND LEASE

API NO. 15-.....129-20930-0000

County.....Morton
NW/4 NW/4 SW/4 Sec.....4 Twp.....32S Rge.....39 East
.....X West

Operator: License #5447
Name.....OXY USA Inc
Address.....P.O. Box 26100
.....Oklahoma City, OK 73126-0100
City/State/Zip

2310
4950 Ft North from Southeast Corner of Section
..... Ft West from Southeast Corner of Section
(Note: Locate well in section plat below)

Purchaser.....Permian & PEPL

Lease Name.....Israel B Well #.....2

Operator Contact Person.....Raymond Hui
Phone.....(405) 949-4268

Field Name.....East Kinsler

Producing Formation.....Upper Morrow

Contractor: License #
Name.....H-30 Drilling Company

Elevation: Ground.....3253'3264' KB.....

Wellsite Geologist.....Andrew Howell
Phone.....(405) 749-2000

Designate Type of Completion
 New Well Re-Entry Workover
 Oil Well SWD Temp Abd
 Gas Inj Delayed Comp
 Dry Other (Core, Water Supply etc.)

RECEIVED
STATE CORPORATION COMMISSION
NOV 2 1988
CONSERVATION DIVISION
Wichita, Kansas

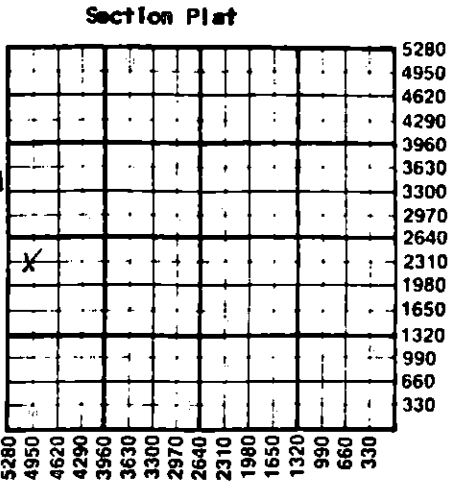

If OWNED: old well info as follows:
Operator,
Well Name,
Comp. Date, Old Total Depth.....

WATER SUPPLY INFORMATION

Disposition of Produced Water: Disposal
Docket # Repressuring

WELL HISTORY

Drilling Method:
 Mud Rotary Air Rotary Cable
9-7-1988 9-18-1988 10-13-1988
.....
Spud Date Date Reached TD Completion Date
6050' 5999'
.....
Total Depth PBDT

Questions on this portion of the ACO-1 call:
Water Resources Board (913) 296-3717
Source of Water: Purchased
Division of Water Resources Permit #.....
 Groundwater.....Ft North from Southeast Corner
(Well)Ft West from Southeast Corner of
Sec Twp Rge East West
 Surface Water.....Ft North from Southeast Corner
(Stream, pond etc).....Ft West from Southeast Corner
Sec Twp Rge East West
 Other (explain).....
(purchased from city, R.W.D. #)

Amount of Surface Pipe Set and Cemented at 1732' feet
Multiple Stage Cementing Collar Used? Yes No
If yes, show depth set DV Tool at 3114' feet
If alternate 2 completion, cement circulated
from.....feet depth to.....w/.....SX cmt
Cement Company Name,
Invoice #

INSTRUCTIONS: This form shall be completed in triplicate and filed with the Kansas Corporation Commission, 200 Colorado Derby Building, Wichita, Kansas 67202, within 120 days of the spud date of any well. Rule 82-3-130, 82-3-107 and 82-3-106 apply.
Information on side two of this form will be held confidential for a period of 12 months if requested in writing and submitted with the form. See rule 82-3-107 for confidentiality in excess of 12 months.
One copy of all wireline logs and drillers time log shall be attached with this form. Submit CP-4 form with all plugged wells. Submit CP-111 form with all temporarily abandoned wells.

All requirements of the statutes, rules and regulations promulgated to regulate the oil and gas industry have been fully complied with and the statements herein are complete and correct to the best of my knowledge.

Signature.....Bryan Humphries.....

Title.....Engineering Manager..... Date 10-22-1988

Subscribed and sworn to before me this 22nd day of October 1988
Notary Public.....Marsha B. Wilson.....

Date Commission Expires.....4-1-92

K.C.C. OFFICE USE ONLY
F Letter of Confidentiality Attached
C Wireline Log Received
C Drillers Time Log Received
Distribution
 KCC SWD/Rep NGPA
 KGS Plug Other
(Specify)
11-2-88

Sec. 4
Twp. 32S
Rge. 39E
Page 3712

Operator Name OXY USA Inc Lease Name Israel B Well # 2

Sec 4 Twp 32S Rge 39 East West County Morton

WELL LOG

INSTRUCTIONS: Show important tops and base of formations penetrated. Detail all cores. Report all drill stem tests giving interval tested, time tool open and closed, flowing and shut-in pressures, whether shut-in pressure reached static level, hydrostatic pressures, bottom hole temperature, fluid recovery, and flow rates if gas to surface during test. Attach extra sheet if more space is needed. Attach copy of log.

Drill Stem Tests Taken Yes No
 Samples Sent to Geological Survey Yes No
 Cores Taken Yes No

Formation Description
 Log Sample

* Production Casing Information:

Cmt'd 1st stage w/500 gal mud flush followed by 330 sx 65/35 Cl H Poz. containing 6% total gel & 1/4#/sx Flo., followed by 250 sx 50/50 Cl H Poz. containing 2% total gel, 12% salt, 1/2% HALAD-9. Cmt'd 2nd stage w/500 gal mud flush, followed by 230 sx 65/35 Cl C Poz. containing 6% total gel & 1/4# sx Flo. Tailed in w/470 sx 50/50 Cl C Poz. containing 2% total gel, 5#/sx Cal-Seal, 0.4% HALAD-4, 2% CaCl & 1/4#/sx Flo.

Name	Top	Bottom
Sand	0	900
Anhy.	900	1733
Lime & Shale	1733	4575
Lime	4575	5075
Shale	5075	6050
PBTD		6000
TD		6050

Ran BHC Sonic w/GR & Caliper log from 1715' to surface. Ran Compensated Vel. Log, Spectral Density/Dual Spaced Neutron II log, Micro., Dual Ind. Short Guard Log & Dual Dipmeter log.

Core 26' of sand 34' of shale.

CASING RECORD <input checked="" type="checkbox"/> New <input type="checkbox"/> Used							
Report all strings set-conductor, surface, intermediate, production, etc.							
Purpose of String	Size Hole Drilled	Size Casing Set (in O.D.)	Weight Lbs/Ft.	Setting Depth	Type of Cement	#Sacks Used	Type and Percent Additives
Surface	12-1/4"	8-5/8"	24#	1732'	Cl C	675	6% total gel 2% CaCl ₂
Production	7-7/8"	5-1/2"	15.5# & 14#	6049'	* (Please refer to Prod. csq. info. above.)		
PERFORATION RECORD				Acid, Fracture, Shot, Cement Squeeze Record (Amount and Kind of Material Used)			
Shots Per Foot	Specify Footage of Each Interval Perforated			Depth			
4	Morrow 5514-18'			2000 gal containing LO-Surf-0			
TUBING RECORD				Liner Run <input type="checkbox"/> Yes <input checked="" type="checkbox"/> No			
Date of First Production		Producing Method					
10-14-1988		<input checked="" type="checkbox"/> Flowing <input type="checkbox"/> Pumping <input type="checkbox"/> Gas Lift <input type="checkbox"/> Other (explain).....					
Estimated Production Per 24 Hours		Oil	Gas	Water	Gas-Oil Ratio	Gravity	
➔		245 Bbls	380 MCFPD MCF	Trace Bbls	CFPB		

METHOD OF COMPLETION

Production Interval

Disposition of gas: Vented Open Hole Perforation
 Sold Other (Specify) 5514-5518'
 Used on Lease Dually Completed
 Commingled