

STATE OF KANSAS  
STATE CORPORATION COMMISSION

WELL PLUGGING RECORD

Give All Information Completely  
Make Required Affidavit  
Mail or Deliver Report to  
Conservation Division  
State Corporation Comm.  
245 North Water  
Wichita, KS 67202

Sedgwick County. Sec.31 Twp. 29S Rge. 2W E/W  
Location as "NE/CNW $\frac{1}{4}$ SW $\frac{1}{4}$ " or footage from lines \_\_\_\_\_

Lease Owner Edwards Oil Co., Inc.  
Lease Name Wittorff Well No. 1

Office Address P. O. Box 192, Rose Hill, KS 67133  
Character of Well (Completed as Oil, Gas or Dry Hole) \_\_\_\_\_

Dry Hole

Date Well completed 4-28- 1980  
Application for plugging filed 4-28- 1980  
Application for plugging approved 4-28- 1980  
Plugging commenced 4-28- 1980  
Plugging completed 4-28- 1980

Reason for abandonment of well or producing formation \_\_\_\_\_  
Dry Hole

If a producing well is abandoned, date of last production \_\_\_\_\_  
19 \_\_\_\_\_

Was permission obtained from the Conservation Division or its agents before plugging was commenced? yes

Name of Conservation Agent who supervised plugging of this well Carl Barnett  
Producing formation \_\_\_\_\_ Depth to top \_\_\_\_\_ Bottom \_\_\_\_\_ Total Depth of Well 4080'

Show depth and thickness of all water, oil and gas formations.

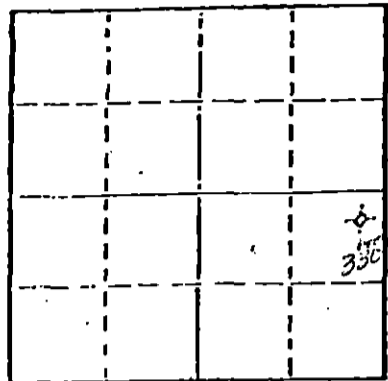

Locate well correctly on above Section Plat

OIL, GAS OR WATER RECORDS

CASING RECORD

FORMATION	CONTENT	FROM	TO	SIZE	PUT IN	PULLED OUT
				8 5/8"	298'	in place

Describe in detail the manner in which the well was plugged, indicating where the mud fluid was placed and the method or methods used in introducing it into the hold. If cement or other plugs were used, state the character of same and depth placed, from \_\_\_\_\_ feet to \_\_\_\_\_ feet for each plug set.

Plug #1 set @ 310' cemented with 35SX  
Plug #2 Set @ 40' cemented with 10SX  
Rathole cemented with 3 SX

(If additional description is necessary, use BACK of this sheet)

Name of Plugging Contractor Aspen Oil, Inc. Exploration

STATE OF Kansas COUNTY OF Sedgwick, ss.  
Kathy L. Sink (employee of owner) ~~XXXXXXXXXXXXXXXXXXXX~~

of the above-described well, being first duly sworn on oath, says: That I have knowledge of the facts, statements, and matters herein contained and the log of the above-described well as filed and that the same are true and correct. So help me God.

(Signature) Kathy L. Sink  
7701 E. Kellogg, Wichita, KS 67207  
(Address)



SUBSCRIBED AND SWORN TO before me this 2nd day of May, 1980

Rebbie A. Hoebel  
Notary Public.

My commission expires November 26, 1983

RECEIVED  
STATE CORPORATION COMMISSION  
MAY 16 1980  
CONSERVATION DIVISION  
Wichita, Kansas

15-173-20267-0000

KANSAS

**WELL COMPLETION REPORT AND DRILLER'S LOG**

S. 31 T. 29S R. 2W <sup>E</sup>/<sub>W</sub>

Loc. NE 1/4 SW

County Sedgwick

API No. 15 — Sedgwick —           
County Number

Operator  
Edwards Oil Co., Inc.

Address  
P. O. Box 192 Rose Hill, KS 67133

Well No. 1 Lease Name Wittorff

Footage Location 660' From North 330' From East  
feet from (N) (S) line feet from (E) (W) line

Principal Contractor Aspen Oil, Inc. Exploration Geologist         

Spud Date 4-19-80 Date Completed 4-28-80 Total Depth 4080' P.B.T.D.         

Directional Deviation          Oil and/or Gas Purchaser         

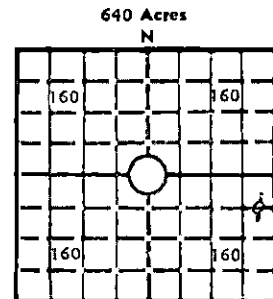

Locate well correctly

Elev.: Gr. 1291

DF          KB         

**CASING RECORD**

Report of all strings set — surface, intermediate, production, etc.

Purpose of string	Size hole drilled	Size casing set (in O.D.)	Weight lbs/ft.	Setting depth	Type cement	Sacks	Type and percent additives
Surface	12 1/4"	8 5/8"		298'	Common		
Production	7 7/8"	Plugged Hole					

**LINER RECORD**

**PERFORATION RECORD**

Top, ft.	Bottom, ft.	Sacks cement	Shots per ft.	Size & type	Depth interval

**TUBING RECORD**

Size	Setting depth	Packer set at

**ACID, FRACTURE, SHOT, CEMENT SQUEEZE RECORD**

Amount and kind of material used	Depth interval treated

**INITIAL PRODUCTION**

Date of first production          Producing method (flowing, pumping, gas lift, etc.)         

RATE OF PRODUCTION PER 24 HOURS  
Oil          Gas          Water           
bbls. MCF CFPB

Disposition of gas (vented, used on lease or sold)          Producing interval (s)         

RECEIVED  
STATE CORPORATION COMMISSION  
MAY 16 1980  
CONSERVATION DIVISION  
Wichita, Kansas

INSTRUCTIONS: As provided in KCC Rule 82-2-125, within 90 days after completion of a well, one completed copy of this Drillers Log shall be transmitted to the State Geological Survey of Kansas, 4150 Monroe Street, Wichita, Kansas 67209. Copies of this form are available from the Conservation Division, State Corporation Commission, 245 No. Water, Wichita, Kansas 67202. Phone AC 316-522-2206. If confidential custody is desired, please note Rule 82-2-125. Drillers Logs will be on open file in the Oil and Gas Division, State Geological Survey of Kansas, Lawrence, Kansas 66044.

Operator  
Edwards Oil Co., Inc.

DESIGNATE TYPE OF COMP.: OIL, GAS, DRY HOLE, SWDW, ETC.:

Well No. 1 Lease Name Wittorff Dry Hole

S 31 T 29S R 2W<sup>E</sup><sub>W</sub>

**WELL LOG**

Show all important zones of porosity and contents thereof; cored intervals, and all drill-stem tests, including depth interval tested, cushion used, time tool open, flowing and shut-in pressures, and recoveries.

SHOW GEOLOGICAL MARKERS, LOGS RUN, OR OTHER DESCRIPTIVE INFORMATION.

FORMATION DESCRIPTION, CONTENTS, ETC.	TOP	BOTTOM	NAME	DEPTH
Sand / Shale	0	620		
Shale / Lime	620	1878		
Lime / Shale	1878	2745		
Stalnaker	2745	2856		
Shale / Lime	2856	3120		
Kansas City Lime	3120	3165		
Lime / Shale	3165	3638		
Mississippi	3638	4056		
Shale / Lime	4056	4080	T. D.	

USE ADDITIONAL SHEETS, IF NECESSARY, TO COMPLETE WELL RECORD.

Date Received	Signature
	Title
	Date