

STATE CORPORATION COMMISSION OF KANSAS  
OIL & GAS CONSERVATION DIVISION  
WELL COMPLETION OR RECOMPLETION FORM  
ACO-1 WELL HISTORY  
DESCRIPTION OF WELL AND LEASE

API No. 15-... 189-21 283 - 0000  
County... Stevens  
C NW NW Sec 24 Twp 31S Rge 35W East  
..... X West

Operator: License # 5003  
Name McCoy Petroleum Corporation  
Address 110 S. Main, Suite 500  
City/State/Zip Wichita, Kansas

4620 Ft North from Southeast Corner of Section  
4620 Ft West from Southeast Corner of Section  
(Note: Locate well in section plat below)

Purchaser Koch Oil Company  
Wichita, Kansas

Lease Name Lahey "A" Well # 1-24

Operator Contact Person John Roger McCoy  
Phone (316) 265-9697

Field Name Wildcat Lahey

Contractor: License # 5658  
Name Sweetman Drilling, Inc.

Producing Formation Chester Sand

Wellsite Geologist John Hastings  
Phone (316) 265-9697

Elevation: Ground 2951 KB 2961

Designate Type of Completion  
X New Well Re-Entry Workover  
X Oil SWD Temp Abd  
Gas Inj Delayed Comp.  
Dry Other (Core, Water Supply etc.)

RECEIVED  
STATE CORPORATION COMMISSION  
JAN 27 1989  
CONSERVATION DIVISION  
Wichita, Kansas

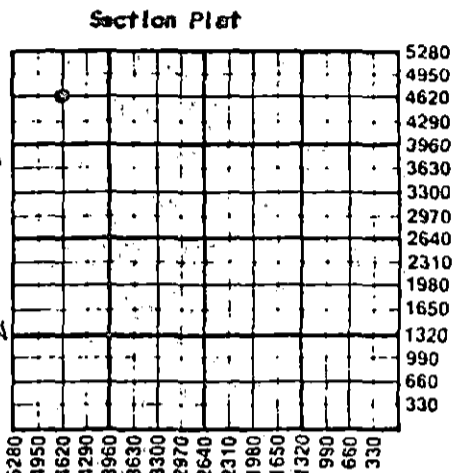

If ONWD: old well info as follows:  
Operator  
Well Name  
Comp. Date Old Total Depth

WATER SUPPLY INFORMATION

Disposition of Produced Water: Disposal  
Docket # Repressuring  
No Water

WELL HISTORY  
Drilling Method: X Mud Rotary Air Rotary Cable  
11-29-88 12-13-88 1-13-89  
Spud Date Date Reached TD Completion Date  
5850' 5800'  
Total Depth PBTD

Questions on this portion of the ACO-1 call:  
Water Resources Board (913) 296-3717

Source of Water:  
Division of Water Resources Permit #

Amount of Surface Pipe Set and Cemented at 1761' feet  
Multiple Stage Cementing Collar Used? X Yes No  
If yes, show depth set 4835, 71' & 3271' feet  
If alternate 2 completion, cement circulated from...feet depth to...w/...SX cmt  
Cement Company Name  
Invoice #

Groundwater...Ft North from Southeast Corner (Well) ...Ft West from Southeast Corner of Sec Twp Rge East West

Surface Water...Ft North from Southeast Corner (Stream, pond etc)...Ft West from Southeast Corner Sec Twp Rge East West

X Other (explain)... Purchased from Land Owner (purchased from city, R.W.D. #)

INSTRUCTIONS: This form shall be completed in triplicate and filed with the Kansas Corporation Commission, 200 Colorado Derby Building, Wichita, Kansas 67202, within 120 days of the spud date of any well. Rule 82-3-130, 82-3-107 and 82-3-106 apply. Information on side two of this form will be held confidential for a period of 12 months if requested in writing and submitted with the form. See rule 82-3-107 for confidentiality in excess of 12 months. One copy of all wireline logs and drillers time log shall be attached with this form. Submit CP-4 form with all plugged wells. Submit CP-111 form with all temporarily abandoned wells.

All requirements of the statutes, rules and regulations promulgated to regulate the oil and gas industry have been fully complied with and the statements herein are complete and correct to the best of my knowledge.

Signature John R. McCoy  
Title President Date 1-26-89

K.C.C. OFFICE USE ONLY  
Letter of Confidentiality Attached  
Wireline Log Received  
Drillers Time Log Received  
Distribution  
KCC SWD/Rep NGPA  
KGS Plug Other (Specify)  
1-27-89  
Form ACO-1 (5-86)

Subscribed and sworn to before me this 26th day of January, 1989...  
Notary Public Deborah Ann Paulus

Date Commission Expires January 8, 1992

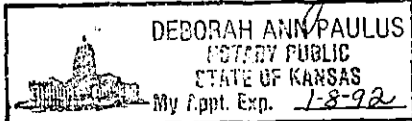

Sec 24 Twp 31 Rge 35W

SIDE TWO

Operator Name McCoy Petroleum Corporation Lease Name Lahey "A" Well # 1-24

Sec. 24 Twp. 31 Rge. 35  East  West County Stevens

RELEASED

MAR 0 7 1990

WELL LOG

FROM CONFIDENTIAL

INSTRUCTIONS: Show important tops and base of formations penetrated. Detail all cores. Report all drill stem tests giving interval tested, time tool open and closed, flowing and shut-in pressures, whether shut-in pressure reached static level, hydrostatic pressures, bottom hole temperature, fluid recovery, and flow rates if gas to surface during test. Attach extra sheet if more space is needed. Attach copy of log.

Drill Stem Tests Taken  Yes  No  
 Samples Sent to Geological Survey  Yes  No  
 Cores Taken  Yes  No

Formation Description  
 Log  Sample

DST #1 4393 - 4410 (Iola)  
 Open 30", S.I. 45", Open 30", S.I. 60"  
 No blow. Apparently surface manifold or flow line was plugged or was leaking.  
 Recovered 307' of total fluid as follows:  
 215' of gassy oil cut mud,  
 (5% gas, 20% oil, 75% mud),  
 92' of gassy slightly oil cut muddy water,  
 (5% gas, 5% oil, 35% mud, 55% water, 26,000 ppm chlorides).  
 FP 30-95# 95-127#  
 ISIP 1200# FSIP 1190#

Name	Top	Bottom
ELECTRIC LOG TOPS		
Winfield	2654 (+ 307)	
Council Grove	2872 (- 93)	
Wabaunsee	3252 (- 291)	
Heebner	4035 (-1074)	
Lansing "A"	4148 (-1187)	
Iola	4394 (-1433)	
Dennis Porosity	4628 (-1667)	
Stark Shale	4644 (-1683)	
Swope Porosity	4667 (-1706)	
Marmaton	4792 (-1831)	
Pawnee	4923 (-1962)	
Cherokee	4982 (-2021)	
Atoka	5258 (-2297)	
Morrow Shale	5330 (-2369)	
Chester	5478 (-2517)	
Chester Sand	5512 (-2551)	
St. Genevieve	5596 (-2635)	
St. Louis	5653 (-2692)	
"B" Zone Porosity	5677 (-2716)	
"C" Zone Porosity	5742 (-2781)	
Spergen	5796 (-2835)	
Log Total Depth	5853 (-2892)	

DST #2 4624 - 4641' (Dennis)  
 Open 30", S.I. 45", Open 60", S.I. 60".  
 Strong blow throughout test.  
 Gas to the surface in 30 minutes on 2nd open, TSTM.  
 Recovered 465' of total fluid as follows:  
 125' of clean gassy oil,  
 250' of gassy frothy oil cut mud,  
 90' of gassy slightly watery oil cut mud  
 FP 63-95# 106-148#  
 ISIP 1242# FSIP 1169#

CASING RECORD <input checked="" type="checkbox"/> New <input type="checkbox"/> Used							
Report all strings set-conductor, surface, intermediate, production, etc.							
Purpose of String	Size Hole Drilled	Size Casing Set (In O.D.)	Weight Lbs/Ft.	Setting Depth	Type of Cement	#Sacks Used	Type and Percent Additives
Surface **See Attached Sheet for Production Casing Infor.	12-1/4"	8-5/8"	24#	1761'	Prep Light	125 575	2% cc 2% cc
PERFORATION RECORD				Acid, Fracture, Shot, Cement Squeeze Record			
Shots Per Foot	Specify Footage of Each Interval Perforated			(Amount and Kind of Material Used)		Depth	
2	5525 to 5550'			50,000 gal My-T-GEL II x 80,000# sand		same	
TUBING RECORD				Liner Run <input type="checkbox"/> Yes <input checked="" type="checkbox"/> No			
Date of First Production		Size	Set At	Packer at			
1-13-89		2-7/8"	5730'	5430'			
Date of First Production		Producing Method					
1-13-89		<input type="checkbox"/> Flowing <input type="checkbox"/> Pumping <input checked="" type="checkbox"/> Gas Lift <input type="checkbox"/> Other (explain).....					
Estimated Production Per 24 Hours	Oil	Gas	Water	Gas-Oil Ratio		Gravity	
	342	78	0	228/1		40	
	Bbls	MCF	Bbls	CFPB			

METHOD OF COMPLETION

Production Interval

Disposition of gas:  Vented  Sold  Used on Lease  
 Open Hole  Perforation  Other (Specify) ..... 5525-5550'  
 Dually Completed  Conminged ..... Chester Sand

McCoy Petroleum Corporation  
 #1-24 Lahey "A"  
 C NW NW Section 24-31S-35W  
 Stevens County, Kansas

RELEASED

MAR 0 7 1990

FROM CONFIDENTIAL

DST's continued

DST #3 4659 - 4679' (Swope)  
 Open 30", S.I. 60", Open 60", S.I. 90"  
 Weak blow increasing to fair 7" blow on 1st open,  
 Weak blow increasing to fair 8" blow on 2nd open.  
 Recovered 200' of oil and gas cut mud,  
 (20% gas, 15% oil, 65% mud).  
 FP 63-63# 85-106#  
 ISIP 897# FSIP 981#

DST #7 5794 - 5810' (Spergen)  
 Open 30", S.I. 60", Open 30", S.I. 60".  
 Weak blow on 1st open.  
 Weak blow for 25 minutes on 2nd open.  
 Recovered 30' of very slightly oil cut mud.  
 FP 42-42# 42-42#  
 ISIP 1504# FSIP 1399#

DST #4 5519 - 5580' (Chester Sand)  
 Open 30", S.I. 60", Open 90", S.I. 120"  
 Weak blow building to strong on 1st open period.  
 Strong blow throughout on 2nd open period.  
 Recovered 1485' of gas in pipe,  
 10' of free oil,  
 175' of gassy oil cut mud.  
 FP 53-63# 74-85#  
 ISIP 1451# FSIP 1556#

RECEIVED  
 STATE CORPORATION COMMISSION

JAN 27 1989

CONSERVATION DIVISION  
 Wichita, Kansas

DST #5 5640 - 5700' (St. Louis "B" zone)  
 Open 30", S.I. 60", Open 90", S.I. 90"  
 Weak blow building to 2 inches on 1st open.  
 Weak blow building to 1-1/2 inches on 2nd open.  
 Recovered 10' of free oil (40+ gravity),  
 155' of oil cut mud.  
 FP 42-53# 63-85#  
 ISIP 1566# FSIP 1546#

DST #6 5734 - 5766' (St. Louis "C" zone)  
 Open 30", S.I. 45", Open 60", S.I. 90"  
 Strong blow throughout test.  
 Gas to surface in 25 minutes on 2nd open, TSTM.  
 Recovered 650' of clean gassy oil (40+ gravity),  
 185' of oil cut mud.  
 FP 106-180# 212-287#  
 ISIP 478# FSIP 436#

KANSAS GEOLOGICAL SURVEY  
 WICHITA BRANCH

JAN 30 1989

(Production Casing Info. continued) Purpose of String	Size Hole	Size Casing	Weight	Setting Depth	Type of Cement	Sacks Used	Type & Percent Additives
Production	7-7/8"	5-1/2"	15.5#	5850'	Thix-Set	125	3%KCL, 1/4Flo/sx 5# sx Gilsonite
DV Tool				4835.71'	Thix-Set	125	3%KCL, 1/4Flo/sx 5# sx Gilsonite
FO Tool				3270.89'	Light Premium	80 50	

been fully compiled with and the statements herein are complete and correct.

Signature: *John Roger Moley*  
 Title: *President* Date: *1-26-89*

Subscribed and sworn to before me this *26th* day of *January*, 19*89*...  
 Notary Public: *Deborah Ann Paulus*

Date Commission Expires: *January 8, 1992*

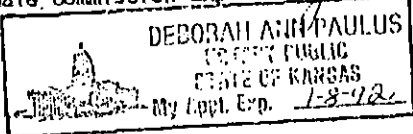

JAN 30 1989  
 KANSAS GEOLOGICAL SURVEY  
 WICHITA BRANCH

K.C.C. OFFICE USE ONLY

Letter of Confidentiality Attached  
 Wireline Log Received  
 Drillers Timelog Received

Distribution

KCC       SWD/Rep       NGPA  
 KGS       Plug       Other  
 (Specify)

Form ACO-1 (5-86)

Sec 24, Twp 31, Rge. 35W