

STATE CORPORATION COMMISSION OF KANSAS
OIL & GAS CONSERVATION DIVISION
WELL COMPLETION OR RECOMPLETION FORM
ACO-1 WELL HISTORY
DESCRIPTION OF WELL AND LEASE

Operator: License # 04824
Name Mesa Operating Limited Partnership
Address P.O. Box 2009
Amarillo, Texas 79189
City/State/Zip

Purchaser NA

Operator Contact Person David Cook
Phone (806) 378-1000

Contractor: License # NA
Name

Wellsite Geologist NA
Phone

Designate Type of Completion
New Well Re-Entry Workover

Oil SWD Temp Abd
Gas Inj Delayed Comp.
Dry Other (Core, Water Supply, etc.)

If OWN: old well info as follows:
Operator Mesa Petroleum Co.
Well Name Moore # 2-29
Comp. Date 5-14-79 Old Total Depth 5275

WELL HISTORY

Drilling Method:
CU Mud Rotary Air Rotary Cable
10-15-86 est NA 10-17-86 est
Spud Date Date Reached TD Completion Date
5275' 5223'
Total Depth PBTD

Amount of Surface Pipe Set and Cemented at 598 feet
Multiple Stage Cementing Collar Used? Yes No
If yes, show depth set feet
If alternate 2 completion, cement circulated from feet depth to w/ SX cmt
Cement Company Name
Invoice #

API NO. 15-025-20,259-00-01

County Clark

NE NW Sec. 29 Twp. 31S. Rge. 21 East
West

4770 Ft North from Southeast Corner of Section
4580 Ft West from Southeast Corner of Section

(Note: Locate well in section plat below)

Lease Name MOORE Well # 2-29

Field Name Lexington Unit

Injection Formation Morrow

Elevation: Ground 2066 KB 2075

Section Plat

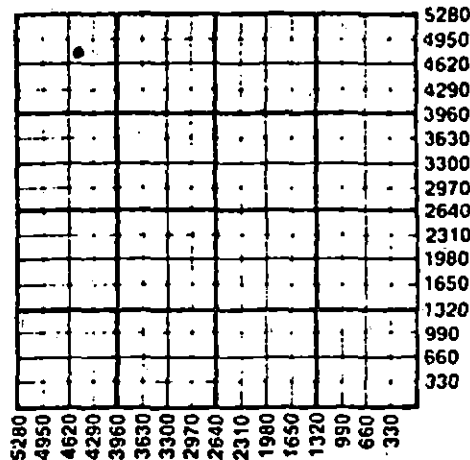

WATER SUPPLY INFORMATION

Disposition of Produced Water: Disposal
Docket # E20779 Repressuring

Questions on this portion of the ACO-1 call:

Water Resources Board (913) 296-3717

Source of Water:
Division of Water Resources Permit #

Groundwater Ft North from Southeast Corner (Well) Ft West from Southeast Corner of Sec Twp Rge East West

Surface Water Ft North from Southeast Corner (Stream, pond etc) Ft West from Southeast Corner Sec Twp Rge East West

X Other (explain) commercial source (purchased from city, R.W.D. #)

INSTRUCTIONS: This form shall be completed in triplicate and filed with the Kansas Corporation Commission, 200 Colorado Derby Building, Wichita, Kansas 67202, within 120 days of the spud date of any well. Rule 82-3-130, 82-3-107 and 82-3-106 apply.

Information on side two of this form will be held confidential for a period of 12 months if requested in writing and submitted with the form. See rule 82-3-107 for confidentiality in excess of 12 months. One copy of all wireline logs and drillers time log shall be attached with this form. Submit CP-4 form with all plugged wells. Submit CP-111 form with all temporarily abandoned wells.

All requirements of the statutes, rules and regulations promulgated to regulate the oil and gas industry have been fully complied with and the statements herein are complete and correct to the best of my knowledge.

Signature R. E. Mathis

Title R. E. Mathis, Safety & Regulatory Date 9/25/86

Subscribed and sworn to before me this 25 day of September 1986

Notary Public

Date Commission Expires 5-3-89

K.C.C. OFFICE USE ONLY

F Letter of Confidentiality Attached
C Wireline Log Received
C Drillers Timelog Received

Distribution

KCC SWD/Rep NGPA
KGS Plug Other (Specify)

Sec. 29 Twp. 31. Rge. 21 W

SIDE TWO

Operator Name Mesa Operating Limited Partnership Lease Name MOORE Well # 2-29

Sec. 29 Twp. 31 Rge. 21 East West County Clark

WELL LOG

INSTRUCTIONS: Show important tops and base of formations penetrated. Detail all cores. Report all drill stem tests giving interval tested, time tool open and closed, flowing and shut-in pressures, whether shut-in pressure reached static level, hydrostatic pressures, bottom hole temperature, fluid recovery, and flow rates if gas to surface during test. Attach extra sheet if more space is needed. Attach copy of log.

Drill Stem Tests Taken Yes No
 Samples Sent to Geological Survey Yes No
 Cores Taken Yes No

See Attached

Formation Description
 Log Sample

Name Top Bottom

See Attached

RECEIVED
 STATE COMMISSION
 CONS. DIV. OKLAHOMA

OCT 27 1986

CASING RECORD <input type="checkbox"/> New <input type="checkbox"/> Used							
Report all strings set-conductor, surface, intermediate, production, etc.							
Purpose of String	Size Hole Drilled	Size Casing Set (in O.D.)	Weight Lbs/Ft.	Setting Depth	Type of Cement	#Sacks Used	Type and Percent Additives
surface	12 1/4"	8 5/8"	24#	598'	Poz	450	6% gel/3% CaCl
production	7 7/8"	5 1/2"	14#	5274'	Poz	250	18% salt/12% Kollite
PERFORATION RECORD				Acid, Fracture, Shot, Cement Squeeze Record			
Shots Per Foot	Specify Footage of Each Interval Perforated			(Amount and Kind of Material Used)			Depth
2 JSPF	5126-5146'						
TUBING RECORD				Liner Run <input type="checkbox"/> Yes <input checked="" type="checkbox"/> No			
	Size 2 3/8"	Set At 5100'	Packer at 5100'				
Date of First Production		Producing Method					
NA		<input type="checkbox"/> Flowing <input type="checkbox"/> Pumping <input type="checkbox"/> Gas Lift <input type="checkbox"/> Other (explain).....					
Estimated Production Per 24 Hours	Oil	Gas	Water	Gas-Oil Ratio		Gravity	
	NA	NA					
	Bbls	MCF	Bbls	CFPB			

METHOD OF COMPLETION

Production Interval Injection

Disposition of gas: Vented Open Hole Perforation
 Sold Other (Specify)
 Used on Lease Dually Completed Commingled

5126-5146'

IMPORTANT
 Kans. Geo. Survey request
 samples on this log **RECEIVED**

KANSAS DRILLERS LOG

AMARILLO PRODUCTION

S. 29 T. 31 R. 21 E W

API No. 15 — 025 — 20,259
 County Number

Loc. NW NW

Operator Mesa Petroleum Co. **MAR - 7 1979**

County Clark

Address P. O. Box 2009 Amarillo, Texas 79109

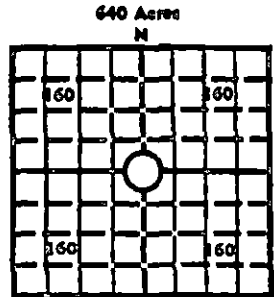

Well No. #2-29 Lease Name Moore

Footage Location 510 feet from (N) (S) line 700 feet from (E) (W) line

Principal Contractor DaMac Drilling Co. Geologist C. Shank

Spud Date 4-23-79 Total Depth 5275 P.B.T.D. 5223

Elev.: Gr. 2066

Date Completed 5-14-79 Oil Purchaser Koch

DF 2074 KB 2075

CASING RECORD

Report of all strings set — surface, intermediate, production, etc.

Purpose of string	Size hole drilled	Size casing set (in O.D.)	Weight lbs./ft.	Setting depth	Type cement	Secks	Type and percent additives
Surface	12 1/4	8 5/8	24	598	35:65 Poz	450	6% gel, 3% CaCl
Production	7 7/8	5 1/2	14	5274	50:50 Poz	250	18% Salt, 12% Kolite

LINER RECORD

PERFORATION RECORD

Top, ft.	Bottom, ft.	Secks cement	Shots per ft.	Size & type	Depth interval
			2	.38" jet	5126-5146

TUBING RECORD

Size	Setting depth	Packer set at
2 3/8	5100	5100

ACID, FRACTURE, SHOT, CEMENT SQUEEZE RECORD

Amount and kind of material used	Depth interval treated

INITIAL PRODUCTION

Date of first production <u>5-10-79</u>	Producing method (flowing, pumping, gas lift, etc.) <u>Flowing</u>
RATE OF PRODUCTION PER 24 HOURS	Oil <u>710</u> bbls. Gas <u>319</u> MCF Water <u>440</u> bbls. Gas-oil ratio <u>440</u> CFPB
Disposition of gas (vented, used on lease or sold) <u>Sold</u>	Producing interval (s) <u>5126-5146</u>

INSTRUCTIONS: As provided in KCC Rule 82-2-125, within 90 days after completion of a well, one completed copy of this Drillers Log shall be transmitted to the State Geological Survey of Kansas, 4150 Monroe Street, Wichita, Kansas 67209. Copies of this form are available from the Conservation Division, State Corporation Commission, 3830 So. Meridian (P.O. Box 17027), Wichita, Kansas 66217. Phone AC 316-522-2206. If confidential custody is desired, please note Rule 82-2-125. Drillers Logs will be on open file in the Oil and Gas Division, State Geological Survey of Kansas, Lawrence, Kansas 66044.

xc: KSGS (2), Denver Office 1

Operator Mesa Petroleum Co.		DESIGNATE TYPE OF COMP.: OIL, GAS, DRY HOLE, SWDW, ETC.: Oil
Well No. 2-29	Lease Name Moore	
S 29 T31S R 21 W ^{6X}		

WELL LOG

Show all important zones of porosity and contents thereof; cored intervals, and all drill-stem tests, including depth interval tested, cushion used, time tool open, flowing and shut-in pressures, and recoveries.

SHOW GEOLOGICAL MARKERS, LOGS RUN, OR OTHER DESCRIPTIVE INFORMATION.

FORMATION DESCRIPTION, CONTENTS, ETC.	TOP	BOTTOM	NAME	DEPTH
Core #1 (5125-54) Recovered 29' Morrow Sand			Toronto	4200
Core #2 (5154-74) Recovered 4' shale, 13' Miss. Lime			Lansing	4388
			Morrow	5110
			St. Louis	5152
DST #1 (5157-5194) St. Louis 30", 60", 60", 120" HP - 2583 - 2496 FP - 17-59, 85-119 SIP - 1308, 1300 Recovered 2700' gas, 68 VSO & GCM, 120' SO & GCM, 60' M & GCO				

OCT 27 1996

USE ADDITIONAL SHEETS, IF NECESSARY, TO COMPLETE WELL RECORD.

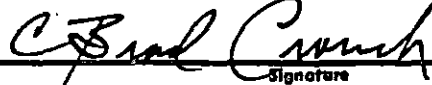
Date Received	 Signature
	Staff Engineer
	Title
	May 17, 1979
	Date

WELL LOG RECEIVED

AMARILLO PRODUCTION

COMPANY **Mesa Petroleum Company**

SEC. 29 T-31S R-21W

FARM **Moore**

NO. **2-29**

MAY 10 1979

LOG. 510 FNL 700 FWL

TOTAL DEPTH **5275**

JLF		GD	
SD		BC	COUNTY Clark
		TL	

COMM. **4-23-79**

COMP. **5-6-79**

CONTRACTOR **DaMac Drilling Inc.**

CASING **Conductor 20" set @ 29'**
Surface 8 5/8" set @ 598'

ELEVATION

PRODUCTION **4 1/2 set @ 5274'**

FIGURES INDICATE BOTTOM OF FORMATIONS.

Surface Sand	0	29
RedBed, Sand	29	600
RedBed, Anhydrtie	600	1216
Clay, Shale	1216	2075
RedBed	2075	2334
Shale	2334	2984
Shale, Lime	2984	5171
Lime	5171	5275 RTD

RECEIVED
STATE CORP. DIV.
CONS. DIV.

OCT 27 1986

State of Kansas

County of Barton

I, Martha J. McKown of DaMac Drilling Inc.

upon oath state the above and foregoing is a true and correct copy of the log of the Moore 2-29 well.

Martha J. McKown

Subscribed and sworn to before me this 7th day of May 19 79

My Commission Expires: 4-28-81

LANA L. REMMENT
Barton County, Kansas
My Appt. Exp. 4-28-81

Lana L. Remment
NOTARY PUBLIC

TOPOGRAPHIC ENGINEERING COMPANY

Surveying and Mapping for the Oil & Gas Industry

409 Regency Tower 333 N.W. 5th St. (405) 235-2363
Oklahoma City, Okla. 73102

AMARILLO PRODUCTION

APR - 2 1979

JLF		GD	
SD		BC	
		TLS	

CLARK County, Kansas
510' fNL-700' fWL Section 29 Township 31S Range 21W P.M.

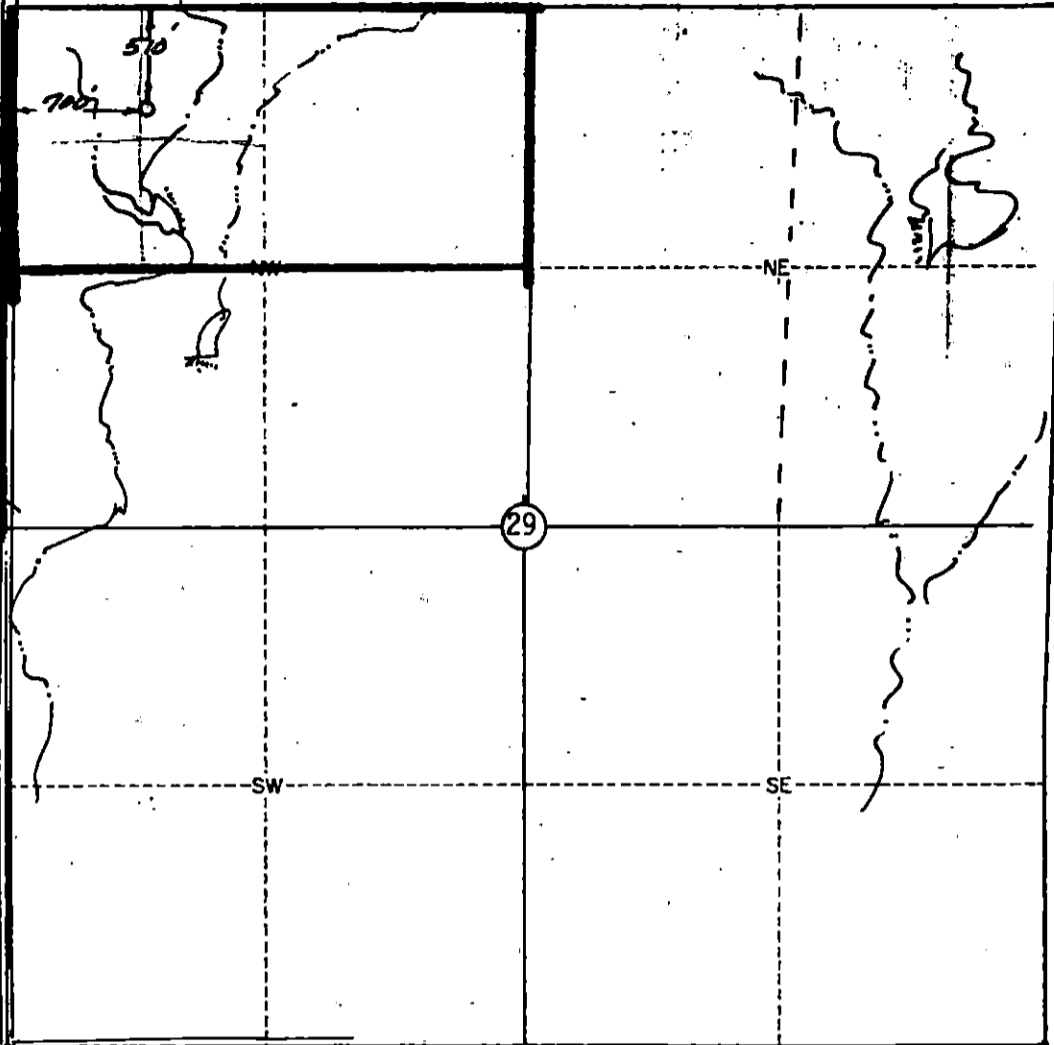

S.H. 34

Scale: 1" = 1000'

Date Staked: March 27, 1979

This location has been very carefully staked on the ground according to the best official survey records, maps, and photographs available to us, but its accuracy is not guaranteed.

Review this plat and notify us immediately of any possible discrepancy.

Operator: MESA PETROLEUM CO.

ELEVATION:

Lease Name: Moore Well No.: 2-29

Topography & Vegetation: pasture

Reference Stakes or Alternate Location: none
Good Drill Site? yes Stakes Set

Best Accessibility to Location: from West line

Distance & Direction: from Jct. S.H. 34 and U.S. 160, go 9.5 miles North on S.H. 34 to NW corner of Sec. 29-31S-21W.

ED
MISSION
MARKS

OCT 27 1986

CERTIFICATE:

I, Gary D. Boswell a Registered Land Surveyor and an authorized agent of Topographic Engineering Co., do hereby certify that the above described well location was surveyed and staked on the ground as shown herein.

Gary D. Boswell

Reg. No. 670

XC Denver