

ORIGINAL

RELEASED
CONFIDENTIAL APR 9 1992
FROM CONFIDENTIAL

SIDE ONE

STATE CORPORATION COMMISSION OF KANSAS
OIL & GAS CONSERVATION DIVISION
WELL COMPLETION FORM
ACO-1 WELL HISTORY
DESCRIPTION OF WELL AND LEASE

Operator: License # 5003

Name: McCoy Petroleum Corporation

Address 110 S. Main, Suite 500

City/State/Zip Wichita KS 67202

Purchaser: Unknown

Operator Contact Person: Roger McCoy

Phone (316) 265-9697

Contractor: Name: Allen Drilling Co.

License: 5418

Wellsite Geologist: Tim Pierce

Designate Type of Completion
 New Well Re-Entry Workover

Oil SWD Temp. Abd.
 Gas 52 Inj Delayed Comp.
 Dry Other (Core, Water Supply, etc.)

If OWMO: old well info as follows:
Operator: _____

Well Name: _____

Comp. Date _____ Old Total Depth _____

Drilling Method:
 Mud Rotary Air Rotary Cable

11-14-90 11-25-90 2-16-91
Spud Date Date Reached TD Completion Date

API NO. 15- 025-21,057-0005

County Clark

SE NW SE Sec. 34 Twp. 31S Rge. 21 East West

1650 Ft. North from Southeast Corner of Section

1650 Ft. West from Southeast Corner of Section
(NOTE: Locate well in section plat below.)

Lease Name Harden "A" Well # 1-34

Field Name Wildcat

Producing Formation Morrow Sand

Elevation: Ground 2013 KB 2018

Total Depth 5300' PBDT _____

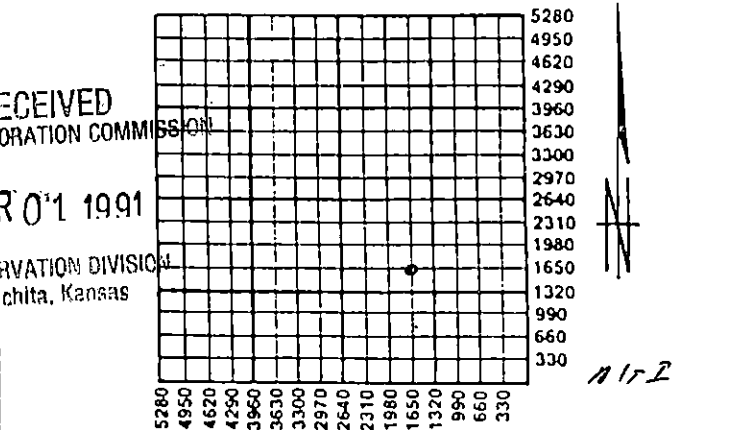

Amount of Surface Pipe Set and Cemented at 685' Feet

Multiple Stage Cementing Collar Used? Yes No

If yes, show depth set _____ Feet

If Alternate II completion, cement circulated from _____

feet depth to _____ w/ _____ sx cmt.

RECEIVED
STATE CORPORATION COMMISSION
APR 01 1991
CONSERVATION DIVISION
Wichita, Kansas

INSTRUCTIONS: This form shall be completed in triplicate and filed with the Kansas Corporation Commission, 200 Colorado Derby Building, Wichita, Kansas 67202, within 120 days of the spud date of any well. Rule 82-3-130, 82-3-107 and 82-3-106 apply. Information on side two of this form will be held confidential for a period of 12 months if requested in writing and submitted with the form. See rule 82-3-107 for confidentiality in excess of 12 months. One copy of all wireline logs and drillers time log shall be attached with this form. ALL CEMENTING TICKETS MUST BE ATTACHED. Submit CP-4 form with all plugged wells. Submit CP-111 form with all temporarily abandoned wells. Any recompletion, workover or conversion of a well requires filing of ACO-2 within 120 days from commencement date of such work.

All requirements of the statutes, rules and regulations promulgated to regulate the oil and gas industry have been fully complied with and the statements herein are complete and correct to the best of my knowledge.

Signature [Signature]

Title President Date 3-28-91

Subscribed and sworn to before me this 28 day of March, 19 91.

Notary Public Deborah Ann Paulus

Date Commission Expires January 8, 1992



K.C.C. OFFICE USE ONLY
F Letter of Confidentiality Attached
C Wireline Log Received
C Drillers Timelog Received
Distribution
KCC _____ SWD/Rep _____ NGPA _____
KGS _____ Plug _____ Other _____ (Specify)

P1

CONFIDENTIAL

SIDE TWO

Operator Name McCoy Petroleum Corporation Lease Name Harden "A" Well # 1-34
Sec. 34 Twp. 31s Rge. 21 East West
County Clark

INSTRUCTIONS: Show important tops and base of formations penetrated. Detail all cores. Report all drill stem tests giving interval tested, time tool open and closed, flowing and shut-in pressures, whether shut-in pressure reached static level, hydrostatic pressures, bottom hole temperature, fluid recovery, and flow rates if gas to surface during test. Attach extra sheet if more space is needed. Attach copy of log.

Drill Stem Tests Taken (Attach Additional Sheets.)	<input checked="" type="checkbox"/> Yes <input type="checkbox"/> No	Formation Description <input checked="" type="checkbox"/> Log <input type="checkbox"/> Sample Name Top Bottom
Samples Sent to Geological Survey	<input checked="" type="checkbox"/> Yes <input type="checkbox"/> No	
Cores Taken	<input type="checkbox"/> Yes <input checked="" type="checkbox"/> No	
Electric Log Run (Submit Copy.)	<input checked="" type="checkbox"/> Yes <input type="checkbox"/> No	
See Attached		See Attached

CASING RECORD <input checked="" type="checkbox"/> New <input type="checkbox"/> Used							
Report all strings set-conductor, surface, intermediate, production, etc.							
Purpose of String	Size Hole Drilled	Size Casing Set (In O.D.)	Weight Lbs./Ft.	Setting Depth	Type of Cement	# Sacks Used	Type and Percent Additives
Surface	12-1/4"	8-5/6"	23#	676'	Light	250	
Production		4-1/2"	10.5#	5294'	60/40 Poz Thix-Set	150 175	3%cc, 2%gel 3%KCL, 5#G11 1/4# Flo
PERFORATION RECORD				Acid, Fracture, Shot, Cement Squeeze Record			
Shots Per Foot	Specify Footage of Each Interval Perforated			(Amount and Kind of Material Used)		Depth	
4	5160-5164'						
TUBING RECORD							
Size		Set At	Packer At	Liner Run <input type="checkbox"/> Yes <input checked="" type="checkbox"/> No			
2-3/8" EUE							
Date of First Production	Producing Method <input type="checkbox"/> Flowing <input type="checkbox"/> Pumping <input type="checkbox"/> Gas Lift <input type="checkbox"/> Other (Explain)						
2-16-91							
Estimated Production Per 24 Hours	Oil Bbls.	Gas Mcf	Water Bbls.	Gas-Oil Ratio		Gravity	
		456					

Disposition of Gas: Vented Sold Used on Lease (If vented, submit ACO-18.)

METHOD OF COMPLETION: Open Hole Perforation Dually Completed Commingled Other (Specify) _____

Production Interval: 5141-5144'



Natural Gas • Crude Oil
Exploration & Production

ORIGINAL

McCOY PETROLEUM CORPORATION

110 South Main, Suite 500
Wichita, Kansas 67202
316-265-9697

RELEASED
APR 09 1992
CONFIDENTIAL
FROM CONFIDENTIAL

John Roger McCoy
President

Kevin McCoy
Vice-President

Harvey H. McCoy
Vice-President

Harden "A" #1-34
SE NW SE Section 34-31S-21W
Clark County, Kansas

IS-025-21057-0000

Page 2
ACO-1

DST #1 5132-5180' (Morrow Sand)
Open 30", S.I. 45", Open 30", S.I. 60"
Gas to the surface in 2 minutes.
Gauge 9,010,000 CFGPD in 5 minutes on 1st open.
9,980,000 CFGPD in 10 minutes,
10,900,000 CFGPD in 20 minutes,
10,900,000 CFGPD in 30 minutes.
Gauge 9,010,000 CFGPD in 5 minutes on 2nd open,
10,900,000 CFGPD in 10 minutes,
12,530,000 CFGPD in 20 minutes,
12,530,000+CFGPD in 30 minutes.
Recovered 2' of slightly oil cut watery mud,
210' of gas cut water.
FP 1489-1469# 1489-1469#
ISIP 1772# FSIP 1721# HH 2500#

DST #2 5180-5190' (Morrow)
Open 30", S.I. 60", Open 60", S.I. 90"
Weak blow building to strong on 1st open.
Strong blow throughout 2nd open.
Recovered 60' of oil spotted muddy water,
360' of salt water.
FP 101-111# 152-223#
ISIP 1802# FSIP 1802#

ELECTRIC LOG TOPS

Heebner	
Lansing	
Marmaton	
Cherokee	
Morrow Shale	5130 (-3112)
1st Morrow Sand	5140 (-3122)
2nd Morrow Sand	5159 (-3141)
Mississippian	5230 (-3212)
LTD	5296 (-3278)

RECEIVED
STATE CORPORATION COMMISSION

APR 01 1991
CONSERVATION DIVISION
Wichita, Kansas