

# ORIGINAL

SIDE ONE

STATE CORPORATION COMMISSION OF KANSAS  
OIL & GAS CONSERVATION DIVISION  
WELL COMPLETION FORM  
ACO-1 WELL HISTORY  
DESCRIPTION OF WELL AND LEASE

API NO. 15- 007-22,342-00-00

County Barber

100' E SE NE Sec. 11 Twp. 31S Rge. 12 X East West

3300 Ft. North from Southeast Corner of Section

560 Ft. West from Southeast Corner of Section  
(NOTE: Locate well in section plat below.)

Lease Name Mott "A" ~~Wagon~~ Well # 28

Field Name Amber Creek South

Producing Formation Mississippi

Elevation: Ground 1608 KB 1615

Total Depth 4385' PBSD 4340'

Operator: License # 5552

Name: Gore Oil Company

Address P.O. Box 2757

Wichita, KS 67201-2757

City/State/Zip \_\_\_\_\_

Purchaser: Koch Oil Company

Operator Contact Person: Scott W Scheuerman

Phone (316) 263-3535

Contractor: Name: Brandt Drilling Company

License: 5840

Wellsite Geologist: Charles Schmaltz

Designate Type of Completion

New Well  Re-Entry  Workover

Oil  SWD  Temp. Abd.

Gas  Inj  Delayed Comp.

Dry  Other (Core, Water Supply, etc.)

If OWMO: old well info as follows:

Operator: \_\_\_\_\_

Well Name: \_\_\_\_\_

Comp. Date \_\_\_\_\_ Old Total Depth \_\_\_\_\_

Drilling Method:

Mud Rotary  Air Rotary  Cable

11-11-90 11-19-90 12-7-90  
Spud Date Date Reached TD Completion Date

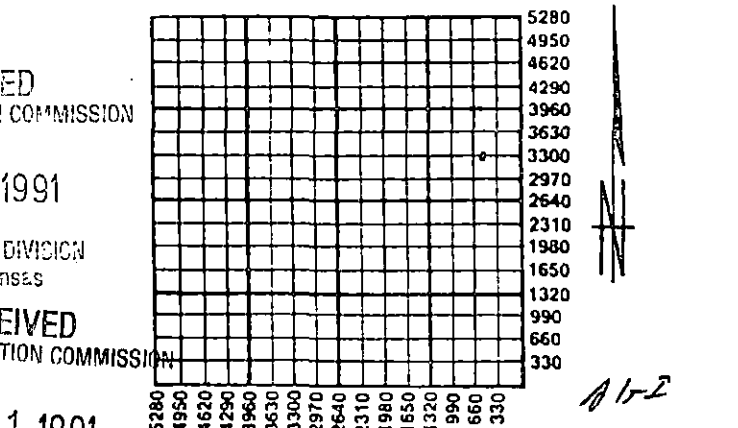

Amount of Surface Pipe Set and Cemented at 307 Feet:

Multiple Stage Cementing Collar Used?  Yes  No

If yes, show depth set \_\_\_\_\_ Feet

If Alternate-II completion, cement circulated from n/a

feet depth to \_\_\_\_\_ w/ \_\_\_\_\_ sx cmr.

INSTRUCTIONS: This form shall be completed in triplicate and filed with the Kansas Corporation Commission, 200 Colorado Derby Building, Wichita, Kansas 67202, within 120 days of the spud date of any well. Rule 82-3-130, 82-3-107 and 82-3-106 apply. Information on side two of this form will be held confidential for a period of 12 months if requested in writing and submitted with the form. See rule 82-3-107 for confidentiality in excess of 12 months. One copy of all wireline logs and drillers time log shall be attached with this form. ALL CEMENTING TICKETS MUST BE ATTACHED. Submit CP 4 form with all plugged wells. Submit CP-111 form with all temporarily abandoned wells. Any recompletion, workover or conversion of a well requires filing of ACO-2 within 120 days from commencement date of such work.

All requirements of the statutes, rules and regulations promulgated to regulate the oil and gas industry have been fully complied with and the statements herein are complete and correct to the best of my knowledge.

Signature Scott W Scheuerman

Title Petroleum Engineer Date 1-14-91

Subscribed and sworn to before me this 14th day of January, 19 91.

Notary Public Rebecca K Crawford

Date Commission Expires 1-7-95

K.C.C. OFFICE USE ONLY

F  Letter of Confidentiality Attached

C  Wireline Log Received

C  Drillers Timelog Received

Distribution

KCC  SWD/Rep  NGPA

KGS  Plug  Other (Specify)

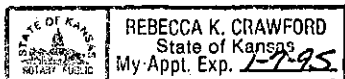

P1

**SIDE TWO**

Operator Name Gore Oil Company Lease Name Mott "A" Well # 28

Sec. 11 Twp. 31s Rge. 12  
 East  
 West

County Barber

**INSTRUCTIONS:** Show important tops and base of formations penetrated. Detail all cores. Report all drill stem tests giving interval tested, time tool open and closed, flowing and shut-in pressures, whether shut-in pressure reached static level, hydrostatic pressures, bottom hole temperature, fluid recovery, and flow rates if gas to surface during test. Attach extra sheet if more space is needed. Attach copy of log.

Drill Stem Tests Taken  Yes  No  
 (Attach Additional Sheets.)  
 Samples Sent to Geological Survey  Yes  No  
 Cores Taken  Yes  No  
 Electric Log Run  Yes  No  
 (Submit Copy.)

Formation Description		
Name	Top	Bottom
Heebner	3514'	-1899
Lansing	3724'	-2109
B/KC	4168'	-2553
Mississippi	4252'	-2637

**CASING RECORD**  New  Used  
 Report all strings set-conductor, surface, intermediate, production, etc.

Purpose of String	Size Hole Drilled	Size Casing Set (In O.D.)	Weight Lbs./Ft.	Setting Depth	Type of Cement	# Sacks Used	Type and Percent Additives
Surface	12 1/4	8 5/8	20	307	50/50, A	300	
Production	7 7/8	4 1/2	10.5	4382	50/50, A	250	

Shots Per Foot	PERFORATION RECORD Specify Footage of Each Interval Perforated	Acid, Fracture, Shot, Cement Squeeze Record (Amount and Kind of Material Used)	Depth
3	4265'-4278'	1,000 gal. 15% NE Acid 2,000 gal. SGA Acid 24,000 gal., 32,000# Fracture Treatment	

**TUBING RECORD** Size 2 3/8" Set At 4282' Packer At \_\_\_\_\_ Liner Run  Yes  No

~~Date of First Production~~ 12-10-90 Producing Method  Flowing  Pumping  Gas Lift  Other (Explain)

Estimated Production Per 24 Hours	Oil Bbls.	Gas Mcf	Water Bbls.	Gas-Oil Ratio	Gravity
	30	50	30		

Disposition of Gas:  Vented  Sold  Used on Lease (If vented, submit ACO-18.)

**METHOD OF COMPLETION**  Open Hole  Perforation  Dually Completed  Commingled  
 Other (Specify) \_\_\_\_\_

Production Interval \_\_\_\_\_

ORIGINAL

Mott "A" #28 Drill Stem Tests Taken

DST #1, 4245'-4270' (30"-60"-30"-60")

Recovered 90' gas cut mud

IHP 2083#      IFP 90#-80#      ISIP 1519#

FHP 2063#      FFP 90#-80#      FSIP 1490#

DST #2, 4272'-4290' (30"-60"-60"-60")

Recovered 80' clean gassy oil, 180' heavy gas & mud cut watery oil

IHP 2090#      IFP 80#-90#      ISIP 1381#

FHP 2073#      FFP 100#-110#      FSIP 1322#

RECEIVED  
STATE CORPORATION COMMISSION

MAR - 6 1991

CONSERVATION DIVISION  
Wichita, Kansas

**HALLIBURTON SERVICES**

A Halliburton Company

INVOICE NO.	DATE
041882	11/11/1990

WELL/LEASE NO./PLANT NAME		WELL/PLANT LOCATION		STATE	WELL/PLANT OWNER
COTT A-28		BARBER		KS	SAME
SERVICE LOCATION		CONTRACTOR	JOB PURPOSE		TICKET DATE
PRATT		BRANDT DRLG	CEMENT SURFACE CASING		11/11/1990
ACCT. NO.	CUSTOMER AGENT	VENDOR NO.	CUSTOMER P.O. NUMBER	SHIPPED VIA	FILE NO.
33580	MERLIN FREEMAN			COMPANY TRUCK	05108

RECEIVED  
STATE CORPORATION COMMISSION

GORE OIL CO  
202 S. ST. FRANCIS  
BOX 2757  
WICHITA, KS 67201-2757

MAR - 6 1991

CONSERVATION DIVISION  
Wichita, Kansas

DIRECT CORRESPONDENCE TO:  
SUITE 1300  
LIBERTY TOWER  
100 BROADWAY AVENUE  
OKLAHOMA CITY, OK 73102-0000

PRICE REF. NO.	DESCRIPTION	QUANTITY	U/M	UNIT PRICE	AMOUNT
PRICING AREA - MID CONTINENT					
000-117	MILEAGE	10	MI		
		1	UNT		
001-016	CEMENTING CASING	312	FT		
		1	UNT		
000-118	MILEAGE SURCHARGE-CEMENT-LAND	10	MI		
		1	UNT		
030-503	CMTG PLUG LA-11, CP-1, CP-3, TOP	8 5/8	IN		
		1	EA		
504-308	STANDARD CEMENT	150	SK		
504-308	STANDARD CEMENT	75	SK		
506-105	POZMIX A	75	SK		
509-406	ANHYDROUS CALCIUM CHLORIDE	8	SK		
500-307	MILEAGE SURCHARGE-CEMENT MAT.	136.7	TMI		
500-207	BULK SERVICE CHARGE	316	CFY		
500-306	MILEAGE CMTG MAT DEL OR RETURN	136.7	TMI		
INVOICE SUBTOTAL					
DISCOUNT-(BID)					
INVOICE BID AMOUNT					
*-KANSAS STATE SALES TAX					
*-PRATT COUNTY SALES TAX					
					
INVOICE TOTAL - PLEASE PAY THIS AMOUNT =====					

TERMS: INVOICES PAYABLE NET BY THE 20TH OF THE FOLLOWING MONTH AFTER DATE OF CUSTOMER'S DEFAULT IN PAYMENT OF CUSTOMER'S ACCOUNT BY THE LAST DAY OF FOLLOWING THE MONTH IN WHICH THE INVOICE IS DATED. CUSTOMER AGREES TO THEREON AFTER DEFAULT AT THE HIGHEST LAWFUL CONTRACT RATE APPLICABLE TO EXCEED 18% PER ANNUM. IN THE EVENT IT BECOMES NECESSARY TO EMPLOY AN ENFORCE COLLECTION OF SAID ACCOUNT, CUSTOMER AGREES TO PAY ALL COLLECTION ATTORNEY FEES IN THE AMOUNT OF 20% OF THE AMOUNT OF THE UNPAID ACCOUNT.



**ORIGINAL HALLIBURTON SERVICES**

INVOICE

A Halliburton Company

INVOICE NO.	DATE
041888	11/19/1990

WELL LEASE NO./PLANT NAME OTT 'A' 28		WELL/PLANT LOCATION BARBER		STATE KS	WELL/PLANT OWNER SAME
SERVICE LOCATION RATT		CONTRACTOR BRANDT DRLG	JOB PURPOSE CEMENT PRODUCTION CASING		TICKET DATE 11/19/1990
ACCT. NO. 33580	CUSTOMER AGENT SCOTT SCHEUERMAN	VENDOR NO.	CUSTOMER P.O. NUMBER	SHIPPED VIA COMPANY TRUCK	FILE NO. 05669

STATE COMPLETION COMMISSION

GORE OIL CO  
202 S. ST. FRANCIS  
BOX 2757  
WICHITA, KS 67201-2757

MAR - 6 1991  
CONSERVATION DIVISION  
Wichita, Kansas

DIRECT CORRESPONDENCE TO:  
SUITE 1300  
LIBERTY TOWER  
100 BROADWAY AVENUE  
OKLAHOMA CITY, OK 73102-0000

PRICE REF. NO.	DESCRIPTION	QUANTITY	U/M
000-117	TRICING AREA - MID CONTINENT MILEAGE	10	MI
		1	UNT
000-118	MILEAGE SURCHARGE-CEMENT-LAND	10	MI
		1	UNT
001-016	CEMENTING CASING	4389	FT
		1	UNT
030-016	CEMENTING PLUG 5W ALUM TOP	4.5	IN
		1	EA
509-968	SALT	200	LB
12A	GUIDE SHOE - 4 1/2" BRD THD.	1	EA
825.201			
24A	INSERT FLOAT VALVE - 4 1/2" BRD	1	EA
818.19101			
40	CENTRALIZER 4-1/2" MODEL S-4	6	EA
807.93004			
27	FILL-UP UNIT 4 1/2"-5"	1	EA
815.19113			
504-308	STANDARD CEMENT	200	SK
504-308	STANDARD CEMENT	25	SK
506-105	POZMIX A	25	SK
506-121	HALLIBURTON-GEL 2%	1	SK
509-968	SALT	550	LB
507-153	CFR-3	115	LB
500-307	MILEAGE SURCHARGE-CEMENT MAT.	118.75	TMY
500-207	BULK SERVICE CHARGE	258	CFT
500-306	MILEAGE CHRG MAT DEL OR RETURN	118.75	TMY
INVOICE SUBTOTAL			
DISCOUNT-(BID)			
INVOICE BID AMOUNT			

\*\*\*\*\* CONTINUED ON NEXT PAGE \*\*\*\*\*

TERMS: INVOICES PAYABLE NET BY THE 20TH OF THE FOLLOWING MONTH AFTER DATE OF CUSTOMER'S DEFAULT IN PAYMENT OF CUSTOMER'S ACCOUNT BY THE LAST DAY FOLLOWING THE MONTH IN WHICH THE INVOICE IS DATED. CUSTOMER AGREES THEREON AFTER DEFAULT AT THE HIGHEST LAWFUL CONTRACT RATE APPLICABLE TO EXCEED 18% PER ANNUM. IN THE EVENT IT BECOMES NECESSARY TO EMPLOY ENFORCE COLLECTION OF SAID ACCOUNT, CUSTOMER AGREES TO PAY ALL COLLECTOR ATTORNEY FEES IN THE AMOUNT OF 20% OF THE AMOUNT OF THE UNPAID ACCO