

STATE CORPORATION COMMISSION OF KANSAS  
OIL & GAS CONSERVATION DIVISION  
WELL COMPLETION FORM  
ACO-1 WELL HISTORY  
DESCRIPTION OF WELL AND LEASE

**ORIGINAL**

API NO. 15- 189-21819-00

County STEVENS

SW - NE - NE Sec. 10 Twp. 34 Rge. 38 X W

4142 FSL Feet from S N (circle one) Line of Section

1250 FEL Feet from E W (circle one) Line of Section

Footages Calculated from Nearest Outside Section Corner:  
NE, SE, NW or SW (circle one)

Lease Name CP- BROOKS #1 UNIT Well # 3

Field Name Hugoton

Producing Formation NA **[ANODE REPOSITORY]**

Elevation: Ground 3205 KB NA

Total Depth 100 PBDT NA

Amount of Surface Pipe Set and Cemented at None Feet

Multiple Stage Cementing Collar Used? NA Yes NA No

If yes, show depth set NA Feet

If Alternate II completion, cement circulated from NA

feet depth to NA w/ NA sx cmt.

Drilling Fluid Management Plan ALT 3 J9 10-18-95  
(Data must be collected from the Reserve Pit)

Chloride content NA ppm Fluid volume NA bbls

Dewatering method used NA

Location of fluid disposal if hauled offsite:

Operator Name NA

Lease Name NA License No. NA

NA Quarter Sec. NA Twp. NA S Rng. NA E/W

County NA Docket No. NA

Operator: License # 5208

Name: Mobil Oil Corporation

Address P.O. Box 2173

2319 North Kansas Avenue

City/State/Zip Liberal, KS 67905-2173

Purchaser: N/A

Operator Contact Person: Sharon Cook

Phone (316) 626-1142

Contractor: Name: Catholic Protection Services

License: 31474

Wellsite Geologist: \_\_\_\_\_

Designate Type of Completion  
   New Well    Re-Entry    Workover

   Oil    SWD    SLOW    Temp. Abd.  
   Gas    ENHR    SIGW  
   Dry X Other (Gels, Gels, Expt., Cathodic, etc)

If Workover:

Operator: \_\_\_\_\_

Well Name: \_\_\_\_\_

Comp. Date \_\_\_\_\_ Old Total Depth \_\_\_\_\_

   Deepening    Re-perf.    Conv. to Inj/SWD  
   Plug Back    PBDT  
   Commingled    Docket No. \_\_\_\_\_  
   Dual Completion    Docket No. \_\_\_\_\_  
   Other (SWD or Inj?)    Docket No. \_\_\_\_\_

1/11/95 1/11/95 1/11/95  
Spud Date Date Reached TD Completion Date

**INSTRUCTIONS:** An original and two copies of this form shall be filed with the Kansas Corporation Commission, 200 Colorado Derby Building, Wichita, Kansas 67202, within 120 days of the spud date, recompletion, workover or conversion of a well. Rule 82-3-130, 82-3-106 and 82-3-107 apply. Information on side two of this form will be held confidential for a period of 12 months if requested in writing and submitted with the form (see rule 82-3-107 for confidentiality in excess of 12 months). One copy of all wireline logs and geologist well report shall be attached with this form. ALL CEMENTING TICKETS MUST BE ATTACHED. Submit CP-4 form with all plugged wells. Submit CP-111 form with all temporarily abandoned wells.

All requirements of the statutes, rules and regulations promulgated to regulate the oil and gas industry have been fully complied with and the statements herein are complete and correct to the best of my knowledge.

Signature Sharon A. Cook Sharon A. Cook

Title Regulatory Assistant Date 2-13-95

Subscribed and sworn to before me this 13<sup>th</sup> day of February, 19 95.

Notary Public Kathleen R. Poulton

Date Commission Expires AUGUST 18, 1998

DEW95097.SAC



**K.C.C. OFFICE USE ONLY**  
F    Letter of Confidentiality Attached  
C    Wireline Log Received  
C    Geologist Report Received  
  
Distribution  
   KCC    SWD/Rep    NGPA  
   KGS    Plug    Other  
(Specify)

Operator Name Mobil Oil Corporation Lease Name CP- BROOKS #1 UNIT Well # 3  
 Sec. 10 Twp. 34 Rge. 38  East County STEVENS  
 West

**INSTRUCTIONS:** Show important tops and base of formations penetrated. Detail all cores. Report all drill stem tests giving interval tested, time tool open and closed, flowing and shut-in pressures, whether shut-in pressure reached static level, hydrostatic pressures, bottom hole temperature, fluid recovery, and flow-rates if gas to surface during test. Attach extra sheet if more space is needed. Attach copy of log.

Drill Stem Tests Taken (Attach Additional Sheets.)	<input type="checkbox"/> Yes <input checked="" type="checkbox"/> No	<input checked="" type="checkbox"/> Log Formation (Top), Depth and Datum <input type="checkbox"/> Sample Name Top Datum  SEE ATTACHED DRILLER'S LOG
Samples Sent to Geological Survey	<input type="checkbox"/> Yes <input checked="" type="checkbox"/> No	
Cores Taken	<input type="checkbox"/> Yes <input checked="" type="checkbox"/> No	
Electric Log Run (Submit Copy.)	<input type="checkbox"/> Yes <input checked="" type="checkbox"/> No	
List All E.Logs Run:		
Electric Resistance Log - Attached		

CASING RECORD <input type="checkbox"/> New <input type="checkbox"/> Used							
Report all strings set-conductor, surface, intermediate, production, etc.							
Purpose of String	Size Hole Drilled	Size Casing Set (In O.D.)	Weight Lbs./Ft.	Setting Depth	Type of Cement	# Sacks Used	Type and Percent Additives

ADDITIONAL CEMENTING/SQUEEZE RECORD				
Purpose:	Depth Top Bottom	Type of Cement	#Sacks Used	Type and Percent Additives
<input type="checkbox"/> Perforate				
<input type="checkbox"/> Protect Casing				
<input type="checkbox"/> Plug Back TD				
<input checked="" type="checkbox"/> Plug Off Zone				
		(1) First plug - Bentonite set at 13' - 3' plug.		
		(2) Second plug - Bentonite set at 32' - 30' plug.		

Shots Per Foot	PERFORATION RECORD - Bridge Plugs Set/Type		Acid, Fracture, Shot, Cement Squeeze Record	
	Specify Footage of Each Interval Perforated		Amount and Kind of Material Used	Depth
First anode set at	80', second anode at	70', third anode at	50'.	

TUBING RECORD		Size	Set At	Packer At	Liner Run	NA <input type="checkbox"/> Yes <input type="checkbox"/> No		
Date of First, Resumed Production, SWD or Inj. Installed 1/11/95		1" PVC vent from TD to 3' above surface.						
Producing Method		NA	<input type="checkbox"/> Flowing	<input type="checkbox"/> Pumping	<input type="checkbox"/> Gas Lift	<input type="checkbox"/> Other (Explain)		
Estimated Production Per 24 Hours	Oil	Bbls. NA.	Gas	Mcf NA	Water	Bbls. NA	Gas-Oil Ratio	Gravity

Disposition of Gas:  Vented  Sold  Used on Lease (If vented, submit ACO-18.)

METHOD OF COMPLETION:  Open Hole  Perf.  Dually Comp.  Commingled

Production Interval:  Other (Specify) \_\_\_\_\_

DATA SHEET

COMPANY MOBILE E+P JOB No. 80100370 DATE: 1-11-95  
 WELL: BROOKS 1-3 PIPELINE:  
 LOCATION: SEC. 10 TWP. 34 RGE. 38 CO. STEVENS STATE KS  
 ANODE TYPE L10A ONE FT: ROTARY 100 FT: CASING \_\_\_\_\_ FT.

DEEP GROUND BED LOGGING DATA

DRILL. DEPTH LOG (FT)	ANODE TO STRUCTURE		ANODES		DRILL DEPTH LOG (FT)	ANODE TO STRUCTURE		ANODES	
	EXPLOR	FINAL	NO	TOP DEPTH		EXPLOR	FINAL	NO	TOP DEPTH
	OHM	OHM				OHM	OHM		
5					205				
HOLE PLUG 10				3'-13'	210				
EARTH FILL 15				13'-30'	215				
HOLE PLUG 20				30'-32'	220				
25					225				
30	1.300				230				
35	1.11				235				
40	1.04				240				
45	.940				245				
50	.980		3		250				
55	.520				255				
60	.360				260				
65	.850				265				
70	.940		2		270				
75	.490				275				
80	.380		1		280				
85	.280				285				
90	.350				290				
95					295				
100					300				
105					305				
110					310				
115					315				
120					320				
125					325				
130					330				
135					335				
140					340				
145					345				
150					350				
155					355				
160					360				
165					365				
170					370				
175					375				
180					380				
185					385				
190					390				
195					395				
200					400				

PIT CLOSED 1-11-95 HOLE PLUG SET 1-11-95

GROUND BED RESISTANCE: (1) VOLTS \_\_\_\_\_ ÷ AMPS \_\_\_\_\_ = \_\_\_\_\_ OHMS (2) VIBROGROUND \_\_\_\_\_ OHMS

BROOKS 1-3\_10-34-38 Stevens  
4042 FSL 1250FEL  
Elec? N Crop CORN

0-60 Clay  
60-80 Sand  
80-100 Clay

ORIGINAL

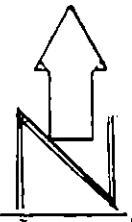

1-11-95

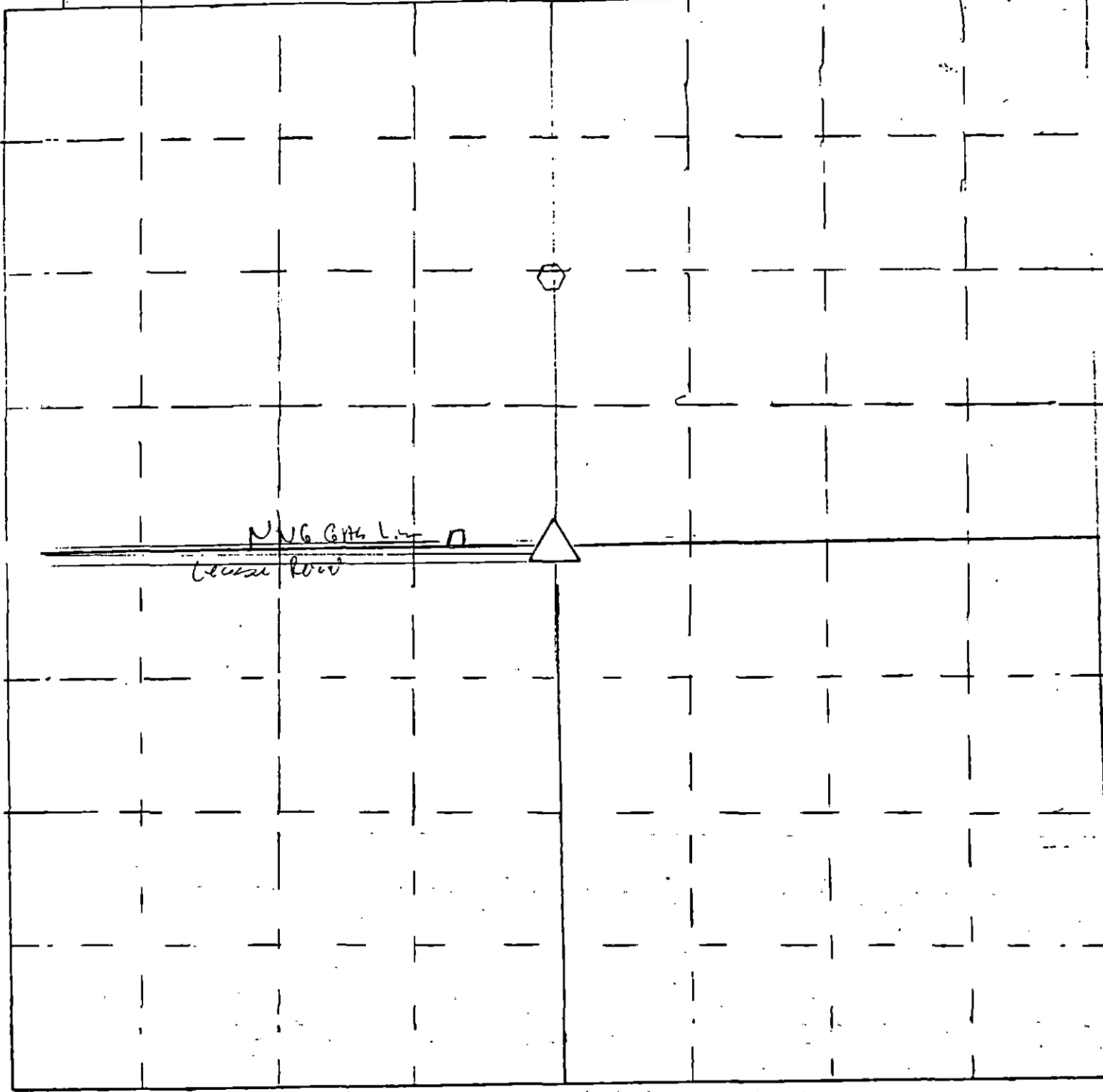

- △ = gas well location
- ⬡ = cathodic deep well location

Scale = 1" = 50'  
□ = Meter house