

STATE CORPORATION COMMISSION OF KANSAS  
OIL & GAS CONSERVATION DIVISION  
WELL COMPLETION FORM  
ACO-1 WELL HISTORY  
DESCRIPTION OF WELL AND LEASE

API NO. 15- 189-2192-70000

ORIGINAL

County Stevens

- NW - SE - SE Sec. 8 Twp. 34 Rge. 38 X W

1250 Feet from (S) N (circle one) Line of Section

1250 Feet from (E) W (circle one) Line of Section

Footages Calculated from Nearest Outside Section Corner:  
NE, (SE) NW or SW (circle one)

Lease Name McLintom Well # I-2

Field Name Hugoton

Producing Formation Chase

Elevation: Ground 3253' KB 3262'

Total Depth 2900' PBTD 2839'

Amount of Surface Pipe Set and Cemented at 666 Feet

Multiple Stage Cementing Collar Used? Yes X No

If yes, show depth set N/A feet

If Alternate II completion, cement circulated from N/A

feet depth to N/A w/ N/A sx cmt.

Drilling Fluid Management Plan ALT I 976 1-17-96  
(Data must be collected from the Reserve Pit)

Chloride content 4,500 ppm Fluid volume 800 bbls

Dewatering method used None

Location of fluid disposal if hauled offsite:

Operator Name N/A

Lease Name License No.

Quarter Sec. Twp. S Rng. E/W

County Docket No.

Operator: License # 09736

Name: Dorchester Hugoton, Ltd.

Address 9696 Skillman Street

Suite 320, LB 42

City/State/Zip Dallas, TX 75243-8200

Purchaser: Centana Energy Co.

Operator Contact Person: John Booth

Phone (214) 340-3443

Contractor: Name: Norseman Drilling

License: #3779

Wellsite Geologist: John Dannelley

Designate Type of Completion  
X New Well Re-Entry Workover

Oil SWD SLOW Temp. Abd.

X Gas ENHR SIGW

Dry Other (Core, WSW, Expl., Cathodic, etc)

If Workover:

Operator: N/A

Well Name: N/A

Comp. Date N/A Old Total Depth N/A

Deepening Re-perf. Conv. to Inj/SWD

Plug Back PBTD

Commingle Docket No.

Dual Completion Docket No.

Other (SWD or Inj?) Docket No.

5/4/95 5/6/95 6/5/95  
Spud Date Date Reached TD Completion Date

INSTRUCTIONS: An original and two copies of this form shall be filed with the Kansas Corporation Commission, 130 S. Market - Room 2078, Wichita, Kansas 67202, within 120 days of the spud date, recompletion, workover or conversion of a well. Rule 82-3-130, 82-3-106 and 82-3-107 apply. Information on side two of this form will be held confidential for a period of 12 months if requested in writing and submitted with the form (see rule 82-3-107 for confidentiality in excess of 12 months). One copy of all wireline logs and geologist well report shall be attached with this form. ALL CEMENTING TICKETS MUST BE ATTACHED. Submit CP-4 form with all plugged wells. Submit CP-111 form with all temporarily abandoned wells.

All requirements of the statutes, rules and regulations promulgated to regulate the oil and gas industry have been fully complied with and the statements herein are complete and correct to the best of my knowledge.

Signature John L. Booth

Title Mgr., Marketing and Royalties Date 7/17/95

Subscribed and sworn to before me this 17th day of July, 1995.

Notary Public Melba J Cecil

Date Commission Expires 11/07/96

K.C.C. OFFICE USE ONLY  
F Letter of Confidentiality Attached  
C  Wireline Log Received  
C Geologist Report Received  
Distribution  
 KCC  SWD/Rep  NGA  
 KGS  Plug  Other (Specify)



Form ACO-1 (7-91)

RECEIVED  
STATE CORPORATION COMMISSION

JUL 24 1995

Operator Name Dorchester Hugoton, Ltd.

SIDE TWO

Lease Name McIntom

Well # I-2

Sec. 8 Twp. 34 Rge. 38

East  
 West

County Stevens

INSTRUCTIONS: Show important tops and base of formations penetrated. Detail all cores. Report all drill stem tests giving interval tested, time tool open and closed, flowing and shut-in pressures, whether shut-in pressure reached static level, hydrostatic pressures, bottom hole temperature, fluid recovery, and flow rates if gas to surface during test. Attach extra sheet if more space is needed. Attach copy of log.

Drill Stem Tests Taken  Yes  No  
(Attach Additional Sheets.)

Samples Sent to Geological Survey  Yes  No

Cores Taken  Yes  No

Electric Log Run  Yes  No  
(Submit Copy.)

List All E.Logs Run: CEMENT BOND  
DUAL INDUCTION  
DUAL-SPACED NEUTRON

Log Formation (Top), Depth and Datum  Sample

| Name            | Top  | Datum |
|-----------------|------|-------|
| Krider          | 2722 | 2762  |
| Winfield        | 2674 | 2711  |
| Upper Ft. Riley | 2790 | 2830  |
| Lower Ft. Riley | 2850 | 2886  |

CASING RECORD

New  Used

Report all strings set-conductor, surface, intermediate, production, etc.

| Purpose of String | Size Hole Drilled | Size Casing Set (In O.D.) | Weight Lbs./Ft. | Setting Depth | Type of Cement | # Sacks Used | Type and Percent Additives  |
|-------------------|-------------------|---------------------------|-----------------|---------------|----------------|--------------|-----------------------------|
| Surface Water     | 12-1/4            | 8-5/8                     | 24              | 666           | C              | 325          | 6% gel-2% CaCl <sub>2</sub> |
| Production        | 7-7/8             | 5-1/2                     | 14              | 2,898         | C              | 310          | 6% gel-2% CaCl <sub>2</sub> |

ADDITIONAL CEMENTING/SQUEEZE RECORD

| Purpose:<br><input type="checkbox"/> Perforate<br><input type="checkbox"/> Protect Casing<br><input type="checkbox"/> Plug Back TD<br><input type="checkbox"/> Plug Off Zone | Depth |        | Type of Cement | #Sacks Used | Type and Percent Additives |
|--|-------|--------|----------------|-------------|----------------------------|
|  | Top   | Bottom |                |             |                            |
|  |       |        |                |             |                            |

| Shots Per Foot | PERFORATION RECORD - Bridge Plugs Set/Type<br>Specify Footage of Each Interval Perforated | Acid, Fracture, Shot, Cement Squeeze Record<br>(Amount and Kind of Material Used) |       |
|----------------|---|---|-------|
|                |   | Amount  | Depth |
| 2              | 2808-2826   | 250 gal. 15%+2000 gal 7-1/2% -  |       |
|                |   | 19,500 gal Form Frac; 20,050# 20-40SD   |       |
| 2              | 2730-2755   | 250 gal 15%+5000 gal 7-1/2% - Frac w/   |       |
| 2              | 2680-2705   | 48,000 gal X/L gel, 3000# 20/40+110,000# 12-20SD                                  |       |

| TUBING RECORD | Size | Set At | Packer At | Liner Run   |
|---------------|------|--------|-----------|---|
|               |      |        |           | <input type="checkbox"/> Yes <input checked="" type="checkbox"/> No |

| Date of First, Resumed Production, SWD or Inj. | Producing Method  |
|--|---|
| 6/14/95  | <input checked="" type="checkbox"/> Flowing <input type="checkbox"/> Pumping <input type="checkbox"/> Gas Lift <input type="checkbox"/> Other (Explain) |

| Estimated Production Per 24 Hours | Oil Bbls. | Gas Mcf | Water Bbls. | Gas-Oil Ratio | Gravity |
|-----------------------------------|-----------|---------|-------------|---------------|---------|
|                                   |           | 400     |             |               |         |

Disposition of Gas:

METHOD OF COMPLETION

Production Interval

Vented  Sold  Used on Lease  
(If vented, submit ACO-18.)

Open Hole  Perf.  Dually Comp.  Commingled

Other (Specify)

2680-2826

# WELL LOCATION SURVEY

PROPERTY OWNER DORCHESTER HUGOTON LTD. SURVEY OF WELL McLinton I-2  
LOCATED 1250 feet from the South line and 1250 feet from East line of  
SECTION 8, T34S-R38W COUNTY OF Stevens STATE OF Kansas  
SURVEYED March 30, 1995 PLATTED March 31, 1995

ELEVATION OF WELL LOCATION IS 3253.0 feet  
API # 15-189-21927



Scale:  
1" = 1,000 ft.

## ORIGINAL

RECEIVED  
KANSAS CORPORATION COMMISSION

JUL 11 1995

CONSERVATION DIVISION  
WICHITA, KS

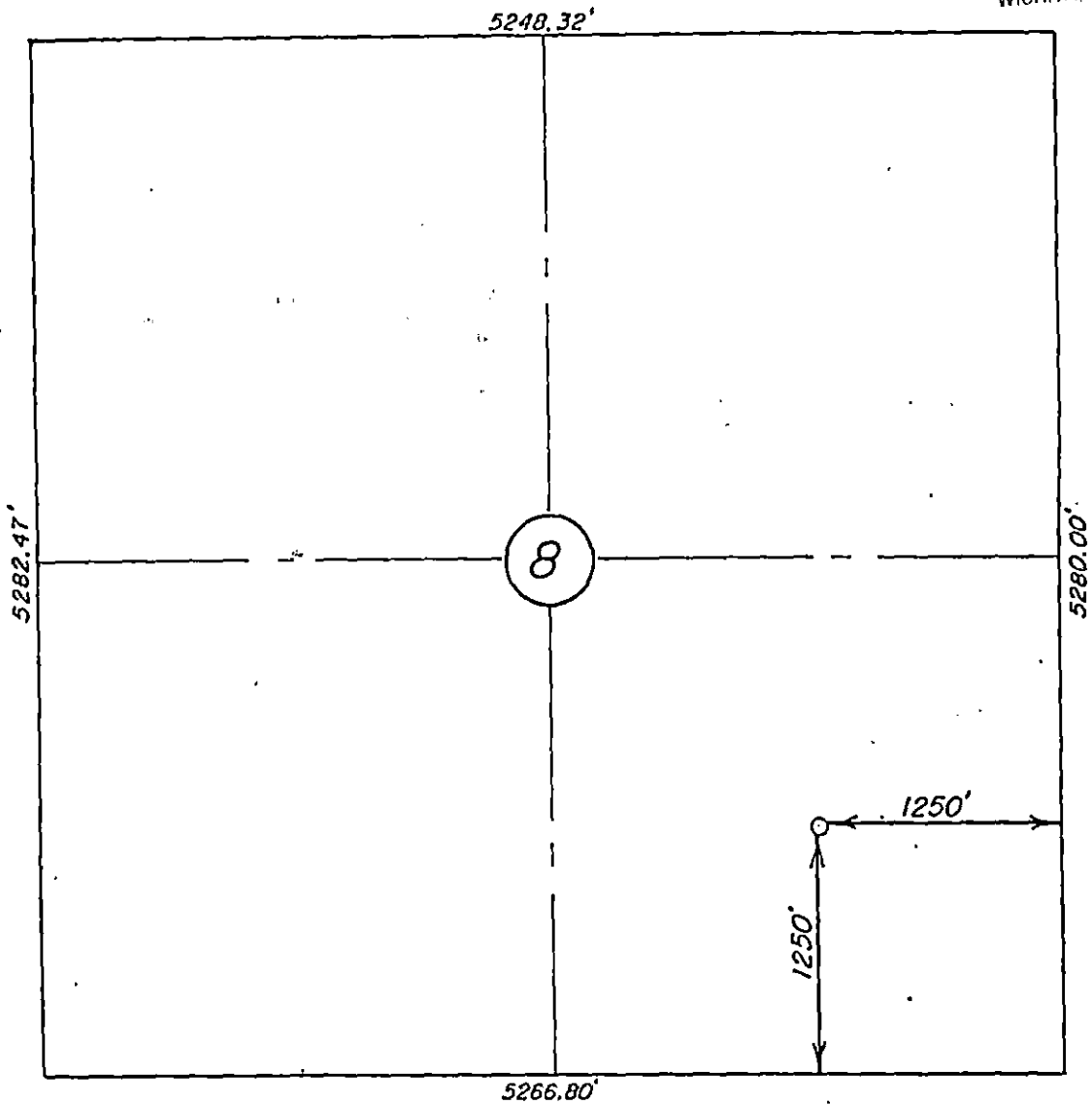

I, Donald D. DeSpain being a Registered Land Surveyor

in the State of Kansas Seal No. 707 do hereby certify that the above plat represents an accurate survey made under my supervision and that all measurements, bearings and monuments are correctly shown and indicated on the above plat as found or staked in the field as so dated above.

Signed: Donald D. DeSpain

Book 791 Page 37

Plat #1260



Surveying Company Drafting

Guymon, Oklahoma 73942

Box 1214

Phone: Day 338-6904 or 338-2144  
and 338-2656

ORIGINAL



The Western Company  
of North America

REMIT TO: P.O. BOX 911543  
DALLAS, TX 75391-1543

|                       |                           |                  |
|-----------------------|---------------------------|------------------|
| INVOICE NO.<br>471879 | OUR RECEIPT NO.<br>268657 | DATE<br>05/07/95 |
| 25622                 | 1225                      | YOUR ORDER NO.   |

DORCHESTER HUGOTON LTD.  
P. O. BOX 889  
HOOKER OK 73945

**received**  
5-12-95

|   |                            |                                |
|---|----------------------------|--------------------------------|
| SERVICES FROM OUR STATION AT:<br>PERRYTON CEMENTING | OUR ENGINEER:<br>ARRINGTON | SIGNED FOR YOU BY:<br>DANNELLY |
| FOR SERVICING WELL NAME:<br>MCLINTON 1-2            | COUNTY:<br>STEVENS         | STATE:<br>KS 15                |

FEDERAL I.D. NO. C 75-0763484

| PRODUCT CODE | DESCRIPTION                        | UNIT OF MEASURE | QUANTITY | LIST PRICE/UNIT | GROSS AMOUNT | PERCENT DISC. | NET AMOUNT |
|--------------|------------------------------------|-----------------|----------|-----------------|--------------|---------------|------------|
| J3905        | MILEAGE, HEAVY VEHICLE, PER UNIT   | MILE            | 105.0    | 2.950           | 309.75       | 35.00         | 201.34     |
| J3915        | MILEAGE, AUTO/PICK-UP/TREATING VAN | MILE            | 70.0     | 1.800           | 126.00       | 35.00         | 81.90      |
| F0075        | CEMENT CASING, 2501 - 3000 FT      | 6HRS            | 1.0      | 1385.000        | 1385.00      | 35.00         | 900.25     |
| F0385        | CEMENT CASING, AFTER 8 HOURS       | HOUR            | 30.0     | 245.000         | 7350.00      | 35.00         | 4,777.50   |
| M1005        | BULK MATERIALS SERVICE CHARGE      | CU FT           | 341.7    | 1.400           | 478.38       | 35.00         | 310.95     |
| J4015        | BULK MATERIAL DELIVERY, DRY        | TONMI           | 511.1    | 1.000           | 511.10       | 35.00         | 332.22     |
| P392F        | PREM PLUS CMT, PERRYTON, TX        | SACK            | 70.0     | 10.360          | 725.20       | 35.00         | 471.38     |
| P462F        | PACESTR PREM + LITE, PERRYTON, TX  | SACK            | 240.0    | 9.280           | 2227.20      | 35.00         | 1,447.68   |
| H5027        | CALC CHLORIDE-TX PANHANDLE         | LB              | 560.0    | .400            | 224.00       | 35.00         | 145.60     |
| P3095        | WMW-1                              | GAL             | 500.0    | .650            | 325.00       | 35.00         | 211.25     |
| P3575A       | CMT PLUG, RUBBER, BOTTOM 5-1/2"    | EACH            | 1.0      | 126.000         | 126.00       | 35.00         | 81.90      |
| P3575        | CMT PLUG, RUBBER, TOP 5-1/2"       | EACH            | 1.0      | 70.000          | 70.00        | 35.00         | 45.50      |
| 13152        | GUIDE SHOE/LONG BOX 5.5" 8RD       | EACH            | 1.0      | 202.000         | 202.00       | 35.00         | 131.30     |
| 17295        | FLOAT CL/ALINS/FV AF LTC 5.5" 8RD  | EACH            | 1.0      | 320.000         | 320.00       | 35.00         | 208.00     |
| 17064        | CENTRALIZER W/ PIN 5 1/2"          | EACH            | 8.0      | 70.000          | 560.00       | 35.00         | 364.00     |
| 17080        | SLIP-ON WELL BORE CABLE 5 1/2"     | EACH            | 20.0     | 28.900          | 578.00       | 35.00         | 375.70     |
| 17131        | STOP COLLARS 5 1/2"                | EACH            | 1.0      | 22.050          | 22.05        | 35.00         | 14.33      |
|              | SUB TOTAL                          |                 |          |                 | 15539.68     |               | 10,100.80  |

ORIGINAL

RECEIVED

MAY 18 1995

CONSERVATION DIVISION  
WICHITA, KS

JUL 11 1995

RECEIVED  
KANSAS CORPORATION COMMISSION

DORCHESTER HUGOTON, LTD.  
APPROVED BY: *[Signature]*  
DATE: 5-15-95  
ACCOUNT: MCLINTON I-2  
*Drilling AFE*  
*Prod. string cut (5 1/2")*

PHONE: (713) 629-2600

TERMS: NET 30 DAYS

**▶ PAY THIS AMOUNT**

10,100.80

DUPLICATE



The Western Company  
of North America

REMIT TO: P.O. BOX 911543  
DALLAS, TX 75391-1543

|                       |                           |                  |
|-----------------------|---------------------------|------------------|
| INVOICE NO.<br>471879 | OUR RECEIPT NO.<br>268657 | DATE<br>05/07/95 |
| 25622                 | 1225                      | YOUR ORDER NO.   |

DORCHESTER HUGOTON LTD.  
P. O. BOX 889  
HOOKER OK 73945

|  |                           |                               |
|--|---------------------------|-------------------------------|
| SERVICES FROM OUR STATION AT<br>PERRYTON CEMENTING | OUR ENGINEER<br>ARRINGTON | SIGNED FOR YOU BY<br>DANNELLY |
| FOR SERVICING WELL NAME<br>MCLINTON 1-2            | COUNTY<br>STEVENS         | STATE<br>KS 15                |

FEDERAL I.D. NO. C 75-0763484

| PRODUCT CODE | DESCRIPTION                        | UNIT OF MEASURE | QUANTITY | LIST PRICE/UNIT | GROSS AMOUNT | PERCENT DISC. | NET AMOUNT |
|--------------|------------------------------------|-----------------|----------|-----------------|--------------|---------------|------------|
| J3905        | MILEAGE, HEAVY VEHICLE, PER UNIT   | MILE            | 105.0    | 2.950           | 309.75       | 35.00         | 201.34     |
| J3915        | MILEAGE, AUTO/PICK-UP/TREATING VAN | MILE            | 70.0     | 1.800           | 126.00       | 35.00         | 81.90      |
| F0075        | CEMENT CASING, 2501 - 3000 FT      | 6HRS            | 1.0      | 1385.000        | 1385.00      | 35.00         | 900.25     |
| F0385        | CEMENT CASING, AFTER 8 HOURS       | HOUR            | 30.0     | 245.000         | 7350.00      | 35.00         | 4,777.50   |
| M1005        | BULK MATERIALS SERVICE CHARGE      | CU FT           | 341.7    | 1.400           | 478.38       | 35.00         | 310.95     |
| J4015        | BULK MATERIAL DELIVERY, DRY        | TONMI           | 511.1    | 1.000           | 511.10       | 35.00         | 332.22     |
| P392F        | PREM PLUS CMT, PERRYTON, TX        | SACK            | 70.0     | 10.360          | 725.20       | 35.00         | 471.38     |
| P462F        | PACESTR PREM + LITE, PERRYTON, TX  | SACK            | 240.0    | 9.280           | 2227.20      | 35.00         | 1,447.68   |
| H5027        | CALC CHLORIDE-TX PANHANDLE         | LB              | 560.0    | .400            | 224.00       | 35.00         | 145.60     |
| P3095        | WMW-1                              | GAL             | 500.0    | .650            | 325.00       | 35.00         | 211.25     |
| P3575A       | CMT PLUG, RUBBER, BOTTOM 5-1/2"    | EACH            | 1.0      | 126.000         | 126.00       | 35.00         | 81.90      |
| P3575        | CMT PLUG, RUBBER, TOP 5-1/2"       | EACH            | 1.0      | 70.000          | 70.00        | 35.00         | 45.50      |
| 13152        | GUIDE SHOE/LONG BOX 5.5" BRD       | EACH            | 1.0      | 202.000         | 202.00       | 35.00         | 131.30     |
| 17295        | FLOAT CL/ALINS/FV AF LTC 5.5" BRD  | EACH            | 1.0      | 320.000         | 320.00       | 35.00         | 208.00     |
| 17344        | CENTRALIZER W/ PIN 5 1/2"          | EACH            | 8.0      | 70.000          | 560.00       | 35.00         | 364.00     |
| 17280        | SLIP-ON WELL BORE CABLE 5 1/2"     | EACH            | 20.0     | 28.900          | 578.00       | 35.00         | 375.70     |
| 17131        | STOP COLLARS 5 1/2"                | EACH            | 1.0      | 22.050          | 22.05        | 35.00         | 14.33      |
| SUB TOTAL    |                                    |                 |          |                 | 15539.68     |               | 10,100.80  |

RECEIVED

MAY 18 1995

RECEIVED  
KANSAS CORPORATION COMMISSION

JUL 17 1995

CONSERVATION DIVISION  
WICHITA, KS

ORIGINAL

PHONE: (713) 629-2600

TERMS: NET 30 DAYS

**PAY THIS AMOUNT** →

10,100.80



The Western Company  
of North America

|                       |                           |                  |
|-----------------------|---------------------------|------------------|
| INVOICE NO.<br>471709 | OUR RECEIPT NO.<br>268654 | DATE<br>05/04/95 |
| 25622                 | 1225                      | YOUR ORDER NO.   |

REMIT TO: P.O. BOX 911543  
DALLAS, TX 75391-1543

DORCHESTER HUGOTON LTD.  
9696 SKILLMAN ST. #320  
DALLAS TX 75243-8200

|  |                           |                               |
|--|---------------------------|-------------------------------|
| SERVICES FROM OUR STATION AT<br>PERRYTON CEMENTING | OUR ENGINEER<br>ARRINGTON | SIGNED FOR YOU BY<br>DANNELLY |
| FOR SERVICING WELL NAME<br>MCLINTON 1-2            | COUNTY<br>STEVENS         | STATE<br>KS 15                |

FEDERAL I.D. NO. C 75-0763484

| PRODUCT CODE | DESCRIPTION                         | UNIT OF MEASURE | QUANTITY | LIST PRICE/UNIT | GROSS AMOUNT | PERCENT DISC. | NET AMOUNT |
|--------------|-------------------------------------|-----------------|----------|-----------------|--------------|---------------|------------|
| J3905        | MILEAGE, HEAVY VEHICLE, PER UNIT    | MILE            | 70.0     | 2.950           | 206.50       | 35.00         | 134.23     |
| J3915        | MILEAGE, AUTO/PICK-UP/TREATING VAN  | MILE            | 70.0     | 1.800           | 126.00       | 35.00         | 81.90      |
| F0035        | CEMENT CASING, 501 - 1000 FT        | 6HRS            | 1.0      | 850.000         | 850.00       | 35.00         | 552.50     |
| M1005        | BULK MATERIALS SERVICE CHARGE       | CU FT           | 354.5    | 1.400           | 496.30       | 35.00         | 322.60     |
| J4015        | BULK MATERIAL DELIVERY, DRY         | TONMI           | 537.8    | 1.000           | 537.80       | 35.00         | 349.57     |
| P392F        | PREM PLUS CMT, PERRYTON, TX         | SACK            | 125.0    | 10.360          | 1295.00      | 35.00         | 841.75     |
| P462F        | PACESTR PREM + LITE, PERRYTON, TX   | SACK            | 200.0    | 9.280           | 1856.00      | 35.00         | 1,206.40   |
| H5027        | CALC CHLORIDE-TX PANHANDLE          | LB              | 640.0    | .400            | 256.00       | 35.00         | 166.40     |
| P3255        | THREAD LOCKING COMPOUND             | BOX             | 1.0      | 24.650          | 24.65        | 35.00         | 16.02      |
| P3625        | CMT PLUG, RUBBER, TOP 8-5/8"        | EACH            | 1.0      | 132.000         | 132.00       | 35.00         | 85.80      |
| 13156        | GUIDE SHOE/LONG BOX 8 5/8" 8RD      | EACH            | 1.0      | 295.000         | 295.00       | 35.00         | 191.75     |
| 17299        | FLOAT CL/ALINS/FV AF LTC 8 5/8" 8RD | EACH            | 1.0      | 425.000         | 425.00       | 35.00         | 276.25     |
| 17068        | CENTRALIZER W/ PIN 8 5/8"           | EACH            | 3.0      | 88.500          | 265.50       | 35.00         | 172.58     |
| 17135        | STOP COLLARS 8 5/8"                 | EACH            | 1.0      | 27.750          | 27.75        | 35.00         | 18.04      |
|              | SUB TOTAL                           |                 |          |                 | 6793.50      |               | 4,415.79   |

RECEIVED

MAY 18 1995

RECEIVED  
KANSAS CORPORATION COMMISSION

JUL 11 1995

CONSERVATION DIVISION  
WICHITA, KS

DORCHESTER HUGOTON, LTD.  
APPROVED BY *[Signature]*  
DATE *5-15-95*  
ACCOUNT *MCLINTON I-2*  
*Drilling AFE -*  
*Surface Eng Contg (85)8*

ORIGINAL

DUPLICATE



The Western Company  
of North America

REMIT TO: P.O. BOX 911543  
DALLAS, TX 75391-1543

|                       |                           |                  |
|-----------------------|---------------------------|------------------|
| INVOICE NO.<br>471709 | OUR RECEIPT NO.<br>268654 | DATE<br>05/04/95 |
| 25622                 | 1225                      | YOUR ORDER NO.   |

DORCHESTER HUGOTON LTD.  
9696 SKILLMAN ST. #320  
DALLAS TX 75243-8200

|  |                           |                               |
|--|---------------------------|-------------------------------|
| SERVICES FROM OUR STATION AT<br>PERRYTON CEMENTING | OUR ENGINEER<br>ARRINGTON | SIGNED FOR YOU BY<br>DANNELLY |
| FOR SERVICING WELL NAME<br>MCLINTON 1-2            | COUNTY<br>STEVENS         | STATE<br>KS 15                |

FEDERAL I.D. NO. C 75-0763484

| PRODUCT CODE | DESCRIPTION                         | UNIT OF MEASURE | QUANTITY | LIST PRICE/UNIT | GROSS AMOUNT | PERCENT DISC. | NET AMOUNT |
|--------------|-------------------------------------|-----------------|----------|-----------------|--------------|---------------|------------|
| J3905        | MILEAGE, HEAVY VEHICLE, PER UNIT    | MILE            | 70.0     | 2.950           | 206.50       | 35.00         | 134.23     |
| J3915        | MILEAGE, AUTO/PICK-UP/TREATING VAN  | MILE            | 70.0     | 1.800           | 126.00       | 35.00         | 81.90      |
| F0035        | CEMENT CASING, 501 - 1000 FT        | 6HRS            | 1.0      | 850.000         | 850.00       | 35.00         | 552.50     |
| M1005        | BULK MATERIALS SERVICE CHARGE       | CU FT           | 354.5    | 1.400           | 496.30       | 35.00         | 322.60     |
| J4015        | BULK MATERIAL DELIVERY, DRY         | TONMI           | 537.8    | 1.000           | 537.80       | 35.00         | 349.57     |
| P392F        | PREM PLUS CMT, PERRYTON, TX         | SACK            | 125.0    | 10.360          | 1295.00      | 35.00         | 841.75     |
| P462F        | PACESTR PREM + LITE, PERRYTON, TX   | SACK            | 200.0    | 9.280           | 1856.00      | 35.00         | 1,206.40   |
| H5027        | CALC CHLORIDE-TX PANHANDLE          | LB              | 640.0    | .400            | 256.00       | 35.00         | 166.40     |
| P3255        | THREAD LOCKING COMPOUND             | BOX             | 1.0      | 24.650          | 24.65        | 35.00         | 16.02      |
| P3625        | CMT PLUG, RUBBER, TOP 8-5/8"        | EACH            | 1.0      | 132.000         | 132.00       | 35.00         | 85.80      |
| 13154        | GUIDE SHOE/LONG BOX 8 5/8" BRD      | EACH            | 1.0      | 295.000         | 295.00       | 35.00         | 191.75     |
| 17299        | FLOAT CL/ALINS/FV AF LTC 8 5/8" BRD | EACH            | 1.0      | 425.000         | 425.00       | 35.00         | 276.25     |
| 17068        | CENTRALIZER W/ PIN 8 5/8"           | EACH            | 3.0      | 88.500          | 265.50       | 35.00         | 172.58     |
| 17135        | STOP COLLARS 8 5/8"                 | EACH            | 1.0      | 27.750          | 27.75        | 35.00         | 18.04      |
|              | SUB TOTAL                           |                 |          |                 | 6793.50      |               | 4,415.79   |

RECEIVED

MAY 18 1995

RECEIVED  
KANSAS CORPORATION COMMISSION

JUL 11 1995

CONSERVATION DIVISION  
WICHITA, KS

ORIGINAL

PHONE: (713) 629-2600

TERMS: NET 30 DAYS

PAY THIS AMOUNT

4,415.79