

STATE CORPORATION COMMISSION OF KANSAS
OIL & GAS CONSERVATION DIVISION
WELL COMPLETION FORM
ACO-1 WELL HISTORY
DESCRIPTION OF WELL AND LEASE

ORIGINAL

API NO. 15- 189-21830-00-00
County STEVENS
- W/2 - NW Sec. 7 Twp. 34 Rge. 38 X W
3960 FSL Feet from S/W (circle one) Line of Section
4060 FEL Feet from E/W (circle one) Line of Section
Footages Calculated from Nearest Outside Section Corner:
NE, SE, NW or SW (circle one)
Lease Name CP- RATCLIFF FEE Well # 3
Field Name Hugoton
Producing Formation NA [ANODE REPOSITORY]
Elevation: Ground 3253 KB NA
Total Depth 100 PBDT NA
Amount of Surface Pipe Set and Cemented at None Feet
Multiple Stage Cementing Collar Used? NA Yes NA No
If yes, show depth set NA Feet
If Alternate II completion, cement circulated from NA
feet depth to NA w/ NA sx cmt.
Drilling Fluid Management Plan ALT 3 9/10-18-95
(Data must be collected from the Reserve Pit)

Operator: License # 5208
Name: Mobil Oil Corporation
Address P.O. Box 2173
2319 North Kansas Avenue
City/State/Zip Liberal, KS 67905-2173
Purchaser: N/A
Operator Contact Person: Sharon Cook
Phone (316) 626-1142
Contractor: Name: Cathodic Protection Services
License: 31474
Wellsite Geologist:
Designate Type of Completion
New Well Re-Entry Workover
Oil SWD SOW Temp. Abd.
Gas ENHR SIGW
Dry X Other (Cope, USW, Expl., Cathodic, etc)

If Workover:
Operator:
Well Name:
Comp. Date Old Total Depth
Deepening Re-perf. Conv. to Inj/SWD
Plug Back PBDT
Commingle Docket No.
Dual Completion Docket No.
Other (SWD or Inj?) Docket No.
1/10/95 1/10/95 1/10/95
Spud Date Date Reached TD Completion Date

Chloride content NA ppm Fluid volume NA bbbls
Dewatering method used NA
Location of fluid disposal if hauled offsite:
Operator Name NA
Lease Name NA License No.
NA Quarter Sec. NA Twp. NA S Rng. NA E/W
County NA Docket No. NA

INSTRUCTIONS: An original and two copies of this form shall be filed with the Kansas Corporation Commission, 200 Colorado Derby Building, Wichita, Kansas 67202, within 120 days of the spud date, recompletion, workover or conversion of a well. Rule 82-3-130, 82-3-106 and 82-3-107 apply. Information on side two of this form will be held confidential for a period of 12 months if requested in writing and submitted with the form (see rule 82-3-107 for confidentiality in excess of 12 months). One copy of all wireline logs and geologist well report shall be attached with this form. ALL CEMENTING TICKETS MUST BE ATTACHED. Submit CP-4 form with all plugged wells. Submit CP-111 form with all temporarily abandoned wells.

All requirements of the statutes, rules and regulations promulgated to regulate the oil and gas industry have been fully complied with and the statements herein are complete and correct to the best of my knowledge.

Signature Sharon A. Cook Sharon A. Cook
Title Regulatory Assistant Date 2-13-95
Subscribed and sworn to before me this 13th day of February, 1995.
Notary Public Kathleen R. Poulton STATE
Date Commission Expires AUGUST 18, 1998

K.C.C. OFFICE USE ONLY
F Letter of Confidentiality Attached
C Wireline Log Received
C Geologist Report Received
Distribution
KCC SWD/Rep NGPA
KGS Plug Other
CORPORATION COMMISSION
FEB 17 1995
Form ACO-1 (7-91)

DEW95097.SAC



CONSERVATION DIVISION
WICHITA, KANSAS

SIDE TWO

Operator Name Mobil Oil Corporation Lease Name CP- RATCLIFF FEE Well # 3

Sec. 7 Twp. 34 Rge. 38 East West
 County STEVENS

INSTRUCTIONS: Show important tops and base of formations penetrated. Detail all cores. Report all drill stem tests giving interval tested, time tool open and closed, flowing and shut-in pressures, whether shut-in pressure reached static level, hydrostatic pressures, bottom hole temperature, fluid recovery, and flow rates if gas to surface during test. Attach extra sheet if more space is needed. Attach copy of log.

Drill Stem Tests Taken Yes No
 (Attach Additional Sheets.)

Samples Sent to Geological Survey Yes No

Cores Taken Yes No

Electric Log Run Yes No
 (Submit Copy.)

List All E.Logs Run:

Electric Resistance Log - Attached

Log Sample
 Formation (Top), Depth and Datums
 Name Top Datum

SEE ATTACHED DRILLER'S LOG

CASING RECORD <input type="checkbox"/> New <input type="checkbox"/> Used							
Report all strings set-conductor, surface, intermediate, production, etc.							
Purpose of String	Size Hole Drilled	Size Casing Set (In O.D.)	Weight Lbs./Ft.	Setting Depth	Type of Cement	# Sacks Used	Type and Percent Additives

ADDITIONAL CEMENTING/SQUEEZE RECORD				
Purpose:	Depth Top Bottom	Type of Cement	#Sacks Used	Type and Percent Additives
<input type="checkbox"/> Perforate				
<input type="checkbox"/> Protect Casing				
<input type="checkbox"/> Plug Back TD				
<input checked="" type="checkbox"/> Plug Off Zone	(1) First plug - Bentonite set at 13' - 3' plug.			
	(2) Second plug - Bentonite set at 37' - 35' plug.			

Shots Per Foot	PERFORATION RECORD - Bridge Plugs Set/Type Specify Footage of Each Interval Perforated	Acid, Fracture, Shot, Cement Squeeze Record (Amount and Kind of Material Used)	Depth
First anode set at	90', second anode at 75', third anode at 55'.		

TUBING RECORD		Size	Set At	Packer At	Liner Run		
1" PVC vent from TD to 3' above surface.					NA	<input type="checkbox"/> Yes <input type="checkbox"/> No	
Date of First, Resumed Production, SWD or Inj. Installed 1/10/95			Producing Method <input type="checkbox"/> NA <input type="checkbox"/> Flowing <input type="checkbox"/> Pumping <input type="checkbox"/> Gas Lift <input type="checkbox"/> Other (Explain)				
Estimated Production Per 24 Hours	Oil Bbls. NA	Gas NA	Mcf NA	Water NA	Bbls. NA	Gas-Oil Ratio	Gravity

Disposition of Gas: **METHOD OF COMPLETION** **Production Interval**

Vented Sold Used on Lease Open Hole Perf. Dually Comp. Commingled
 (If vented, submit ACO-18.) Other (Specify) _____

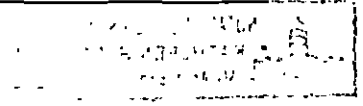

DATA SHEET

COMPANY MOBIL E+P JOB No. 80100370 DATE: 1-10-95
 WELL: RATCLIFF FEE 3 PIPELINE:
 LOCATION: SEC. 7 TWP. 34 RGE. 38 CO. STEVENS STATE KS
 ANODE TYPE LIDA ONE FT: ROTARY 100 FT: CASING _____ FT.

DEEP GROUND BED LOGGING DATA

DRILL DEPTH LOG (FT)	ANODE TO STRUCTURE		ANODES NO	TOP DEPTH	DRILL DEPTH LOG (FT)	ANODE TO STRUCTURE		ANODES NO	TOP DEPTH
	EXPLOR OHM	FINAL OHM				EXPLOR OHM	FINAL OHM		
5					205				
HOLE PLUG 10				3'-13'	210				
EARTH FILL 15				13'-35'	215				
20					220				
25					225				
30	.690				230				
HOLE PLUG 35	.520			35'-37'	235				
40	.590				240				
45	.770				245				
50	.860				250				
55	.890		3		255				
60	.490				260				
65	.250				265				
70	.260				270				
75	.720		2		275				
80	.270				280				
85	.330				285				
90	.870		1		290				
95					295				
100					300				
105					305				
110					310				
115					315				
120					320				
125					325				
130					330				
135					335				
140					340				
145					345				
150					350				
155					355				
160					360				
165					365				
170					370				
175					375				
180					380				
185					385				
190					390				
195					395				
200					400				

PIT CLOSED 1-10-95 HOLE PLUG SET 1-10-95

RATCLIFF FIELDS 7-34-38 Stevens
3960 FSL 3960FSL
Elev? N Crop mib

34

10-95

0-50 BROWN Clay

50-90 Brown sand

90-100 Brown sand + Clay

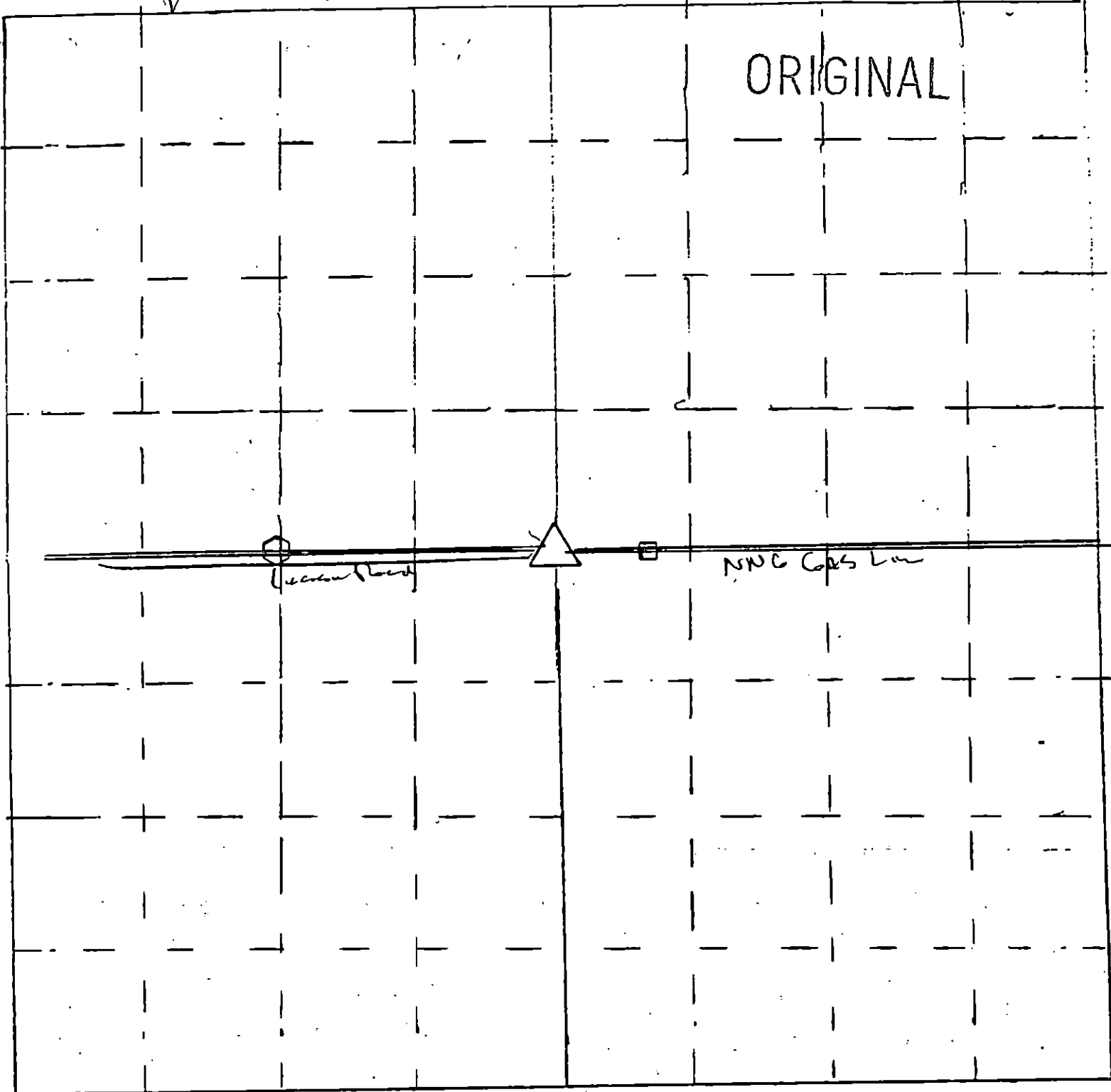
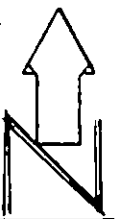

△ = gas well location

○ = cathodic deep well location

Scale = 1" = 50'

□ = Meter house