

\*Amendment: To show additional perforation in the Morrow Sand.

PR?  
unit

C SIDE ONE

STATE CORPORATION COMMISSION OF KANSAS  
OIL & GAS CONSERVATION DIVISION

WELL COMPLETION OR RECOMPLETION FORM  
ACO-1 WELL HISTORY

DESCRIPTION OF WELL AND LEASE

Operator: License # 5447  
Name Citgas Service Oil & Gas Corp  
Address 3545 N.W. 58th Street  
City/State/Zip Okla., City, Okla. 73112

Purchaser Citgo Petroleum

Operator Contact Person Raymond Hui  
Phone (405) 949-4400

Contractor: License # 7860  
Name Johnson Drilling Company, Inc.

Wellsite Geologist Brent Sonnier  
Phone (405) 949-4400

Designate Type of Completion  
 New Well  Re-Entry  Workover  
 Oil  SWD  Temp Abd  
 Gas  Inj  Delayed Comp.  
 Dry  Other (Core, Water Supply etc.)

If OWWO: old well info as follows:  
Operator  
Well Name  
Comp. Date Old Total Depth

WELL HISTORY

Drilling Method:  
 Mud Rotary  Air Rotary  Cable  
8-10-84 8-24-84 \*4-3-86  
Spud Date Date Reached TD Completion Date  
5750' 4932' \*workover  
Total Depth PBD  
Amount of Surface Pipe Set and Cemented at 1454' KB  
Multiple Stage Cementing Collar Used?  Yes  No  
If yes, show depth set feet  
If alternate 2 completion, cement circulated from feet depth to w/ SX cmt

API NO. 15-129-20712-00-00  
County Morton  
C... NE NW Sec. 33 Twp 34S Rge 41  East  West  
4620 Ft North from Southeast Corner of Section  
3300 Ft West from Southeast Corner of Section  
(Note: Locate well in section plat below)  
Lease Name Wilburton Morrow Sand Well # 1105  
Unit  
Field Name Wilburton Morrow "C" Sd. Unit  
Producing Formation Morrow "C"  
Elevation: Ground 3437' KB

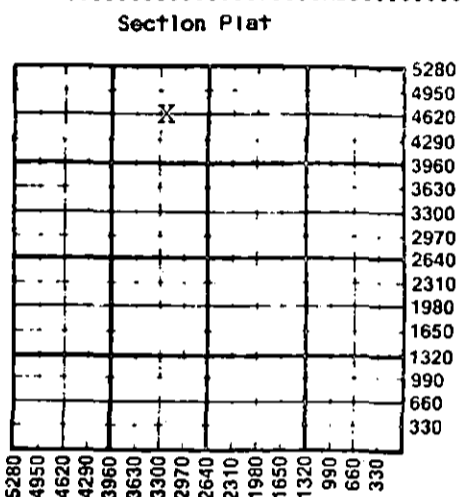

WATER SUPPLY INFORMATION  
Disposition of Produced Water:  Disposal  Repressuring  
Docket #  
Reinjected into WMSU Unit.

Questions on this portion of the ACO-1 call:  
Water Resources Board (913) 296-3717  
Source of Water: WMSU #1203 Water Supply Well  
Division of Water Resources Permit #  
 Groundwater 2640 Ft North from Southeast Corner  
(Well) 660 Ft West from Southeast Corner of  
Sec 33 Twp 34S Rge 41  East  West  
 Surface Water Ft North from Southeast Corner  
(Stream, pond etc) Ft West from Southeast Corner  
Sec Twp Rge  East  West  
 Other (explain)  
(purchased from city, R.W.D. #)

INSTRUCTIONS: This form shall be completed in duplicate and filed with the Kansas Corporation Commission, 200 Colorado Derby Building, Wichita, Kansas 67202, within 90 days after completion or recompletion of any well. Rule 82-3-130 and 82-3-107 apply.  
Information on side two of this form will be held confidential for a period of 12 months if requested in writing and submitted with the form. See rule 82-3-107 for confidentiality in excess of 12 months.  
One copy of all wireline logs and drillers time log shall be attached with this form. Submit CP-4 form with all plugged wells. Submit CP-111 form with all temporarily abandoned wells.

All requirements of the statutes, rules and regulations promulgated to regulate the oil and gas industry have been fully complied with and the statements hereon are complete and correct to the best of my knowledge.

Signature Del G. Oliver  
Title Engineering Manager Date 4/18/86

Subscribed and sworn to before me this 18 day of April 1986  
Notary Public  
Date Commission Expires 4-24-89

K.C.C. OFFICE USE ONLY  
 Letter of Confidentiality Attached  
 Wireline Log Received  
 Drillers Time Log Received  
Distribution  
 KCK  SWD/Rep  NGPA  
 KGS  Plug  Other  
(Specify)

APR 25 1986  
CONSERVATION DIVISION  
Wichita, Kansas

Form ACO-1 (7-84)

SIDE TWO

Operator Name Cities Service Oil & Gas Corporation Lease Name Wilburton Morrow Well # 1105  
Sand Unit  
 Sec. 33 Twp. 34S Rge. 41  East  West County Morton

WELL LOG

INSTRUCTIONS: Show important tops and base of formations penetrated. Detail all cores. Report all drill stem tests giving interval tested, time tool open and closed, flowing and shut-in pressures, whether shut-in pressure reached static level, hydrostatic pressures, bottom hole temperature, fluid recovery, and flow rates if gas to surface during test. Attach extra sheet if more space is needed. Attach copy of log.

Drill Stem Tests Taken  Yes  No  
 Samples Sent to Geological Survey  Yes  No  
 Cores Taken  Yes  No

Formation Description  
 Log  Sample

Core #1 4830-4878'  
 Core #2 4878-4915'. 28' Morrow Sand and 8' Shale

Logging:

Dual Ind. - SFL, GR, SP,  
 Comp Neutron Form. Density,  
 Sonic w/GR & Caliper.  
 CBL/GR/CCL

Name	Top	Bottom
Surface, Clay & Sand	0	490
Redbed, Shale	490	1055
Glorietta Sand	1055	1149
Shale	1149	1445
Anhydrite	1445	1455
Shale	1455	3216
Lime & Shale	3216	5750
TD		5750'
PBTD		4932'

CASING RECORD <input checked="" type="checkbox"/> New <input type="checkbox"/> Used							
Report all strings set-conductor, surface, intermediate, production, etc.							
Purpose of String	Size Hole Drilled	Size Casing Set (in O.D.)	Weight Lbs/Ft.	Setting Depth	Type of Cement	#Sacks Used	Type and Percent Additives
Surface	12-1/4"	8-5/8"	24	1454' KB	Howco. Lt. Class. H.	650	2% CaCl <sub>2</sub> , 1/4# Flo
Production	7-7/8"	5-1/2"	14	5230' KB	50/50 Pozz. Floccle,	200	18% salt, 1/4# CFR-2.
PERFORATION RECORD				Acid, Fracture, Shot, Cement Squeeze Record			
Shots Per Foot	Specify Footage of Each Interval Perforated			(Amount and Kind of Material Used)		Depth	
4	4940-48' Morrow Sand			250 gal...15% Spearhead Acid		4940-48'	
2	4872-4908' Morrow "C"			Set. CIBP @ 4870' KB			
2	4872-4908' Morrow "C"						
4	4840-4850' (10'; 40 holes)			1500 gals w/7.5% Spearhead acid		4840-50 &	
TUBING RECORD		Size 2-7/8" Set At	4864' KB	Backer at	Liner Run	<input type="checkbox"/> Yes <input checked="" type="checkbox"/> No	4860-67'
Date of First Production	Producing Method						
10/1/84	<input type="checkbox"/> Flowing <input checked="" type="checkbox"/> Pumping <input type="checkbox"/> Gas Lift <input type="checkbox"/> Other (explain).....						
Estimated Production Per 24 Hours	Oil	Gas	Water	Gas-Oil Ratio	Gravity		
370 Bbls	425 MCF	892 Bbls	425 CFPB				

METHOD OF COMPLETION

Disposition of gas:  Vented  Open Hole  Perforation  
 Sold  Other (Specify) .....  
 Used on Lease  Dually Completed  Conmingled

Production Interval

4840-50 &  
 4860-67  
 Morrow "C"

Amendment: to show additional perf. in the same zone.

SIDE ONE

STATE CORPORATION COMMISSION OF KANSAS  
OIL & GAS CONSERVATION DIVISION  
WELL COMPLETION OR RECOMPLETION FORM  
ACO-1 WELL HISTORY  
DESCRIPTION OF WELL AND LEASE

Operator: License # 5447  
Name Cities Service Oil & Gas Corp  
Address 3545 NW 58th Street  
Oklahoma City, Oklahoma  
City/State/Zip 73112

Purchaser Citgo Petroleum

Operator Contact Person Raymond Hui  
Phone (405) 949-4432

Contractor: License # 7860  
Name Johnson Drilling Company

Wellsite Geologist Brent Sonnier  
Phone (405) 949-4400

Designate Type of Completion

New Well Re-Entry  Workover  
 Oil SWD Temp Abd  
 Gas Inj Delayed Comp  
 Dry Other (Core, Water Supply etc)

If ~~OWNO~~: old well info as follows:

Operator Cities Service Oil & Gas Corp  
Well Name Wilburton Mor. Sand Unit #1105  
Comp. Date 11/2/84 Old Total Depth 5750'

WELL HISTORY

Drilling Method:

Mud Rotary  Air Rotary  Cable

Spud Date 8/10/84 Date Reached TD 8/24/84 Completion Date 11/11/86

Total Depth 5750' PBTD 4870'

Amount of Surface Pipe Set and Cemented at 1454 feet  
Multiple Stage Cementing Collar Used? Yes  No  
If yes, show depth set...feet  
If alternate 2 completion, cement circulated from...feet depth to...w/...SX cmt  
Cement Company Name  
Invoice #

API NO. 15-129-20712

County Morton

C... NE... NW... Sec. 33... Twp. 34S... Rge. 41... East West

4620 Ft North from Southeast Corner of Section  
3300 Ft West from Southeast Corner of Section

(Note: Locate well in section plat below)

Lease Name Wilburton Mor. Sand Unit #1105

Field Name Wilburton Mor. "C" Sand

Producing Formation Morrow "C"

Elevation: Ground 3437' KB

Section Plat

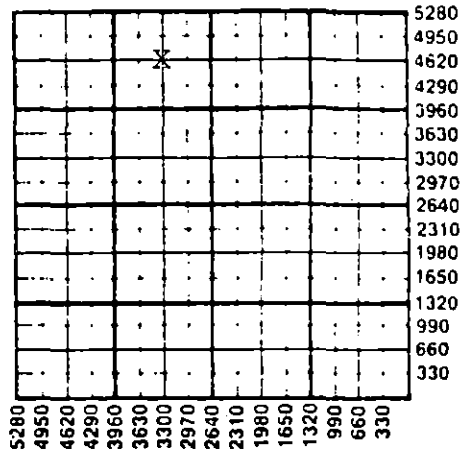

WATER SUPPLY INFORMATION

Disposition of Produced Water: Disposal  
Docket # Repressuring

Questions on this portion of the ACO-1 call:  
Water Resources Board (913) 296-3717

Source of Water:  
Division of Water Resources Permit #

Groundwater...Ft North from Southeast Corner (Well) ...Ft West from Southeast Corner of Sec Twp Rge East West

Surface Water...Ft North from Southeast Corner (Stream, pond etc)...Ft West from Southeast Corner Sec Twp Rge East West

Other (explain) (purchased from city, R.W.D. #)

INSTRUCTIONS: This form shall be completed in triplicate and filed with the Kansas Corporation Commission, 200 Colorado Derby Building, Wichita, Kansas 67202, within 120 days of the spud date of any well. Rule 82-3-130, 82-3-107 and 82-3-106 apply.

Information on side two of this form will be held confidential for a period of 12 months if requested in writing and submitted with the form. See rule 82-3-107 for confidentiality in excess of 12 months. One copy of all wireline logs and drillers time log shall be attached with this form. Submit CP-4 form with all plugged wells. Submit CP-111 form with all temporarily abandoned wells.

All requirements of the statutes, rules and regulations promulgated to regulate the oil and gas industry have been fully complied with and the statements herein are complete and correct to the best of my knowledge.

Signature Del G. Oliver

Title Engineering Manager Date 12/2/86

Subscribed and sworn to before me this 2nd day of December 1986

Notary Public Debra Jo Howeth

Date Commission Expires 4-24-89

K.C.C. OFFICE USE ONLY  
F Letter of Confidentiality Attached  
C Wireline Log Received  
C Drillers Timelog Received  
Distribution  
KCC SWD/Rep NGPA  
KGS Plug Other (Specify)

Sec. 33 Imp. 34 Page 4/2

Operator Name ... Cities Service Oil & Gas Corp ... Lease Name ... Wilburton Mor. Sand Unit ... 1105

Sec. 33 ... Twp. 34S ... Rge. 41 ...  East  West County ... Morton

WELL LOG

INSTRUCTIONS: Show important tops and base of formations penetrated. Detail all cores. Report all drill stem tests giving interval tested, time tool open and closed, flowing and shut-in pressures, whether shut-in pressure reached static level, hydrostatic pressures, bottom hole temperature, fluid recovery, and flow rates if gas to surface during test. Attach extra sheet if more space is needed. Attach copy of log.

Drill Stem Tests Taken  Yes  No  
 Samples Sent to Geological Survey  Yes  No  
 Cores Taken  Yes  No

Formation Description  
 Log  Sample

Core #1 4830-4878'  
 Core #2 4878-4915' (28' Mor. Sand & 8' Shale)  
 Ran CNL w/GR from 4862-4700'.  
 TDT w/GR from 4859'-4750'.

Name	Top	Bottom
Surface, Clay & Sand	0	490
Redbed, Shale	490	1055
Glorietta Sand	1055	1149
Shale	1149	1445
Anhydrite	1445	1455
Shale	1455	3216
Lime & Shale	3216	5750
TD		5750
P.B.T.D.		4870

CASING RECORD <input checked="" type="checkbox"/> New <input type="checkbox"/> Used							
Report all strings set-conductor, surface, intermediate, production, etc.							
Purpose of String	Size Hole Drilled	Size Casing Set (In O.D.)	Weight Lbs/Ft.	Setting Depth	Type of Cement	#Sacks Used	Type and Percent Additives
Surface	12-1/4"	8-5/8"	24	1454' KB	Howco Lit	650	2% CaCl <sub>2</sub> , 1/4# floc.
Production	7-7/8"	5-1/2"	14	5230' KB	Class H	150	3% CaCl <sub>2</sub> , 1/4# floc.
					50/50 Pdz	200	18% salt, 1/4# Floccle, 0.8% CFR-2
PERFORATION RECORD				Acid, Fracture, Shot, Cement Squeeze Record			
Shots Per Foot	Specify Footage of Each Interval Perforated			(Amount and Kind of Material Used)		Depth	
	Set CTBP at 4932' w/1 sx cmt on top.						
4	4840-4850' (10' 40 holes - new perf)			1500 gals 7.5% spearhead		4840-67'	
2	4860-4867' (Existing perf)						
TUBING RECORD				Liner Run <input type="checkbox"/> Yes <input checked="" type="checkbox"/> No			
	Size 2-7/8"	Set At 4864'	Packer at				
Date of First Production after WO	Producing Method						
11-11-86	<input type="checkbox"/> Flowing <input checked="" type="checkbox"/> Pumping <input type="checkbox"/> Gas Lift <input type="checkbox"/> Other (explain).....						
Estimated Production Per 24 Hours	Oil	Gas	Water	Gas-Oil Ratio	Gravity		
	192 Bbls	170 MCF	733 Bbls		CFPB		

METHOD OF COMPLETION

Production Interval

Disposition of gas:  Vented  Open Hole  Perforation  
 Sold  Other (Specify) .....  
 Used on Lease  Dually Completed  Commingled

Morrow  
 4840-4867'

STATE CORPORATION COMMISSION OF KANSAS  
OIL & GAS CONSERVATION DIVISION

WELL COMPLETION OR RECOMPLETION FORM  
ACO-1 WELL HISTORY

DESCRIPTION OF WELL AND LEASE

Operator: license # 5447  
name Cities Service Oil & Gas Corp.  
address 3545 NW 58th Street  
City/State/Zip Oklahoma City, OK 73112

Operator Contact Person Raymond Hui  
Phone (405) 949-4400

Contractor: license # 7860  
name Johnson Drilling Company, Inc.

Wellsite Geologist Brent Sonnier  
Phone 405-949-4400

Purchaser: Citgo Petroleum

Designate Type of Completion  
 New Well  Re-Entry  Workover  
 Oil  Gas  Dry  
 SWD  Inj  Other (Core, Water Supply etc.)  
 Temp Abd  Delayed Comp.

If OWWO: old well info as follows:  
Operator  
Well Name  
Comp. Date Old Total Depth

WELL HISTORY

Drilling Method:  Mud Rotary  Air Rotary  Cable  
8-10-84 8-24-84 11-2-84  
Spud Date Date Reached TD Completion Date

5750' 4932'  
Total Depth PBD

Amount of Surface Pipe Set and Cemented at 1454' KB feet

Multiple Stage Cementing Collar Used?  Yes  No

If Yes, Show Depth Set feet

If alternate 2 completion, cement circulated  
from feet depth to w/ SX cmt

**INSTRUCTIONS:** This form shall be completed in duplicate and filed with the Kansas Corporation Commission, 200 Colorado Derby Building, Wichita, Kansas 67202, within 90 days after completion or recompletion of any well. Rules 82-3-130 and 82-3-107 apply.

Information on side two of this form will be held confidential for a period of 12 months if requested in writing and submitted with the form. See rule 82-3-107 for confidentiality in excess of 12 months.

One copy of all wireline logs and drillers time log shall be attached with this form. Submit CP-4 form with all plugged wells. Submit CP-111 form with all temporarily abandoned wells.

All requirements of the statutes, rules, and regulations promulgated to regulate the oil and gas industry have been fully complied with and the statements herein are complete and correct to the best of my knowledge.

Signature *D.G. Oliver*  
Title Engineering Manager Date 12-11-84  
Subscribed and sworn to before me this 11th day of December 19 84

Notary Public *James S. Porter*  
Date Commission Expires 6-12-88

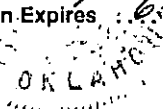

API NO. 15- 129-20712  
County Morton  
C NE NW Sec. 33 Twp. 34S Rge. 41  
660' FNL, 1980' FWL  
4620 Ft North from Southeast Corner of Section  
3300 Ft West from Southeast Corner of Section  
(Note: locate well in section plat below)

Lease Name Wilburton Morrow Sand Unit Well# 1105

Field Name Wilburton Morrow "C" Sd. Unit

Producing Formation Morrow "C"

Elevation: Ground 3437' KB 3450' KB-KCC

Section Plat

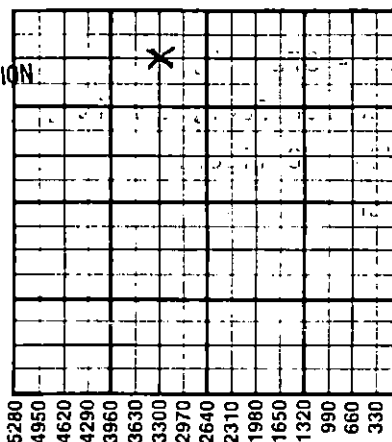

WATER SUPPLY INFORMATION

Source of Water: WMSU #1203 Water Supply Well

Division of Water Resources Permit #

Groundwater 2640 Ft North From Southeast Corner and  
(Well) 660 Ft. West From Southeast Corner of  
Sec 33 Twp 34 Rge 41  East  West

Surface Water Ft North From Southeast Corner and  
(Stream, Pond etc.) Ft West From Southeast Corner  
Sec Twp Rge  East  West

Other (explain)  
(purchased from city, R.W.D.#)

Disposition of Produced Water:  Disposal  Repressuring

Docket #  
Reinjected into WMSU Unit

K.C.C. OFFICE USE ONLY  
F  Letter of Confidentiality Attached  
C  Wireline Log Received  
C  Drillers Timelog Received  
Distribution  
 KCC  SWD/Rep  NGPA  
 KGS  Plug  Other  
(Specify)

Sec. 33 Twp 34 Rge 41

**WELL LOG**

**INSTRUCTIONS:** Show important tops and base of formations penetrated. Detail all cores. Report all drill stem tests giving interval tested, time tool open and closed, flowing and shut-in pressures, whether shut-in pressure reached static level, hydrostatic pressures, bottom hole temperature, fluid recovery, and flow rates if gas to surface during test. Attach extra sheet if more space is needed. Attach copy of log.

Drill Stem Tests Taken  Yes  No  
 Samples Sent to Geological Survey  Yes  No  
 Cores Taken  Yes  No

**Formation Description**  
 Log  Sample

Core #1 4830-4878'  
 Core #2 4878-4915'. 28' Morrow Sand and 8' Shale.

Name	Top	Bottom
Surface, Clay, Sand	0	490
Redbed, Shale	490	1055
Glorietta Sand	1055	1149
Shale	1149	1445
Anhydrite	1445	1455
Shale	1455	3216
Lime & Shale	3216	5750
T.D.		5750'
P.B.T.D.		4932'

**Logging:**

Dual Ind. - SFL, GR, SP,  
 Comp. Neutron Form. Density,  
 Sonic w/GR & Caliper.  
 CBL/GR/CCL

CASING RECORD <input checked="" type="checkbox"/> new <input type="checkbox"/> used							
Report all strings set - conductor, surface, intermediate, production, etc.							
Purpose of string	size hole drilled	size casing set (in O.D.)	weight lbs/ft.	setting depth	type of cement	# sacks used	type and percent additives
Surface	12-1/4"	8-5/8"	24	1454' KB	Howco Lt. Class "H"	650	2% CaCl <sub>2</sub> , 1/4# fldc.
Production	7-7/8"	5-1/2"	14	5230' KB	50/50 Poz. Floccle, .8% CFR-2	200	3% CaCl <sub>2</sub> , 1/4# fldc. 1.8% salt, 1/4#
PERFORATION RECORD				Acid, Fracture, Shot, Cement Squeeze Record			
shots per foot	specify footage of each interval perforated			(amount and kind of material used)			Depth
4	4940-48' Morrow Sand CIBP @ 4932' KB w/1 sx cmt on top			250 gal. 15% Spearhead Acid			4940-48'
2	4872-4908' Morrow "C"			Set CIBP @ 4870' KB			
2	4860-4867' Morrow "C"						
TUBING RECORD				Liner Run <input type="checkbox"/> Yes <input type="checkbox"/> No			
size 2-7/8" set at 4864' KB packer at SN @ 4848'							
Date of First Production	Producing method <input type="checkbox"/> flowing <input checked="" type="checkbox"/> pumping <input type="checkbox"/> gas lift <input type="checkbox"/> Other (explain)						
10-1-84							
State Test 11-2-84	Oil	Gas	Water	Gas-Oil Ratio	Gravity		
Estimated Production Per 24 Hours	107 Bbls	50 MCF	94 Bbls	467	CFPS		

Disposition of gas:  vented  sold  used on lease

**METHOD OF COMPLETION**  
 open hole  perforation  other (specify) \_\_\_\_\_  
 Dually Completed.  Commingled

**PRODUCTION INTERVAL**  
 4860-4867'  
 Morrow "C"